



SHESTAKOV

Yacht Sales

FL42 - CUSTOM



Builder:

CUSTOM

Model:

FL42

LOA:

139' 0" (42.60 m)

Beam:

30' 0" (9.40 m)

Max Draft:

8' 10" (2.70 m)

Cruise Speed:

12.5 kn / 14.38 mph

Max Speed:

15 kn / 17.26 mph

Gross Tonnage:

489 Pounds

Water Capacity:

3170.06 Gallons

Fuel Capacity:

21133.76 Gallons

Sleeps:

9

Total Heads:

8

If you would like to buy a yacht **FL42 - CUSTOM** or would like help, please call +1(954)274-4435 or visit shestakovyachtsales.com

TABLE OF CONTENTS

OVERVIEW	3
Selecting a FL42	3
Features of the Model	3
Technical Specifications	4
Pricing and Ordering	4
Questions and Answers	5
Owner Experience Review	5
Pros and Cons	6
Comparison with Other Models	7
SPECIFICATIONS	8
GALLERY	9
CONTACTS	14

OVERVIEW

The FL42 from CUSTOM measures 42.6 m (139 ft) and is presented as a purpose-built expedition yacht configured on a full-displacement platform with a steel hull. Listed by Andrey Shestakov and Shestakov Yacht Sales, this design pairs rugged, commercial-grade construction with a comfortable 12.5-knot cruising pace and substantial internal volume of 489 gross tons.

Selecting a FL42

When offshore capability, interior space and long-range comfort are primary objectives, the FL42 is a compelling option. Powered by twin CAT diesel engines, it is intended to cruise efficiently at 12.5 knots with a top capability around 15 knots, and its full-displacement hull promotes a smoother ride on blue-water passages. Accommodating up to 14 people with dedicated crew quarters and shaped by Floating Life's design teams, it's engineered for extended voyages in the spirit of a contemporary expedition yacht.

Features of the Model

- Naval architecture by Floating Life - ZeroTredici Naval Designer; interiors by Floating Life - Satura Studio.
- Full-displacement construction with a steel hull and Steel decks for durability and stability.
- Twin CAT diesel power (2 engines) for reliable propulsion; cruise 12.5 kn (14.38 mph), max 15 kn (17.26 mph).
- Volume-forward layout with 489 gross tons, designed to support 14 accommodations, 9 sleeps, and 8 heads.
- Professional crew area with 5 crew cabins and 10 crew beds to maintain premium service standards underway.

Technical Specifications

- Length overall: 139 ft (42.6 m)
- Beam: 30 ft (9.4 m)
- Maximum draft: 8.858 ft (2.7 m)
- Hull configuration: Full Displacement
- Category: motor yacht
- Sub-category: expedition yacht
- Hull material: steel
- Deck material: Steel
- Gross tonnage: 489
- Engines: 2 x CAT
- Fuel type: Diesel
- Cruising speed: 12.5 kn (14.38 mph)
- Maximum speed: 15 kn (17.26 mph)
- Accommodations: 14
- Sleeps: 9
- Heads: 8
- Crew cabins: 5
- Crew beds: 10
- Fuel capacity: 21,133.76 gal
- Fresh water capacity: 3,170.06 gal
- Hull designer: Floating Life - ZeroTredici Naval Designer
- Interior designer: Floating Life - Satura Studio

Pricing and Ordering

Current pricing and delivery timelines are available on request. For inquiries about purchasing, sea trials, inspections or negotiating an acquisition of the FL42 by CUSTOM, reach out to Andrey Shestakov and the Shestakov Yacht

Sales team for confidential assistance and transaction planning.

Questions and Answers

Q: What type of yacht is the FL42? A: It is a **motor yacht** arranged as an **expedition yacht** built on a **steel hull** with a **full-displacement** hull form.

Q: What are the **speed** figures? A: The FL42 is specified to cruise at **12.5 kn (14.38 mph)** with a **maximum speed** of **15 kn (17.26 mph)** .

Q: How many people can it accommodate? A: The yacht provides **accommodations for 14** , with **9 sleeps** and **8 heads** ; the dedicated **crew** quarters include **5 cabins** housing **10 beds** .

Q: Who are the **designers** and the **builder** ? A: The vessel is built by CUSTOM, with hull design by Floating Life - ZeroTredici Naval Designer and interior design by Floating Life - Satura Studio.

Q: How much **fuel** and **fresh water** can it carry? A: Fuel capacity is **21,133.76 gal** and fresh water capacity is **3,170.06 gal** . For up-to-date availability, contact Andrey Shestakov at Shestakov Yacht Sales.

Owner Experience Review

Buyers considering the FL42 from CUSTOM will note the project's primary focus on long-range capability and seakeeping. Marketing materials portray it as an expedition, displacement platform with an approximate project range near 5,000 nautical miles, intended for true ocean crossings and prolonged itineraries rather than short coastal hops.

Onboard arrangements emphasized in press releases and broker decks lean toward privacy and guest comfort: a full beam owner's suite, four en suite guest staterooms (configured as two doubles and two twins), an expansive

main-deck salon and a substantial beach club serving the lower deck. Extensive outdoor living zones—wraparound promenades, a sundeck lounge and optional fold-out owner-suite balconies—underscore the “owner’s deck/owner’s condo” concept.

As a new or custom project listed for 2025, there is limited independent sea-trial data, long-term operating histories or comprehensive owner-handling feedback for the FL42. Published figures and commentary remain primarily spec- and press-driven. One recurring design detail mentioned is the “under lower deck” repositioned engine room to liberate guest volume, a choice that can affect maintenance access and service planning. Fractional and managed-ownership options have been promoted, though model-specific long-term operating costs and precise crew-sizing analyses are not yet widely documented.

Pros and Cons

- Projected ~5,000 nm range supports true ocean crossing, expedition itineraries.
- Flexible layouts with full beam owner suite, four en suite guest cabins, and a large beach club favor private family cruising and entertaining.
- Fractional/managed ownership pathways are available for shared usage and operational support.
- Independent sea trial reports and owner handling feedback for FL42 are currently scarce.
- Performance figures, including cruise and top speed, are not widely published for this model.
- The “under lower deck” engine room configuration may complicate service access and maintenance planning.

Comparison with Other Models

Model	LOA	Beam	Draft	Speed (Cruising/Max)	Gross Tonnage
FL42	139' 0" (42.60 m)	30' 0" (9.40 m)	8' 10" (2.70 m)	12.5 kn / 15 kn	489
3 Masted Schooner	167' 0" (50.90 m)	32' 0" (9.75 m)	30' 11" (9.42 m) – 59' 1" (18 m)	9 kn	
77ft Custom Norlin Cutter Sloop	76' 0" (23.34 m)	18' 0" (5.59 m)	28' 12" (8.83 m)	8 kn / 11 kn	
Floe Craft Afina 3950	39' 0" (11.89 m)	11' 0" (3.35 m)	5' 6" (1.67 m) – 9' 10" (3 m)		18500
51 Mini Super Yacht	51' 0" (15.54 m)	14' 0" (4.27 m)	11' 6" (3.50 m)	20 kn / 23 kn	
Benetti 105	106' 0" (32.50 m)	19' 0" (5.97 m)	8' 0" (2.44 m)	12 kn / 16 kn	109
170 Commercial Crew Boat	170' 0" (51.82 m)	30' 0" (9.14 m)	21' 1" (6.42 m)	22 kn / 24 kn	
Commercial LCU	119' 0" (36.30 m)	34' 0" (10.39 m)	9' 0" (2.75 m) – 17' 3" (5.25 m)		
PK50	164' 0" (50 m)	28' 0" (8.61 m)			487
Sports Cat 44	44' 0" (13.41 m)	14' 0" (4.27 m)	9' 10" (3 m)		

SPECIFICATIONS

LOA:

139' 0" (42.60 m)

Max Draft:

8' 10" (2.70 m)

Cruise Speed:

12.5 kn / 14.38 mph

Gross Tonnage:

489 Pounds

Fuel Capacity:

21133.76 Gallons

Sleeps:

9

Crew Cabin:

5

Hull Material:

Steel Yachts

Hull Configuration:

Full Displacement

Interior Designer:

Floating Life - Satura Studio

Engines:

2

Fuel Type:

Diesel

Beam:

30' 0" (9.40 m)

Max Speed:

15 kn / 17.26 mph

Water Capacity:

3170.06 Gallons

Total Heads:

8

Crew Berths:

10

Deck Material:

Steel

Hull Designer:

Floating Life - ZeroTredici Naval Designer

Manufacturer:

CAT

GALLERY









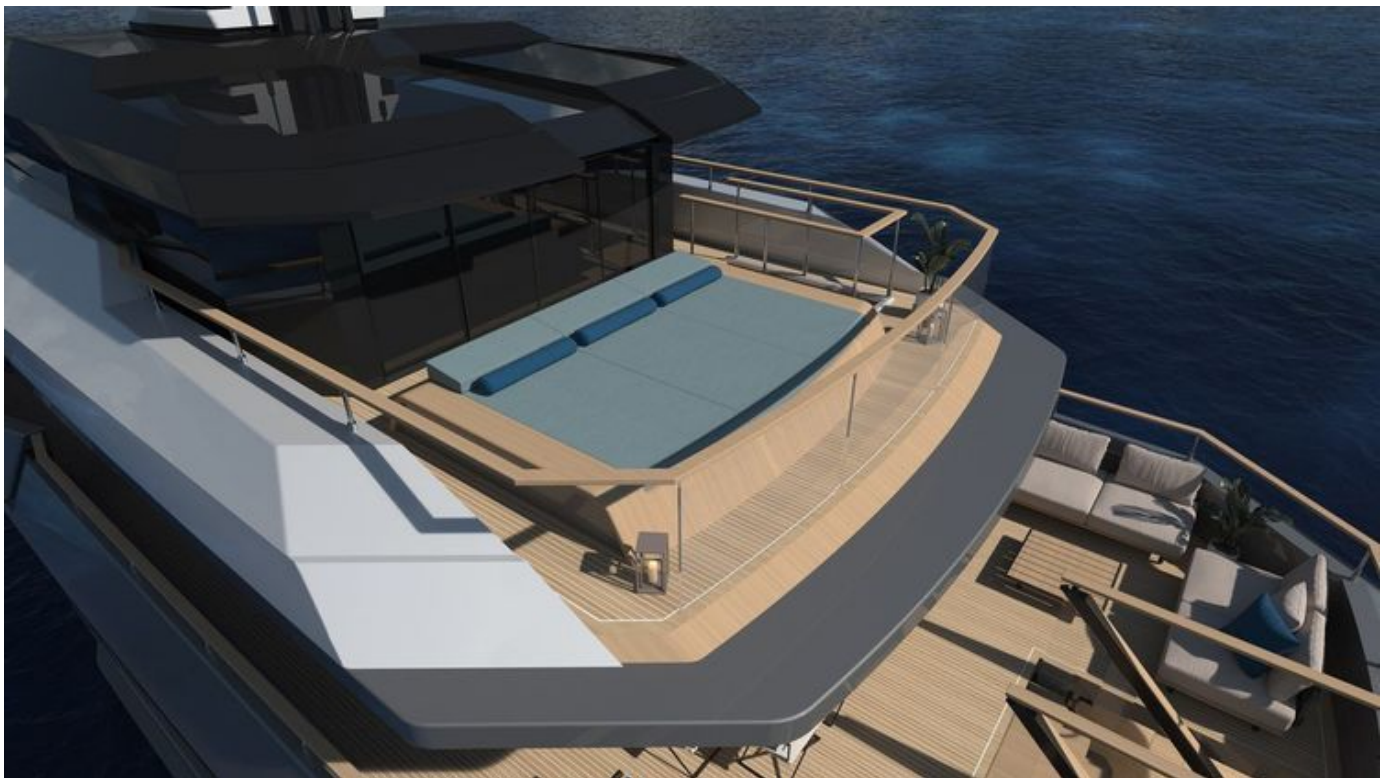

CONTACTS

Shestakov Yacht Sales is a brokerage company specializing in the sale and service of yachts worldwide. The company offers services for buying and selling both new and used motor yachts, sailing vessels, and luxury superyachts. They also provide yacht registration, insurance, technical maintenance, crew selection, and charter organization services across the U.S., Canada, Latin America, the Caribbean, and the Bahamas.

The founder and lead broker of the company is Andrey Shestakov, a licensed and certified expert with extensive experience in marine engineering and shipbuilding.

The company has an extensive network of partnerships with major yacht manufacturers worldwide and provides services in multiple languages, including Russian, Ukrainian, Spanish, and English. The office is in Dania Beach, Florida, USA.

For more information and to view available yachts, you can visit the company's official website: <https://shestakovyachtsales.com>

Contact details

Phone: +1(954)274-4435

Email: andrey@shestakovyachtsales.com

Address



1380 Weeping Willow Way, Hollywood,
Florida 33019