



SHESTAKOV

Yacht Sales

EXPLORER - INACE



Builder:

INACE

Model:

Explorer

LOA:

126' 0" (38.40 m)

Min Draft:

24' 1" (7.33 m)

Beam:

26' 0" (7.92 m)

Max Draft:

26' 3" (8 m)

Cruise Speed:

11 kn / 12.66 mph

Max Speed:

13 kn / 14.96 mph

Water Capacity:

2300 Gallons

Fuel Capacity:

16300 Gallons

Sleeps:

9

Total Heads:

8

If you would like to buy a yacht **EXPLORER - INACE** or would like help, please call +1(954)274-4435 or visit shestakovyachtsales.com

TABLE OF CONTENTS

| | |
|---|-----------|
| OVERVIEW | 3 |
| Selecting a Explorer | 3 |
| Features of the Model | 3 |
| Technical Specifications | 4 |
| Pricing and Ordering | 5 |
| Questions and Answers | 5 |
| Owner Experience Review | 5 |
| Pros and Cons | 6 |
| Comparison with Other Models | 7 |
| SPECIFICATIONS | 8 |
| GALLERY | 9 |
| CONTACTS | 14 |

OVERVIEW

Presented by Shestakov Yacht Sales, the Explorer from INACE is a motor yacht with an expedition profile designed for serious voyaging. Built on a steel hull and featuring a displacement hull with a bulbous bow, this 126 ft (38.4 m) vessel cruises efficiently at 11 knots (12.66 mph) and can reach up to 13 knots (14.96 mph).

Selecting a Explorer

Deciding on the right specification for the Explorer begins with defining your objectives. As both a bona fide expedition yacht and a capable motor yacht, it offers a measured equilibrium of comfort, carrying capacity, and fuel economy. Andrey Shestakov and the Shestakov Yacht Sales team will work with you to configure guest and crew accommodations, refine performance goals, and select interior finishes, coordinating closely with the builder to ensure the specification aligns with the model's proven capabilities.

Features of the Model

- Robust construction: a steel hull with matching steel decks and a displacement form featuring a bulbous bow engineered for long-range passagemaking.
- Dependable propulsion: driven by a single Caterpillar inboard diesel engine, with an 11-knot cruising speed and a 13-knot maximum (12.66 / 14.96 mph).
- Thoughtful layout: rated for 12 accommodations, providing sleeping arrangements for 9 and 8 onboard heads for guest convenience.
- Professional crew spaces: four dedicated crew cabins offering a total of 7 berths to support extended missions.
- Designed interiors: interiors conceived by Luiz Debasto to deliver a refined

onboard aesthetic and functionality.

- Dimensions that deliver volume and stability: LOA 126 ft (38.4 m), beam 26 ft (7.92 m), with draft spanning from a minimum of 24.059 ft (7.3333 m) to a maximum of 26.247 ft (8 m).
- Enduring capacities: substantial tankage including 16,300 gal of fuel and 2,300 gal of fresh water.

Technical Specifications

- Model: Explorer
- Builder: INACE
- Type: motor yacht
- Subcategory: expedition yacht
- Hull category: steel yacht
- LOA: 126 ft (38.4 m)
- Beam: 26 ft (7.92 m)
- Draft (min): 24.059 ft (7.3333 m)
- Draft (max): 26.247 ft (8 m)
- Speed (cruise): 11 kn (12.66 mph)
- Speed (max): 13 kn (14.96 mph)
- Engines: 1 x Caterpillar, Inboard, Diesel
- Hull configuration: Displacement w Bulbous Bow
- Deck material: Steel
- Interior designer: Luiz Debasto
- Accommodations: 12
- Sleeps: 9
- Heads: 8
- Crew cabins: 4
- Crew beds: 7
- Fuel capacity: 16300 gal

- Water capacity: 2300 gal

Pricing and Ordering

To obtain current pricing, check availability, or receive guidance on building and outfitting the Explorer by INACE, please contact Andrey Shestakov at Shestakov Yacht Sales. Our brokerage team will align your mission profile with what this expedition yacht and motor yacht platform can deliver, and handle paperwork, surveys, and delivery logistics on your behalf.

Questions and Answers

- What are the **cruising** and **maximum speeds** of the Explorer? Cruising speed is **11 knots** (12.66 mph) and the yacht's top speed is **13 knots** (14.96 mph).
- What are the yacht's **dimensions** and **drafts** ? Overall length is **126 ft (38.4 m)** , beam is **26 ft (7.92 m)** , and draft varies from **24.059 ft (7.3333 m)** up to **26.247 ft (8 m)** .
- What **engine** powers this motor yacht? Propulsion is provided by a single **Caterpillar inboard diesel** engine.
- How many **accommodations** , **sleeps** , and **crew** spaces are on board? The layout includes **12 accommodations** , berthing for **9** guests, and **8 heads** ; crew quarters comprise **4 cabins** with **7 beds** total.
- What is the **hull and deck construction** , and **hull form** ? Construction includes a steel hull with **steel decks** , configured as a **Displacement w Bulbous Bow** .

Owner Experience Review

Owners and captains characterize the Explorer from INACE as a genuine long-range expedition platform. Multiple Atlantic crossings have been

completed, some programs report logged mileage exceeding 75,000 miles, and one hull was noted as among the most active charter yachts in the Mediterranean in 2008. An independent sea trial recorded a composed and comfortable motion when the yacht was beam-to in short, steep seas off Fortaleza. Real-world listings and operator feedback generally position the vessel's performance within efficient displacement norms, often cited around a 10-knot cruise with roughly 12 knots top-end.

Aboard, crews frequently highlight the vessel's vast internal volume and the sense of being on a larger yacht, with common arrangements featuring a full-beam master, below-deck guest staterooms, and a full-beam galley; both pilothouse and raised-pilothouse configurations are found. Several refits have specifically targeted reduced noise and vibration in guest zones, with owners reporting tangible gains. Forum commentary is mixed on seakeeping, with at least one captain reporting pronounced heel and a tendency to wallow in certain conditions. Maintenance commentary skews positive regarding straightforward engineering and heavy-duty systems laid out for in-vessel servicing; steel hulls are lauded for easier repairs in remote locations, while aluminum examples require diligent isolation of dissimilar metals and rigorous corrosion protection to control lifecycle costs. For liveaboard living, extended world cruising, or charter operations, the Explorer rewards disciplined upkeep and careful payload management.

Pros and Cons

- Proven long-range capability with documented multiple Atlantic crossings and programs reporting 75,000+ miles.
- Exceptional internal volume with full-beam master, galley, and guest arrangements that suit liveaboard and charter roles.
- Efficient displacement performance, typically around a 10-knot cruise and approximately 12 knots at top, with trials noting comfortable motion in some

sea states.

- Seakeeping reports are mixed; at least one captain has described excessive heel and wallowing in particular conditions.
- Aluminum versions can demand intensive maintenance unless dissimilar metal isolation and corrosion protection are strictly observed.
- Addressing noise and vibration to meet contemporary comfort standards may require targeted refit work.

Comparison with Other Models

| Model | LOA | Beam | Draft | Speed (Cruising/Max) | Gross Tonnage |
|-------------------|-------------------|-----------------|-----------------------------------|----------------------|---------------|
| Explorer | 126' 0" (38.40 m) | 26' 0" (7.92 m) | 24' 1" (7.33 m) – 26' 3" (8 m) | 11 kn / 13 kn | |
| Explora 131 | 131' 0" (39.93 m) | 27' 0" (8.36 m) | 23' 9" (7.25 m) | 10 kn / 12 kn | 350 |
| Aventura 130 | 130' 0" (39.62 m) | 27' 0" (8.50 m) | 22' 12" (7 m) – 26' 3" (8 m) | 10 kn / 12 kn | 460 |
| FHI 90 | 90' 0" (27.41 m) | | | 10 kn / 13 kn | 230 |
| Explora 135 | 134' 0" (40.87 m) | 27' 0" (8.23 m) | 27' 1" (8.25 m) | 10 kn / 14 kn | 390 |
| Explora 145 | 145' 0" (44.20 m) | 30' 0" (9.14 m) | 22' 12" (7 m) | 10 kn / 12 kn | 499 |
| Explora 90 | 90' 0" (27.43 m) | 23' 0" (7.01 m) | 21' 4" (6.50 m) – 22' 12" (7 m) | 10 kn / 13 kn | 138 |
| Aventura 164 | 164' 0" (49.99 m) | 30' 0" (9.20 m) | 21' 4" (6.50 m) – 23' 7" (7.20 m) | 11 kn / 13 kn | 498 |
| INACE EXPLORER 80 | 78' 0" (23.90 m) | | 6' 11" (2.10 m) | | |
| Explorer 105 | 105' 0" (32.28 m) | 23' 0" (7.14 m) | 25' 2" (7.67 m) | 10 kn / 13 kn | 230 |

SPECIFICATIONS

LOA:

126' 0" (38.40 m)

Beam:

26' 0" (7.92 m)

Cruise Speed:

11 kn / 12.66 mph

Water Capacity:

2300 Gallons

Sleeps:

9

Crew Cabin:

4

Hull Material:

Steel Yachts

Hull Configuration:

Displacement w Bulbous Bow

Engines:

1

Engine Type:

Inboard

Min Draft:

24' 1" (7.33 m)

Max Draft:

26' 3" (8 m)

Max Speed:

13 kn / 14.96 mph

Fuel Capacity:

16300 Gallons

Total Heads:

8

Crew Berths:

7

Deck Material:

Steel

Interior Designer:

Luiz Debasto

Manufacturer:

Caterpillar

Fuel Type:

Diesel

GALLERY

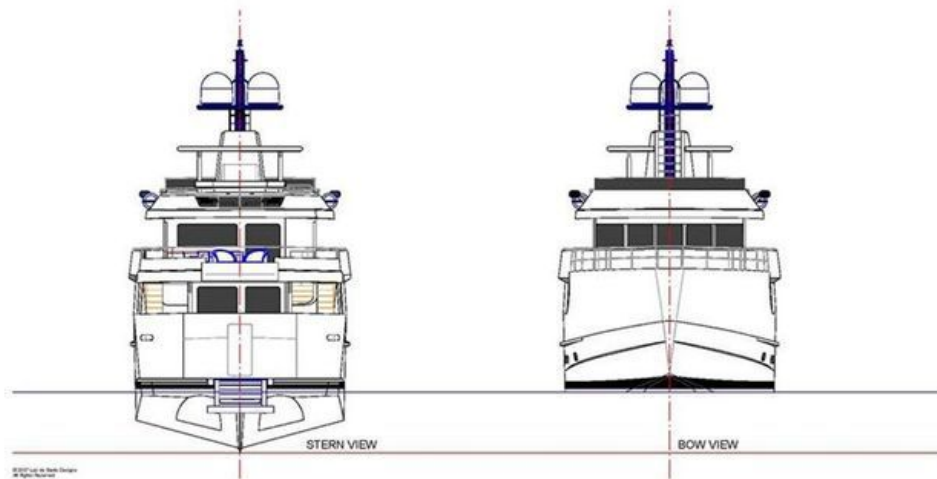

INACE 126'
LUXORIBASTO



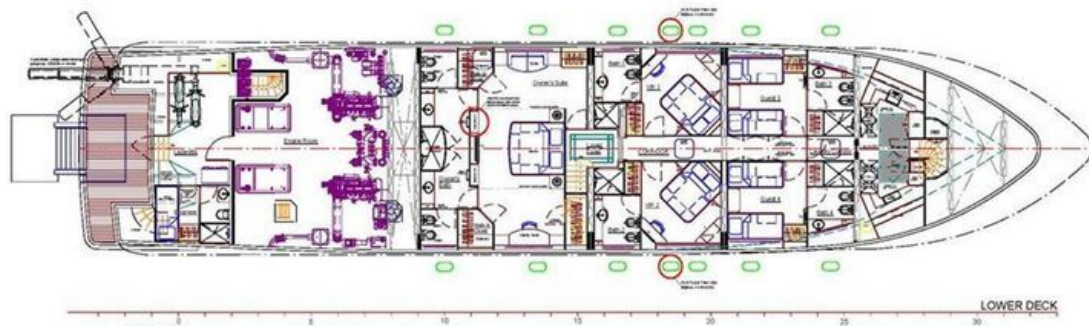

INACE 126'

LUXDEBASTO
LUXURY YACHTS

NOTE:
- VSP1 and VSP2 has been changed according to the new layout.
- An portlight in the VSP1 and VSP2 has been moved forward for 500mm.
- A Dockchair has been installed in the Owner's Suite, moving forward for 200mm the 4 door to the Owner's Bathroom.



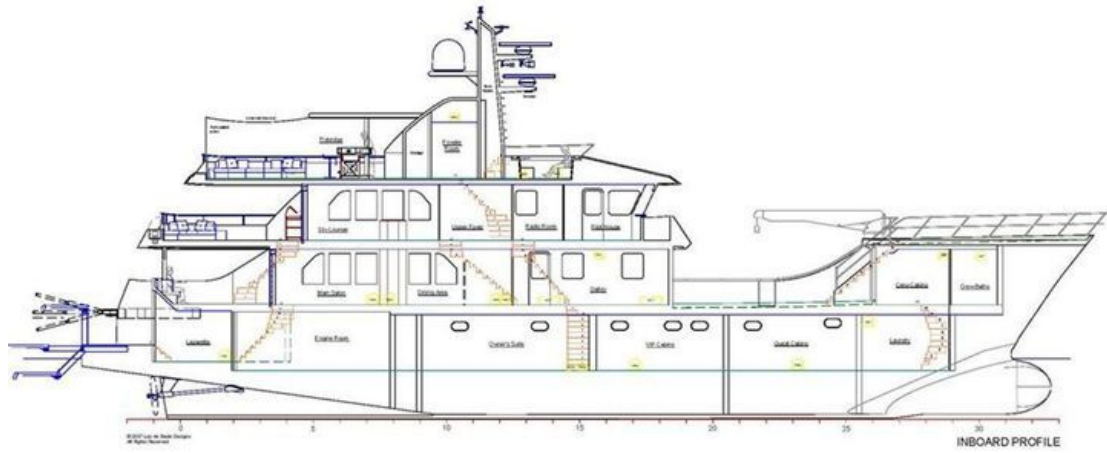

INACE 126'
LUXDEBASTO







CONTACTS

Shestakov Yacht Sales is a brokerage company specializing in the sale and service of yachts worldwide. The company offers services for buying and selling both new and used motor yachts, sailing vessels, and luxury superyachts. They also provide yacht registration, insurance, technical maintenance, crew selection, and charter organization services across the U.S., Canada, Latin America, the Caribbean, and the Bahamas.

The founder and lead broker of the company is Andrey Shestakov, a licensed and certified expert with extensive experience in marine engineering and shipbuilding.

The company has an extensive network of partnerships with major yacht manufacturers worldwide and provides services in multiple languages, including Russian, Ukrainian, Spanish, and English. The office is in Dania Beach, Florida, USA.

For more information and to view available yachts, you can visit the company's official website: <https://shestakovyachtsales.com>

Contact details

Phone: +1(954)274-4435

Email: andrey@shestakovyachtsales.com

Address



1380 Weeping Willow Way, Hollywood,
Florida 33019