



SHESTAKOV

Yacht Sales

EXPLORER 34MT - OCEAN KING



Builder:

OCEAN KING

Model:

Explorer 34MT

LOA:

112' 0" (34.14 m)

Beam:

25' 0" (7.80 m)

Max Draft:

80' 11" (24.67 m)

Cruise Speed:

12 kn / 13.81 mph

Max Speed:

13 kn / 14.96 mph

Water Capacity:

3170 Gallons

Fuel Capacity:

11889 Gallons

Total Heads:

8

Crew Cabin:

3

Hull Material:

Steel Yachts

If you would like to buy a yacht **EXPLORER 34MT - OCEAN KING** or would like help, please call +1(954)274-4435 or visit shestakovyachtsales.com

TABLE OF CONTENTS

OVERVIEW	3
Selecting a Explorer 34MT	3
Features of the Model	3
Technical Specifications	4
Pricing and Ordering	4
Questions and Answers	5
Owner Experience Review	5
Pros and Cons	6
Comparison with Other Models	7
SPECIFICATIONS	8
GALLERY	9
CONTACTS	14

OVERVIEW

The Explorer 34MT from OCEAN KING is a motor yacht in the motor yachts category, constructed on a steel hull with steel decking. Measuring 112 ft (34.14 m) overall with a 25 ft (7.8 m) beam, it maintains a cruising pace of 12 knots (13.81 mph) and can host up to 10 guests. The vessel is presented by Andrey Shestakov and the team at Shestakov Yacht Sales.

Selecting a Explorer 34MT

Opt for the Explorer 34MT if you prioritize the durability of a steel hull, the simplicity and dependability of twin inboard diesel propulsion, and the spaciousness afforded by a 112 ft platform with a 25 ft beam. As a motor yacht within the wider motor yachts segment, it combines comfortable living spaces with moderate passagemaking speeds. For tailored advice on whether this model fits your cruising profile and to check availability, contact Andrey Shestakov at Shestakov Yacht Sales.

Features of the Model

- Robust steel hull construction complemented by steel decks for confident offshore operation.
- Twin inboard [[engine]] diesels by Caterpillar, chosen for ease of serviceability and proven reliability.
- Interior arrangement designed to accommodate up to 10 guests, supported by 8 heads and 3 crew cabins.
- Substantial range capability enabled by 11,889 gal of fuel capacity and 3,170 gal of freshwater storage for extended cruising.
- Practical performance envelope with a 12-knot cruising speed and a 13-knot top speed (13.81/14.96 mph).

Technical Specifications

- Model: Explorer 34MT
- Builder: OCEAN KING
- Category: motor yachts
- Subcategory: motor yacht
- Hull: steel
- Deck material: Steel
- LOA: 112 ft (34.14 m)
- Beam: 25 ft (7.8 m)
- Max draft: 80.938 ft (24.67 m)
- Engines: 2 x Caterpillar, Inboard, Diesel
- Cruising speed: 12 kn (13.81 mph)
- Maximum speed: 13 kn (14.96 mph)
- Fuel capacity: 11,889 gal
- Water capacity: 3,170 gal
- Accommodations: 10
- Heads: 8
- Crew cabins: 3

Pricing and Ordering

Pricing and stock information for the Explorer 34MT are available upon request. To review current offerings, arrange viewings, or plan a purchase, please reach out to Andrey Shestakov at Shestakov Yacht Sales. Our brokerage team will assist with inspections, negotiations, contract paperwork, and delivery logistics from initial offer through handover.

Questions and Answers

Q: What type of yacht is the Explorer 34MT? A: It is a motor yacht in the motor yachts segment, manufactured by OCEAN KING.

Q: Does it have a steel hull? A: Yes. The Explorer 34MT is constructed with a steel hull and fitted with steel decks to enhance longevity and ease of maintenance.

Q: What powers the yacht and how fast does it go? A: The Explorer 34MT is propelled by two inboard, **Caterpillar diesel** engines. You can anticipate a **cruising speed** of 12 knots (13.81 mph) and a **maximum speed** of 13 knots (14.96 mph).

Q: How many guests and crew can it accommodate? A: The layout supports **up to 10 guests** , and includes **8 heads** along with **3 crew cabins** to facilitate longer passages.

Q: How can I purchase or get pricing for the Explorer 34MT? A: Contact **Andrey Shestakov** at **Shestakov Yacht Sales** for the latest pricing, availability information, and to set up surveys, inspections, and offers.

Owner Experience Review

Buyers attracted to dependability and offshore capability will note that the OCEAN KING Explorer 34MT was designed for ambitious, long-distance itineraries and debuted publicly at the Monaco Yacht Show 2025. Industry commentary references a transoceanic endurance of roughly 4,000 nautical miles at 10 knots, and its full-displacement steel hull with a bulbous bow behaves more like a commercial ship-yacht hybrid, favoring sea-keeping and crew/passenger comfort above speed. Expect a deliberate cadence underway—approximately 12 knots in normal cruising with a top-end near 13

knots—paired with the composed motion characteristic of commercial-style hulls.

Life aboard is geared toward extended voyages: a five-stateroom configuration anchored by a roomy master suite and a sweeping saloon benefits from unusually generous internal volume. The finish palette has been labeled “New Brutalism,” utilizing industrial elements such as metal meshes and cement-like surfaces, with a rigid geometric grid organizing the spaces. Functionality is evident throughout—the large tankage, dedicated crew accommodations sized for an estimated three to five personnel, and a tender/toys platform that flows into multiple outdoor living areas including an aft terrace, sun deck, and flybridge—making the yacht suitable for owner-operated or fully crewed programs.

Because the model was unveiled in October 2025, long-term owner feedback remains limited. Owners should anticipate standard upkeep for large steel vessels, including regular corrosion control and cyclical paint/antifouling maintenance. High-power diesel options from Caterpillar or MAN come with extensive global support networks but also carry the heavier scheduled servicing typical of such engines. To date, published coverage has not reported any owner-verified engine failures.

Pros and Cons

- Full-displacement steel hull with a bulbous bow provides stable, comfortable ocean passages.
- Transoceanic capability in the neighborhood of 4,000 nm at 10 knots supports genuine long-range cruising plans.
- Five-stateroom layout, large tankage, and spacious crew/service zones are well suited to extended stays aboard.
- Modest performance—around a 12-knot cruise and 13-knot top speed—will

disappoint buyers seeking higher speeds.

- Steel construction and substantial diesel powerplants require routine corrosion management and entail higher scheduled maintenance costs.
- Real-world owner reports are sparse because the model was only revealed and shown in 2025.

Comparison with Other Models

Model	LOA	Beam	Draft	Speed (Cruising/Max)	Gross Tonnage
Ducale 120	119' 0" (36.25 m)	27' 0" (8.50 m)	8' 2" (2.49 m)	12.5 kn / 14 kn	358
Explorer 34MT	112' 0" (34.14 m)	25' 0" (7.80 m)	8' 11" (2.67 m)	12 kn / 13 kn	
N/A	163' 0" (49.85 m)	29' 0" (9 m)	7' 9" (2.35 m)	14 kn / 16 kn	499

SPECIFICATIONS

LOA:

112' 0" (34.14 m)

Max Draft:

80' 11" (24.67 m)

Cruise Speed:

12 kn / 13.81 mph

Water Capacity:

3170 Gallons

Total Heads:

8

Hull Material:

Steel Yachts

Engines:

2

Engine Type:

Inboard

Beam:

25' 0" (7.80 m)

Max Speed:

13 kn / 14.96 mph

Fuel Capacity:

11889 Gallons

Crew Cabin:

3

Deck Material:

Steel

Manufacturer:

Caterpillar

Fuel Type:

Diesel

GALLERY





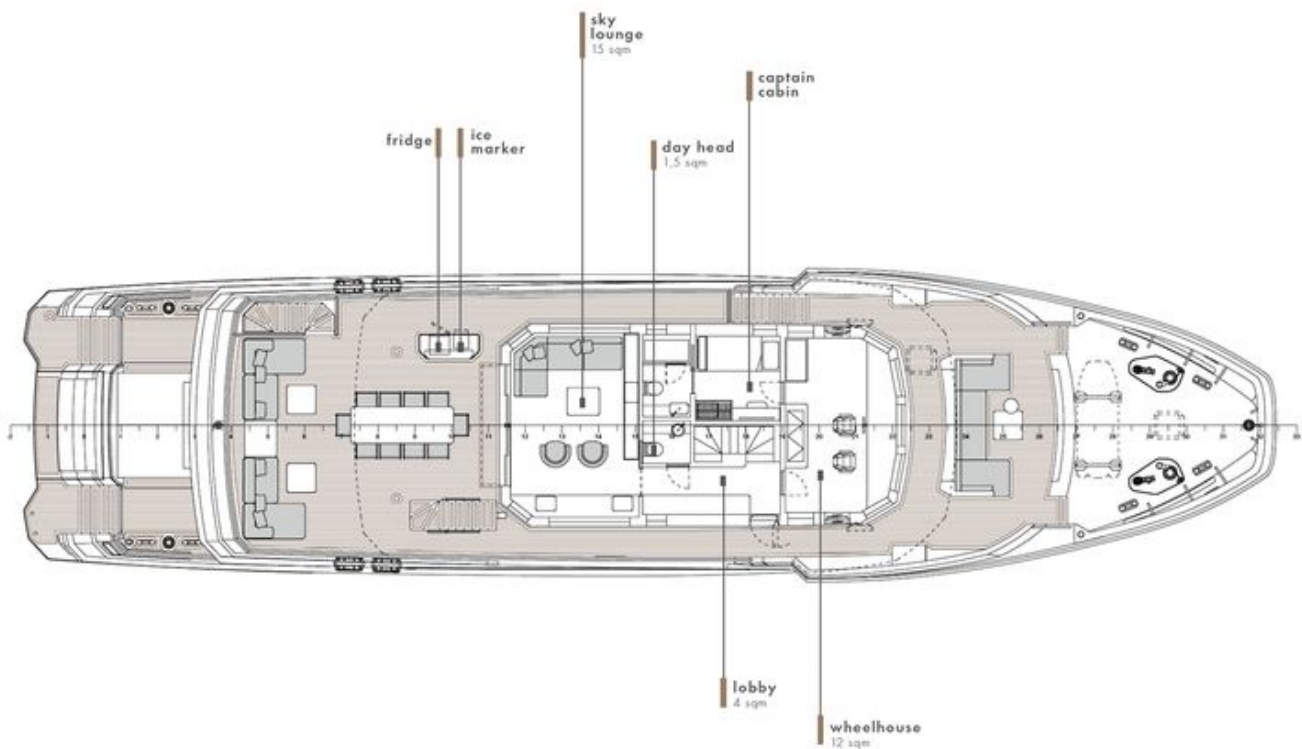

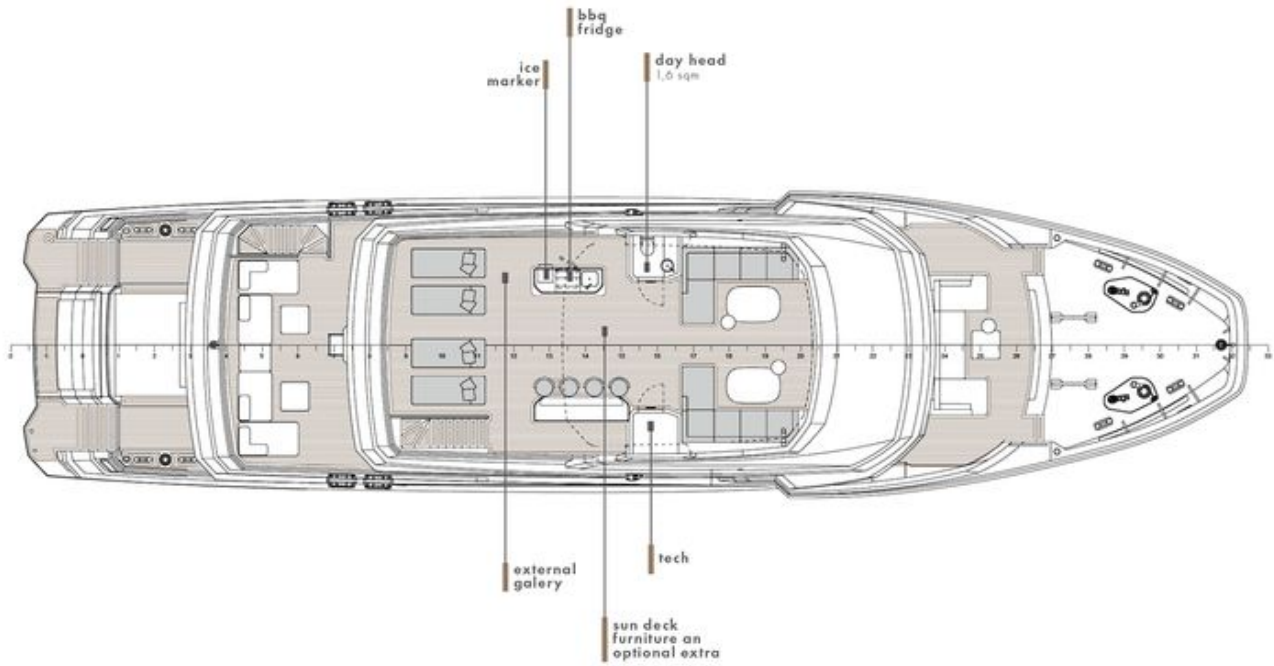

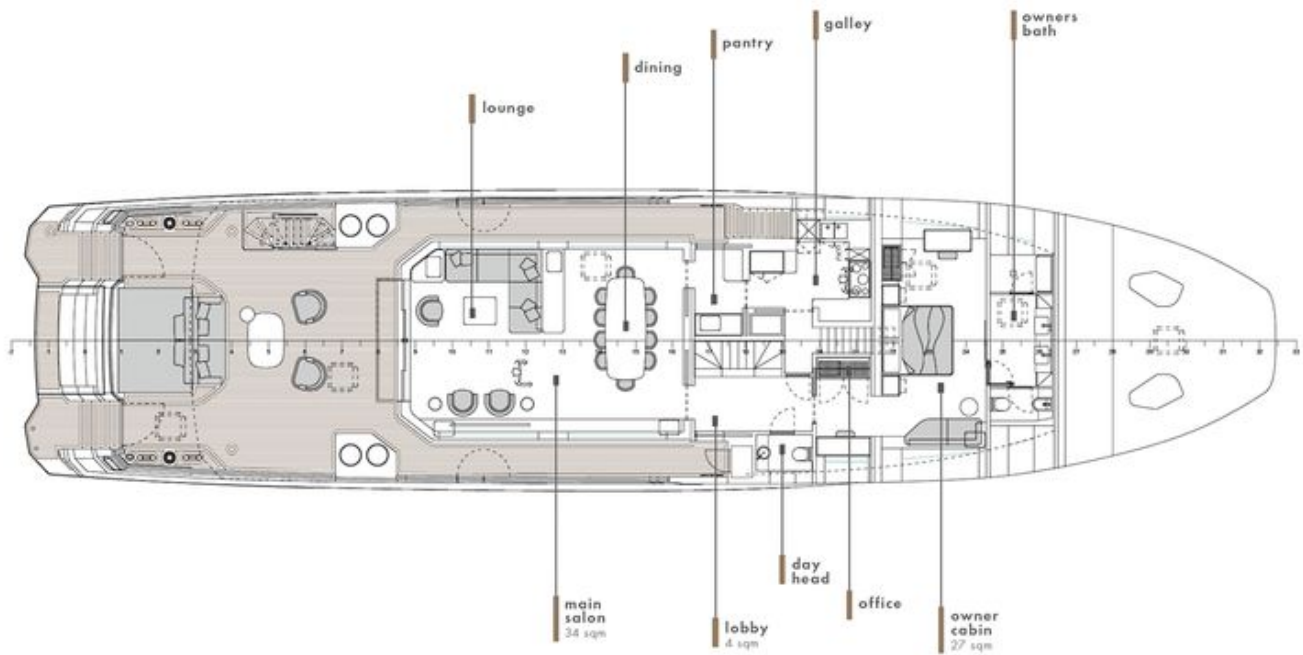
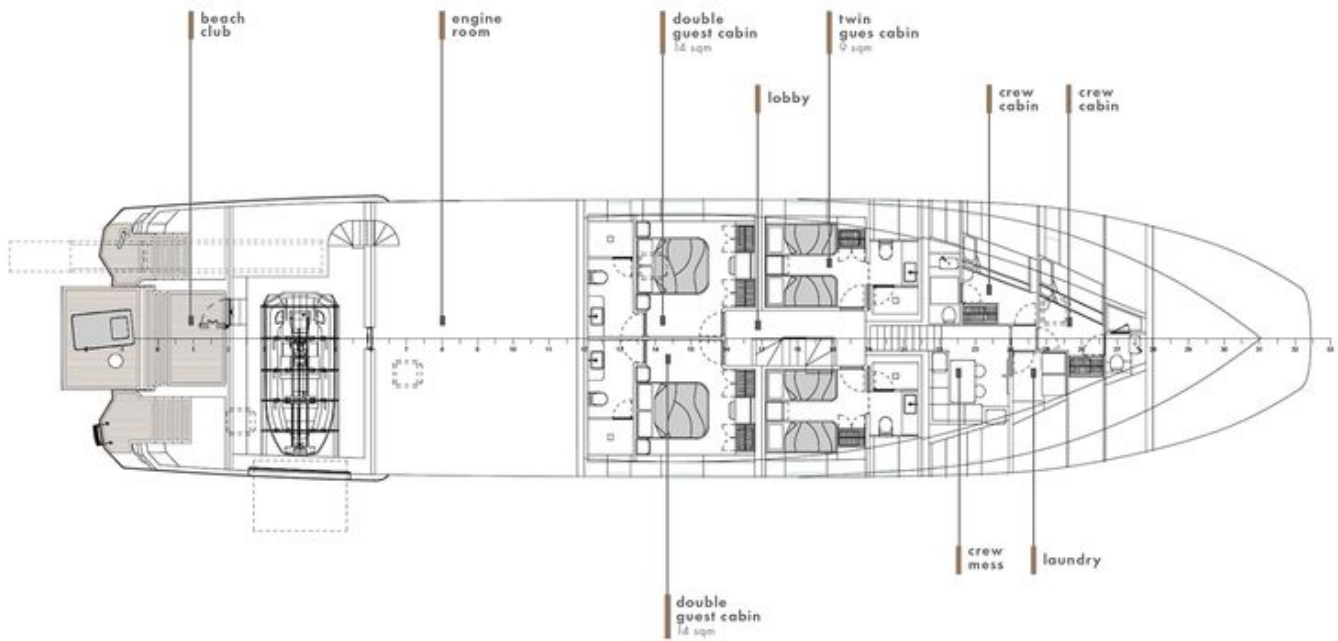

CONTACTS

Shestakov Yacht Sales is a brokerage company specializing in the sale and service of yachts worldwide. The company offers services for buying and selling both new and used motor yachts, sailing vessels, and luxury superyachts. They also provide yacht registration, insurance, technical maintenance, crew selection, and charter organization services across the U.S., Canada, Latin America, the Caribbean, and the Bahamas.

The founder and lead broker of the company is Andrey Shestakov, a licensed and certified expert with extensive experience in marine engineering and shipbuilding.

The company has an extensive network of partnerships with major yacht manufacturers worldwide and provides services in multiple languages, including Russian, Ukrainian, Spanish, and English. The office is in Dania Beach, Florida, USA.

For more information and to view available yachts, you can visit the company's official website: <https://shestakovyachtsales.com>

Contact details

Phone: +1(954)274-4435

Email: andrey@shestakovyachtsales.com

Address



1380 Weeping Willow Way, Hollywood,
Florida 33019