



SHESTAKOV

Yacht Sales

## E60 – PARDO YACHTS



**Builder:**

PARDO YACHTS

**Model:**

E60

**LOA:**

60' 0" (18.29 m)

**Beam:**

16' 0" (5.06 m)

**Max Draft:**

12' 4" (3.75 m)

**Fuel Capacity:**

660 Gallons

**Hull Material:**

Fiberglass and Plastic Yachts

**Deck Material:**

Fiberglass

**Engines:**

2

**Manufacturer:**

Volvo Penta

**Engine Type:**

Inboard

**Fuel Type:**

Diesel

If you would like to buy a yacht **E60 – PARDO YACHTS** or would like help, please call +1(954)274-4435 or visit [shestakovyachtsales.com](http://shestakovyachtsales.com)

---

# TABLE OF CONTENTS

---

|   |           |
|---|-----------|
| <b>OVERVIEW .....</b>                     | <b>3</b>  |
| <b>Selecting an E60 .....</b>             | <b>3</b>  |
| <b>Features of the Model .....</b>        | <b>3</b>  |
| <b>Technical Specifications .....</b>     | <b>4</b>  |
| <b>Pricing and Ordering .....</b>         | <b>4</b>  |
| <b>Questions and Answers .....</b>        | <b>4</b>  |
| <b>Owner Experience Review .....</b>      | <b>5</b>  |
| <b>Pros and Cons .....</b>                | <b>6</b>  |
| <b>Comparison with Other Models .....</b> | <b>6</b>  |
| <b>SPECIFICATIONS .....</b>               | <b>8</b>  |
| <b>GALLERY .....</b>                      | <b>9</b>  |
| <b>CONTACTS .....</b>                     | <b>14</b> |

## OVERVIEW

---

The E60 from PARDO YACHTS is a modern motor yacht crafted for confident, comfortable cruising and built within the fiberglass and plastic class. Measuring 60 ft (18.29 m) overall with a 16 ft (5.06 m) beam and powered by twin Volvo Penta diesel inboards, it strikes a balance between performance, space, and on-board refinement for owners seeking a sophisticated 60-foot platform. Shestakov Yacht Sales, led by Andrey Shestakov, is available to assist you from initial inquiry through final closing.

## Selecting an E60

---

Opting for the E60 prioritizes a reliable twin-engine inboard arrangement and the durability associated with the fiberglass and plastic category. If your brief specifies a 60-foot motor yacht with diesel inboards, substantial fuel capacity, and a fiberglass deck, this model warrants careful consideration. Collaborate with Shestakov Yacht Sales and Andrey Shestakov to match the yacht's specifications and delivery timeline to your cruising plans.

## Features of the Model

---

- **Twin inboard propulsion:** Equipped with 2 x Volvo Penta diesel engines, this layout delivers dependable, maintainable power for a vessel of this scale.
- **Efficient footprint:** The 60 ft LOA combined with a 16 ft beam produces balanced proportions suitable for both cruising performance and practical berthing.
- **Robust construction:** Classified within the fiberglass and plastic segment, the yacht features a fiberglass deck for long-term durability and reduced upkeep.
- **Capable draft:** A maximum draft of 12.303 ft (3.75 m) contributes to steady handling and seakeeping in a variety of conditions.

- Range minded fuel capacity: With 660 gallons of fuel, the E60 supports extended passages and greater itinerary flexibility, dependent on load and sea state.

## Technical Specifications

---

- Model: E60
- Builder: PARDO YACHTS
- Category: motor yacht
- Hull category: fiberglass and plastic
- LOA: 60 ft (18.29 m)
- Beam: 16 ft (5.06 m)
- Max Draft: 12.303 ft (3.75 m)
- Engines: 2 x Volvo Penta, Inboard, Diesel
- Fuel Capacity: 660 gal
- Deck Material: Fiberglass

## Pricing and Ordering

---

For up to date availability, pricing details, or to arrange a private showing of the E60, contact Shestakov Yacht Sales. Broker Andrey Shestakov will manage specification reviews, offer submission, inspection coordination, and the closing paperwork to ensure a smooth acquisition.

## Questions and Answers

---

Q: What is the category of the E60? A: It is a motor yacht built in the fiberglass and plastic class, reflecting its intended **design intent** and **construction** .

Q: Who builds the E60 and what are the **engines** ? A: The yacht is produced by

PARDO YACHTS, and propulsion is provided by 2 x **Volvo Penta diesel inboard** units.

Q: What are the key **dimensions** of the yacht? A: The E60 measures an **LOA** of 60 ft (18.29 m), a **beam** of 16 ft (5.06 m), and a **maximum draft** of 12.303 ft (3.75 m).

Q: What is the hull and **deck** composition? A: The hull is classified under the fiberglass and plastic category, while the **deck material** is fiberglass.

Q: How do I proceed with **pricing** and **purchase** ? A: Contact Shestakov Yacht Sales—broker **Andrey Shestakov** will supply current pricing and availability, and will guide you through offers, surveys, and the closing process for the E60.

## Owner Experience Review

---

Owners are drawn to the E60 from PARDO YACHTS for family coastal trips, extended cruising, owner operator weekends, and entertaining afloat. Launched in 2021 as an Endurance model and remaining in production into the mid 2020s, the design pairs a three cabin, multi head arrangement with a full beam owner's stateroom, generous storage, and comfortable headroom throughout. The galley aft layout, equipped with multiple coolers and under counter refrigeration plus well placed lockers, proves highly functional, while dual cockpits, fold down side terraces, and an adaptable flybridge expand social zones whether at anchor or underway.

When under way, reviewers note a composed, dry motion in light chop with minimal slamming and impressively low acoustic levels in the salon and at the helm. The hull feels most settled in the high teens up to about 20 knots, with peak speeds typically in the low to mid 20s (approximately 22–25 knots) depending on IPS selection; joystick controlled IPS operation delivers light, predictable handling for accurate close quarters maneuvering, favoring long,

steady passages over sharply sporty turns.

An aft crew cabin outfitted with two single berths and an en suite supports small crew passages or additional guests while preserving separate service access. Routine ownership often revolves around Volvo Penta D8 IPS700/800 maintenance: budget for pod oil, sacrificial anodes, and seal inspections with dealer authorized support, schedule an annual haul out and impeller checks, and verify service access during survey (notably fuel/water lines and strainers). Early handovers and purchase advice consistently recommend thorough pre delivery surveys. Broker listings and owner notes have even described the E60 as a "perfect gem with both performance and modern Euro ergonomic designs offering an unparalleled luxurious experience."

## Pros and Cons

- Composed, dry ride with low interior noise and a tranquil helm in light chop.
- Predictable IPS joystick control makes precise docking straightforward for owner operators.
- Family oriented layout with three cabins plus crew quarters, galley aft, and expansive decks featuring fold down terraces and a configurable flybridge.
- Pod drive maintenance and specialized components can be comparatively expensive; plan for annual haul outs and routine service.
- Optimized for long, steady passages rather than aggressive, high speed cornering.
- Service access varies by installation; surveys should confirm clear reach to fuel/water systems and strainers.

## Comparison with Other Models

| Model | LOA | Beam | Draft | Speed (Cruising/Max) | Gross Tonnage |
|-------|-----|------|-------|----------------------|---------------|
|-------|-----|------|-------|----------------------|---------------|

|               |                  |                 |                 |               |    |
|---------------|------------------|-----------------|-----------------|---------------|----|
| E60           | 60' 0" (18.29 m) | 16' 0" (5.06 m) | 12' 4" (3.75 m) |               |    |
| 43            | 46' 0" (14 m)    | 13' 0" (4.20 m) | 3' 5" (1.05 m)  |               |    |
| 50            | 53' 0" (16.15 m) | 15' 0" (4.57 m) | 13' 1" (4 m)    | 27 kn / 36 kn |    |
| PARDO 43      | 46' 0" (14 m)    | 13' 0" (4.20 m) | 3' 5" (1.05 m)  | 28 kn / 38 kn | 10 |
| 38            | 39' 0" (11.89 m) | 11' 0" (3.61 m) | 9' 7" (2.92 m)  |               |    |
| 43 Walkaround | 43' 0" (13.11 m) | 13' 0" (4.19 m) | 11' 3" (3.42 m) |               |    |
| PARDO 38      | 39' 0" (11.90 m) | 11' 0" (3.60 m) | 3' 5" (1.05 m)  | 35 kn / 40 kn |    |
| P50           | 50' 0" (15.24 m) | 16' 0" (4.95 m) | 13' 1" (4 m)    |               |    |
| GT 52         | 52' 0" (15.85 m) |                 |                 |               |    |
| P43           | 43' 0" (13.11 m) | 13' 0" (4.19 m) | 11' 3" (3.42 m) | 30 kn / 35 kn |    |

---

# SPECIFICATIONS

---

**LOA:**

60' 0" (18.29 m)

**Max Draft:**

12' 4" (3.75 m)

**Fuel Capacity:**

660 Gallons

**Hull Material:**

Fiberglass and Plastic Yachts

**Engines:**

2

**Engine Type:**

Inboard

**Beam:**

16' 0" (5.06 m)

**Deck Material:**

Fiberglass

**Manufacturer:**

Volvo Penta

**Fuel Type:**

Diesel

# GALLERY

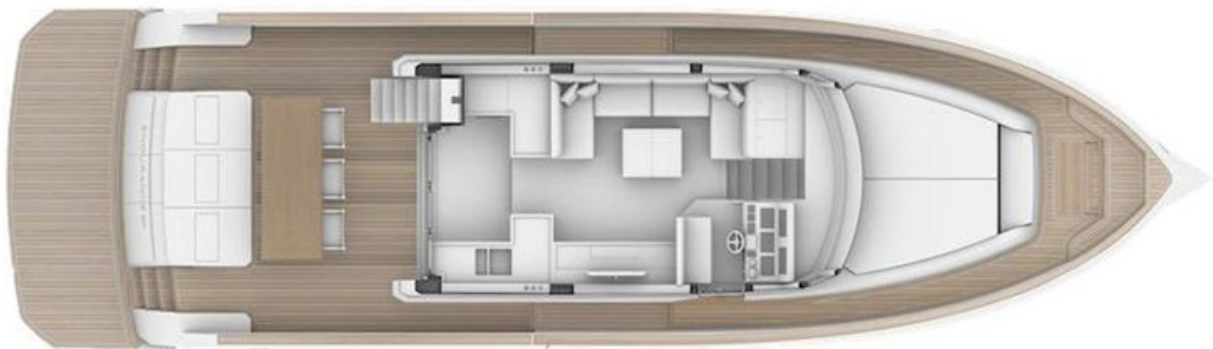
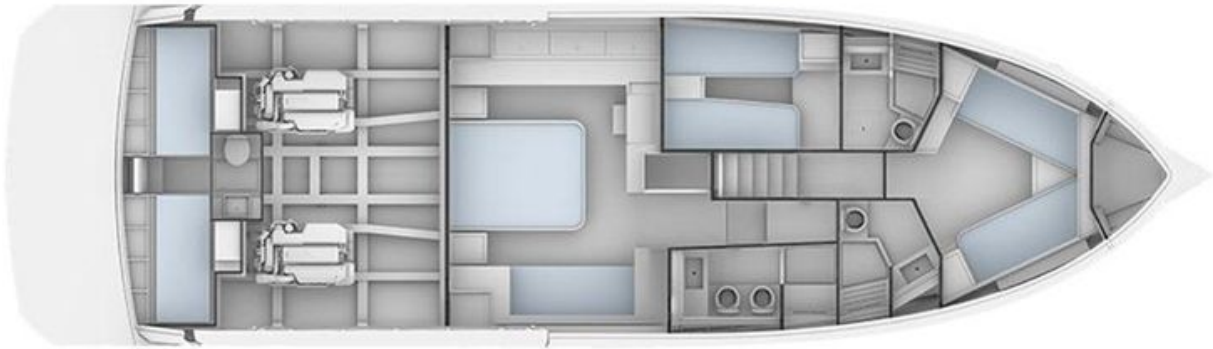
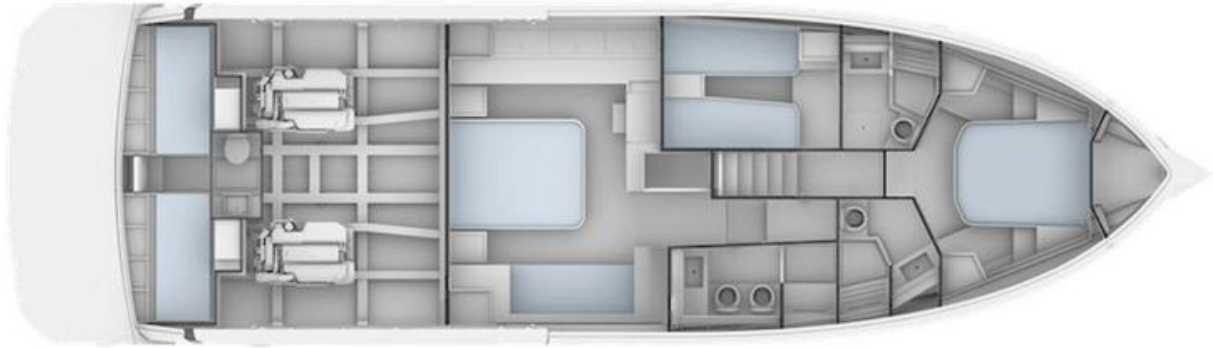









# CONTACTS

---

Shestakov Yacht Sales is a brokerage company specializing in the sale and service of yachts worldwide. The company offers services for buying and selling both new and used motor yachts, sailing vessels, and luxury superyachts. They also provide yacht registration, insurance, technical maintenance, crew selection, and charter organization services across the U.S., Canada, Latin America, the Caribbean, and the Bahamas.

The founder and lead broker of the company is Andrey Shestakov, a licensed and certified expert with extensive experience in marine engineering and shipbuilding.

The company has an extensive network of partnerships with major yacht manufacturers worldwide and provides services in multiple languages, including Russian, Ukrainian, Spanish, and English. The office is in Dania Beach, Florida, USA.

For more information and to view available yachts, you can visit the company's official website: <https://shestakovyachtsales.com>

## Contact details

---

**Phone:** +1(954)274-4435

**Email:** [andrey@shestakovyachtsales.com](mailto:andrey@shestakovyachtsales.com)

## Address

---



1380 Weeping Willow Way, Hollywood,  
Florida 33019