

## 2026 LAZZARA UHV 100 - LAZZARA



**Builder:** [Lazzara](#)

**LOA:** 100' 0" (30.48 m)

**Year Built:** 2025

**Max Draft:** 19' 8" (6 m)

**Model:** UHV 100

**Cruising Speed:** 12 Knots (13.81 MPH)

**Price:** - Subject to change.

[See full listing on our website](#)

**Location:** Antalya, Turkey

**Max Speed:** 16 Knots (18.41 MPH)

---

# TABLE OF CONTENTS

---

**OVERVIEW ..... 3**

**SPECIFICATIONS ..... 5**

    Basic Information ..... 5

    Dimensions ..... 5

    Speed, Capacities and Weight ..... 5

    Accommodations ..... 5

    Hull and Deck Information ..... 6

    Engine Information ..... 6

**GALLERY ..... 7**

**DETAILED DESCRIPTION ..... 13**

**CONTACTS ..... 19**

## OVERVIEW

---

Presenting the awe-inspiring 2025 Lazzara UHV 100, a vision of naval artistry and poise that unites cutting-edge innovation with timeless grace. This luxury motor yacht blends comprehensive amenities, adaptable living spaces, and refined styling so seamlessly that it becomes both a rarefied objet d'art and a supremely capable superyacht.

Carrying the distinguished Lazzara badge, the UHV 100 stands proudly within the brand's celebrated UHV series, a lineage defined by precision, artisan craftsmanship, and an unwavering devotion to excellence. As the latest expression of Lazzara's ethos, the UHV 100 underscores a commitment to lavish comfort, stellar performance, meticulous engineering, and an ocean-going experience that lingers long after you return to shore.

Measuring 100 feet in length—approximately 30.48 meters—this imposing yacht commands presence among motor yachts of her class, yet her generous volume never compromises elegance. Instead, she achieves a rare equilibrium of scale and style. From her raked bow to her graceful stern, the exterior reads as a single, fluid stroke, seemingly sculpted by the breeze and refined by light, where every line serves a purpose and every curve speaks of intent.

Beneath the beauty lies a hull form honed for poise and efficiency, conceived to marry visual drama with sophisticated hydrodynamics. The shape is engineered to part the sea with clean precision, reducing drag for enhanced economy and delivering a noticeably smoother ride. This refined platform, working in concert with her formidable twin engines, translates into confident cruising, assured handling, and an effortless sense of momentum in a wide range of conditions.

Step aboard and Lazzara's devotion to reliability and indulgence becomes unmistakable. Entering the UHV 100 is like crossing a threshold into a world of tailored serenity, where five expansive cabins host up to ten guests in

complete privacy. Every surface, material, and accent has been thoughtfully chosen, each placement deliberate, culminating in an interior ambience that radiates quiet sophistication and modern luxury.

The full beam master suite is an intimate sanctuary, a beautifully proportioned haven with a sumptuous ensuite and panoramic vistas to frame each morning and evening. Guest accommodations mirror this elevated standard, with ensuite bathrooms, supple linens, and plush furnishings that envelop you in comfort. Every cabin is a private retreat, executed with the precision of a boutique residence and the warmth of a five star escape.

When it's time to gather, the main salon and dining area unveil a versatile stage for entertaining. Soft seating invites relaxed conversation, while advanced entertainment systems heighten the onboard experience. The dining space, centered around a striking table, is designed for memorable meals under a canopy of seascape views, turning every course into a celebration of the journey itself.

Outdoors, the UHV 100 continues to delight. The sun deck is a dedicated haven for open air living, complete with a spa pool, a well appointed bar, generous lounge settings, and alfresco dining, all set against sweeping horizons. Aft, an expansive deck offers an idyllic perch for starlit suppers or golden hour cocktails, allowing each moment to be savored to the sound of the sea.

As a contemporary superyacht, the 2025 Lazzara UHV 100 harmonizes form and function with rare finesse. Her character reveals itself in the confident cadence of her progress, the precision of her navigation, and the enveloping comfort of her interiors. Whether embarking on a leisurely coastal cruise, settling into an extended passage, or hosting a spirited celebration at anchor, she elevates every occasion into an indelible chapter of life on the water.

In essence, the 2025 Lazzara UHV 100 is far more than a motor yacht; it is a floating sanctuary of refinement, a triumph of Lazzara craftsmanship, and a lyrical composition written upon the waves.

# SPECIFICATIONS

---

## Basic Information

---

**Model Year:**  
2026

**Country:**  
Turkey

**Year Built:**  
2025

## Dimensions

---

**LOA:**  
100' 0" (30.48 m)

**Max Draft:**  
19' 8" (6 m)

## Speed, Capacities and Weight

---

**Cruise Speed:**  
12 Knots (13.81 MPH)

**Water Capacity:**  
660 Gallons

**Max Speed:**  
16 Knots (18.41 MPH)

**Fuel Capacity:**  
1100 Gallons

## Accommodations

---

**Sleeps:**  
5

**Crew Cabin:**  
3

**Total Heads:**  
7

**Crew Berths:**  
6

## Hull and Deck Information

---

**Hull Material:**

Fiberglass and Plastic Yachts

**Hull Designer:**

Lazzara Design Team

**Deck Material:**

Epoxy Composite

**Interior Designer:**

Lazzara

**Hull Configuration:**

Displacement w Bulbous Bow

## Engine Information

---

**Engines:**

2

**Engine Type:**

Inboard

**Manufacturer:**

Volvo Penta

**Fuel Type:**

Diesel

# GALLERY



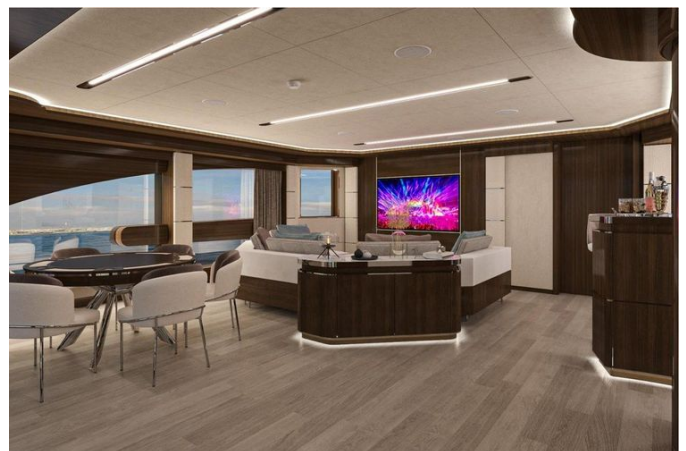









---

# DETAILED DESCRIPTION

---

## Description

---

Masterfully conceived to deliver unrivaled interior volume, the UHV 100 boasts the greatest gross tonnage in its class, and its optimized spatial planning rivals yachts twice its size. With 2,800 sq.ft (260m<sup>2</sup>) of interior space and 1,345 sq.ft (125m<sup>2</sup>) of exterior decks, the Lazzara UHV 100 promises a superlative onboard lifestyle—a true home on the water.

This additional volume yields larger upper and main decks aft along with substantially more room on the forward deck. As with every UHV, the aft upper deck can become a private owner's terrace when you select the unique layout with the master suite on the second deck. In this configuration, the main deck features an expansive galley and country kitchen alongside the salon and formal dining area. Alternatively, if you opt for a second-deck salon, the master moves to the main deck in place of the country kitchen. On the lower deck there are four, rather than three, large guest cabins for a total of five guest cabins, and within the crew area the addition of a third bunk room expands accommodations to five.

## Accommodations

---

Thoughtfully arranged accommodations welcome up to ten guests across five beautifully appointed staterooms, while a professional complement of five crew are comfortably housed in three dedicated cabins, ensuring seamless service and privacy throughout the voyage.

## Features

---

Thoughtfully equipped for effortless cruising, the yacht's electrical system

provides a shore power inlet, a generator, and an inverter for dependable onboard energy management. The comprehensive electronics suite includes a depthsounder, radar, wind speed and direction instrumentation, a computer, a navigation center, a plotter, a DVD player, an autopilot, a radio, a compass, GPS, cockpit speakers, and VHF, ensuring confident navigation and entertainment underway. Interior amenities elevate comfort and control with a stern thruster and bow thruster for precise handling, alongside a dishwasher, washing machine, electric bilge pump, oven, microwave oven, air conditioning, an electric head, heating, hot water, a refrigerator, a fresh water maker, a sea water pump, and a battery charger for carefree living aboard. On deck, exterior refinements feature a teak cockpit and teak sidedecks underfoot, a cockpit shower, a hydraulic gangway, plush cockpit cushions, a versatile cockpit table, and a swimming ladder, creating a welcoming environment for relaxation and easy access to the sea.

## Specifications

---

This 100ft yacht blends performance and poise, cruising confidently at 12kn with a top speed of 16kn and a range of 1500nm. Her proportions are beautifully balanced, with a 24.25ft beam, a 6ft maximum draft, and a 92.17ft length at waterline, all carried with authority on a dry weight of 331,000Lb. The hull and superstructure gleam in high performance white marine paint. Power management is truly global, with an electrical circuit designed for 220V-60 and 220-50 worldwide power, and the yacht's handling is elevated by an optional aft docking station featuring throttle, joystick, and thruster controls, optional hydraulic bow and stern thrusters rated at 60 kW each, and optional premium electric AC fin stabilization by CMC.

Purposeful engineering continues below deck. Fuel is carried in a 3,100 gal integrated epoxy coated system with high/low level alarms, level sensor, and flow indicator feeding Racor fuel filters—two duplex units for the main engines

and a single for the generator—with optional stainless steel valves and piping and an optional Alfa Laval fuel polishing system. The sea water system is anchored by two Lazzara custom FRP hull integrated sea chests connected by a crossover so one can be isolated for maintenance while still supplying all consumers, complemented by two Lazzara custom FRP hull integrated seawater discharge boxes and one black water discharge box, all plumbed with hard piping and a CuNiFe valve system, and offered with an optional electronic anti fouling system comprising four units with four transducers each. For illumination and ambiance, LED interior and exterior overhead lighting is complemented by optional Lazzara Phantom 360 exterior LED courtesy lighting, bright LED engine room lighting, dramatic LED underwater lighting encircling the entire boat with thirty-two lights, and an LED bow light that illuminates the foredeck from the waterline up.

Power distribution is robust and reassuring. The AC 110/220V system features a main switchboard, a 100A, 220V, 60Hz shore power inlet, and Glendinning Cablemasters with two 100ft, 100 amp units. The DC 24V system includes a main switchboard, two 24V/400Ah house batteries, two 24V/400Ah engine room batteries, a port side battery starting group (24V/270Ah), a starboard side battery starting group (24V/270Ah), and an emergency starting group (24V/200Ah), with the ability to use the engine batteries to start the generator and vice versa. Options include two Northern Lights generators at 50 kW, 110/220V, 60 Hz, a Mastervolt 24V/3500W/100A inverter charger, and a shore power converter for global 50/60 Hz input. Comfort is heightened by a heated towel bar in the master bath and a heated floor in the master bathroom. Chilled water air conditioning delivers 240k BTU, while engine room ventilation is handled by DC motor, stainless steel intake and outlet fans with fire dampers.

Navigation and oversight are exceptionally advanced, led by a Lazzara custom alarm monitoring system by Boening with a Lazzara backup alarm monitoring system covering bilge levels, navigation lights, and emergency shutdown, and a

comprehensive Garmin navigation package that includes four Garmin GPSMap 8616 MFDs, two Garmin GMR 424 xHD2 four foot open arrays, a Garmin VHF marine radio with handset, a Garmin autopilot, and a Garmin marine instrument for speed, depth, and more than one hundred marine and vessel parameters. Entertainment flows seamlessly through every space with an optional RTI cabin automation system controlling lights, blinds, air conditioning, and TV lifts. The upper deck aft features speakers and a 43" QLED TV; the upper salon presents Sonos speakers and a 65" QLED TV; the main deck aft offers Sonos speakers with a 43" QLED TV; the main salon hosts Sonos speakers and a 55" QLED TV; the master stateroom enjoys Sonos speakers with a 43" QLED TV; the port forward guest stateroom features Sonos speakers with a 43" QLED TV; the starboard forward guest stateroom carries Sonos speakers with a 43" QLED TV; the double guest stateroom includes Sonos speakers with a 43" QLED TV; and the twin guest stateroom is similarly equipped. A Sonos audio system integrates them all, while the crew mess benefits from a 43" LED TV and the beach club resonates with two speakers. Connectivity is ensured by an onboard ethernet network and Wi-Fi, with an optional bow underwater camera and optional two anchor cameras expanding situational awareness.

Everyday utility is meticulously addressed by generous tankage and resilient plumbing. A single 660 Gal epoxy composite fresh water tank with level indicators and a pressurized water system is supported by a fresh water shore connection for land based supply, an optional 2000 GPD fresh water maker, and an AC/DC fresh water pump system. Hot water is provided by two 26 gallon boilers. Black water is contained in a 420 gal integral fiberglass tank with shore and overboard discharge and a sea water wash system, complemented by an optional black water sewage treatment system and two blackwater discharge pumps, one serving as backup. Grey water is managed through integral fiberglass interface tanks with intelligent control. Safety critical pumping includes a 220V AC bilge pump, which can be used as a

backup fire pump, and a 24V DC fire pump, which can be used as a backup bilge pump, with two fire hose locations on the main aft deck and fore deck. Deck hygiene is effortless with bow and stern fresh water deck washes and anchor sea and fresh water washdown capability. Maintenance is simplified by an oil change system for engines and generators, while the bilge system is guarded by six high level alarms. All heads feature electric toilets with fresh water flush.

On deck, capability meets craftsmanship. The main deck is equipped with two bow hydraulic windlass units with capstan capability, with optional two stainless steel anchors and 250' anchor chain to port and 250' anchor chain to starboard in 5/8" high strength chain. Aft, two capstans (24V) aid docking, and side bulwark boarding doors—one each to port and starboard—enhance access. A hydraulic stern door opens to the beach club, and a hydraulic up/down swim platform expedites tender launch. Teak decking graces the main deck and the swim platform. Convenience and style include a salon aft electric sliding door and a starboard electric sliding door as options, an aft deck bar with ice maker and refrigerator, and a high gloss lacquered teak aft tabletop. The Lazzara exterior cushion package envelops the seating, with a second Lazzara exterior cushions package also available. A galley access door leads to the port side deck, complemented by an optional electric crew access door to the same deck. Forward, relaxation takes center stage with an optional custom made foredeck Jacuzzi and three expansive seating groups, the center converting to a sunbed, finished with the Lazzara exterior cushion package, an optional high gloss lacquered teak tabletop, a refrigerator and icemaker, an exceptionally large forward storage locker, and an optional sunshade system. Above, the upper deck features a Lazzara custom pilothouse helm station, optional port and starboard electric pantograph helm doors, and an optional aft electric sliding door, all surrounded by the Lazzara exterior cushion package. Signature UHV series elements include a hardtop mini radar arch, a custom navigation mast, and custom painted dummy domes and bases.

Amenities continue with an optional high gloss lacquered teak tabletop, teak decking, a refrigerator and icemaker, an electric grill, and an optional electronic sunshade awning.

Interior spaces are refined and functional. The upgraded galley is outfitted with a Miele oven, cooktop, extraction hood, microwave, warming drawer, coffee machine, dishwasher, wine cooler, refrigerator, and freezer. Laundry is effortless with a washer and dryer in the guest corridor and another washer and dryer in the crew galley, while additional refrigeration includes a refrigerator in the master closet and another in the guest corridor. The interior presents a high gloss finish with leather and stainless steel accents, while guest areas on the lower, main, and upper decks ride on floating floors. The yacht benefits from full thermal and voice insulation, with piping and mechanical systems isolated from the structure to reduce vibration and noise. Bathrooms are appointed with natural marble showers and countertops. Essential deck machinery includes electric warping drums and a hydraulic windlass with drum. Tankage comprises a fresh water tank at 1 x 660 Gal in epoxy composite, fuel tanks—three totaling 3500 Gal in epoxy composite—and a holding tank at 1 x 500 Gal in epoxy composite. For ultimate peace of mind, safety equipment features a vessel wide fire detection system, a fire detection and fixed fire suppression system for the engine room, Coast Guard approved PFDs, and two eight person life rafts.

# CONTACTS

---

Shestakov Yacht Sales is a brokerage company specializing in the sale and service of yachts worldwide. The company offers services for buying and selling both new and used motor yachts, sailing vessels, and luxury superyachts. They also provide yacht registration, insurance, technical maintenance, crew selection, and charter organization services across the U.S., Canada, Latin America, the Caribbean, and the Bahamas.

The founder and lead broker of the company is Andrey Shestakov, a licensed and certified expert with extensive experience in marine engineering and shipbuilding.

The company has an extensive network of partnerships with major yacht manufacturers worldwide and provides services in multiple languages, including Russian, Ukrainian, Spanish, and English. The office is in Dania Beach, Florida, USA.

For more information and to view available yachts, you can visit the company's official website: <https://shestakovyachtsales.com>

## Contact details

---

**Phone:** +1(954)274-4435

**Email:** [andrey@shestakovyachtsales.com](mailto:andrey@shestakovyachtsales.com)

## Address

---

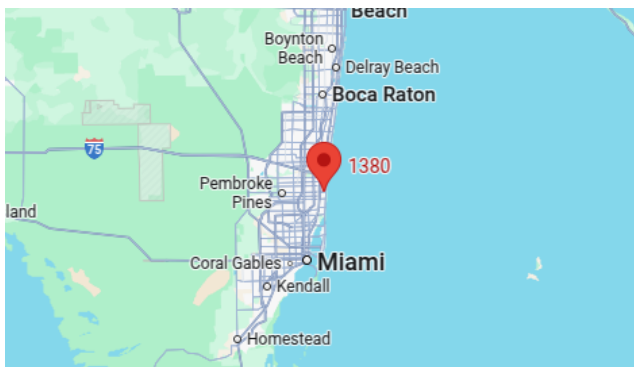

1380 Weeping Willow Way, Hollywood,  
Florida 33019