

## XCEL 70 - XCEL YACHTS



**Builder:** [XCEL YACHTS](#)

**Beam:** 29' 0" (8.90 m)

**Year Built:** 2025

**Min Draft:** 5' 3" (1.60 m)

**Model:** XCEL 70

**Max Draft:** 5' 3" (1.60 m)

**Price:** \$5,036,013.35 USD Subject to change.

[See full listing on our website](#)

**Location:** Abu Dhabi Island and Internal Islands City, United Arab Emirates

**LOA:** 77' 0" (23.50 m)

---

# TABLE OF CONTENTS

---

<b>OVERVIEW .....</b>	<b>3</b>
<b>SPECIFICATIONS .....</b>	<b>4</b>
Basic Information .....	4
Dimensions .....	4
Speed, Capacities and Weight .....	4
Accommodations .....	5
Hull and Deck Information .....	5
Engine Information .....	5
<b>GALLERY .....</b>	<b>6</b>
<b>DETAILED DESCRIPTION .....</b>	<b>11</b>
<b>CONTACTS .....</b>	<b>20</b>

## OVERVIEW

---

The Xcel 70, a remarkable embodiment of contemporary yacht craftsmanship and opulent aesthetics, has now reached the outfitting phase, signifying a pivotal moment in its voyage toward the eagerly awaited debut, projected for January 2025. This exquisite vessel is poised to redefine luxury on the water, making it an exceptional choice for those looking to buy a yacht. With its current boat location offering a prime opportunity for yacht sales, this yacht for sale is a must-see for discerning buyers. Explore the world of yacht sales in the current boat location and discover the unparalleled elegance and performance that the Xcel 70 promises to deliver.

# SPECIFICATIONS

---

## Basic Information

---

**Category:**  
Motor yachts

**Year Built:**  
2025

**Sub category:**  
Cruisers

**Country:**  
United Arab Emirates

**Model Year:**  
2025

## Dimensions

---

**LOA:**  
77' 0" (23.50 m)

**Beam:**  
29' 0" (8.90 m)

**Min Draft:**  
5' 3" (1.60 m)

**Max Draft:**  
5' 3" (1.60 m)

## Speed, Capacities and Weight

---

**Water Capacity:**  
1056.69 Gallons

**Fuel Capacity:**  
1585.03 Gallons

## Accommodations

---

**Sleeps:**

4

**Crew Berths:**

3

**Total Heads:**

4

## Hull and Deck Information

---

**Hull Material:**

Fiberglass and Plastic Yachts

**Hull Designer:**

N/A

**Deck Material:**

GRP

**Interior Designer:**

N/A

**Hull Configuration:**

N/A

## Engine Information

---

**Engines:**

2

**Manufacturer:**

Volvo Penta

# GALLERY

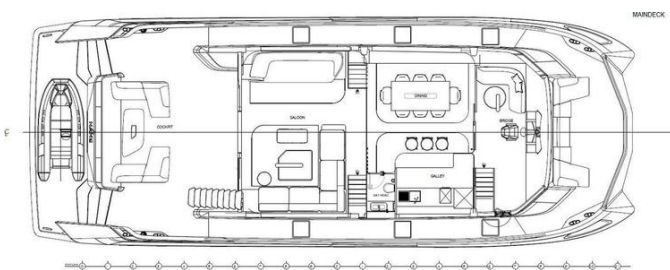
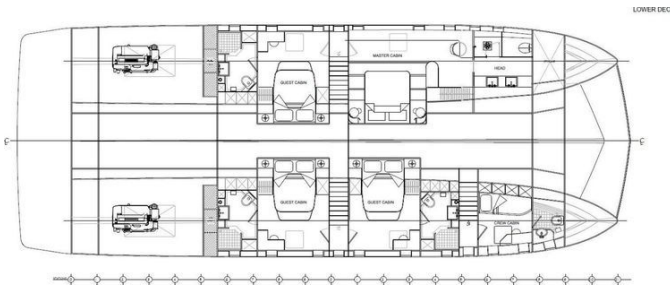
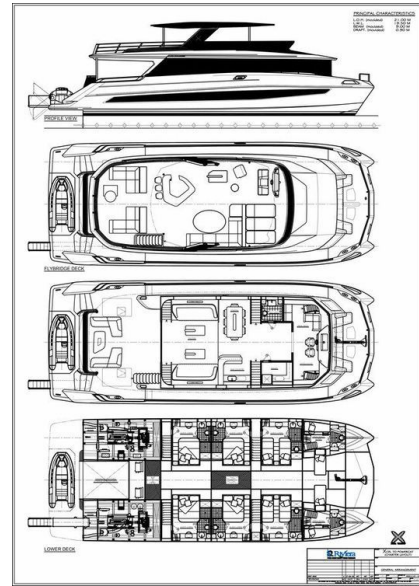





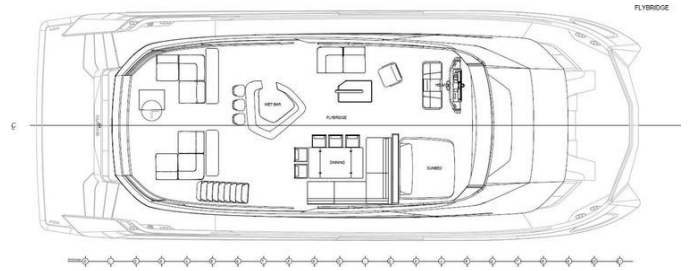



---

# DETAILED DESCRIPTION

---

## Hull and Superstructure

---

The hull and superstructure of this yacht are crafted with precision and durability in mind, utilizing GRP (Glass Reinforced Polyester) molded in a sandwich shell construction, adhering to International Yacht Building Practice standards. This robust construction extends to the G.R.P sandwich bulkheads and partitions, ensuring a solid and reliable structure. The yacht's bulwark is elegantly covered with a teak cap on the topsides, adding a touch of classic maritime style. Inside, the internal decks feature G.R.P. sandwich soles, providing a sturdy and comfortable footing.

A PVC rub rail with a 316L stainless steel insert encircles the boat, offering both protection and a sleek finish. The foredeck area is equipped with two storage compartments, perfect for stowing away essential gear. For maintenance purposes, a full-size engine compartment hatch is bolted to the deck, ensuring easy access. Additional storage is available for mooring lines, and an under-deck storage locker is conveniently located in the aft cockpit. The roof overhang aft is supported by two structural polished stainless steel supports, adding both strength and aesthetic appeal. Transom steps are thoughtfully placed on both the port and starboard sides, ensuring easy access to the water.

The yacht's tanks are integral to its design, with two GRP fuel tanks, each with a capacity of 3000 liters, complete with monitoring sensors and air vents. Freshwater needs are met with two integral GRP tanks, each holding 2000 liters, also equipped with sensors and air vents. Waste management is handled by two integral GRP black water tanks, each with a 500-liter capacity, and two grey water tanks of the same size.

Windows and doors are designed for both functionality and style, featuring

fixed superstructure tinted tempered windows of the frameless type, along with clear tempered front glass. Side hull windows are present on both port and starboard, complemented by port lights for below-deck compartments. A custom-designed sliding main door, crafted from high-quality stainless steel with tempered glass, offers variable positioning for ease of use. Window covers are provided for all windows, ensuring privacy and protection from the elements.

Deck outfitting is meticulously planned, with deck railings in 316L stainless steel designed to complement the yacht's overall aesthetic. Four high-end stainless steel cleats and four heavy-duty stainless steel bollards provide secure mooring options. Handrails are strategically placed around the yacht, ensuring safe movement onboard. Stainless steel deck fillers are available for both fuel and water tanks, and a black water tank deck extraction connection is included. LED deck courtesy lights illuminate all external areas, enhancing safety and ambiance.

The swim platform is a haven of luxury, featuring synthetic marine decking on the transom and two high-end stainless steel cleats. Two custom stainless steel manual swim ladders with teak steps provide easy access to the water. Custom doors on the port and starboard sides allow for convenient cockpit access. LED courtesy lights adorn the transom steps, while a shore power inlet (220v AC) with a 50m shore power cable ensures connectivity. A deck shower on the swim platform offers a refreshing rinse after a swim, and six underwater lights in blue create a captivating ambiance.

Optional features for the swim platform include natural teak decking, two custom stainless steel automatic retractable swim ladders with teak steps, a hydraulic swim platform (transformer), a marine crane with a 450kg capacity, and additional underwater lights.

The cockpit is designed for both relaxation and functionality, with synthetic marine teak decking providing a durable and stylish surface. Designer steps,

crafted from polished stainless steel and teak, lead to the fly-bridge, complete with a guardrail for safety. Two LED floodlights and overhead strip lights with a special design illuminate the area, while natural teak decking adds a touch of elegance. Four marine waterproof speakers ensure high-quality sound for entertainment.

Optional cockpit features include Lintex Fabric vinyl-treated seating with a custom coffee table and two capstan winches with stainless steel fairleads. Side walkways are 70 cm wide, providing easy access to the forward area. Emergency exit hatches are strategically placed on both the port and starboard sides, ensuring safety. Synthetic marine teak decking covers the side walkways, complemented by LED overhead strip lights. An optional upgrade includes natural teak wood decking for the side walkways.

In the forward area, a hidden anchor windlass with controls and a chain counter on the main helm ensures smooth anchoring. A stainless steel anchor roller and a polished 316L stainless steel anchor weighing 63 kg are included, along with a 12mm anchor chain measuring 70 meters in length. Two marine waterproof speakers provide sound in this area. An optional foredeck Lintex Fabric vinyl-treated lounging sofa adds comfort and style.

The fly-bridge is a masterpiece of design, featuring a stylish GRP console with an electronic throttle control system, an engine control screen, and a steering wheel. A magnetic compass and a multifunction display unit (12") serve as a repeater on the fly-bridge. Two remote controls for searchlights and a horn switch are conveniently located. The GRP hardtop is supported by exclusive stainless steel fins with integrated glass and columns, offering an open bridge design that allows 360-degree visibility. Synthetic marine teak decking provides a durable surface, while a GRP pilot sofa with luxury outdoor upholstery offers comfort. Four marine waterproof speakers with a subwoofer ensure high-quality sound. Handrails are conveniently located for secure movement, and a tempered glass windshield provides protection. Cup holders are

strategically placed around the fly-bridge, and LED overhead mood lighting in the hardtop ceiling creates a relaxing atmosphere. Courtesy floor lights and LED overhead strip lights enhance visibility, while an electric barbecue (220v) and a 24-volt refrigerator (60 liters) add convenience.

Optional fly-bridge features include natural teak wood decking, an openable electric soft top, a forward-facing sunbed opposite the pilot's station, an L-shape Lintex Fabric vinyl-treated sofa with an adjustable dining table and five loose seats, a coffee table with three seats behind the captain's seat, a central wet bar with a built-in fridge and ice maker, and three bar stools. An aft-facing luxurious lounging area with two designer Lintex Fabric vinyl-treated sofas and a coffee table, along with upholstered fly-bridge cushions and backrests with luxurious Lintex Fabric vinyl-treated fabrics, complete the optional offerings.

The standard layout of the saloon is a blend of elegance and functionality, featuring veneer and leather wall panels, two-tone parquet and carpet flooring, and tempered glass shatterproof windows. A stylish and contemporary designed sectional sofa with ALCANTARA fabric, along with an L-shape sofa designed with ALCANTARA fabrics and coordinated pillows, provide ample seating. Two puffs in the saloon area, an Italian-designed two-tone coffee table, and a side table add to the decor. Stairs with carpet steps and courtesy lights lead to the lower deck, while a decorative wood partition separates the living and dining areas. A 55-inch retractable Smart TV behind the L-shape sofa, a surround sound bar, and coordinated motorized curtains with remote control enhance entertainment options. Ceiling panels with LED strip lighting and four decorative LED wall sconces create a warm ambiance. AC air handling units with a total capacity of 36000BTU for the Mediterranean version or 54000BTU for the Gulf version ensure comfort, with A/C vents and a digital Aircon controller display. Safety features include a fire extinguisher (dry powder, 3 kg each) and a fire alarm sensor. Internal light switches and covers complete the saloon's features.

Optional saloon features include a Satellite TV Antenna KVH TV6 and a broadband system.

The galley and dining area are designed for both style and functionality, featuring a stylishly designed marble dining room table and eight custom-designed leather dining chairs. The dining room flooring is made from carpet and parquet, while a full-length side cabinet with veneered wood offers ample storage. Decorative ceiling panels made with ALCANTARA fabric and embedded LED strip lights add a touch of elegance. A day head with complete accessories, an electrical fresh water toilet, a solid surface washbasin with a vanity cupboard, and ceramic flooring provide convenience. An integrated bar counter with a marble top and three elegantly designed leather bar stools offer a space for relaxation. Galley flooring in coordinated parquet, a stainless steel sink, and tempered shatterproof tinted windows offer excellent visibility. Storage cupboards and drawers provide ample storage for all galley accessories, while storage lockers on the starboard side under the bar worktop surface add convenience. AC air handling units with a total capacity of 36000BTU for the Mediterranean version or 54000BTU for the Gulf version ensure comfort, with A/C vents and a digital Aircon controller display. An induction cooktop in the galley with four burners and a ventilation hood, a combination microwave oven, a full-height fridge in the kitchen at the main deck, and an ice maker complete the galley features. Safety features include a fire extinguisher (dry powder, 3 kg each) and a fire alarm sensor. Internal light switches and covers complete the galley and dining area's features.

The helm and wheelhouse are elegantly styled, featuring a helm station for multi-functional displays and equipment controls. An electrical control panel (24V DC and 220V AC), an electronic throttle control system, and two multifunction display units (12") including a 48 kn.m Radar/GPS/echo sounder provide comprehensive navigation options. A VHF radio telephone on the main helm with one repeater on the fly-bridge ensures communication. A set of navigation lights with a control panel on the main helm, a magnetic compass,

and two remote-controlled searchlights enhance navigation. A horn set (double) with a switch on the helm and fly-bridge consoles, three variable speed windshield wipers with a control panel and water nozzles, and an automatic control and alarm panel for bilge pumps ensure safety. A stylish exclusive steering wheel, an engine control screen, and luxurious Italian-designed chairs for the captain and navigator provide comfort. Stylish sofas on the port and starboard of the helm area, a tempered glass shatterproof windshield for maximum visibility, and various cup holders in the wheelhouse area add convenience. Stairs leading down to the crew accommodation area, flooring in the wheelhouse area in parquet, and decorative ceiling panels made with ALCANTARA fabric and embedded LED strip lights enhance the decor. A sliding glass door between the wheelhouse helm area and the dining/galley area, an AC air handling unit (18000BTU Mediterranean version or 24000BTU Gulf version), and A/C vents with a digital Aircon controller display ensure comfort. Safety features include a fire extinguisher (dry powder, 3 kg each), a fire alarm sensor, and a fire alarm system control panel. Fuel tank gauges on the main helm and fly-bridge console, water gauges on the main helm and fly-bridge console, gray water tank monitors on the main helm with an extraction switch, and black water tank monitors on the main helm with an extraction switch provide comprehensive monitoring. Internal light switches complete the helm and wheelhouse features.

Optional helm and wheelhouse features include an autopilot with control and a repeater on the fly-bridge, one rear monitoring camera and one engine room monitoring camera integrated into the multifunction screen at the main console, a boat CCTV monitoring system with main control on the helm, and a night vision thermal camera.

The master cabin is a sanctuary of luxury, featuring a king-size bed with a leather lower bed frame and chargers conveniently located on each bedside cabinet. Luxury carpet in the main cabin area, a vanity/desk area with a power

socket and seat, and a private access door to the cabin provide comfort and privacy. An AC air handling unit (12000BTU Mediterranean version or 24000BTU Gulf version) and A/C vents with a digital Aircon controller display ensure comfort. A bar fridge (220v) in the master cabin, a designated area for a 55" HD Smart TV and surround sound bar, and port and starboard hull side windows with automatic blinds enhance the cabin's features. Overhead LED ceiling lights, internal light switches, and a bathroom area with a vanity, two sinks and faucets, two storage areas under sinks, a fresh water electric flushing toilet with an exhaust fan, a full-sized walk-in shower with an overhead rain shower and privacy door, a full-sized mirror, marble stone countertops, and synthetic flooring with a marble look complete the master cabin's features. LED reading lights to port and starboard of the bed above the bedside, three full-height closets, a fire extinguisher (dry powder, 3 kg each), and a fire alarm sensor ensure safety and convenience.

Guest cabins offer a choice of one queen-size bed (160cm wide) or double single beds (80 cm wide) in any of the three cabins. Luxury carpet in the guest cabin area, a private access door to the cabin for privacy, a vanity/desk area with a power socket and seat, and an AC air handling unit (9000BTU/compartment Mediterranean version or 18000BTU Gulf version) with A/C vents and a digital Aircon controller display ensure comfort. Various wall plugs with charging ports, a clothes closet with shoe storage below, a large hull side window with automatic blinds, overhead LED ceiling strip lights, LED reading lights at port and starboard of the bed, a 32-inch Smart TV with a soundbar in the guest room, and internal light switches provide convenience. Safety features include a fire extinguisher (dry powder, 3 kg each) and a fire alarm sensor. The bathroom area includes a vanity with one sink and faucet, storage areas under sinks, manual blinds on the hull side window, a fresh water electric flushing toilet with an exhaust fan, a full-sized walk-in shower with an overhead rain shower, a full-sized mirror, marble stone countertops, and synthetic flooring with a marble look.

The crew cabin is designed for functionality, featuring a washing/dryer machine, a private access door to the cabin for privacy, a vanity/desk area with a power socket and seat, and an AC air handling unit (9000 BTU/compartment Mediterranean version or 12000BTU Gulf version) with A/C vents and a digital Aircon controller display. Various wall plugs with charging ports, a clothes closet with shoe storage below, a large hull side window, overhead LED ceiling strip lights, LED reading lights at port and starboard of the bed, three crew beds, a 32-inch Smart TV with a soundbar in the guest room, and internal light switches provide convenience. Safety features include a fire extinguisher (dry powder, 3 kg each) and a fire alarm sensor. The bathroom area includes a vanity with one sink and faucet, storage areas under sinks, manual blinds on the hull side window, a fresh water electric flushing toilet with an exhaust fan, a shower in the toilet with a mixer, a full-sized mirror, marble stone countertops, and synthetic flooring with a marble look.

The engine room and equipment are designed for performance and reliability, featuring a set of flexibly mounted twin 800Hp diesel engines, ZF gearboxes, S.S shafts, and propellers. A 40kW 220 V, 50 HZ marine generator with a control panel on the main helm ensures power. A multi-stage marine chiller type air conditioning system with reverse cycle (Mediterranean Version) and relevant air handling units with a capacity of 138000BTU provide comfort. A sea water pump for marine chillers, a circulation pump for marine air handlers, two battery chargers, three sets of marine maintenance-free batteries, and battery switches ensure reliable operation. An automatic bilge pump in each engine room, two hydraulic steering cylinders, air exhaust blowers (220v) with suitable air discharge capacity for the engine room, a fuel transfer pump between the two fuel tanks, and a power-assisted hydraulic dual steering system with Riviera exclusive rudders enhance performance. A main engine underwater exhaust system, an electric water pressure system for freshwater (220/24v), two water heaters (220v), overhead LED lighting in each engine room, stainless steel steps from the main deck hatch to each engine room, two

black water discharge pumps, two grey water discharge pumps, and an automatic fire extinguisher system (FM200) for the engine room with manual pull cables on the main deck ensure safety and convenience. Engine room automatic dampers, engine room insulation with mineral wool and a polymeric sound barrier in maritex finish, an engine room floor of checkered aluminum plates with service hatches, access for servicing equipment such as pumps and valves, a main switch panel, a shore power inlet, and ten automatic submersible bilge pumps complete the engine room's features.

Optional engine room features include an upgrade to 1000hp engines, an electro-hydraulic bow thruster, an electro-hydraulic stern thruster, a 200L water maker, and an upgrade to a multi-stage marine chiller type air conditioning system with reverse cycle (Gulf Version) with relevant air handling units with a capacity of 222000BTU.

Safety and life-saving equipment include two life buoy rings (30"), ten life jackets, one first aid kit, two life rafts with a 10-person capacity each, and an offshore flare pack, ensuring peace of mind while at sea.

# CONTACTS

---

Shestakov Yacht Sales is a brokerage company specializing in the sale and service of yachts worldwide. The company offers services for buying and selling both new and used motor yachts, sailing vessels, and luxury superyachts. They also provide yacht registration, insurance, technical maintenance, crew selection, and charter organization services across the U.S., Canada, Latin America, the Caribbean, and the Bahamas.

The founder and lead broker of the company is Andrey Shestakov, a licensed and certified expert with extensive experience in marine engineering and shipbuilding.

The company has an extensive network of partnerships with major yacht manufacturers worldwide and provides services in multiple languages, including Russian, Ukrainian, Spanish, and English. The office is in Dania Beach, Florida, USA.

For more information and to view available yachts, you can visit the company's official website: <https://shestakovyachtsales.com>

## Contact details

---

**Phone:** +1(954)274-4435

**Email:** [andrey@shestakovyachtsales.com](mailto:andrey@shestakovyachtsales.com)

## Address

---

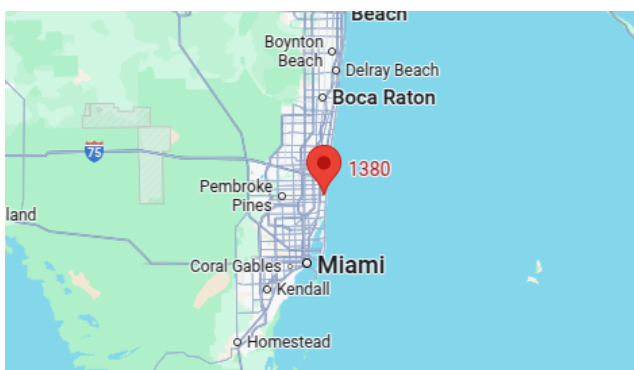

1380 Weeping Willow Way, Hollywood,  
Florida 33019