

## SX88 - SANLORENZO



**Builder:** [Sanlorenzo](#)

**LOA:** 88' 0" (26.82 m)

**Year Built:** 2025

**Beam:** 23' 0" (7.04 m)

**Model:** SX88

**Min Draft:** 18' 4" (5.60 m)

**Price:** - Subject to change.

**Max Draft:** 18' 4" (5.60 m)

[See full listing on our website](#)

**Location:** Fort Lauderdale, United States

**Cruising Speed:** 20 Knots (23.02 MPH)

**Max Speed:** 23 Knots (26.47 MPH)

---

# TABLE OF CONTENTS

---

**OVERVIEW ..... 3**

**SPECIFICATIONS ..... 4**

    Basic Information ..... 4

    Dimensions ..... 4

    Speed, Capacities and Weight ..... 5

    Accommodations ..... 5

    Hull and Deck Information ..... 5

    Engine Information ..... 6

**GALLERY ..... 7**

**CONTACTS ..... 11**

# OVERVIEW

---

## 2026 Sanlorenzo SX88

The crossover yacht that redefined expectations.

Regarded across the globe as a contemporary classic, the Sanlorenzo SX88 originated the Crossover Yacht philosophy, blending the generous internal volume of an Explorer Yacht with the refinement and lifestyle of a luxury Italian motor yacht. Its unmistakable profile, flowing open-plan arrangement, and seamless indoor-outdoor continuity create an environment that feels decisively modern, while a composed presence and elegant stance ensure it commands attention in any harbor.

Designed for the owner who values space, panoramic sightlines, and flexible use, the SX88 offers a sweeping beach club, a loft-inspired salon framed by full-height glass, and a Flybridge helm that frees the main deck for expansive living and entertaining. Every element is carefully considered to enhance life aboard, delivering Superyacht sensibilities in a nimble Flybridge Motor Yacht format that is as adaptable as it is sophisticated. Crossover yacht, explorer yacht, luxury motor yacht, flybridge yacht, superyacht.

# SPECIFICATIONS

---

## Basic Information

---

**Category:**  
Motor yachts

**Year Built:**  
2025

**Sub category:**  
Expedition Yachts

**Country:**  
United States

**Model Year:**  
2026

## Dimensions

---

**LOA:**  
88' 0" (26.82 m)

**Beam:**  
23' 0" (7.04 m)

**Min Draft:**  
18' 4" (5.60 m)

**Max Draft:**  
18' 4" (5.60 m)

## Speed, Capacities and Weight

---

**Cruise Speed:**

20 Knots (23.02 MPH)

**Water Capacity:**

400 Gallons

**Max Speed:**

23 Knots (26.47 MPH)

**Fuel Capacity:**

2400 Gallons

**Gross Tonnage:**

88 Pounds

## Accommodations

---

**Sleeps:**

8

**Crew Cabin:**

2

**Total Heads:**

4

**Crew Berths:**

2

## Hull and Deck Information

---

**Hull Material:**

Fiberglass and Plastic Yachts

**Hull Designer:**

Zuccon International Project

**Deck Material:**

Composite

**Interior Designer:**

Piero Lissoni

**Hull Configuration:**

Full Displacement Planing Hull

## Engine Information

---

**Engines:**

3

**Fuel Type:**

Diesel

**Manufacturer:**

Volvo Penta

# GALLERY



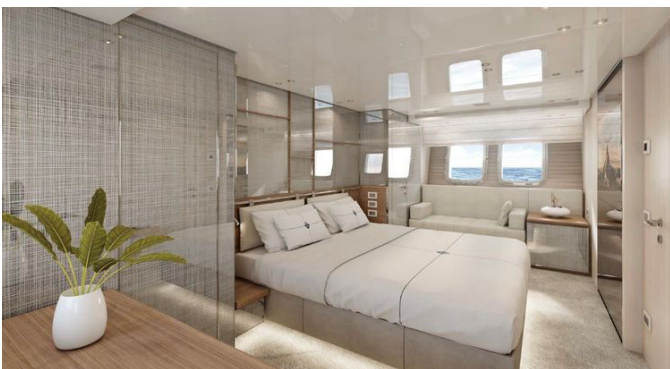

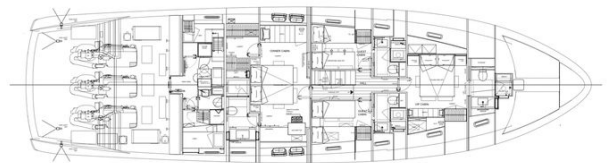

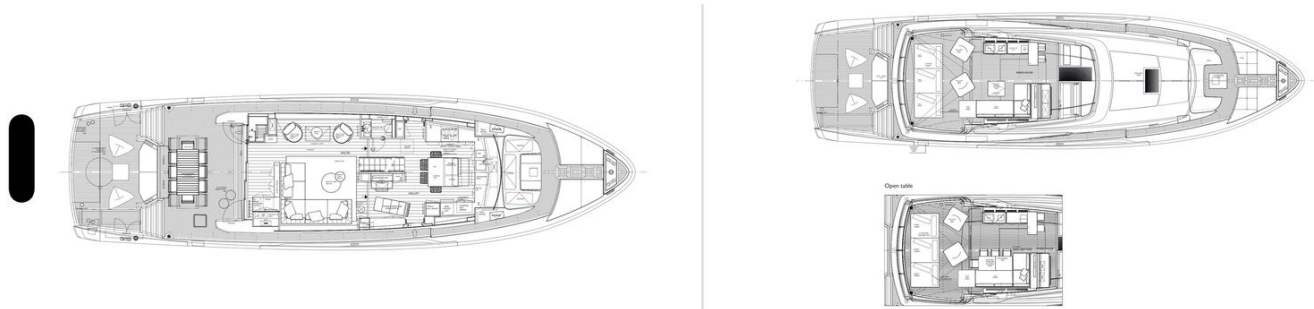

# CONTACTS

---

Shestakov Yacht Sales is a brokerage company specializing in the sale and service of yachts worldwide. The company offers services for buying and selling both new and used motor yachts, sailing vessels, and luxury superyachts. They also provide yacht registration, insurance, technical maintenance, crew selection, and charter organization services across the U.S., Canada, Latin America, the Caribbean, and the Bahamas.

The founder and lead broker of the company is Andrey Shestakov, a licensed and certified expert with extensive experience in marine engineering and shipbuilding.

The company has an extensive network of partnerships with major yacht manufacturers worldwide and provides services in multiple languages, including Russian, Ukrainian, Spanish, and English. The office is in Dania Beach, Florida, USA.

For more information and to view available yachts, you can visit the company's official website: <https://shestakovyachtsales.com>

## Contact details

---

**Phone:** +1(954)274-4435

**Email:** [andrey@shestakovyachtsales.com](mailto:andrey@shestakovyachtsales.com)

## Address

---



1380 Weeping Willow Way, Hollywood,  
Florida 33019