

91' FILIPPETTI NEVETTA 28 - FILIPPETTI



Builder: [FILIPPETTI](#)

LOA: 91' 0" (27.74 m)

Year Built: 2027

Beam: 23' 0" (6.99 m)

Model: Nevetta 28

Max Draft: 20' 6" (6.25 m)

Price: \$10,600,000 USD Subject to change.

Cruising Speed: 13 Knots (14.96 MPH)

[See full listing on our website](#)

Location: Ancona, Italy

Max Speed: 15 Knots (17.26 MPH)

TABLE OF CONTENTS

OVERVIEW 3

SPECIFICATIONS 5

 Basic Information 5

 Dimensions 5

 Speed, Capacities and Weight 5

 Accommodations 5

 Hull and Deck Information 6

 Engine Information 6

GALLERY 7

DETAILED DESCRIPTION 9

CONTACTS 11

OVERVIEW

The 2027 Filippetti Navetta 28 arrives as a rare new-build offering for owners who value serious long-range capability, sumptuous onboard living and a fully bespoke finish. Designed in collaboration with noted naval architect Fulvio De Simoni, this 91-foot full-displacement motor yacht combines a bulbous bow with a refined, advanced hull shape to produce a composed, economical passage across ocean miles. Hull #1 is available for complete personalization, giving an owner the opportunity to dictate layouts, materials and fit-out down to the smallest detail.

Arranged for extended cruising, the Navetta 28 allows flexible guest accommodation with a choice of five or six suites, permitting a plan that suits family life or a charter program. The owner's stateroom can be positioned on the main deck or elevated to the upper deck to maximize privacy, volume and panoramic sea views. Each cabin is specified with premium finishes and superior joinery, and large windows ensure interiors are flooded with natural light. Crew facilities are discrete and professional, comprising three cabins and two heads to ensure smooth service while safeguarding owner and guest privacy.

The main salon is conceived as an elegant, open-plan living area where generous proportions meet refined detailing; owners may select bespoke veneers, fabrics, stones and color schemes to build a cohesive, contemporary superyacht environment that feels personal and timeless. Outdoor spaces are sculpted for both leisure and functionality, beginning with a broad foredeck lounge on the main deck that creates a private vantage point for sun and scenery. The cockpit aft steps seamlessly from the salon to provide a gracious alfresco dining and lounging setting, while a swim platform at the waterline simplifies access for swimming, water toys and tender operations.

Underway, performance and efficiency work in harmony: the yacht is driven by

twin MAN 800 hp engines, delivering a comfortable cruising speed of 13 knots and a maximum of 14.5 knots. A 4,500-gallon fuel capacity supports a range in excess of 3,000 nautical miles, making the Navetta 28 a genuine bluewater passagemaker. Stabilizer fins enhance onboard comfort both moving and at anchor, reinforcing the vessel's serene, trawler-inspired temperament.

For anyone seeking a highly efficient, fully customizable long-range superyacht, the Filippetti Navetta 28 (2027) presents an elegant canvas on which to create a personalized vessel that melds enduring Italian craftsmanship with purposeful engineering and luxurious living.

SPECIFICATIONS

Basic Information

Model Year:
2027

Country:
Italy

Year Built:
2027

Dimensions

LOA:
91' 0" (27.74 m)

Max Draft:
20' 6" (6.25 m)

Beam:
23' 0" (6.99 m)

Speed, Capacities and Weight

Cruise Speed:
13 Knots (14.96 MPH)

Water Capacity:
770 Gallons

Max Speed:
15 Knots (17.26 MPH)

Fuel Capacity:
4510 Gallons

Accommodations

Total Heads:
7

Hull and Deck Information

Hull Material:

Fiberglass and Plastic Yachts

Hull Designer:

N/A

Deck Material:

Fiberglass

Interior Designer:

N/A

Hull Configuration:

N/A

Engine Information

Engines:

2

Engine Type:

Inboard

Manufacturer:

MAN

Fuel Type:

Diesel

GALLERY

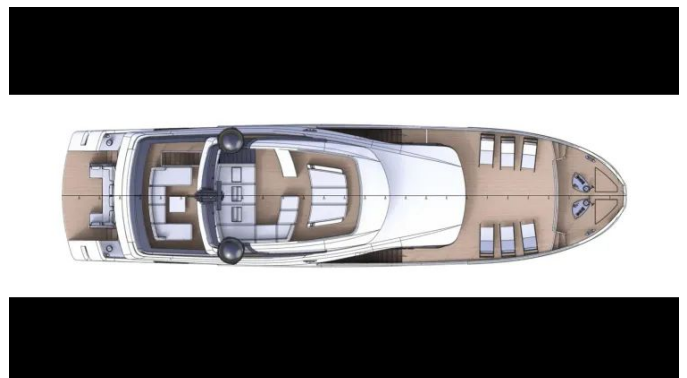

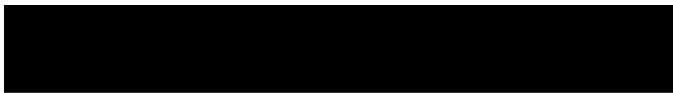
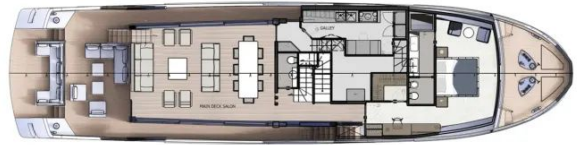

DETAILED DESCRIPTION

Technical specifications

Conceived for long-range refinement and assured seakeeping, this yacht measures 27.65m (90.9ft) overall with a waterline length of 22.50m (74ft), a broad 7m (22.11ft) beam and a draft of 1.90m (6.3ft). A displacement hull fitted with a bulbous bow enhances hydrodynamic efficiency and stability, with a light displacement of 95 tons rising to 125 tons when fully laden. Propulsion is provided by twin MAN 800HP engines on shaft drives, yielding a top speed of 14.5 knots and a steady cruise of 12 knots, while hotel power is supplied by two 33kW generators. Extended range is assured by a 20,500L (4,510 US Gallons) fuel capacity alongside 3,500L (770 US Gallons) of fresh water. Accommodation can be arranged to include up to six cabins and as many as seven heads, complemented by three crew cabins and two crew heads, all set within lines and naval architecture by Fulvio De Simoni.

Options, upgrades, and features

Through a personalised, collaborative process with the shipyard, every option, upgrade and feature is determined to produce a fully bespoke specification that mirrors your precise preferences and overarching vision for the yacht.

About Filippetti Yachts

Filippetti Yachts traces its roots to Fausto Filippetti, who entered the world of yachting in 1967 in the shipyards of Fano (Pesaro-Urbino), advancing from apprentice to accomplished shipwright. Over the course of more than forty years he established himself as a leading figure in Italian recreational boating and in 1985 was a co-founder of Pershing. Building on four decades of practical

expertise, he conceived an entirely new range distinguished by refined design, superior comfort and high performance. The Filippetti Yachts brand was officially launched in 2009, with his children, Martina and Giovanni, at the helm.

Disclaimer

All particulars are supplied in good faith; however, their accuracy cannot be guaranteed and no warranty is made concerning the vessel's condition. This yacht may be sold prior to availability, its price altered, or it withdrawn from the market without prior notice. The information is provided solely for the convenience of prospective clients and should not be construed as, nor taken to imply, a formal representation of any specific yacht offered for sale.

CONTACTS

Shestakov Yacht Sales is a brokerage company specializing in the sale and service of yachts worldwide. The company offers services for buying and selling both new and used motor yachts, sailing vessels, and luxury superyachts. They also provide yacht registration, insurance, technical maintenance, crew selection, and charter organization services across the U.S., Canada, Latin America, the Caribbean, and the Bahamas.

The founder and lead broker of the company is Andrey Shestakov, a licensed and certified expert with extensive experience in marine engineering and shipbuilding.

The company has an extensive network of partnerships with major yacht manufacturers worldwide and provides services in multiple languages, including Russian, Ukrainian, Spanish, and English. The office is in Dania Beach, Florida, USA.

For more information and to view available yachts, you can visit the company's official website: <https://shestakovyachtsales.com>

Contact details

Phone: +1(954)274-4435

Email: andrey@shestakovyachtsales.com

Address



1380 Weeping Willow Way, Hollywood,
Florida 33019