

58 RIVIERA OPEN FLYBRIDGE — RIVIERA



Судостроитель: RIVIERA

Год постройки: 2012

Модель: Катер для спортивной рыбалки

Цена: ЦЕНА ЯХТЫ ПО ЗАПРОСУ

Местонахождение: United States

Длина общая: 58' 0" (17.68m)

Ширина: 17' 5" (5.28m)

Купить 58 Riviera Open Flybridge — RIVIERA а также выбрать подходящую вам яхту из нашего каталога яхт вам поможет опытный яхтенный брокер Андрей Шестаков. На сегодняшний день компания Shestakov Yacht Sales Inc. имеет большое количество яхт в собственном списке продаж, а также тесно сотрудничает со всеми крупными яхтенными производителями по всему миру.

Для того чтобы купить яхту 58 Riviera Open Flybridge — RIVIERA а также проконсультироваться по любому вопросу связанному с покупкой, продажей, чартером яхт позвоните по телефону **+7(918)465-66-44**.

ОГЛАВЛЕНИЕ

ОГЛАВЛЕНИЕ	2
ХАРАКТЕРИСТИКИ	4
Основная информация	4
Размеры	4
Скорость, вместимость и масса	4
Размещение	4
Корпус и палуба	5
Информация о двигателе	5
ПОДРОБНОЕ ОПИСАНИЕ	6
Overall	6
Note	6
Remarks	6
Исключения	7
Отказ от ответственности	7
ФОТОГРАФИИ	9
Tournament Bunks	9
Helm	9
Helm at Night	9
Glove Box-Close	9
Glove Box-Open	9
Flybridge -Bar	10
Rocket Launchers	10
Flybridge-Sink	10
Mezzanine Seating	11
Cockpit-Sink	11
Cockpit-Tackle Box	11
Rod Storage	12
Cabinets Open	12

Bar	12
Bar Open	13
Layout	13
Profile	13
Layout	14
Layout	14
КОНТАКТЫ	15
Контактная информация	15
Телефоны	15
Время работы	15
Адрес	15

ХАРАКТЕРИСТИКИ

Основная информация

Тип судна: Катер для спортивной рыбалки

Подкатегория: Convertible

Модельный год: 2012

Год постройки: 2012

Страна: United States

Открытая палуба мостика: Да

Кубрик: Да

Размеры

Длина общая: 58' 0" (17.68m)

Длина по ватерлинии: 59' 9" (18.19m)

Ширина: 17' 5" (5.28m)

Длина привального бруса: 63' 5" (19.31m)

Скорость, вместимость и масса

Водоизмещение: 66100 Pounds

Вместимость воды: 264 Gallons

Вместимость сточного бака: 73 Gallons

Объем топливного бака: 1506 Gallons

Размещение

Всего кают: 3

Всего коек: 5

Спальные места: 6

Корпус и палуба

Материал корпуса: Fiberglass

Материал палубы: Fiberglass

Комплектация корпуса: Deep Vee

Цвет корпуса: White

Дизайнер корпуса: Riviera

Информация о двигателе

Двигатели: 2

Производитель: Caterpillar

Тип двигателя: Inboard

Тип топлива: Diesel

ПОДРОБНОЕ ОПИСАНИЕ

Overall

Stylish and Stately- The light, bright feel flows below decks into the two staterooms and guest cabin. Fixed port lights in the hull contribute to the light and airy feel. To cater for extended voyages there is a concealed laundry off the companionway. **Ingenious Saloon-** Brimming with ingenious features, the saloon is an entertainer's delight. In the case of this 'open' model the galley is situated at the front of the saloon, directly opposite the dinette. A rear 'hopper' window opens the saloon up, to the cockpit. **Flybridge Quality-** The Flybridge is undeniably the epitome of Riviera quality. Features include large lounge, table, teak floor, optional sunroof, wet bar and fridge, glass racks, storage, and helm station complete with adjustable leather Pompanette helm-chairs and ultra-modern console. Build quality is especially important in a flybridge model of this size because such a vessel is clearly designed to go further, to fish beyond the continental shelf, and to explore distant shores. Renowned international naval architect, Frank Mulder, is responsible for the design, using the latest CAD (Computer Aided Design) software. **Ultimate All-Rounder Cockpit-** Generously proportioned, it has been deliberately designed to enhance the 58's fishing capabilities whilst still providing superior entertaining attributes. **Confidence In Construction-** Build quality is especially important in a Flybridge model of this size because such a vessel is clearly designed to go further, to fish beyond the continental shelf, and to explore distant shores. **Credible Design-** Renowned international naval architect, Frank Mulder, is responsible for the design, using the latest CAD (Computer Aided Design) software. **Smoother, Cleaner, Quieter -** The 58 features underwater exhausts which are both cleaner and quieter. Larger shafts, precision Veem propellers and a robust build contribute to a refreshingly smooth ride. **RTM Technology -** Smaller fiberglass components are built using the RTM (Resin Transfer Moulding) closed mould injection process - which produces lighter and stronger components, with a better finish.

Note

Some pictures depict Optional Equipment and/or Optional Layout Arrangements

Remarks

The 58 Open Flybridge is a boat for those with a zest for life and a love of fishing or entertaining; it is also a boat for the most discriminating and experienced boating enthusiast. The running surface of the hull features propeller tunnels designed to deliver more powerful forward thrust, improved fuel efficiency and a smoother, steadier ride. Underwater exhausts deliver cleaner, quieter performance. And behind it all there is our legendary hand-laid fiberglass hull with additional bulkheads, separate compartments throughout, extra transverse stiffeners and a watertight collision bulkhead in the bow. After consultation with leading skippers and game

fishermen internationally, Riviera has created a brand-new Flybridge helm design and a cockpit layout with one purpose in mind - serious sport fishing. The huge cockpit is a very clean space with a large fridge, insulated icebox, large storage bins and an optional live-bait tank. There is even an option for a mezzanine seating area for up to three people directly below the bulkhead window. The port seat has a refrigerator underneath and a storage locker under the step while the centre seat is hinged to provide access to the engine room. The helm is on a raised platform and features twin Pompanette Platinum helm chairs; you couldn't be in a more comfortable or commanding position. The electrically operated console opens to reveal electronic equipment and accommodates up to three 15" displays. The Flybridge itself is likely to be the number one spot for family and friends. For a start, it is huge, very comfortable... and just so bright and open. Under the protection of the low-profile hardtop, you can relax on the U-shaped five seater lounge or port side bench. A well-equipped wet-bar is complete with sink, drink holders and below-bench fridge. Attention to detail has helped us create a living area on the 58 Open that is outstandingly comfortable and elegantly functional. Large side windows and a huge aft window beside the saloon door provide superior visibility and create a light, fresh ambience during the day while sophisticated lighting and modern blinds enhance a relaxed, contemporary atmosphere in the evening. For your entertainment there is a retractable 40" flat-screen television in the saloon and, thanks to the Bose lifestyle system, it sounds as good as it looks. There's an icemaker and fridge in the wet-bar and plenty of storage for bottles and glasses. There have been no compromises in the galley either, located on the same level as the saloon. Features include two below-bench fridge drawers, a top-load freezer, convection microwave, three-burner cooktop, optional dishwasher and trash compactor, large, solid-surface benchtops and stylish yet extremely practical Amtico flooring. Stunning, mirror-like timberwork throughout is the result of Riviera's new robotic varnishing technology and contributes to the overall warm and relaxed feel of the sleeping quarters. The master stateroom is delightfully spacious and inviting. It offers a walk-around queen-size bed with quality inner-spring mattress. The hanging and cupboard space is especially generous, and the cedar lining ensures that clothes always have a fresh feeling. The same could be said of the guest stateroom as it features similar inclusions and comfort. In this cabin there is an option to replace the island bed with tournament bunks. Both staterooms have the most modern of en suite bathrooms featuring semi-recessed porcelain hand basins, contemporary solid-surface benchtops and premium-brand mixer taps and chrome showerheads. The third cabin features two single Pullman berths. There's a third bathroom to serve the third cabin and for general day use. If you are ready to improve the standard of your boating life, few vessels exceed the standards set by the Riviera 58 Open Flybridge.

Исключения

При продаже яхты исключаются личные вещи владельца.

Отказ от ответственности

Компания предоставляет описание судна или яхты добросовестно, но не может гарантировать точность этой информации, а также не ручается за техническое

состояние. Покупатель должен проинструктировать своих агентов или оценщиков исследовать представленную информацию более подробно, по собственному желанию. Продажа судна или яхты, изменение цены или снятие с продажи будет происходить без предварительного уведомления.

ФОТОГРАФИИ

Tournament Bunks



Helm



Helm at Night



Glove Box-Close



Glove Box-Open



Flybridge -Bar



Rocket Launchers

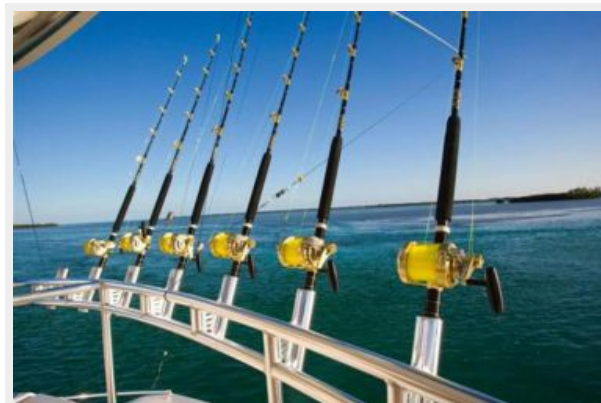

Flybridge-Sink



Mezzanine Seating



Cockpit-Sink



Cockpit-Tackle Box



Rod Storage



Cabinets Open



Bar



Bar Open



Layout



Layout

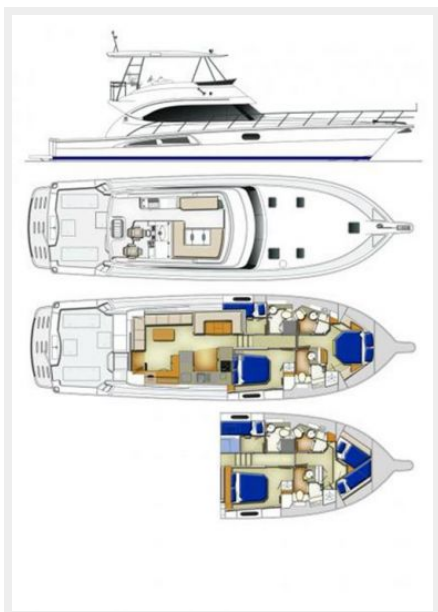

Layout

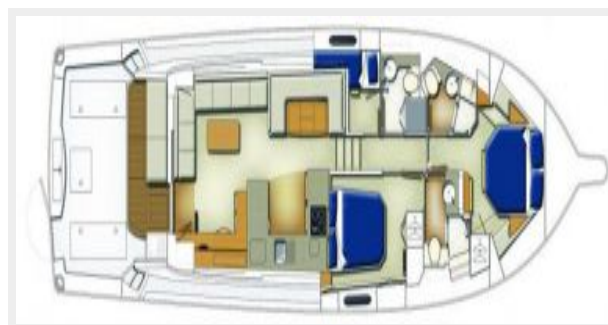

КОНТАКТЫ

Андрей Шестаков (Andrey Shestakov) – ведущий яхтенный брокер отдела продаж яхт и судов компании Shestakov Yacht Sales Inc. Официальный представитель Shestakov Yacht Sales Inc. для русскоговорящих клиентов в центральном офисе компании в Майами/Форт Лодердейл/Флорида/США.

Контактная информация

Email: andrey@shestakovyachtsales.com

Web: shestakovyachtsales.com

Телефоны

Краснодарский край: **+7(918)465-66-44**

США, Майами, Флорида: **+1(954)274-4435**

Время работы

Понедельник – Суббота: **9:00 - 21:00**
EDT

Воскресенье: **Закрито**

Адрес



Harbour Towne Marina, 850 NE 3rd St,
STE 213, Dania, FL 33004