

## NIRVANA — PURSUIT



**Builder:** PURSUIT

**Year Built:** 2000

**Model:** Cruiser

**Price:** PRICE ON APPLICATION

**Location:** United States

**LOA:** 30' 0" (9.14m)

**Max Draft:** 3' 3" (0.99m)

**Cruise Speed:** 21 Kts. (24 MPH)

**Max Speed:** 31 Kts. (36 MPH)

Our experienced yacht broker, Andrey Shestakov, will help you choose and buy a yacht that best suits your needs Nirvana — PURSUIT from our catalogue. Presently, at Shestakov Yacht Sales Inc., we have a wide variety of yachts available on our sale's list. We also work in close contact with all the big yacht manufacturers from all over the world.

If you would like to buy a yacht Nirvana — PURSUIT or would like help answering any questions concerning purchasing, selling or chartering a yacht, please call +1(954)274-4435

# TABLE OF CONTENTS

TABLE OF CONTENTS	2
SPECIFICATIONS	4
Overview	4
Basic Information	4
Dimensions	4
Speed, Capacities and Weight	4
Accommodations	4
Hull and Deck Information	5
Engine Information	5
DETAILED INFORMATION	6
Accommodations	6
Galley	6
Engine Room & Mechanical	6
Hull & Deck Equipment	7
Audio And Visual Equipment	8
Electrical System	9
Remarks	9
Exclusions	9
Disclaimer	10
PHOTOS	11
Stateroom	11
Galley	11
Bath	11
Salon settee	11
Helm seating	12
Helm	12
Plotter	12
Cockpit forward	12

---

Port seating	12
Aft deck	12
Cockpit sink	13
Livewell	13
Engine room	13
Engine hatch	13
Bow hauled	13
Stern hauled	13
Layout	14
<b>CONTACTS</b>	<b>15</b>
Contact details	15
Telephones	15
Office hours	15
Address	15

---

# SPECIFICATIONS

---

## Overview

---

"Nirvana" is a remarkably well-kept 30' express designed for comfort and fish-ability. She has had the engines replaced in 2003 via a factory upgrade. She is loaded with equipment and ready to cruise. Motivated Seller! Recent price reduction!

## Basic Information

---

**Category:** Cruiser

**Model Year:** 2000

**Year Built:** 2000

**Country:** United States

**Cockpit:** Yes

## Dimensions

---

**LOA:** 30' 0" (9.14m)

**Max Draft:** 3' 3" (0.99m)

## Speed, Capacities and Weight

---

**Cruise Speed:** 21 Kts. (24 MPH)

**Max Speed:** 31 Kts. (36 MPH)

**Displacement:** 10600 Pounds

**Water Capacity:** 30 Gallons

**Holding Tank:** 18 Gallons

**Fuel Capacity:** 210 Gallons

## Accommodations

---

**Total Berths:** 1

**Total Heads:** 1

---

## Hull and Deck Information

---

**Hull Material:** Fiberglass

**Deck Material:** Fiberglass Sandwich

**Hull Configuration:** Deep Vee

---

## Engine Information

---

**Engines:** 2

**Manufacturer:** Mercruiser

**Engine Type:** Inboard

**Fuel Type:** Gas

---

# DETAILED INFORMATION

---

## Accommodations

---

Sleeps 4 with one bath. A sliding plexiglas companionway door leads to salon with a forward double berth (hanging locker to starboard) and a convertible dinette (double) aft and to starboard. These areas have storage beneath. To port is a bath aft and galley forward. Flooring is teak and maple. The Headliner is vinyl with recessed lighting.

## Galley

---

Teak cabinetry with storage

Teak with inlay dinette table

Granite-cote countertops

AC/DC refrigerator

Electric cooktop (single burner)

Microwave oven

Sink with faucet

## Engine Room & Mechanical

---

Mercruiser 5.7 L, 300 hp gas engines (310 hours), replaced in 2003 (factory recall)/ access from the aft deck via an electrically lifted hatch and day hatch. Fresh water cooled. New water pump impellers and alignment 2010.

Fuel filters

Morse engine controls

Tides Dripless shaft seals

Aquamet 22 1.5" shafts with Nibral propellers

Engine blower system

Halon fire-suppression system

Fresh and raw water pumps

Hot water heater (6 usg)

Vacuflush head system

Horn

Ritchie compass

Engine gauges with alarms

Hydraulic steering system

Air conditioning – Cruisair reverse cycle with digital control

## Hull & Deck Equipment

---

Helm layout includes a helm chair and port lounge seat. A folding transom seat is featured in the aft cockpit.

“Nirvana” has been rack stored from 2000-2005, then winter-hauled thereafter. Fresh bottom paint with barrier coat applied 2008. Cutlass bearings replaced 2010

Self draining cockpit with molded-in nonskid (also on gunwales)

One-piece stainless steel bow rail

4 opening port lights with screens

3 deck hatches with screens

Port and starboard windshield wipers

Recessed trim tabs

Bow pulpit with anchor

Bow pulpit with anchor

Lewmar windlass with chain and rode

Hardtop with enclosure (stratoglass 3 side 2009) and rod storage

Vented aluminum windshield with handholds

Cockpit fly

Stainless steel cleats

Rocket launcher rod holders

Deck rod holders (4)

Rupp outriggers

Deck rod holders

Bait prep station with tackle storage

Live baitwell

Cockpit fishbox with macerator

Fresh and Raw water washdowns

Transom door

Transom shower (hot/cold)

Cockpit bolsters

Docklines and fenders

USCG safety equipment

---

## **Audio And Visual Equipment**

---

Raytheon RL70C radar/chartplotter/GPS

Furuno 582L fish finder

B&G engine monitor

VHF radio

Alpine am/fm/cd stereo

TV antenna and wiring



Telephone jack and wiring

---

## Electrical System

---

2 AGM 12vdc starting batteries

Group 31 12 vdc house battery (deep cycle)

Battery charger – 20 amp

Battery switches

Shore power inlet and 30 amp 50' shore cord and reverse polarity indicator

Electrical distribution panel with breakers (110vac/12vdc)

CO detector

2 automatic bilge pumps

Naviation lighting

Interior and courtesy lighting

---

## Remarks

---

The Pursuit 3000 Express is a high-end inboard express fishing boat offering best-in-class construction which Pursuit Boats are known for. She boasts an upscale interior with luxury appointments including teak cabinetry and hardwood flooring. Note engine replacement in 2003 (factory recall).

“Nirvana” has been lovingly cared for by subsequent owners and it shows! Her cockpit upholstery is like new and her gelcoat gleams. She is ready to cruise and priced to sell quickly!

---

## Exclusions

---

Owner's personal belongings.

## Disclaimer

---

The Company offers the details of this vessel or yacht in good faith but cannot guarantee or warrant the accuracy of this information nor warrant the condition of the vessel. A buyer should instruct his representatives, agents, or his surveyors, to investigate such details as the buyer desires validated. This vessel or yacht is offered subject to prior sale, price change, or withdrawal without notice.

# PHOTOS

**Stateroom**



**Galley**



**Salon settee**



**Bath**



**Helm seating**



**Helm**



**Plotter**



**Cockpit forward**



**Port seating**



**Aft deck**



**Cockpit sink**



**Livewell**



**Engine room**



**Engine hatch**



**Bow hauled**



**Stern hauled**



## Layout

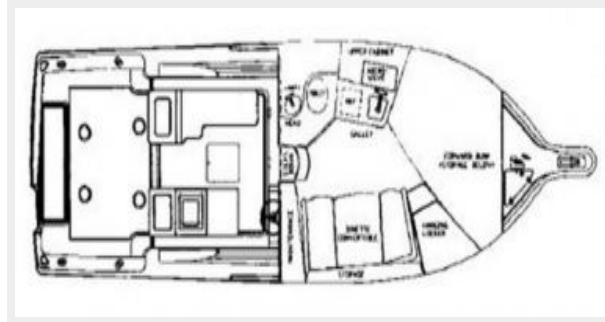

# CONTACTS

---

Andrey Shestakov, leading yacht broker of the sales department of Shestakov Yacht Sales Inc. Shestakov Yacht Sales Inc., the official representative of the Miami/Fort Lauderdale FL headquarters.

## Contact details

---

Email: [andrey@shestakovyachtsales.com](mailto:andrey@shestakovyachtsales.com)

Web: [shestakovyachtsales.com/en/](http://shestakovyachtsales.com/en/)

## Telephones

---

USA: +1(954)274-4435

## Office hours

---

Monday – Saturday: **9:00 - 21:00** EDT

Sunday: **closed**

## Address

---



Harbour Towne Marina, 850 NE 3rd St,  
STE 213, Dania, FL 33004