

NORTH-LINE 37 — NORTH-LINE YACHTS



Судостроитель: [North-Line Yachts](#)

Год постройки: 2015

Модель: Моторная яхта

Цена: **ЦЕНА ЯХТЫ ПО ЗАПРОСУ**

Местонахождение: Netherlands

Длина общая: 39' 4" (11.99m)

Ширина: 12' 8" (3.86m)

Мин. осадка: 3' 5" (1.04m)

Крейс. скорость: 16 Kts. (18 MPH)

Макс. скорость: 28 Kts. (32 MPH)

Купить **NORTH-LINE 37** — **North-Line Yachts** а также выбрать подходящую вам яхту из нашего каталога яхт вам поможет опытный яхтенный брокер Андрей Шестаков. На сегодняшний день компания **Shestakov Yacht Sales Inc.** имеет большое количество яхт в собственном списке продаж, а также тесно сотрудничает со всеми крупными яхтенными производителями по всему миру.

Для того чтобы купить яхту **NORTH-LINE 37** — **North-Line Yachts** а также проконсультироваться по любому вопросу связанному с покупкой, продажей, чартером яхт позвоните по телефону **+7(918)465-66-44**.

ОГЛАВЛЕНИЕ

ОГЛАВЛЕНИЕ	2
ХАРАКТЕРИСТИКИ	4
Обзор	4
Основная информация	4
Размеры	4
Скорость, вместимость и масса	4
Размещение	5
Корпус и палуба	5
Информация о двигателе	5
ПОДРОБНОЕ ОПИСАНИЕ	6
Construction	6
Machinery	6
Electrical Systems	7
Plumbing Systems	8
Tankage	8
Navigation Equipment	9
Domestic Equipment	9
Accommodation	10
Deck Equipment	12
Already fitted Optional Extras	13
Исключения	14
Отказ от ответственности	14
ФОТОГРАФИИ	15
КОНТАКТЫ	20
Контактная информация	20
Телефоны	20
Время работы	20
Адрес	20

ХАРАКТЕРИСТИКИ

Обзор

A Nelson from the Netherlands? With design assistance from Arthur Mursell these 37 foot aft cockpit semi displacement cruisers are as rugged as you would expect, but clever design tweaks allow the North-Line 37 to have separate 2 cabin accommodation.

Основная информация

Тип судна: Моторная яхта

Модельный год: 2015

Год постройки: 2015

Страна: Netherlands

Кубрик: Да

Размеры

Длина общая: 39' 4" (11.99m)

Длина по ватерлинии: 33' 10" (10.31m)

Ширина: 12' 8" (3.86m)

Мин. осадка: 3' 5" (1.04m)

Скорость, вместимость и масса

Крейс. скорость: 16 Kts. (18 MPH)

Макс. скорость: 28 Kts. (32 MPH)

Водоизмещение: 21999.92912498
Pounds

Вместимость воды: 138.6903273 Gallons

Вместимость сточного бака:
73.96817456 Gallons

Объем топливного бака: 369.8408728
Gallons

Размещение

Всего кают: 2

Всего коек: 7

Всего ком. состава: 1

Корпус и палуба

Материал корпуса: GRP

Материал палубы: GRP

Комплектация корпуса: Semi-Displacement

Дизайнер корпуса: TT Boat Design / Arthur Mursell

Информация о двигателе

Двигатели: 2

Производитель: Volvo Penta

Модель: D6

Тип двигателя: Inboard

Тип топлива: Diesel

ПОДРОБНОЕ ОПИСАНИЕ

Construction

RCD Status: The yacht conforms with the essential safety requirements of Directive 94/25EC (Recreational Craft Directive) and is categorised A – “Ocean”

Hull, Deck & Superstructure Construction:

- GRP/Fibreglass hull.
- Round bilge with fine entry and medium dead rise.
- Spray rail incorporated in hull moulding.
- Sandwich up to water line; under water single skin GRP.
- Rubber D-profile 100 x 100mm rubbing strake.
- Dark blue hull.
- White boot top.
- Inter protect and antifouling below waterline.
- GRP sandwich wheel house.
- GRP sandwich deck; non skid surface.
- White wheel house and deck.
- Self draining cockpit.
- Various zinc anodes.

Machinery

Engine & Gearboxes:

- 2 x Volvo Penta D6 330 hp, with original Volvo Penta control panel, 6 cylinders.
- Double Racor filter with water separator.
- 6mm lead and rubber panel insulation, plus 40mm Acousticab.

Maintenance & Performance:

- Displacement Speed: 7/8 knots.
- Cruising Speed: 16/22 knots.
- Max Speed: 28 knots.

Propulsion & Steering:

- Stainless steel water lubricated prop shafts, 45mm.
- Hydraulic steering system.

Electrical Systems

Voltage Systems:

- Separate 12v system with 1 x starter bank and 1 x service bank.
- 1 x 220v socket recessed into starboard berth-side locker in owner's cabin.
- 1 x 220v socket recessed into panel in heads compartment.
- 2 x 220v sockets recessed into panel in saloon.
- 2 x 220v sockets recessed into panel in galley.
- 2 x 220v sockets recessed into panel in wheelhouse

Battery Banks:

- 2 x Optima Red Top starter battery.
- 3 x 225 amp Victron AGM Board batteries.

Battery Chargers:

- Victron Multiplus Inverter/charger 3000/120 with remote control.

Alternators:

- 2 x 115 amp alternator on engines.

Shore Power:

- Shore supply fittings plus 15 metres of cable.

Other Electrical:

- Maxpower CT 60 bowthruster.
- Bennet hydraulic trimtabs.

Plumbing Systems

Fresh Water & Water Heating System:

- 60 litre Electric water heating system.
- Pressurized water system; including 8 litre pressure vessel.

Bilge Pumps:

- 1 x Manual switch operated bilge pump.
- 4 x Electric bilge pumps.

Tankage

Fuel:

- Total capacity of 1400 litres (219 gallons) in 2 x 700 litre tanks.
- 2 x Fuel tank gauge.

Fresh water:

- Total capacity of 525 litres (115 gallons).

- Water tank gauge.

Grey/Blackwater holding tanks:

- Total capacity of 280 litres (61 gallons).
- Waste water sonar level gauge with automatic and manual pump out switch.

Navigation Equipment

- Electric ships horn.

Domestic Equipment

Galley:

- 130 litre fridge with freezer compartment.
- Large round stainless steel sink.
- Single handle mixer tap.
- 4 burner stove.
- LG combi microwave/oven.

Heads/Showers:

- Vetus electric flush toilet.
- Shower includes thermostat tap with adjustable height for shower head.
- Single hand mixer tap in basin.

Heating & Ventilation:

- Eberspacher hot air heating system.
- Hot air outlet under port side locker in owner's cabin.
- Hot air outlet under locker in heads compartment.

- 2 x Hot air outlets at either end of U-shaped settee in saloon.
- Hot air outlet in guest cabin.
- Hot air outlet in wheelhouse.

Lighting:

- Halogen spotlights recessed into ceiling.
- Owner's cabin has 2 x reading lights/lamps.
- Guest cabin has 2 x reading lights/lamps.
- Saloon settee has 2 x reading lights/lamps.
- Complete set of navigation lights.

Accommodation

Summary of Accommodation:

- 2 x Aluminium deck hatches; 1 x in owner's cabin and 1 x over the galley.
- Solid Khaya trimmed/panelled interior.
- Alcantara synthetic panelled headlining.
- Teak with Ash strip floor at wheelhouse, saloon and cabins.
- Matt chrome brass fastenings.
- Silk gloss finished paintwork.
- Pilot 57 helm seat.

Description of layout from forwards:

Owner's Cabin:

- Lockable door.
- Free standing berth (202 x 150cm).

- Lockers on either side.
- Bed-side cabinets on either side of berth.
- Seating on either side of berth.
- 1 x Escape hatch and 2 x hinged port lights.
- 4 x Recessed spot lights and 2 x reading lights/lamps.

Heads Compartment:

- Fully moulded in synthetic material with well radiused corners.
- Corian worktop.
- Spacious lockers below and over the wash basin; upper locker is fitted with door mirrors.
- Hinged port light.
- 2 x Spots recessed into headlining.
- Teak floor.

Saloon:

- Seating area sits 6 people on U-shaped settee.
- Stowage under the settee include lardge drawer.
- Table in solid Khaya, 100 x 70 cm.
- 2 x Hinged port lights.
- 2 x Spots recessed into head lining.

Galley:

- Spacious galley with large worktop.
- Corian worktop.
- Single and double lower lockers.
- Lockers with sliding doors to accommodate microwave oven above worktop.

- 1 x Large drawer for cutlery.
- 1 x Ventilation/escape hatch and 2 x hinged port lights.
- 2 x Spot lights recessed into head lining.

Deck Equipment

General:

- Stainless steel bath platform with teak grating and door to cockpit.
- Stainless steel folding boarding ladder.
- Wheelhouse double glaze with 2 double glazed sliding windows.
- 3 x Speich heavy duty stainless steel Pantograph windscreen wipers.
- Victron Multiplus inverter/charger 3000/120 with remote control.
- Victron VE Net ultimate power management and control.
- 2 x Solid teak doors with double glazed windows.
- Opening side access in guard rail with SS sliding rails.
- 2 x 5 bladed HR props.
- Hydraulic opened engine hatch.
- Hydraulic lowered folding mast.
- Teakdeck on cockpit sole and steps.
- Flag including ensign staff.
- 1 x Boat hook.

Anchoring & Mooring Equipment:

- Stainless steel type Bruce anchor with stainless steel fittings.
- 50m of 10mm chain.
- Electric and manually operated anchor windlass.
- 6 x Large Cooney stainless steel bollards.

- 4 x Fenders.
- 4 x Mooring lines.

Safety Equipment:

- Varnished teak grab rails, all around wheel house.
- Stainless steel guard rail on all sides, 75cm high.

Fire-fighting equipment:

- 2 x Manual operated extinguishers
- Stat X Aerosol automatic extinguisher in engineroom

Already fitted Optional Extras

- 2 x D6 330 HP Volvo Penta
- 1400 litre fuel capacity, instead of 1000 litres.
- Bennet hydraulic trimtabs.
- Max power CT 60 5.8 HP KGF bowthruster.
- Teak sprayrail and badging.
- Stainless steel bath platform with teak grating and access door to platform.
- Osmosis prevention system.
- Microwave with oven.
- Corian worktop.
- Corian worktop in head.
- Teak floor in head.
- Drawer in settee.
- Victron Multiplus inverter/charger 3000/120 with remote control.
- VE Net ultimate power management and control.
- Hydraulic opened engine hatch.
- Hydraulic lowered folding mast.
- Teak deck on cockpit sole and steps.
- Gebo double glazed windows include large double glazed sliding windows.
- 2 x Solid teak doors with double glazed windows.
- Teak/Ash stripe floor at wheelhouse, saloon/galley and cabins.
- Lofrans electric anchor winch.
- Opening side access in guard rail with SS sliding rails.
- 2 x 5 bladed HR props.

- Alcantara linings.

Recommended options by Manufacturer:

- 2nd helmsman seat, hydraulically operated.
- Drawer fridge in wheelhouse.
- Teak deck.
- Simrad navigation.
- Norsap helmsman seat.

Исключения

При продаже яхты исключаются личные вещи владельца.

Отказ от ответственности

Компания предоставляет описание судна или яхты добросовестно, но не может гарантировать точность этой информации, а также не ручается за техническое состояние. Покупатель должен проинструктировать своих агентов или оценщиков исследовать представленную информацию более подробно, по собственному желанию. Продажа судна или яхты, изменение цены или снятие с продажи будет происходить без предварительного уведомления.

ФОТОГРАФИИ









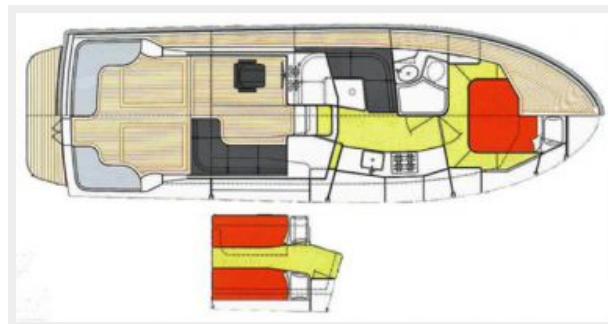

КОНТАКТЫ

Андрей Шестаков (Andrey Shestakov) – ведущий яхтенный брокер отдела продаж яхт и судов компании Shestakov Yacht Sales Inc. Официальный представитель Shestakov Yacht Sales Inc. для русскоговорящих клиентов в центральном офисе компании в Майами/Форт Лодердейл/Флорида/США.

Контактная информация

Email: andrey@shestakovyachtsales.com

Web: shestakovyachtsales.com

Телефоны

Краснодарский край: **+7(918)465-66-44**

США, Майами, Флорида: **+1(954)274-4435**

Время работы

Понедельник – Суббота: **9:00 - 21:00**
EDT

Воскресенье: **Закрето**

Адрес



Harbour Towne Marina, 850 NE 3rd St,
STE 213, Dania, FL 33004