

SY PHILKADE — SENSATION



Builder: SENSATION

Year Built: 1986

Model: Cruising Sailboat

Price: PRICE ON APPLICATION

Location: Thailand

LOA: 122' 9" (37.40m)

Beam: 25' 0" (7.60m)

Min Draft: 9' 7" (2.90m)

Max Draft: 19' 1" (5.80m)

Cruise Speed: 12 Kts. (14 MPH)

Max Speed: 14 Kts. (16 MPH)

Our experienced yacht broker, Andrey Shestakov, will help you choose and buy a yacht that best suits your needs **SY PHILKADE — SENSATION** from our catalogue. Presently, at Shestakov Yacht Sales Inc., we have a wide variety of yachts available on our sale's list. We also work in close contact with all the big yacht manufacturers from all over the world.

If you would like to buy a yacht **SY PHILKADE — SENSATION** or would like help answering any questions concerning purchasing, selling or chartering a yacht, please call **+1(954)274-4435**

TABLE OF CONTENTS

TABLE OF CONTENTS	2
SPECIFICATIONS	3
Basic Information	3
Dimensions	3
Speed, Capacities and Weight	3
Accommodations	3
Hull and Deck Information	4
Engine Information	4
DETAILED INFORMATION	5
Introduction	5
Electrical System	6
Electronics and Navigational	6
Engine /Mechanical Equipment	7
Sails and Rigging	7
Deck & Hull	7
Exclusions	8
Disclaimer	8
PHOTOS	9
CONTACTS	14
Contact details	14
Telephones	14
Office hours	14
Address	14

SPECIFICATIONS

Basic Information

Category: Cruising Sailboat

Model Year: 1986

Year Built: 1986

Refit Year: 1995

Country: Thailand

Dimensions

LOA: 122' 9" (37.40m)

LWL: 98' 2" (29.90m)

Beam: 25' 0" (7.60m)

Min Draft: 9' 7" (2.90m)

Max Draft: 19' 1" (5.80m)

Speed, Capacities and Weight

Cruise Speed: 12 Kts. (14 MPH)

Cruise Speed RPM: 1800 Kts.

Cruise Speed Range: 2750

Max Speed: 14 Kts. (16 MPH)

Displacement: 255736.22392 Pounds

Gross Tonnage: 146 Pounds

Water Capacity: 2456.8000836 Gallons

Holding Tank: 924.866354052 Gallons

Fuel Capacity: 7799.151491196 Gallons

Accommodations

Total Cabins: 3

Total Berths: 3

Sleeps: 6

Total Heads: 3

Crew Berths: 3

Crew Sleeps: 6

Crew Heads: 3

Hull and Deck Information

Hull Material: Aluminum

Deck Material: Teak over Aluminum

Hull Designer: Dubois Naval Architects

Exterior Designer: Dubois

Engine Information

Engines: 2

Manufacturer: MAN

Model: D2848

Engine Type: Inboard

Fuel Type: Diesel

DETAILED INFORMATION

Introduction

SY PHILKADE was originally launched by Sensation Yachts in New Zealand as SY AQUEL II in 1986. Subsequently named SY VAINGUEUR. This 123ft Cutter rigged super yacht was born to cruise-fast. She has seen the world and has a history of fast Ocean passages. With a revolutionary exterior design for the 1980's her styling has not aged and she still turns heads wherever she goes.

PHILKADE was designed by DUBOIS NAVAL ARCHTECTS, easily the foremost design house for sailing Superyachts today. Carrying on their tradition of partnering great design and excellence in naval architecture has developed some of the world's best award winning Superyachts.

The design for well-known American yachtsman Bob Milhous was ground breaking and launched the super yacht career of Dubois. The yacht has been a proven performer under sail and the interior lay out makes excellent use of space in a contemporary way. The raised decksaloon has become a Dubois trade mark. The stern with the symmetrical steps has won many acclaims and is great for entertainment at anchor.

PHILKADE is now based in Thailand where she is currently undergoing further refit work to her decks and interior. However, her present owner has a change of plans and is offering the yacht, as is where is, excluding the interior refit but otherwise in good running condition.

It is in our view an ideal situation to buy such a pedigree Dubois superyacht with the opportunity to customize and modernize the interior to the specific wishes of the new owner.

We have contacted the interior design firm Design Unlimited who have experience in designing the interior of one of Dubois latest yachts, Bliss, which you can see on their website http://www.designunlimited.net/templates/Dubois_36m.htm

Yacht Solutions, a well-known refit company in Thailand with a track record of 10 years working

on a range of projects all offering their own complexities and challenges has made a detailed quotation of the work needed to complete the interior and a few other necessary upgrades including exterior painting which will result in a condition as new. We are happy to share the details of the suggested refit with a prospective buyer and we could offer project management during the refit.

SCOPE AND COST OF THE REFIT

The following work needs to be included in the required refit:

- A Condition Survey
- Complete Interior Refit.
- Exterior painting of hull and superstructure
- Upgrading of certain machinery

Yacht Solutions have quoted all of the above including the fees of the interior architect @ US\$ 1 million subject to final plans. The time frame of the refit would be approx. 9 months and could be done in 2012.

Philkade had an extensive refit at the famous Rybovich yard in Florida in 2009 prior to her Pacific crossing (with over Us\$ 1m spent on these works) with complete new rigging, new sails, new electronics, new hydraulic steering, and a major overhaul of the electrical systems.

Electrical System

- Dual 24V battery banks w/ approx. 2000 amp hours reserve
- Inverter system with 2 inverters: 24V to 110V/220V

Electronics and Navigational

- ar-Furuno 36NM/Garmin 36NM
- Raio-ICOM SSB, ICOM VHF (3), Handheld VHF (4)
- Autopilot- SIMRAD (2)
- Depth sounder-Furuno
- Sound/Chart Plotter-Gamin
- Wind instruments-Furuno

- Navigation software-Nobeltec
- Satellite phone/email-Iridium,

Engine /Mechanical Equipment

- Main Engines two 355 Horse Power or 261 kW MAN. Engine Model: D2840.
- Power generation: Northern Lights 2 times 90KW with PTOs for Hydraulic power, no enclosure.
- Cruisair MTA-60CA chilled water system - twin 60,000 BTU units - reverse
- Kobelt hydraulic steering
- 2 x Engine driven bilge pumps
- Richfield 50HP bowthrusters - fully retractable
- 5 x Jabsco 24v DC, 300 gph bilge pumps
- Fireboy automatic extinguishing system in engine room
- Hundestad controllable pitch propellers, fully feathering under sail
- 2 X Twin Racor plus fuel cleaning system plus LGX filters
- 1x Westerbeke 25 KW night generator
- FCI @ 600 gals/day

Sails and Rigging

- Omohondro Custom carbon-fibre mast w/ Rondal hydraulic in-mast furling
- Omohondro Custom carbon-fibre boom
- Rondahl hydraulic MK III roller furling for genoa
- In mast furling main - Macksail
- Roller furling staysail - Macksail
- Rondal hydraulic roller furling for staysail
- Macksail mainsail, genoa and staysail

Deck & Hull

- GalleyMaid hydraulic windlass
- Anchor stowage via hydraulically opening "pockets" in the topsides adjacent to the stern
- 15' Caribe RIB with 40 HP Yamaha
- Hydraulic center stern hatch for access to garage
- "Escalier" stern w/ four, full-beam steps from deck to transom providing exceptional access for watersports and bathing

Exclusions

Owner's personal belongings.

Disclaimer

The Company offers the details of this vessel or yacht in good faith but cannot guarantee or warrant the accuracy of this information nor warrant the condition of the vessel. A buyer should instruct his representatives, agents, or his surveyors, to investigate such details as the buyer desires validated. This vessel or yacht is offered subject to prior sale, price change, or withdrawal without notice.

PHOTOS

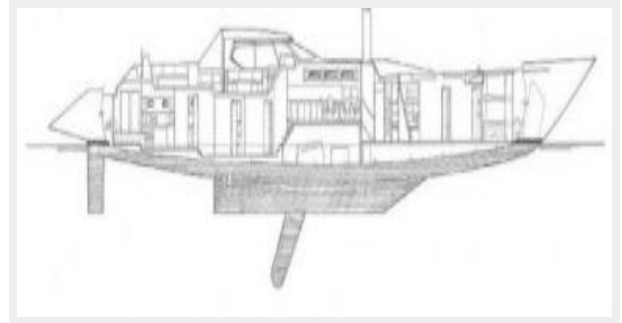
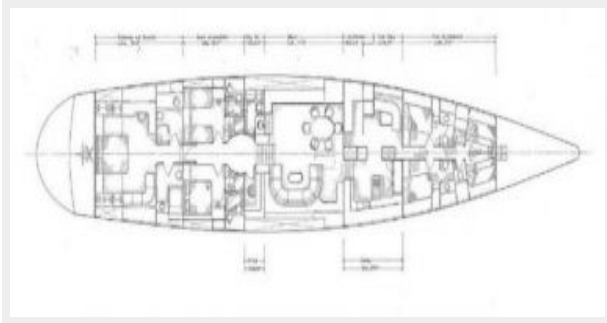







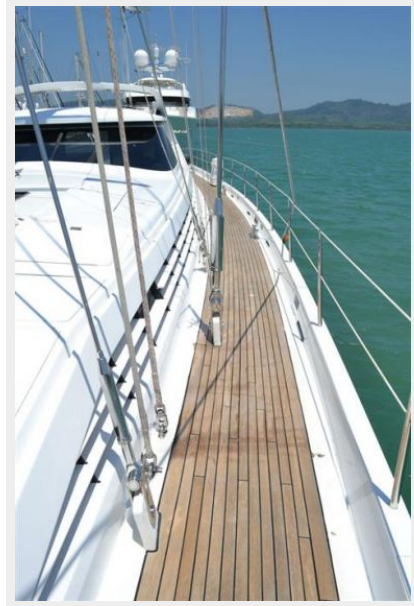

CONTACTS

Andrey Shestakov, leading yacht broker of the sales department of Shestakov Yacht Sales Inc. Shestakov Yacht Sales Inc., the official representative of the Miami/Fort Lauderdale FL headquarters.

Contact details

Email: andrey@shestakovyachtsales.com

Web: shestakovyachtsales.com/en/

Telephones

USA: +1(954)274-4435

Office hours

Monday – Saturday: **9:00 - 21:00** EDT

Sunday: **closed**

Address



Harbour Towne Marina, 850 NE 3rd St,
STE 213, Dania, FL 33004