

MID SUMMER'S DREAM — HINCKLEY



Builder: HINCKLEY

Year Built: 2004

Model: Motor Yacht

Price: PRICE ON APPLICATION

Location: United States

LOA: 55' 3" (16.84m)

Beam: 17' 9" (5.41m)

Min Draft: 2' 11" (0.89m)

Max Draft: 2' 11" (0.89m)

Cruise Speed: 32 Kts. (37 MPH)

Max Speed: 39 Kts. (45 MPH)

Our experienced yacht broker, Andrey Shestakov, will help you choose and buy a yacht that best suits your needs **MID SUMMER'S DREAM — HINCKLEY** from our catalogue. Presently, at Shestakov Yacht Sales Inc., we have a wide variety of yachts available on our sale's list. We also work in close contact with all the big yacht manufacturers from all over the world.

If you would like to buy a yacht **MID SUMMER'S DREAM — HINCKLEY** or would like help answering any questions concerning purchasing, selling or chartering a yacht, please call **+1(954)274-4435**

TABLE OF CONTENTS

TABLE OF CONTENTS	2
SPECIFICATIONS	4
Overview	4
Basic Information	4
Dimensions	4
Speed, Capacities and Weight	4
Accommodations	5
Hull and Deck Information	5
Engine Information	5
DETAILED INFORMATION	6
VESSEL OVERVIEW:	6
MASTER STATEROOM:	6
MASTER HEAD:	7
GUEST STATEROOM:	7
GUEST / DAY HEAD:	7
SALON:	8
GALLEY	8
DECK AND HULL:	9
ENGINE AND MECHANICAL DETAILS:	10
ELECTRICAL:	11
ELECTRONICS AND NAVIGATION	11
COMMENTS:	12
Exclusions	12
Disclaimer	12
PHOTOS	13
Salon Starboard Side Forward	13
Salon Port Side Forward	13
Salon Forward	13

Galley	13
Master Stateroom	14
Galley 2	14
Master Stateroom 2	14
Master Stateroom 3	14
Master Head	15
Master Stateroom 4	15
Guest Cabin	15
Guest Head	15
Full Size Washer / Dryer	16
Stidd Helm Chairs	16
Electrical Panel	16
Cockpit Showing Folding Seat	16
Cockpit Looking Forward	17
Lazzarette	17
Running Shot	17
Layout	17
Running Shot 2	17
CONTACTS	18
Contact details	18
Telephones	18
Office hours	18
Address	18

SPECIFICATIONS

Overview

MID SUMMER'S DREAM is a stunning and fast example of this well admired Bruce King design and is being offered on the brokerage market for the first time. Providing spacious accommodations for up to six adults in two private staterooms and a convertible settee in the salon, she is ideal for use as a couple's getaway or for family cruising. Beautifully appointed with satin finished cherry, high gloss teak and holly sole, top quality fabrics and reliable machinery ensure her next owner a continued level of style, comfort, and performance relatively few ever have the opportunity to experience. Very well recommended by her broker, this is one Hinckley 55 not to miss.

Basic Information

Category: Motor Yacht

Sub Category: Jet Boat

Model Year: 2004

Year Built: 2004

Country: United States

Cockpit: Yes

Dimensions

LOA: 55' 3" (16.84m)

Beam: 17' 9" (5.41m)

Min Draft: 2' 11" (0.89m)

Max Draft: 2' 11" (0.89m)

Speed, Capacities and Weight

Cruise Speed: 32 Kts. (37 MPH)

Max Speed: 39 Kts. (45 MPH)

Displacement: 59999 Pounds

Water Capacity: 200 Gallons

Holding Tank: 26 Gallons

Fuel Capacity: 1000 Gallons

Accommodations

Total Cabins: 2

Sleeps: 6

Total Heads: 2

Hull and Deck Information

Hull Material: Kevlar Composite

Deck Material: Teak

Hull Designer: Bruce King

Engine Information

Engines: 2

Manufacturer: MAN

Engine Type: Inboard

Fuel Type: Diesel

DETAILED INFORMATION

VESSEL OVERVIEW:

MID SUMMER'S DREAM is a stunning and fast example of this well admired Bruce King design which is being offered on the brokerage market for the first time. Providing spacious accommodations for up to six adults in two private staterooms and a convertible settee in the salon, she is ideal for use as a couple's getaway or for family cruising. Beautifully appointed with satin finished cherry, high gloss teak and holly sole, top quality fabrics and reliable machinery ensure her next owner a continued level of style, comfort, and performance relatively few ever have the opportunity to experience. Very well recommended by her broker, this is one Hinckley 55 not to miss.

MASTER STATEROOM:

Centerline tapered Queen berth

Satin Cherry wood finish

High gloss Teak and Holly sole

Large overhead hatch w/retractable screen and blackout shade

(4) Opening ports w/screens and blackout shades

Sharp Aquos flat screen TV

Samsung DVD/VHF player

Bose speaker system

Air-conditioning control

Variable overhead lighting

Bedside reading lamps

2-cedar lined hanging lockers

Small built in desk w/stool

MASTER HEAD:

High gloss Teak and Holly sole

Stainless washbasin

Teal Corian countertop

Tankwatch 4 holding tank monitor

SeaLand vacuflush toilet

Overhead hatch w/retractable screen and blackout shade

Opening port w/screen and blackout shade

Large stall shower

GUEST STATEROOM:

Two athwart ship single berths

Satin Cherry wood finish

High gloss Teak and Holly sole

Hanging locker

(2) Opening ports w/screens and blackout shades

Overhead opening hatch w/retractable screen and blackout shade

(2) Fans

Air-conditioning control

Bose speakers

Bedside reading lamps

Variable overhead lighting

GUEST / DAY HEAD:

High gloss Teak and Holly sole

Stainless washbasin

Teal Corian countertop

Tankwatch 4 holding tank monitor

SeaLand vacuflush toilet

Overhead hatch w/retractable screen and blackout shade

Opening port w/screen and blackout shade

Stall shower

SALON:

Satin Cherry wood finish

High gloss Teak and Holly sole

U-shaped dinette / settee to starboard

Satin cherry electric high/low pedestal table that converts to a double bunk

Bose surround sound system

Custom Cherry cabinet to port with foldaway Sharp Aquos flat panel TV and DVD/CD player

(4) Overhead opening hatches w/retractable screens and blackout shades

(2) Wall mounted lamps on aft bulkhead

Floor to ceiling blackout drapes for aft windows/French doors

Variable overhead lighting

GALLEY

High gloss Teak and Holly sole

Large stainless sink w/detachable wand shower spigot

Teal Corian countertop

Custom dish drying rack

Princess 2-burner stove

Sharp carousel stainless convection microwave

Cuisinart stainless toaster

Sub-Zero 700BR refrigerator and freezer drawers

Icemaker located under Stidd helm seats

DECK AND HULL:

Burgundy Red Awlgrip over a Kevlar/E-glass and Carbon fiber SCRIMP hull

White Gel coat deck

White boot stripe

Black bottom

Full stainless bow rail and varnished teak toe rail and cockpit coamings

Wide side decks with integral fender lockers

USCG navigation lights

Saltwater deck wash spigot on bow

Hydraulic Muir windlass in recessed custom anchor well

Polished stainless DELTA plow anchor w/chain rode

Spare aluminum Fortress anchor

17gal hot water heater

100gal aluminum holding tank

200gal stainless fresh water tank

Hot and cold cockpit shower

Swim platform with ladder

Molded fiberglass rear facing bench seats to port and starboard in cockpit

Storage lockers to port and starboard in cockpit

Assorted fenders and lines

Assorted life jackets

St. Croix tender davits on swim platform

Sunscreens for salon and pilothouse windows

Stainless frame four panel sliding French doors from salon to cockpit

(4) Kidde multipurpose dry chemical extinguishers

Fold away aft cockpit bench seat

Aft cockpit lighting

Lifesling

ENGINE AND MECHANICAL DETAILS:

(2) MAN 1300hp diesel engines with Twin Disc transmission (1022hrs 7/2014)

(2) Hamilton 403 jet drives

Dual Racor fuel filters for each engine

Reverse oil change system

Automatic Haylon fire extinguishing system

Underwater exhaust system with low speed by pass

Side Power hydraulic bow thruster

Dual cylinder stainless trim tabs

Power assisted steering

Forced air exhaust blower in engine room

17gal Stainless hot water heater

Central vacuum system

Marine Air Systems air conditioning with reverse cycle heating

ELECTRICAL:

Westerbeke 15kw generator in sound box (694hrs 7/2014)

(2) Balmar 100amp alternators

(2) 24 volt DC Mastervolt battery chargers/inverters

(4) House batteries

(4) Engine and generator starting batteries(New 7/2014)

24 volt DC ships service

12 volt lighting throughout

240/120 volt AC system

50amp shore power cord with Glendenning system

ProMariner galvanic isolator monitor

ELECTRONICS AND NAVIGATION

Garmin GPSmap 5215

Garmin GPSmap 4212

Raymarine ST2 90 display

Raymarine ST2 90 autopilot

Raymarine ST2 90 bucket/rudder angle indicator

Icom IC-M602 VHF/Hailer

MAN engine control panel (Upgraded 7/2014)

MAN electronic throttle controls (Replaced with new upgrade version 7/2014)

Hinckley JetStick control

Exalto wiper control pad

Ritchie Powerdamp compass

ACR spotlight control

Matrix tank monitor system

(2) Stidd electric helm chairs

Electric side helm window

Westerbeke remote starting panel for generator

Fuel flow meter

High water bilge alarm

COMMENTS:

This is a well-maintained and aggressively priced yacht in good order with no surprises. Offers are encouraged by her motivated owner.

Exclusions

Owner's personal belongings.

Disclaimer

The Company offers the details of this vessel or yacht in good faith but cannot guarantee or warrant the accuracy of this information nor warrant the condition of the vessel. A buyer should instruct his representatives, agents, or his surveyors, to investigate such details as the buyer desires validated. This vessel or yacht is offered subject to prior sale, price change, or withdrawal without notice.

PHOTOS

Salon Starboard Side Forward



Salon Port Side Forward



Salon Forward



Galley



Galley 2



Master Stateroom



Master Stateroom 2



Master Stateroom 3



Master Stateroom 4



Master Head



Guest Cabin



Guest Head



Full Size Washer / Dryer



Stidd Helm Chairs



Electrical Panel



Cockpit Showing Folding Seat



Cockpit Looking Forward



Lazzarette



Layout

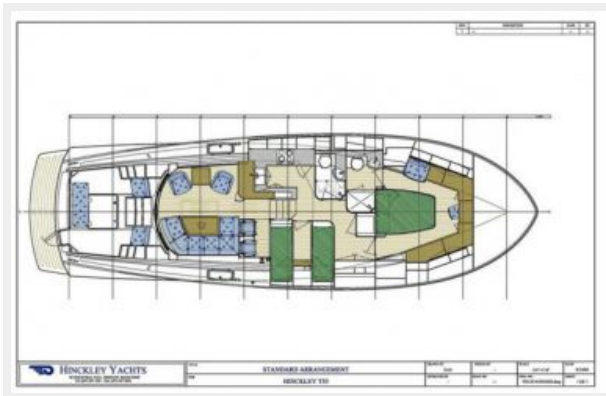

Running Shot



Running Shot 2



CONTACTS

Andrey Shestakov, leading yacht broker of the sales department of Shestakov Yacht Sales Inc. Shestakov Yacht Sales Inc., the official representative of the Miami/Fort Lauderdale FL headquarters.

Contact details

Email: andrey@shestakovyachtsales.com

Web: shestakovyachtsales.com/en/

Telephones

USA: +1(954)274-4435

Office hours

Monday – Saturday: **9:00 - 21:00** EDT

Sunday: **closed**

Address



Harbour Towne Marina, 850 NE 3rd St,
STE 213, Dania, FL 33004