

## WAIANIWA — MCMULLEN & WING



**Builder:** MCMULLEN & WING

**Year Built:** 1995

**Model:** Cruising Sailboat

**Price:** PRICE ON APPLICATION

**Location:** United States

**LOA:** 59' 11" (18.26m)

**Beam:** 16' 10" (5.13m)

**Min Draft:** 7' 3" (2.21m)

**Cruise Speed:** 8 Kts. (9 MPH)

**Max Speed:** 9 Kts. (10 MPH)

Our experienced yacht broker, Andrey Shestakov, will help you choose and buy a yacht that best suits your needs **WAIANIWA — MCMULLEN & WING** from our catalogue. Presently, at Shestakov Yacht Sales Inc., we have a wide variety of yachts available on our sale's list. We also work in close contact with all the big yacht manufacturers from all over the world.

If you would like to buy a yacht **WAIANIWA — MCMULLEN & WING** or would like help answering any questions concerning purchasing, selling or chartering a yacht, please call **+1(954)274-4435**

# TABLE OF CONTENTS

TABLE OF CONTENTS	2
SPECIFICATIONS	4
Overview	4
Basic Information	4
Dimensions	4
Speed, Capacities and Weight	4
Accommodations	4
Hull and Deck Information	5
Engine Information	5
DETAILED INFORMATION	6
Broker's Comments	6
Owner's Comments	6
Construction	6
Machinery	7
Electrical Systems	8
Plumbing Systems	9
Tankage	9
Navigation Equipment	10
Domestic Equipment	11
Accommodation	12
Deck Equipment	14
Exclusions	17
Disclaimer	17
PHOTOS	18
CONTACTS	24
Contact details	24
Telephones	24
Office hours	24

---

Address

24

# SPECIFICATIONS

## Overview

Astonishing build quality from McMullen & Wing down under to epic designs from Bill Dixon. Built to do the world 2 handed - t-shirt now collected. Available for use at the ocean near you.

## Basic Information

**Category:** Cruising Sailboat

**Sub Category:** Center Cockpit

**Model Year:** 1995

**Year Built:** 1995

**Country:** United States

## Dimensions

**LOA:** 59' 11" (18.26m)

**LWL:** 50' 0" (15.24m)

**Beam:** 16' 10" (5.13m)

**Min Draft:** 7' 3" (2.21m)

## Speed, Capacities and Weight

**Cruise Speed:** 8 Kts. (9 MPH)

**Max Speed:** 9 Kts. (10 MPH)

**Displacement:** 74999.05690978 Pounds

**Water Capacity:** 636.390473268 Gallons

**Fuel Capacity:** 696.357529072 Gallons

## Accommodations

**Total Cabins:** 3

**Total Berths:** 7

**Total Heads:** 2

---

## Hull and Deck Information

---

**Hull Material:** Composite

**Deck Material:** GRP

**Hull Finish:** Fiberglass

**Hull Designer:** Bill Dixon

---

## Engine Information

---

**Engines:** 1

**Manufacturer:** Yanmar

**Model:** 4LH-DTE

**Engine Type:** Inboard

**Fuel Type:** Diesel

---

# DETAILED INFORMATION

---

---

## Broker's Comments

---

WAIANIWA is in her second ownership. The brief to Bill Dixon was to deliver the best possible design to enable her owners to sail shorthanded in safety, with ease around the globe. The commission for her build was given to McMullen and Wing. 51,000 man hours later, WAIANIWA was born, with some of the best joinery you will see, and fitting the design brief like a glove. Her pilothouse is quite unique – essential to shorthanded cruising, perfect for entertaining, plus practical for warm or cold water sailing. Her original owner's completed a 2 year circumnavigation aboard her before selling her to her current owners in 2002. They have voyaged from 51° North to 51° South and many points between. She has never been chartered and has always been maintained/updated throughout her life. She is ready for her next adventure.

---

## Owner's Comments

---

WAIANIWA has turned out to be everything we had hoped for. We were about to build a new yacht that was very similar when we came across LADY KATHERYN (Renamed WAIANIWA, which means "The pot of gold at the end of the rainbow). My previous yacht was a Little Harbor 50 and I was worried about stepping up to a much larger yacht. In fact because of the special attention to shorthanded sailing this yacht is easier to handle in all conditions than my previous yacht. My wife and I have sailed her in all conditions and we have been very happy with her performance both under sail and under power. She is a true 200 miles a day yacht.

---

## Construction

---

### *Hull, Deck & Superstructure Construction:*

- The original owner specified that the hull be able to withstand hitting a submerged container at 10 knots.
- The hull is composite with stripped plank cedar core - outer skin is S-glass with two layers of Kevlar, inner skin is S-glass reinforced with carbon fiber in some areas.
- WAIANIWA sustained damage in 2007 from grounding, with penetration into the integral tanks, requiring large areas of the cedar core to be replaced with new outer laminates applied. There was no water inside the hull, and all work was completed to high standards by a builder in Maine.
- Decks are fiberglass with Corecell foam core and superstructure is custom built with fiberglass.

- There are three watertight compartments – forepeak, engine room and lazarette.
- Flag Blue Awlgripp hull (2008) with gold cove stripe, double white boot stripes and red bottom. Cabinhouse is white Awlgrip with painted non-skid.

#### *Keel & Rudder:*

- Rudder is carbon fiber with JP3 rudder bearing (all new 2009).

## **Machinery**

---

#### *Engine & Gearboxes:*

- 1 x Yanmar 4LH-DTE 170 HP diesel engine. Reconditioned 2010 with new injectors and cleaning of turbo system.
- Dual fuel filters for engine with by-pass. Triple in-line filters for engine and generator.

#### *Maintenance & Performance:*

- Engine Hours: 7,560 hours.
- Cruising Speed: 8.5 knots.
- Maximum Speed: 9.25 knots.

#### *Propulsion & Steering:*

- Oversized 50 mm direct shaft drive with aquadrive, custom made shaft lock and Shaft Shark automatic line cutter.
- Autoprop self-pitching propeller that adjusts between motorsailing and powering into head seas and wind.
- Hydraulic steering system with two independent stations in cockpit and pilothouse.
- Side-power 60 HP bow thruster (2006).
- Lewmar Commander 5 hydraulic system driving four cockpit winches, boom furling and genoa furler.
- Custom steering pedestal with wrap-around leather-covered wheel for easy access to

pedestal controls.

*Other Mechanical:*

- Dual refrigeration systems for redundancy – both 50/60 HZ AC driven.

*Note: Numerous spares for all systems, including a spare aquadrive.*

---

## **Electrical Systems**

---

*Voltage Systems:*

- 12-24 volt DC and 220-240 volt AC electrical systems for U.S. or European use.
- Custom main breaker panels, starboard side pilothouse and at aft landing area.

*Battery Banks:*

- 24 volt house battery bank providing 600 amp hours (six volt AGM in series/parallel to create 12v) replaced 2014.
- 12 volt battery bank for engine start and electronics.
- Genset and engine batteries - replaced in 2013.
- Bow thruster batteries - replaced in 2011.

*Battery Chargers:*

- Mastervolt 24 volt battery charger for 240 volt/50 Hz shore power (European and Pacific).
- Vectran charge system, 24 volt for 220 volt/60 Hz shore power (American).

*Alternators:*

- Twin engine alternators – 100 amp with Maxcharge smart regulator for house bank and 40 amp for engine start.



---

### *Generator:*

- Kohler 17 kW generator putting out 240 Volts/ 50 Hz. (6,073 hours – overhauled 2011), with separate exhaust and underwater wet exhaust for quiet operation.
- IDEC automatic generator starting system, capable of starting generator, charging batteries and running refrigeration while off the boat.

### *Shore Power:*

- Two shore power cables, one for the US 220 volt system and one for the European 240 volt power source.

### *Other Electrical:*

- Victron isolation transformer.
- Vectran 4000 watt inverter which runs all systems onboard.

---

## **Plumbing Systems**

---

### *Fresh Water & Water Heating System:*

- Pressurized fresh water system with 17 gallon hot water tank.

### *Watermaker:*

- Model 850 watermaker providing 40 GPH with automatic backwashing system (new electronics, booster pump and high pressure pump 2007).

### *Bilge Pumps:*

- 6 x Electric bilge pumps.
- 2 x Manual bilge pumps.
- Engine-driven bilge pump, 100 gpm, with manifold to pick up in all six zones.

---

## **Tankage**

---

- Fuel and water transferrable from side to side for trim adjustment and increased stability on long passages.

#### *Fuel:*

- Total capacity of 2,636 litres (580 gallons) in 2 x integral GRP tanks and 1 x steel keel tank.

#### *Fresh water:*

- Total capacity of 2,409 litres (530 gallons) in 2 x integral GRP tanks.

#### *Grey/Blackwater holding tanks:*

- Two holding tanks with discharge pumps (stainless steel).
- Two grey water tanks with discharge pumps (stainless steel).

---

## **Navigation Equipment**

---

- Furuno Navnet 2 Radar and chart plotter.
- 2 x Furuno GP-32 GPS units for redundancy.
- Standard Horizon GPS/chart plotter at cockpit helm.
- Furuno depth finder, B&G depth finder.
- B&G Hydra instruments with multiple remotes in the pilothouse and at the cockpit helm.
- B&G autopilot.
- Coursemaster autopilot (back-up for redundancy).
- Toshiba laptop connected to the Furuno radar and to the Iridium phone.
- Icom M-34 VHF.
- Iridium phone and modem.
- Raymarine loud hailer and automatic fog horn.
- Handheld VHF.

- Spreader camera connected to the radar screen that can be set to survey any part of the boat or adjacent dock.

## Domestic Equipment

---

### *General:*

- Washer/Dryer (2006).

### *Galley:*

- Alpes –Inox four-burner electric/propane stove with overhead vent.
- Microwave oven.
- Double front-opening refrigerator.
- Top-opening freezer.
- Trash compactor.
- Twin stainless sinks with retractable faucet.
- Full assortment of galleyware and both casual and formal dinnerware.

### *Heads/Showers:*

- 2 x WCs.
- 2 x Showers.
- Hot and cold fresh water shower on transom.

### *Heating & Ventilation:*

- Hella fans in all cabins.
- Air conditioning – four independent zones, 40,000 BTU total.
- Espar heater with vents throughout.

*Entertainment:*

- 18" Flat screen TV in pilothouse.
- Pioneer stereo, CD and DVD player with multiple speakers.

## Accommodation

---

*Summary of Accommodation:*

- WAIANIWA sleeps six in three private cabins, plus one in the pilothouse.
- Her fine New Zealand craftsmanship is evident throughout, with her solid American cherry raised-panel joiner work and Huon pine floors.
- Her solid white raised-panel bulkheads, painted white hull ceiling and white fabric overhead - combined with numerous hatches, opening portholes and windows - provide a light, airy feel.

*Description of layout from forwards:**Owner's Cabin:*

- The owner's cabin is forward and features a queen-sized berth on centerline.
- There is a large bureau and vanity to starboard, as well as a generous 4' wide hanging locker outboard.
- Two large drawers under the berth and numerous other lockers add to the exceptional storage space.
- A deck hatch and two opening portholes provide ample light and ventilation.
- There is also a huge storage space under the berth.

*En-suite and Shower:*

- There is a private head with separate shower stall attached to the owner's cabin.
- Features include sink, vanity mirror, Microphor vacuflush toilet and heated towel racks.

### *Galley:*

- Further aft to port is a very well designed galley that was mocked up several times during construction and has proven to be efficient, both at anchor and underway.
- The area is partially open to the pilothouse above for additional light and ventilation.

### *Lower Dinette:*

- To starboard is a very nice dinette/breakfast nook with a large fixed table that also doubles as additional countertop space for the galley.
- There are bookshelves outboard, and storage under the seats.
- The table is also used as a chart table, with chart storage built in, and it is a comfortable place to gather, whether at sea or at anchor.

### *Pilothouse/Main Saloon:*

- The most unique feature of this yacht is the raised main salon/pilothouse that boasts almost full 360 degree views.
- To port is a U-shaped dining area with a cocktail table that expands to a dining table.
- Two chairs to starboard can move over to provide space for six to dine in comfort.
- Also to starboard is a fully functional piloting station along with the main navigational equipment, electrical breaker panels, a small refrigerator for drinks and entertainment equipment, including an up/down TV.

### *Aft Landing:*

- Moving aft and down four steps is a landing area with additional breaker panels and the washer/dryer, in addition to easy access to the engine room, study and guest accommodations.

### *Study/Office Area:*

- Aft to port is a cozy office area with desk, settee and bookshelves – a great place to work quietly or read in peace.

---

### *Port Guest Cabin:*

- Aft and to port through the office area is a private guest cabin with twin single berths side by side.
- There is a wide bureau with vanity mirror and a full-height hanging locker.
- Light and ventilation are provided by a deck hatch and two opening portholes.

### *Starboard Guest Cabin:*

- Aft and to starboard is the second guest cabin, featuring a queen-sized double berth.
- There is a wide bureau with vanity light, a full-height hanging locker and a small seat.
- A deck hatch and two opening portholes provide great light and ventilation.

### *Aft Heads Compartment and Shower:*

- A head with separate shower stall is located off the aft landing for use by guests.
- Features include sink, vanity mirror, Microphor vacuflush toilet and heated towel racks.

---

## **Deck Equipment**

---

### *Rig:*

- The rig is generous in size, giving the boat a good light-air performance.
- It is a cutter headed sloop rig with outer large genoa and inner heavy-weather staysail.
- Everything above deck is oversized for strength and reliability.
- Southern Spars triple spreader aluminum rig and furling boom (rebuilt 2012).
- Stainless rod standing rigging.
- Reckman hydraulic genoa furler (rebuilt 2010).
- Reckman manual furler for staysail which is self-tacking.
- Spinnaker/whisker pole stored on front of mast.
- Navtec hydraulic back stay and boom vang with control panel in cockpit.

- Main boom preventer.

#### *Winches:*

- 2 x Lewmar 72 ST hydraulic primary winches.
- 2 x Lewmar 58 ST hydraulic mainsheet/secondary winches.
- 2 x Lewmar 48 ST mast winches.

#### *Sails:*

- Hood Vectran furling genoa (new 2012).
- Doyle Stratis furling mainsail with full length battens (new 2013).
- The mainsail is a large sail that is easily handled with the in-boom furling.
- Doyle Stratis furling staysail (new 2013).
- North asymmetric cruising spinnaker (2005).

#### *General:*

- Bauer dive compressor.
- Automatic salt water washdown for anchor and chain.
- 5 x Custom flush deck hatches.
- 9 x Lewmar deck hatches (2011).
- 12 x Lewmar opening portholes.
- Custom cockpit table that folds down and becomes the cockpit floor when not in use.
- 3m Aluminium passarelle with handrail.
- Bosun's chair.

#### *Anchoring & Mooring Equipment:*

- Lewmar anchor windlass with remote at helm.

- Bruce 120 lb. anchor with 120' of 7/16" chain rode and 300' of 1" nylon rode.
- Delta 60 lb. anchor with chain and rode.
- Fortress anchor with chain and rode.
- Folding stern anchor stored aft with rode and chain.

#### *Covers, Canvas & Cushions:*

- Cockpit cushions, blue Sunbrella.
- Dodger (new, 2014).
- Bimini (new, 2014) with connector to dodger.
- Side curtains.
- Aft deck awning on rigid frame for protection in all conditions, also with side curtains.
- Sun covers for all pilothouse windows.
- Wheel cover.
- Interior upholstery covers.
- Padded table and floor covers.

#### *Tender & Outboard:*

- Simpson Lawrence stainless steel davits with electric hoist.
- Zodiac 14' dinghy (2008) with lifting straps for davits (new tubes, 2015).
- Yamaha 40hp four-stroke outboard motor.

#### *Safety Equipment:*

- Sea Hornet alarm monitoring all systems on the boat including mechanical, electrical, fire, bilge and entry.
- Plastimo 8-man liferaft.
- 2 x MOB automatic lifebuoys.



- 10 x Lifejackets.
- 8 x Safety harnesses.
- Jacklines.
- Flares.
- ACR EPIRB.
- Large first aid kit.
- Hand-held search light.

## **Exclusions**

---

Owner's personal belongings.

## **Disclaimer**

---

The Company offers the details of this vessel or yacht in good faith but cannot guarantee or warrant the accuracy of this information nor warrant the condition of the vessel. A buyer should instruct his representatives, agents, or his surveyors, to investigate such details as the buyer desires validated. This vessel or yacht is offered subject to prior sale, price change, or withdrawal without notice.

# PHOTOS







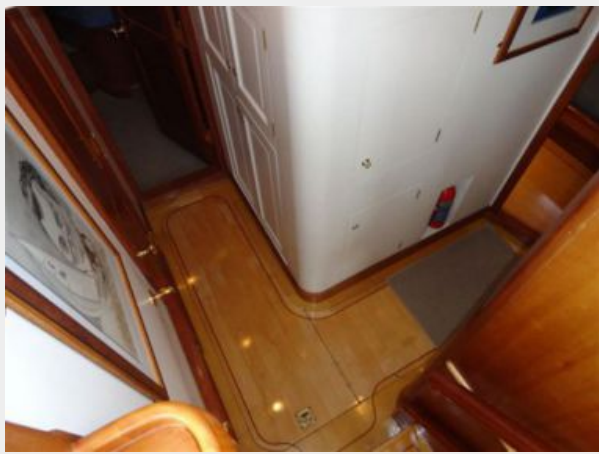





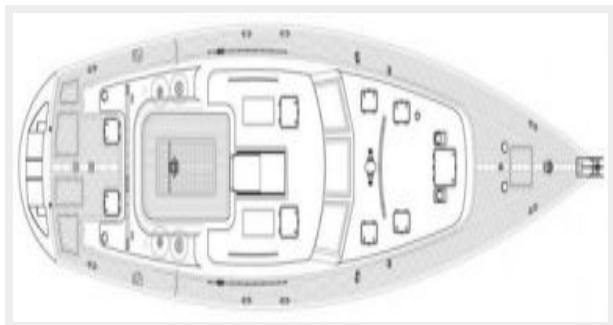
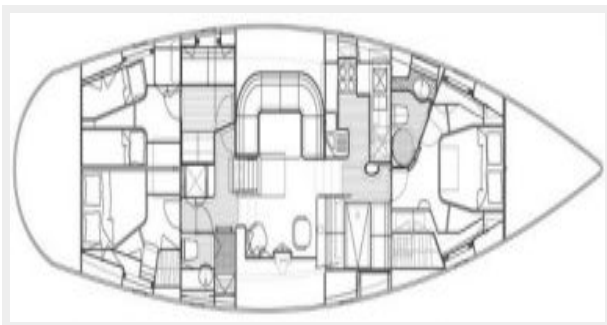
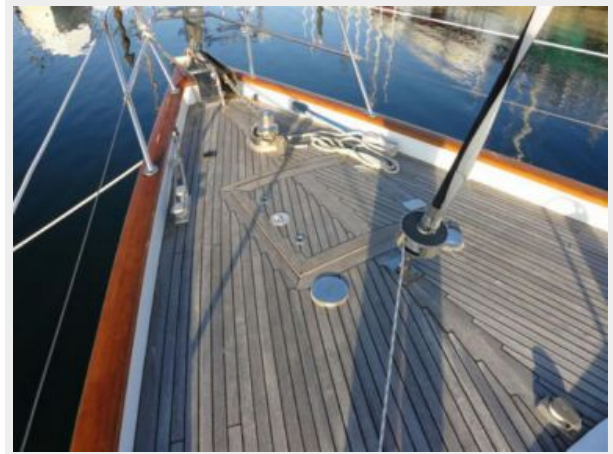



# CONTACTS

---

Andrey Shestakov, leading yacht broker of the sales department of Shestakov Yacht Sales Inc. Shestakov Yacht Sales Inc., the official representative of the Miami/Fort Lauderdale FL headquarters.

## Contact details

---

Email: [andrey@shestakovyachtsales.com](mailto:andrey@shestakovyachtsales.com)

Web: [shestakovyachtsales.com/en/](http://shestakovyachtsales.com/en/)

## Telephones

---

USA: +1(954)274-4435

## Office hours

---

Monday – Saturday: **9:00 - 21:00** EDT

Sunday: **closed**

## Address

---



Harbour Towne Marina, 850 NE 3rd St,  
STE 213, Dania, FL 33004