

ECLIPSE — NAUTOR'S SWAN



Builder: NAUTOR'S SWAN

Year Built: 1983

Model: Cruising Sailboat

Price: PRICE ON APPLICATION

Location: Spain

LOA: 47' 2" (14.38m)

Beam: 14' 6" (4.42m)

Min Draft: 7' 2" (2.18m)

Cruise Speed: 6 Kts. (7 MPH)

Max Speed: 8 Kts. (9 MPH)

Our experienced yacht broker, Andrey Shestakov, will help you choose and buy a yacht that best suits your needs **ECLIPSE — NAUTOR'S SWAN** from our catalogue. Presently, at Shestakov Yacht Sales Inc., we have a wide variety of yachts available on our sale's list. We also work in close contact with all the big yacht manufacturers from all over the world.

If you would like to buy a yacht **ECLIPSE — NAUTOR'S SWAN** or would like help answering any questions concerning purchasing, selling or chartering a yacht, please call **+1(954)274-4435**

TABLE OF CONTENTS

TABLE OF CONTENTS	2
SPECIFICATIONS	4
Overview	4
Basic Information	4
Dimensions	4
Speed, Capacities and Weight	4
Accommodations	4
Hull and Deck Information	5
Engine Information	5
DETAILED INFORMATION	6
Broker's Comments	6
Construction	7
Machinery	7
Electrical Systems	8
Plumbing Systems	8
Tankage	9
Navigation Equipment	9
Domestic Equipment	10
Accommodation	11
Deck Equipment	13
Exclusions	17
Disclaimer	17
PHOTOS	18
CONTACTS	24
Contact details	24
Telephones	24
Office hours	24
Address	24

SPECIFICATIONS

Overview

A very smart member of the most successful class in the whole sisterhood - 109 of these were launched. This Swan 46 has been much updated in this ownership combining great performance with comfort and style.

Basic Information

Category: Cruising Sailboat

Model Year: 1983

Year Built: 1983

Refit Year: 2002

Refit Type: /2003

Country: Spain

Dimensions

LOA: 47' 2" (14.38m)

LWL: 37' 11" (11.56m)

Beam: 14' 6" (4.42m)

Min Draft: 7' 2" (2.18m)

Speed, Capacities and Weight

Cruise Speed: 6 Kts. (7 MPH)

Max Speed: 8 Kts. (9 MPH)

Displacement: 31305.641204 Pounds

Water Capacity: 110.95226184 Gallons

Fuel Capacity: 97.74365924 Gallons

Accommodations

Total Cabins: 2

Total Berths: 8

Total Heads: 2

Hull and Deck Information

Hull Material: GRP

Deck Material: Teak

Hull Finish: Stainless Steel

Hull Designer: German Frers

Engine Information

Engines: 1

Manufacturer: Perkins

Model: 4.154M

Engine Type: Inboard

Fuel Type: Diesel

DETAILED INFORMATION

Broker's Comments

The Swan 46, with 109 hulls completed, is one of the most successful Swans classes ever built. They succeed not only as exciting yachts that fulfil everyone's expectations of style and luxury, but they are also accomplished regatta yachts.

ECLIPSE was delivered to her first owner in June 1983 in Scotland as a competition version Swan 46 and with a 3 spreader tall rig and deep keel. After a very successful few years of racing, the interior was modified for cruising.

She was bought by her present Finnish owner in Mallorca in May 2001 and wintered 2001/2 in Portugal. In his ownership she enjoyed a significant refit in the winter of 2002-3 with further works accomplished in 2003-4 at the specialist Nautor refit yard "Xpilia" in Kokkola, Finland (very close to the Nautor Swan yard). These refits included - new teak decks, overhaul of the rig, deck hardware repositioned and replaced, new electronics, central heating added, a modified keel, the addition of the aft entrance to the aft cabin and a major engine overhaul with zero-ing of hours.

Her owners have enjoyed using the yacht for family cruising and together they have sailed in the Western Mediterranean, the English Channel & Solent, the North Sea, and the Baltic Sea. In 2009 they sailed ECLIPSE across the Atlantic to the Caribbean. Based in Antigua in the past few years, she has spent the periods when not in use ashore. During the period 2002- 2008 the yacht spent the winters ashore inside a warm shed in Finland.

Although the owners have not really raced the yacht they did attend the Swan 40 Year rRgatta in Turku in July 2006. In 2013 they won the Rolex Swan Cup cruising class in the BVI.

ECLIPSE was shipped back to Palma in March 2014.

The yacht has always been professionally maintained with equipment updates annually. For example in 2013, the windlass and anchor chain was replaced, service batteries replaced and so too was the compressor unit of the refrigerator.

Construction

RCD Status: Our understanding is that the yacht is exempt from the essential safety requirements of Directive 94/25EC (Recreational Craft Directive) as she was built and placed into use within the EU prior to 1998.

Hull, Deck & Superstructure Construction:

- Hull construction is single skin GRP and finished with white gelcoat.
- Coaming stripes and waterlines blue.
- Bottom finished in Blue anti-fouling paint.
- New teak deck (2002-3).
- Entrance also from aft cockpit to aft cabin, added in 2004.
- GRP surfaces on deck painted 2004, including coaming stripes.
- Aluminium anodized toe rails.

Keel & Rudder:

- Fin keel with bulb.
- Keel modified (to reduce draft) with a lead bulb – works were done in Finland and authorised by Nautor.
- Balanced spade rudder with roller bearings.

Machinery

Engine & Gearboxes:

- Perkins 4.154 M, 58 hp diesel engine fresh water, intercooled, completely renovated 2004. Hurth reduction gearbox.

Maintenance & Performance:

- Maximum speed: 8 knots, cruising speed: 6 - 7 knots.

Propulsion & Steering:

- Pedestal completely renovated and painted 2004.
- Stainless Steel Wheel.

- Max-prop 3-blade feathering propeller.
- Spare two-blade Max-prop.
- Elk hide on steering wheel.

Electrical Systems

Voltage Systems:

- 220volt and 24volt AC and DC systems.
- 1 x 220volt deck inlet.

Battery Banks:

- 2 x 12volt Exide gel cell batteries for service (2013).
- Service Batteries 12 x 2 V = 24 V/240 Ah.
- Engine battery 93 Ah 24 V, 2004.

Battery Chargers:

- Mastervolt battery charger and inverter (2005).

Shore Power:

- Shore power with Mastervolt battery charger.
- Shore power cord.

Plumbing Systems

Fresh Water & Water Heating System:

- Hot water via shore supply immersion heater element as well as engine heat exchanger. Water pressure system.

Bilge Pumps:

- Whale Gusher 8 bilge pump.
- Electric Bilge Pump Rule 3700.
- Two manual bilge pumps, one by helm and one by chart table inside.

Tankage

Fuel:

- Two stainless steel fuel tanks with total capacity of 370 litres (97 US gallons).

Fresh water:

- Stainless steel fresh-water tanks (4) with total capacity of 420 litres (approx 110 US gallons).
- Plus 3 further “reserve tanks” that have not been used – they were installed for long passages.

Grey/Blackwater holding tanks:

- Stainless steel holding tanks for both heads.

Navigation Equipment

- All Raymarine instruments new 2004.
- Raytheon RL 80 CRL Radar/plotter 12” on crash bar above compass.
- ST 60 Tridata system.
- ST 60 Wind + 2 MFD´s.
- 120 GPS receiver + Pathfinder PC –kit.
- Raymarine Autopilot interconnected with rest of the instruments.
- VHF.

At Helm:

- Raymarine RL80C chart plotter and radar.
- 1 x ST60 Tridata Raymarine.
- 1 x ST6002 Raymarine auto pilot.
- 1 x ST60 analogue wind direction, true and apparent.
- 1 x Suunto pedestal compass.

At Navigation Station:

- Raymarine Autohelm ST60 Multi

- Radio Ocean RO-4800 VHF.
- NAV4 Navtex Plus Fax machine for weather.
- Iridium sat phone.

Note: Grounding plate for single side band (no SSB on board).

Domestic Equipment

Galley:

- Isotherm holding plate refrigerator, top loading (compressor new 2013).
- Double stainless steel sink.
- Hot and cold pressure water.
- Manual foot pump for salt water.
- Force 10 gimble 4 burner stove with oven.

Heads/Showers:

- Cockpit shower, hot and cold water shower.
- Two Jabsco marine toilets (old Blake ones were replaced in 2012).
- Two wash-basins and two showers – drain to sump tank.

Heating & Ventilation:

- Eberspacher D5W diesel powered waterborne with outlet in the cabins (2004).
- Eberspacher diesel forced water central heating system with thermostat in each cabin, which enables to adjust temperature in every cabin separately. The heater is operated from the electric control panel and is equipped with a timer function. The unit itself is in stern.
- 2 x Dorade vents each side of forward companionway.
- 2 x Dorade vents at stern/transom.
- 4 x new Cowls for the Dorade (not installed).
- 4 x Opening deck hatches.
- Sliding forward hatch.
- Sliding companionway and aft entrance hatches with wash-board.

Entertainment:

- Sony cockpit speakers.

- Pioneer DEH11E AM/FM CD Player.
- Pioneer Multi Disc Player in main saloon.

Accommodation

Summary of Accommodation:

- Sleeps 8 in 2 separate sleeping cabins plus 4 more in the main saloon.
- The interior is standard for Swan 46 Mk 1, except for the following: Aft cabin with large double berth to starboard and single to port. Extra entrance from aft cockpit; Saloon, with U shape settee to port converts into a double berth with pilot berth above; Lockers / bookshelves (instead of pilot berth) starboard with music centre; Forward cabin, fixed wooden berths with storage underneath.
- New white/blue fabric 2004 – still in good condition as has nearly always had covers on.
- Interior was partly revarnished and part of the ceiling panels were renewed 2004.
- Varnished, hand rubbed, Burmese teak interior. Teak and holly cabin sole.

Description of layout from forwards:

Forward Cabin:

- Locker Forward.
- "V" Berth for 2 with white and blue pattern fabric.
- Storage under the "V" berth.
- 2 x Hella Turbo Fans.
- 2 x Hanging lockers aft to starboard with 2 lockers under.
- Silencio FAI cabin heater with thermostat.

Forward Heads Compartment:

- Located portside after "V" berth.
- Jabsco manual head.
- Hot and cold pressure water.
- Foot pump water.
- Telephone type shower.
- Teak floor grating.
- 2 x Lockers outboard.
- White fibreglass unit to 1/2 height.

Main Saloon:

- Located aft of the forward cabin.
- "U" shaped dinette to port with insert to make a double berth.
- Table on centreline with leaves Port and Starboard, glasses storage in middle.
- Pilot berth outboard to port with lee cloth.
- Locker with shelves forward to port.
- Portside storage space outboard of backrest.
- Straight settee to starboard with storage behind back rest.
- Shelving and lockers above and outboard with more glassware storage forward.
- Silencio FAI cabin heater with thermostat – one unit in saloon and one in forward cabin.
- Isotherm refrigeration system (unit is under the port settee in saloon).
- 2 x Hella Turbo fans (starboard one not working).

Galley:

- Located port aft of saloon.
- Storage lockers outboard and behind sink, stove and fridge.
- Dish draining locker over sink.
- Drawers under sink and dry storage under sink.
- Deep storage cupboard centreline across from sink.
- Large pullout trash bin.
- 1 x Hella Turbo fan.
- 1 x 220 volt outlet.

Navigation Station:

- Located starboard side aft of saloon and facing forward.
- 5 x Drawers under. Chart and stowage in chart table.
- Surrounded by navigation, communication systems and with the AC/DC electrical panel outboard.

Master Cabin:

- Located aft of the Nav station with access either to starboard or port via the galley.
- Single berth to port.
- Large Single (small double bed) to starboard.
- Double seat separates the berths with storage under the seat.
- Hanging locker forward on port with locker underneath.
- Hanging locker forward on starboard with locker underneath.
- Shelving port and starboard.

- 2 x Hella Turbo Fans.
- Aft Companion way to aft cockpit with sliding hatch.

Master Heads Compartment:

- Jabsco manual head.
- Hot and cold pressure water.
- Foot pump water.
- Telephone type shower.
- Teak floor grate.
- 2 x Lockers outboard.
- White fibreglass unit to 1/2 height.

Deck Equipment

Rig:

- All deck hardware renewed 2004, including re-arranging of winches (some winches removed).
- 2 x Antal stoppers (3 line) added on deck.
- Main halyard led aft to electric winch.
- Curved mainsheet track (track was repositioned in the refit to allow for the sliding aft entrance hatch).
- Genoa tracks port and starboard each with 2 cars.
- 3-spreader Nautor mast, taller than standard for better light airs sailing.
- Mast and booms (were anodized) aluminium made by Nautor and were painted 2004.
- Stainless steel rod rigging.
- Hydraulic inner forestay adjuster, inner stay of 1 x 19 stainless steel wire.
- Baby forestay 1 x 19 stainless steel.
- Check stays.
- Backstay s/s rod.
- All sheaves in mast renewed 2004.

- Folding mast steps, 4 pcs.
- Spinnaker track on front of mast, 2004.
- Two spinnaker poles (1 carbon fibre with some corrosion at end fitting; 1 original Nautor one).
- One jockey pole.
- Mainsail with “stack pack” system.
- Reckmann furling head stay, installed 2006.
- 2 x Navtec hydraulic systems; 1 for - back-stay, baby-stay, flattening, head-stay; 1 for boom-vang; 2 x control boxes with gauges, both on front of helm pedestal.
- New genoa sheets and main outhaul (2007).
- New Dynema genoa and main halyards 2004.
- New split runners without metal joints 2004.
- 2 x Spinnaker halyards.
- 1 x Jib halyard.
- 1 x Main halyard.
- Running rigging lead aft to forward companionway, led through 6 ANTAL line stoppers.
- Foredeck light and steaming light.
- 1/4 moon at mast to store inner forestay.
- Headsail deck lights port and starboard.

Winches:

- 2 x Harken 66-2 electric winches. 2004.
- 2 x Lewmar 44 AST 2 speed halyard with jammers.
- 1 x Lewmar 44 ST 2 speed mainsheet.

Note: The owner has in Finland two Lewmar 44AST 2 speed winches from the yacht – he kept as spares.

Sails:

- Mast top above water level: 20.7 m.
- I = 19.20m (standard was 17.7m).
- Mainsail with battens - Dacron - (2005) by North.
- Furling Genoa -135%, (2007) by Doyle.
- Asymmetric cruising spinnaker in a snuffer by Crusader.
- Inner forestay jib, by Hood.
- Storm jib by Hood.

Sail Areas:

- Fore-triangle 53 m².
- Main 46 m².
- Genoa 150% 80 m².
- Spinnaker. 185 m².

General:

- Deck wash, seawater, in cockpit aft.
- Stainless steel stanchions, pulpit and pushpit.
- Gate in stern rail. Gates in lifelines port and starboard.
- S/S swim ladder on transom.
- New coach roof windows, hardened glass, 2005.
- Stainless steel antenna post on transom.
- Cockpit table.
- Flag pole.
- Boarding ladder/passerelle aft gangway.

Anchoring & Mooring Equipment:

- Electric Quick anchor windlass with chain gypsy and rode winch, new in 2013.
- Up and down foot control buttons on deck.
- Bruce 20 kgs anchor.
- Anchor chain, new 2013.
- Single Stainless steel stem-head fitting with Delrin Bow Roller
- Bow locker (added in refit in Finland) and further access down to the anchor chain locker.
- Mooring cleats forward, amidships and aft.

Covers, Canvas & Cushions:

- Curved helmsman cockpit seat.
- Large spray-hood over aft cockpit, 2012.
- Small spray-hood over main entrance, 2004.
- Wheel & binnacle cover.
- Deck awning.
- Sun bimini with s/s frame (bimini new 2010).
- Mainsail cover / stack-pack, new 2014.

Tender & Outboard:

- Davit for outboard engine with bracket on stern rail.
- RIB AB dinghy with 9.8 hp Tohatsu outboard.

Safety Equipment:

- Stainless steel 1 x 19 double lifelines.

- Liferaft - 6 person, in a soft valise (serviced June 2014). 2 x Horseshow life rings--one with man overboard light.

Exclusions

Owner's personal belongings.

Disclaimer

The Company offers the details of this vessel or yacht in good faith but cannot guarantee or warrant the accuracy of this information nor warrant the condition of the vessel. A buyer should instruct his representatives, agents, or his surveyors, to investigate such details as the buyer desires validated. This vessel or yacht is offered subject to prior sale, price change, or withdrawal without notice.

PHOTOS



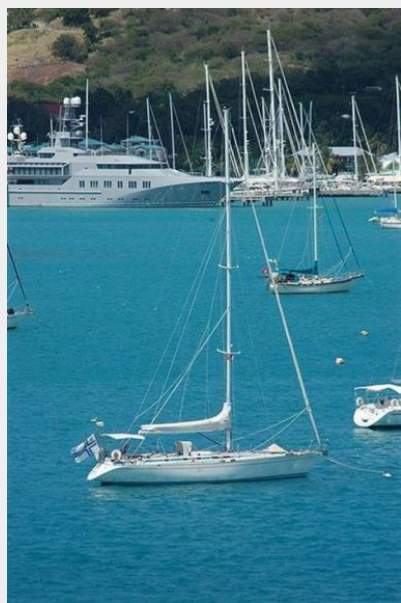
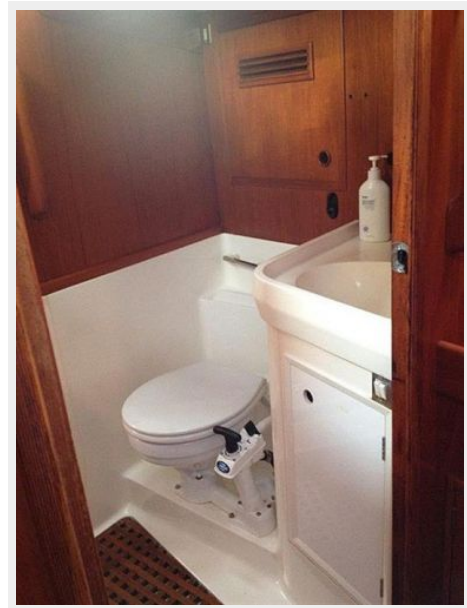



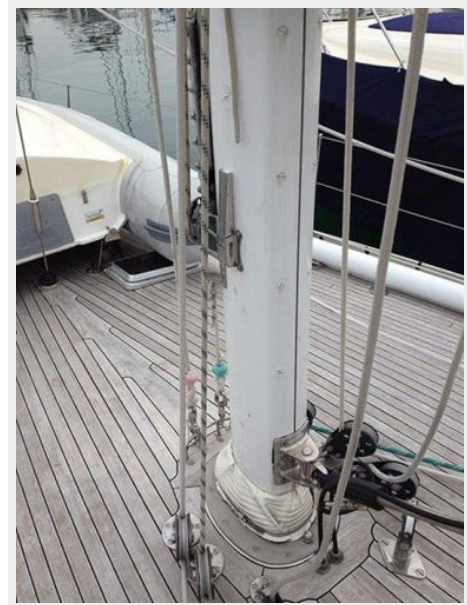
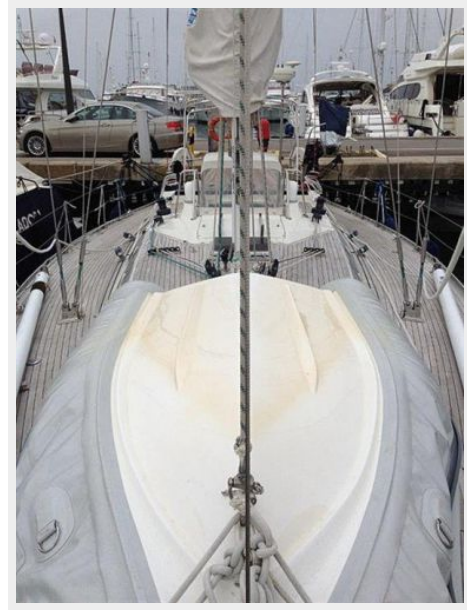

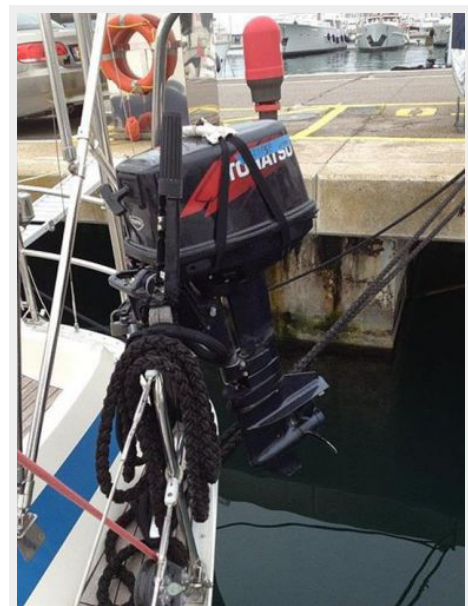
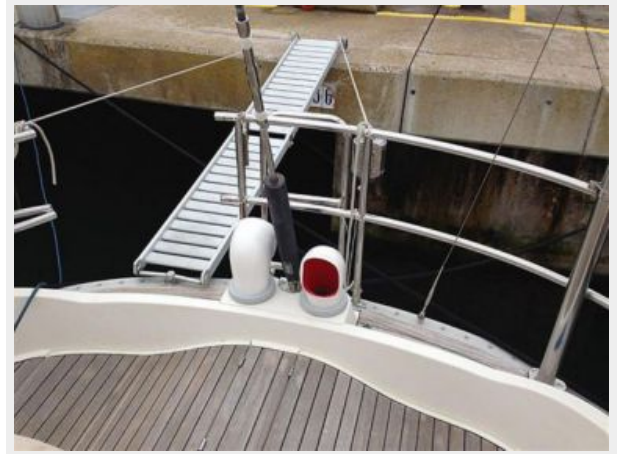

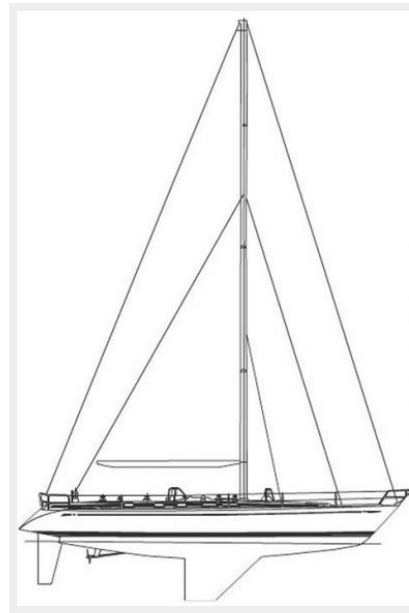
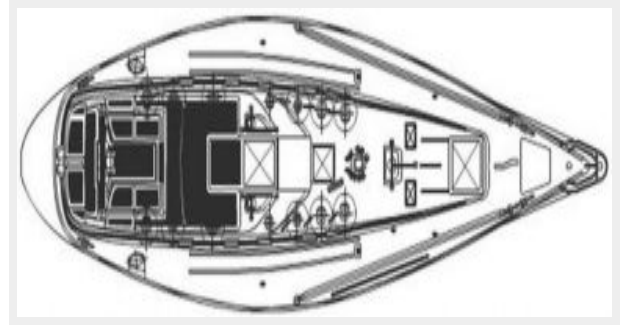
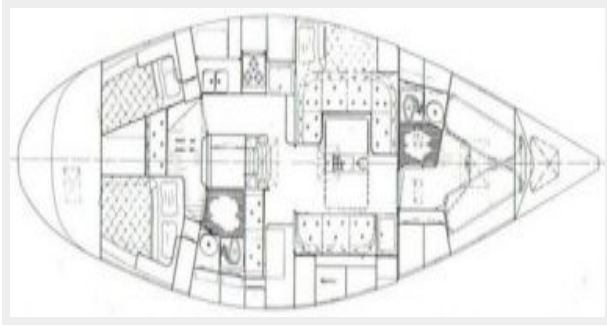

CONTACTS

Andrey Shestakov, leading yacht broker of the sales department of Shestakov Yacht Sales Inc. Shestakov Yacht Sales Inc., the official representative of the Miami/Fort Lauderdale FL headquarters.

Contact details

Email: andrey@shestakovyachtsales.com

Web: shestakovyachtsales.com/en/

Telephones

USA: +1(954)274-4435

Office hours

Monday – Saturday: **9:00 - 21:00** EDT

Sunday: **closed**

Address



Harbour Towne Marina, 850 NE 3rd St,
STE 213, Dania, FL 33004