

SUNSHINE — FAIRWAYS MARINE



Builder: FAIRWAYS MARINE

Year Built: 1977

Model: Motorsailor

Price: PRICE ON APPLICATION

Location: United States

LOA: 54' 0" (16.46m)

Beam: 15' 0" (4.57m)

Min Draft: 6' 6" (1.98m)

Our experienced yacht broker, Andrey Shestakov, will help you choose and buy a yacht that best suits your needs **SUNSHINE — FAIRWAYS MARINE** from our catalogue. Presently, at Shestakov Yacht Sales Inc., we have a wide variety of yachts available on our sale's list. We also work in close contact with all the big yacht manufacturers from all over the world.

If you would like to buy a yacht **SUNSHINE — FAIRWAYS MARINE** or would like help answering any questions concerning purchasing, selling or chartering a yacht, please call **+1(954)274-4435**

TABLE OF CONTENTS

TABLE OF CONTENTS	2
SPECIFICATIONS	4
Overview	4
Basic Information	4
Dimensions	4
Speed, Capacities and Weight	4
Accommodations	4
Hull and Deck Information	5
Engine Information	5
DETAILED INFORMATION	6
Owner's Comments	6
Construction	6
Machinery	7
Electrical Systems	7
Plumbing Systems	8
Tankage	9
Navigation Equipment	9
Domestic Equipment	10
Accommodation	11
Deck Equipment	11
Exclusions	13
Disclaimer	13
PHOTOS	14
CONTACTS	19
Contact details	19
Telephones	19
Office hours	19
Address	19

SPECIFICATIONS

Overview

Lovely example of the Fisher 'Super' 46 concept with extended rig allowing for surprising performance under sail. Originally commissioned for an astronaut, although in his ownership, her travels were less extensive.

Basic Information

Category: Motorsailor

Sub Category: Cruising Sailboat

Model Year: 1977

Year Built: 1977

Country: United States

Dimensions

LOA: 54' 0" (16.46m)

LWL: 40' 0" (12.19m)

Beam: 15' 0" (4.57m)

Min Draft: 6' 6" (1.98m)

Speed, Capacities and Weight

Displacement: 49998.63639898 Pounds

Water Capacity: 216.092738536 Gallons

Holding Tank: 47.815141412 Gallons

Fuel Capacity: 660.43013 Gallons

Accommodations

Total Cabins: 3

Total Berths: 6

Total Heads: 1

Hull and Deck Information

Hull Material: GRP

Deck Material: GRP

Hull Configuration: Long Keel

Hull Finish: Stainless Steel

Hull Designer: Wyatt & Freeman

Engine Information

Engines: 1

Manufacturer: Ford Lehman

Engine Type: Inboard

Fuel Type: Diesel

DETAILED INFORMATION

Owner's Comments

The flagship of the Fisher range is a true world cruiser capable of the most arduous passage in safety and comfort. The wheelhouse provides lots of space and retreat from hot sun or cold rain.

Originally this yacht was commissioned by the astronaut Charles Pete Conrad in which he cruised the Pacific. Then to another own who sailed with his family from Los Angeles to Virginia. The boat was then decommissioned and extensive refit began in 1990 and finished in 2001 when I became the owner. I have sailed this boat around the Caribbean and up the East coast of the USA with my family. My age has caught up and I am ready to pass the boat on.

During the refit the modifications to this boat included a bowsprit designed by Wyatt and Freeman, conversion to a cutter rig, the aft cabin being made into a double, and a new galley.

The boat was Awlgrippied including the mast and still shows bright. Also air conditioning, generator, new wiring and plumbing were replaced.

Construction

Hull, Deck & Superstructure Construction:

- Heavy duty hand laid GRP.
- Double skin GRP bulwarks; balsa core deck.
- Teak laid deck in cockpit.

Keel & Rudder:

- 10 tons encapsulated cast iron keel.
- Keel hung rudder.
- Prop in aperture .

Machinery

Engine & Gearboxes:

- 1 x Ford Lehman 120hp diesel engine.
- Hand start fitted.
- Electronic engine controls.

Maintenance & Performance:

- Date of Last Service: February 2014.

Propulsion & Steering:

- Whitlock rod steering with two positions.
- Dripless propeller shafts.
- Three blade fixed prop.
- Emergency tiller.

Note: Many spares including hoses, heat exchangers and a spare propeller onboard.

Electrical Systems

Voltage Systems:

- 12v DC system.
- 125v AC system.
- Large breaker panel for all systems.

Battery Banks:

- 4 x Deep cycle batteries.

Battery Chargers:

- 2 x Battery chargers.

Alternators:

- 200amp heavy duty alternator.

Generator:

- Westerbeke 8kW generator.

Shore Power:

- Shore power connection.
- Shore power isolator.

Other Electrical:

- 3000 watt inverter.

Note: Many spares including alternators on-board.

Plumbing Systems

Fresh Water & Water Heating System:

- 12v pressurised Hot and cold water system.
- Calorifier 125v.

Watermaker:

- Available but is currently off the yacht.

Bilge Pumps:

- 1 x Manual bilge pump.
- 2 x Electric bilge pumps.

Tankage

Fuel:

- Total capacity of 2,500 litres (550 gallons) in 3 x stainless steel tanks.

Fresh water:

- Total capacity of 818 litres (180 gallons) in 1 x stainless steel tank.

Grey/Blackwater holding tanks:

- 181 litres (40 gallon) black water tank.

Navigation Equipment

- SSB Kenwood radio.
- 2 x Garmin GPS plotters.
- Furuno radar.
- AIS.
- 2 x VHF radio.
- 2 x Self steering system – Raytheon and Cetrek.
- 3 x Compasses.
- B&G system.
- Fax connected to SSB.
- Loud hailer.

- Laptop station.

Domestic Equipment

Galley:

- Norcold fridge/freezer.
- 4-burner cooker with oven.
- Microwave.
- Large icebox.

Heads/Showers:

- Blake Victory WC

Heating & Ventilation:

- Eberspacher heater.
- 2 x 16,000 BTU hot and cold AC.
- 5 x 12v fans.
- Wind sock.

Entertainment:

- 26" TV in saloon, 20" TV in cabin.
- 3 x Stereo with DVD player.

Lighting:

- 12v deck head and reading throughout.
- Many 125v lights.

Accommodation

Summary of Accommodation:

- A mixture of solid teak and teak veneers throughout, teak and holly sole.
- Two main matching cabins with bunk beds and large wardrobes and cupboards.
- Aft cabin with double bed and desk, also sink unit with hot and cold water.
- Large sofa to starboard of saloon, dinette to port, galley and many cupboards, wardrobes and bookcases.
- Heads compartment with WC, shower and sink.
- Engine room access from wheelhouse above and from the side on the passageway. Hanging lockers to starboard.
- A workshop containing the batteries bench and spare parts.
- Wheel house with captain's chair, L shaped sofa to seat 7 or 8 persons.

Deck Equipment

Rig:

- Cutter headed ketch rig with white painted spars.
- Stainless steel rigging.
- Conventional slab reefing main and mizzen.
- Profurl furling systems for foresails.
- Lazy jack on main.

Winches:

- 2 x Large self-tailing primary winches.
- 4 x Secondary winches.

Sails:

-
- New Tanbark sails in 2002.
 - Main.
 - Mizzen.
 - Stay sail.
 - Yankee.
 - Storm jib.
 - Storm main sail.

General:

- All stainless on deck.
- 2 x Large storage bins in front of deck house.
- Aluminium davits.

Anchoring & Mooring Equipment:

- Anchor locker containing 400' galvanized chain.
- 400' feet of 1" braided line.
- 1 x CQR anchor 75lb.
- 1 x Danforth anchor 45lb.
- 12v Simpson Lawrence anchor winch.

Covers, Canvas & Cushions:

- Full awning.

Tender & Outboard:

- Tinker tramp with as new outboard and sailing kit.

Safety Equipment:

- 8-man liferaft and various other safety equipment.

Fire-fighting equipment:

- Auto fire extinguishers in engine room.
- 4 x Hand fire extinguishers.
- Fire alarm.

Exclusions

Owner's personal belongings.

Disclaimer

The Company offers the details of this vessel or yacht in good faith but cannot guarantee or warrant the accuracy of this information nor warrant the condition of the vessel. A buyer should instruct his representatives, agents, or his surveyors, to investigate such details as the buyer desires validated. This vessel or yacht is offered subject to prior sale, price change, or withdrawal without notice.

PHOTOS









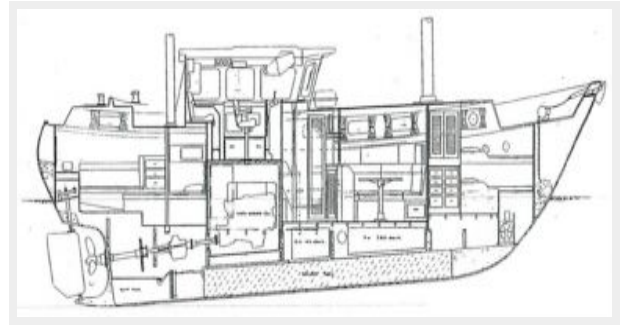

CONTACTS

Andrey Shestakov, leading yacht broker of the sales department of Shestakov Yacht Sales Inc. Shestakov Yacht Sales Inc., the official representative of the Miami/Fort Lauderdale FL headquarters.

Contact details

Email: andrey@shestakovyachtsales.com

Web: shestakovyachtsales.com/en/

Telephones

USA: +1(954)274-4435

Office hours

Monday – Saturday: **9:00 - 21:00** EDT

Sunday: **closed**

Address



Harbour Towne Marina, 850 NE 3rd St,
STE 213, Dania, FL 33004