

SPECTRUM — SUNSEEKER



Судостроитель: SUNSEEKER

Год постройки: 2005

Модель: Моторная яхта

Цена: ЦЕНА ЯХТЫ ПО ЗАПРОСУ

Местонахождение: United States

Длина общая: 75' 0" (22.86m)

Ширина: 18' 6" (5.64m)

Макс. осадка: 5' 6" (1.68m)

Крейс. скорость: 28 Kts. (32 MPH)

Макс. скорость: 33 Kts. (38 MPH)

Купить Spectrum — SUNSEEKER а также выбрать подходящую вам яхту из нашего каталога яхт вам поможет опытный яхтенный брокер Андрей Шестаков. На сегодняшний день компания Shestakov Yacht Sales Inc. имеет большое количество яхт в собственном списке продаж, а также тесно сотрудничает со всеми крупными яхтенными производителями по всему миру.

Для того чтобы купить яхту Spectrum — SUNSEEKER а также проконсультироваться по любому вопросу связанному с покупкой, продажей, чартером яхт позвоните по телефону **+7(918)465-66-44**.

ОГЛАВЛЕНИЕ

ОГЛАВЛЕНИЕ	2
ХАРАКТЕРИСТИКИ	4
Обзор	4
Основная информация	4
Размеры	4
Скорость, вместимость и масса	4
Размещение	4
Корпус и палуба	5
Информация о двигателе	5
ПОДРОБНОЕ ОПИСАНИЕ	6
Aft Cockpit	6
Galley	6
Salon	6
Main Deck Helm	7
Fly Bridge	7
Swim Platform	8
Deck Equipment	8
Master Stateroom	9
Master Head	10
VIP Stateroom	10
VIP Head	10
Starboard Guest Cabin	11
Port Guest Cabin	11
Crew Quarters	12
Engine Room	12
Electrical Equipment	13
Systems	13
Исключения	13

Отказ от ответственности	14
ФОТОГРАФИИ	15
Port Profile	15
Starboard	15
Flybridge	15
Flybridge Helm	15
Aft Deck	15
Salon 1	15
Salon 2	16
Salon 3	16
Galley 1	16
Galley 2	16
Galley 3	16
Main Deck Helm Console	16
Master 1	17
Master 2	17
VIP	17
Head	17
Port Guest	17
Starboard Guest	17
Linen Locker	18
Main Deck Layout	18
Accommodation Deck Layout	18
КОНТАКТЫ	19
Контактная информация	19
Телефоны	19
Время работы	19
Адрес	19

ХАРАКТЕРИСТИКИ

Обзор

A great example of the Sunseeker Yacht 75 versatility, styled and designed with a unique configuration. This Sunseeker 75 is in immaculate condition and has been professionally maintained since new. Fitted with a bespoke layout of chestnut leathers and maple woodwork, she provides as modern, spacious and luxurious environment for her guests aboard.

Основная информация

Тип судна: Моторная яхта

Подкатегория: Sedan Cruiser

Модельный год: 2005

Год постройки: 2005

Страна: United States

Верх: Open W/Bimini Top

Открытая палуба мостика: Да

Размеры

Длина общая: 75' 0" (22.86m)

Длина по ватерлинии: 58' 6" (17.83m)

Ширина: 18' 6" (5.64m)

Макс. осадка: 5' 6" (1.68m)

Скорость, вместимость и масса

Крейс. скорость: 28 Kts. (32 MPH)

Макс. скорость: 33 Kts. (38 MPH)

Водоизмещение: 94140 Pounds

Вместимость воды: 291 Gallons

Объем топливного бака: 1453 Gallons

Размещение

Всего кают: 4

Всего ком. состава: 4

Койки экипажа: 2

Комм. состав экипажа: 1

Корпус и палуба

Материал корпуса: Fiberglass

Цвет корпуса: Dark Blue

Информация о двигателе

Двигатели: 2

Производитель: MAN

Тип двигателя: Inboard

Тип топлива: Diesel

ПОДРОБНОЕ ОПИСАНИЕ

Aft Cockpit

- Teak-laid cockpit floor
- Teak table & chairs
- Raritan ice maker
- Glendinning cable master w/ 100 amp power
- Underwater lights x 8-75 watt, 24v halogen bulb, aluminum
- Bronze casing
- Forward and aft deck wash down system
- Self draining
- Stairs to flybridge
- Stern seating
- Side storage lockers
- Stern safety doors
- Engine room access hatch
- 2 x stern capstan winches 24v and fairleads
- Cockpit speaker
- Overhead cockpit lights 24v
- Low-level courtesy lights in aft cockpit 24v
- Low-level courtesy lights on side decks 24v

Galley

- Electric refrigerators
- Dishwasher
- 4-ring ceramic stove
- Microwave/Convection Oven
- Custom granite counter and stainless steel backsplash
- Extra built-in storage in galley
- Custom galley sinks
- Hot and Cold water
- Rubbish bin
- Cupboard and drawer, stowage below
- Double AC sockets
- Fire extinguisher

Salon

- Large formal dining area in upper salon
- Bose Surround system in main salon

- Custom carpet runners in main salon
- 6-Disc CD player in salon with remote
- Creston Controls on flybridge helm for lighting and AV
- Two helm seats for lower helm
- Occasional seating in lower salon
- 40" Sony television
- Drinks cabinet
- Stainless steel sliding cockpit doors to aft cockpit
- Halogen overhead lighting 24v
- Low-level lights 24v

Main Deck Helm

- Custom helm seat
- Maptech 15" Navigation system
- Panasonic phone system with intercom
- SAT phone
- Fire alarm system with smoke detectors
- Simrad autopilot
- Console with walnut fascia
- Hydraulic power steering
- Wooden rimmed steering wheel
- Full analog engine instrumentation
- Electronic speed log
- Rudder indicator-Fresh-water gauge-Fuel gauge
- VHF radio dual station
- Trim tab controls
- Cigar lighter
- Compass
- Raymarine Radar Navnet II plotter
- Horn
- Switch panels
- Windscreen wipers with washers
- Glass holders

Fly Bridge

- Custom layout on flybridge including wetbar with granite top and 3 stainless steel stools, Gaggenau BBQ grill, icemaker, fridge and freezer (8 cu. ft.)
- Duplicate engine controls and instrumentation
- Duplicate autopilot controls
- Compass

- Custom helm seat
- Teak flooring
- Twin Sanshin spotlights
- Kahlenberg triple air horns w/ custom arch - Stainless
- KVH Satellite/phone systems
- Sunbrella cushions on all exterior seats
- Covers for upper and lower seats, tables, bridge bar and dash
- Stairs to cockpit
- Self draining
- Acrylic deflecting spray screen
- Hydraulic steering
- Fiberglass Table with cover
- Chrome mast, custom Black antennas, custom domes
- Custom steering wheel
- 8-person life raft and EPIRB
- Extended bimini top in dark Blue canvas
- Flybridge Tonneau cover
- Stainless steel guard rails and grab rails
- Glass holders
- Wetbar with hot and cold water, ice maker, ceramic griddle and refrigerator
- Radio/CD remote control
- Cockpit speakers
- Low-level flybridge lighting 24v
- Lights under radar arch 24v
- Steering indicator
- Trim tab control
- Radar and Chart plotter "Navnet II"

Swim Platform

- Teak-laid hydraulic lifting swim platform
- Hot and cold swimming shower
- Fresh-water connection
- Dockside AC shore power connection
- Stainless steel swim ladder
- Lazarette stowage for fenders
- Additional pair 12" mooring cleats
- Pair of retractable cleats for tender on port and starboard corners of swim platform

Deck Equipment

- Chafing bars for lines

- Dark Blue hull
- Side boarding ladder
- Passerelle Remote engine control
- Bow sunbathing cushions
- Fittings all in stainless steel
- Deck cleats
- Pulpit and cockpit rails
- Stainless steel fendering with rubber insert
- Stainless steel bow roller with anchor stop
- Electric winch and capstan with deck, cockpit and flybridge controls
- Chain locker fender stowage
- Curved direct glazed safety glass windscreen
- Fuel fillers port and starboard
- Fresh-water filler
- IMCO navigation lights
- Remote spotlight 24v
- Ensign staff and socket
- Fender tie bar under anchor locker lid
- Stainless steel bow plate
- Stainless steel Delta anchor and 60m chain

Master Stateroom

- 22" Sony TV
- Safe-2 brick with digital lock
- Custom master berth w/storage beneath and drawers in base-end
- Dressing table with mirror and stool
- Air conditioning
- Halogen overhead lights 24v
- 2 x Reading lights 24v
- 2 x Opening portholes with mosquito screens and curtains
- 4 x Large fixed side windows
- Double AC socket
- Radio/CD/DVD player
- Door to Ensuite bathroom
- Door to En suite walk in wardrobe
- Fitted carpet
- Custom cupboard
- Extra large closet
- Fitted sheets
- Custom dresser
- Custom wall features
- Creston controls for lights and AV

Master Head

- Tecma toilet
- Separate bidet in Master bathroom
- Extra storage in Master head
- Washbasin
- Taps and accessories
- Soap dispenser
- Large shower
- Extractor fan
- Air conditioning outlet
- Mirror
- Creston lights
- Seat in shower
- Toothbrush and glass holder
- Towel ring
- Halogen overhead light 24v
- Opening porthole with mosquito screen

VIP Stateroom

- Double berth with storage beneath and drawers in base end
- TV/Radio/CD/DVD
- Extra large closet
- Walk in wardrobe behind closed door
- Dressing table with stool
- Overhead lockers
- Air conditioning
- Flatscreen television
- Halogen overhead lights 24v
- 2 x Reading lights 24v
- 2 x opening portholes with mosquito screens and curtains
- Double AC socket
- Door to Ensuite toilet/shower
- Fitted carpet
- Creston Controls for Lighting and AV

VIP Head

- Tecma toilet
- Washbasin, Taps and accessories
- Soap dispenser

- Separate shower compartment
- Air conditioning outlet
- Extractor fan
- Mirrored vanity unit
- Shelved cupboard
- Seat in shower
- Toothbrush and glass holder
- Towel ring
- Halogen overhead light 24v
- Opening porthole with mosquito screen and blind
- Shaver socket 110v

Starboard Guest Cabin

- 2 x single berths
- Custom filler strips to convert twin berths into doubles
- Under berth storage
- Bedside unit with drawer
- 2 x reading lights 24v
- TV/Radio/CD/DVD
- Full hanging wardrobe
- Air conditioning
- Halogen overhead lights 24v
- Opening porthole with mosquito screen and curtains
- Double AC socket
- Overhead lockers
- Flat Screen television
- Tecma toilet
- Soap dispenser
- Washbasin w/taps and accessories
- Separate shower compartment
- Extractor fan
- Air conditioning outlet
- Mirrored vanity unit

Port Guest Cabin

- 2 x Single berths
- TV/Radio/CD/DVD
- Air conditioning
- Halogen overhead lights 24v
- Opening porthole with mosquito screen and curtain

- Tecma toilet
- Soap dispenser
- Taps and accessories
- Separate shower compartment
- Extractor fan
- Air conditioning outlet
- Mirrored vanity unit
- Shelved cupboard
- Seat in shower
- Toothbrush and glass holder
- Towel ring
- Halogen over head light 24v
- Opening porthole with mosquito screen and blind

Crew Quarters

- Stern Entry
- 2 x Twin berths
- Wardrobe
- TV/Radio/CD
- Halogen overhead lighting 24v
- Reading light 24v
- AC socket
- Washbasin and shower
- Mirrored vanity unit
- Opening porthole with mosquito screen
- Toilet
- Shaver point 110v

Engine Room

- Diesel prime pumps
- Fire and bilge flood monitoring alarm system (8-zone)
- Inverter for audio/visual equipment
- Oil change system plus fuel priming system
- Transformer with low voltage and surge protector
- Watermaker-1600 gal./day with remote control in salon
- Custom workbench over starboard generator
- Separate fuel filters/water separators
- Automatic fire extinguisher

- Engine room and forward bilge flood alarms
- 2 x Automatic bilge pumps
- 2 x Automatic flood pumps
- 2 x Extractor fans
- Manual bilge pump
- Additional lights and plugs in all bilges
- Soundproofing throughout engine room
- Fuel tanks with electric sending unit

Electrical Equipment

- 2 Generators with underwater silent exhaust and sound box
- AC dockside connection
- Galvanic isolator
- 24v and 12v DC electrical system with full circuit breaker protection
- 4 x Engine batteries 24v circuit
- 4 Inverter Batteries
- 4 x Domestic batteries 24v circuit
- 2 x Generator batteries 1 2v circuit
- Alternator split charging system
- Remote battery switches controlled from locker in cockpit
- Battery charger for 24v circuits
- Battery charger for 12v circuit
- Water heater
- AC sockets throughout the boat
- 24v hand light and cable
- Magnet Inverter

Systems

- Hydraulic power steering engine driven pump
- Tecma toilet system
- Toilet waste holding tank with monitoring system
- Aluminium fresh-water tank with electric sending unit
- 24v fresh-water pressure system
- Hot water tank
- Bow & Stern thrusters
- Watermaker

Исключения

При продаже яхты исключаются личные вещи владельца.

Отказ от ответственности

Компания предоставляет описание судна или яхты добросовестно, но не может гарантировать точность этой информации, а также не ручается за техническое состояние. Покупатель должен проинструктировать своих агентов или оценщиков исследовать представленную информацию более подробно, по собственному желанию. Продажа судна или яхты, изменение цены или снятие с продажи будет происходить без предварительного уведомления.

ФОТОГРАФИИ

Port Profile



Starboard



Flybridge



Flybridge Helm



Aft Deck



Salon 1



Salon 2



Salon 3



Galley 1



Galley 2



Galley 3



Main Deck Helm Console



Master 1



Master 2



VIP



Head

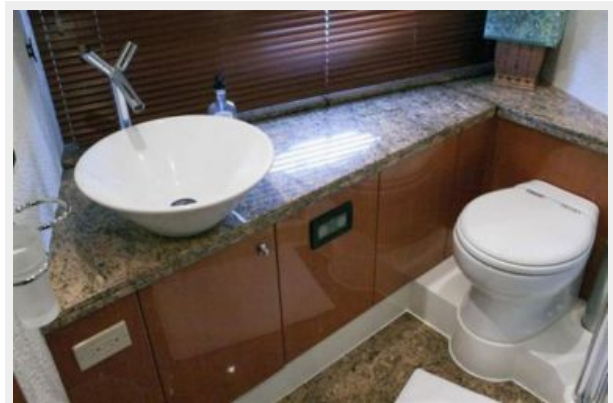

Port Guest



Starboard Guest



Linen Locker



Main Deck Layout

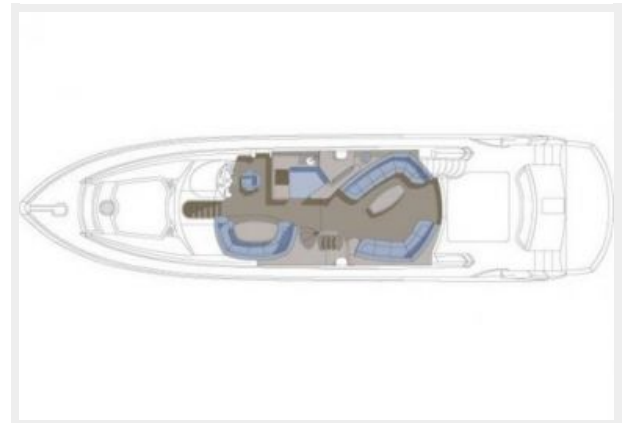

Accommodation Deck Layout

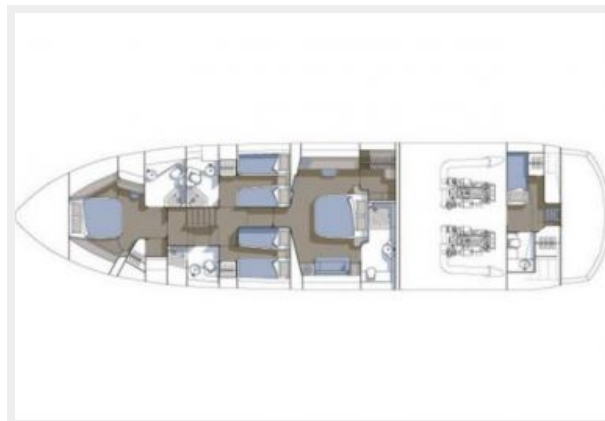

КОНТАКТЫ

Андрей Шестаков (Andrey Shestakov) – ведущий яхтенный брокер отдела продаж яхт и судов компании Shestakov Yacht Sales Inc. Официальный представитель Shestakov Yacht Sales Inc. для русскоговорящих клиентов в центральном офисе компании в Майами/Форт Лодердейл/Флорида/США.

Контактная информация

Email: andrey@shestakovyachtsales.com

Web: shestakovyachtsales.com

Телефоны

Краснодарский край: **+7(918)465-66-44**

США, Майами, Флорида: **+1(954)274-4435**

Время работы

Понедельник – Суббота: **9:00 - 21:00**
EDT

Воскресенье: **Закрито**

Адрес



Harbour Towne Marina, 850 NE 3rd St,
STE 213, Dania, FL 33004