

SEA LEAF — OCEAN ALEXANDER



Судостроитель: OCEAN ALEXANDER

Год постройки: 2010

Модель: Моторная яхта

Цена: ЦЕНА ЯХТЫ ПО ЗАПРОСУ

Местонахождение: United States

Длина общая: 68' 0" (20.73m)

Ширина: 20' 0" (6.10m)

Макс. осадка: 5' 0" (1.52m)

Крейс. скорость: 12 Kts. (14 MPH)

Макс. скорость: 17 Kts. (20 MPH)

Купить **SEA LEAF — OCEAN ALEXANDER** а также выбрать подходящую вам яхту из нашего каталога яхт вам поможет опытный яхтенный брокер Андрей Шестаков. На сегодняшний день компания **Shestakov Yacht Sales Inc.** имеет большое количество яхт в собственном списке продаж, а также тесно сотрудничает со всеми крупными яхтенными производителями по всему миру.

Для того чтобы купить яхту **SEA LEAF — OCEAN ALEXANDER** а также проконсультироваться по любому вопросу связанному с покупкой, продажей, чартером яхт позвоните по телефону **+7(918)465-66-44**.

ОГЛАВЛЕНИЕ

ОГЛАВЛЕНИЕ	2
ХАРАКТЕРИСТИКИ	4
Основная информация	4
Размеры	4
Скорость, вместимость и масса	4
Размещение	4
Корпус и палуба	4
Информация о двигателе	5
ПОДРОБНОЕ ОПИСАНИЕ	6
PLEASE NOTE	6
INTRODUCTION	6
CONSTRUCTION	6
DESIGN FEATURE	6
INTERIOR FINISH	7
ACCOMMODATIONS	7
NAVIGATION AND ENTERTAINMENT	8
ELECTRICAL	8
ENGINE ROOM & BILGE EQUIPMENT	8
EXTERIOR HARDWARE AND EQUIPMENT	9
SIGNIFICANT OPTIONAL UPGRADES	9
SAFETY PACKAGE	9
EXCLUSIONS	10
Исключения	10
Отказ от ответственности	10
ФОТОГРАФИИ	11
КОНТАКТЫ	16
Контактная информация	16
Телефоны	16

Время работы	16
Адрес	16

ХАРАКТЕРИСТИКИ

Основная информация

Тип судна: Моторная яхта

Подкатегория: Raised Pilothouse

Модельный год: 2010

Год постройки: 2010

Страна: United States

Регистрационный номер: 743163

Размеры

Длина общая: 68' 0" (20.73m)

Ширина: 20' 0" (6.10m)

Макс. осадка: 5' 0" (1.52m)

Скорость, вместимость и масса

Крейс. скорость: 12 Kts. (14 MPH)

Макс. скорость: 17 Kts. (20 MPH)

Водоизмещение: 136000 Pounds

Вместимость воды: 350 Gallons

Вместимость сточного бака: 200 Gallons Объем топливного бака: 2000 Gallons

Размещение

Всего кают: 3

Каюты экипажа: 1

Койки экипажа: 2

Спальных мест экипажа: 2

Корпус и палуба

Материал корпуса: Fiberglass

Дизайнер корпуса: Ed Monk

Информация о двигателе

Двигатели: 2

Производитель: Caterpillar

Модель: C-18

Тип двигателя: Inboard

Тип топлива: Diesel

ПОДРОБНОЕ ОПИСАНИЕ

PLEASE NOTE

PRELIMINARY LISTING - SUBJECT TO OWNER REVIEW AND CHANGES!

INTRODUCTION

CLICK HERE FOR "SEA LEAF" VIRTUAL TOURS!

CLICK HERE FOR "SEA LEAF" VIDEO!

CLICK HERE FOR "SEA LEAF" COMPLETE PHOTOS! (click on any photo for slide show format)

This timeless Ed Monk design offers a unique combination of features that more manufacturers should pay attention to....The low profile, understated looks of a fly bridge sport yacht, plus the economical installation of Caterpillar C18 engines for extended range, yielding the ability to attain 17 knots top speed when needed. Let's face it, with the price of fuel today, most boat owners and captains travel at displacement speeds most of the time, and SEA LEAF offers this dual combination and does so in elegant style! SEA LEAF's 20 Ft. beam, with full walk around side decks, gives one the feeling of a much larger yacht, yet from all angles of observation, this is truly a well proportioned yacht that looks stable and actually lives up to all expectations. Add to this, an elegant high gloss varnished interior with well chosen understated quality soft goods and you have discovered your next home away from home. If a motor yacht in this size range, with generous crew cabin for two aft, and state of the art electronics and more options than you can imagine, sounds good to you, then you must make an appointment to inspect SEA LEAF as soon as possible.

CONSTRUCTION

The hull and decks are carbon fiber infused with Airex PVC foam core above the waterline, and the hull bottom is protected by Interprotect epoxy anti osmosis system. Forward there is a reinforced collision bulkhead, tempered safety glass in all frameless windows, interior structural components all bonded to the hull, plus hard top. Sylomer floating floor system.

DESIGN FEATURE

Deep V forward with flared bow sections. Fly bridge with hard top and extended boat deck that covers the aft deck dining area. Full walk around side decks with deep bulwarks. Flush pilothouse doors and windows offering excellent sit down visibility from all seating areas. Very

well proportioned, functional low profile silhouette that will remain in style and never have a dated look.

INTERIOR FINISH

High gloss varnished Sakura paneling and cabinetry throughout. Satin finish in the crew areas. Burl wood accent detailing in salon and staterooms. Salon circular stairway to the upper deck. Soft vinyl removable headliners. Settees with Ultraleather fabrics. Hidden hinges and push button handles for all drawers and cabinets. 24 Volt LED lighting throughout the interior and exterior of the vessel.

ACCOMMODATIONS

Main Salon: (See attached layout details) Electronic sliding doors entering from the aft deck. L shaped settee to starboard with high low burlwood top table and side chair. Built in cabinets, hidden Sony 40" LCD TV, plus two occasional chairs to port. Spiral stainless and Sakura staircase to fly bridge on portside. Numerous additional custom cabinets and drawers. Pilothouse/Dining Area: Burl wood dining table with seating for six to port with detailed overhead ceiling and lighting. Custom pilot house station with black Ultraleather and teak trim. Burl wood custom dash and built in desk/work area. Watertight doors to port and starboard side decks. Large additional chart drawer, custom built at lower helm. Galley: Efficient U shaped galley with granite counter tops and Sakura varnished cabinetry Full size Amana stainless Easy Reach refrigerator Numerous overhead storage lockers and under counter drawers Full size microwave/convection oven Gaggenau electric cook top and oven Fisher & Paykel dishwasher Broan trash compactor Custom cutlery drawer and wine glass storage racks added Master Stateroom: Located in the center of the vessel, with fore and aft facing king-sized innerspring mattress His and her head with shower and vanity Samsung LCD TV Two nightstands, bureau with vanity, plus numerous drawers and lockers Full height cedar lined hanging lockers, one containing a safe Oval stainless portholes with screens Generous LED 24 Volt overhead and reading lighting

VIP Stateroom Forward: Queen sized berth with large drawers and storage under Cedar lined hanging lockers Pioneer 22" LCD TV Sony DVD/CD stereo video system with IR Repeater Two overhead stainless deck hatches and oval port lights with privacy screens Generous 24 V LED lighting throughout Port Guest Stateroom: Side by side twin bed stateroom with ensuite head and shower Sharp 20" TV, DVD/CD stereo and video system Cedar lined hanging locker and dressing mirror Stainless oval port light with privacy screen 24 Volt LED lighting overhead and for reading Heads: Custom granite counter tops and varnished sakura walls in all heads Grohe faucets and hardware for sinks and showers Amtico plank flooring Tecma toilet system Granite shower flooring and shower seats Seamless fiberglass stall showers with one piece glass doors China sinks Keuco bathroom fixtures throughout 24 Volt LED lighting Vent blowers Stainless oval port lights with screens Water-proof draperies Well positioned mirrored cabinet doors

NAVIGATION AND ENTERTAINMENT

2 Furuno radars: Furuno DRS 12 KW, plus Furuno DRS4A 4 KW open array Furuno GP330B GPS/WAAS antenna Simrad AP 28 autopilot with repeater feeding Furuno Nav Net System 2 ICOM M504 VHF radios with long antennas, GPS, hailer, and fog signal KVH Satellite TV antenna for North America 2 KEPM GB 19 “ marinized glass bridge monitors 2 ASUS VW266H 25.5” computer monitors in pilot house with wireless router, and Wave Wifi Booster Furuno class B transponder 2 Furuno Nav Net 3D black box processors Furuno Network dual depth, wind, with multiple displays throughout vessel Verizon Hotspot for Email and phones I Sat Phone ProDigital DA4000 cell phone antenna Maretron N2K View software package for Octoplex control system Upgraded Nobletec software for navigation and weather XMWX Satellite Weather Bundle/USB receiver attached to Creston and computer 3 Direct TV Receivers Printer/fax/scanner in pilot house Cameras: 4 - four axis cameras for engine room, salon, upper deck, and aft deck Full engine instrumentation both stations Crestron POE injector, with universal remote Dennon AVR 989 Receiver and DN U210 DVD Player Furman Power Conditioner Phone Intercom System

ELECTRICAL

Two 25 KW Northern generators Octoplex three location AC/DC electrical control panels, allowing electric start up and monitoring throughout the boat. 4000 W Pure Sine Wave Inverter/Charger Volt and Amp meters for AC/DC systems Reverse polarity indicating lights Heavy Duty AGM 8D batteries for engines, generators, and house bank Marine grade tinned copper wiring throughout the vessel 50 and 100 amp shore power receptacles in transom with Cable Master Vimar switches and outlets Chain Counter Battery parallel control switch system Telephone jacks in master stateroom, salon, and pilot house Cell phone amplifier Proportional thruster controls

ENGINE ROOM & BILGE EQUIPMENT

Twin Caterpillar C-18 Engines with Platinum Plus Warranties until Dec. 2015. Note: Warranties may be extended for an additional 60 months. Two 25 KW Northern Lights generators with gas/water separators Matrix Aqua Clean 600 gal per day water maker Oil changing system for engines and generators Fuel polishing system Delta T engine positive pressure system with pressure sensors, logic computer and variable speeds fans Fire extinguishing system with engine shutdown feature Power steering system 3 inch lead/foam sound insulation Headhunter pressure fresh and sea water systems Aluminum fuel tanks with sight gauges and electric gauges Stainless water tank with sight and electric gauges Two 30 gallon water heaters Dripless engine and rudder post seals Four 24 Volt electric bilge pumps with auto and manual switches, sumped when necessary One manual bilge pump, and Y valve engine driven bilge pump Underwater exhaust system Color coded piping for fuel, water, and hydraulics Three valve steering system for autopilot Holding tank plumbed for dockside and overboard offshore

discharge with tank gauge in pilot house Central vacuum system Common drainage system for sinks, showers, bilge and exterior deck and 24 volt shower sump pumps Port and starboard side fillers for water and fuel tanks Seacocks and raw water strainers on all intakes Racor fuel/water separators for main engines and generators Engine isolation switches Anti explosion AC/DC lights in engine room Spare conduit from engine room to pilothouse, Fly bridge, and fly bridge overhang Heron rubber flooring in engine room and stainless hand rails on side of engines Lighted gel coat bilges High water engine room bilge alarm Extra storage cabinets and drawers built in to engine room

EXTERIOR HARDWARE AND EQUIPMENT

Tender: AB VST 13' with 60 HP Yamaha four stroke, lifting straps, depth sounder and cover Muir VRC 3500C windlass, 125 lb. stainless plow anchor, stainless anchor roller, cleats and hawse holes Stainless swivel anchor light bracket Keypower hydraulic bow thruster 36 HP, and 25 HP stern thruster Keypower hydraulic stabilizers Hydraulic trim tabs Steelhead SM 2000R davit with hydraulic boom, rotation and extension controls Kahlenberg dual air horns Kenyon electric BBQ on boat deck 2 inch elliptical S/S handrails on main deck, 1-1/2 on fly bridge Marquipt Sea Stairs U shaped, removable hand rails on teak covered swim platform, with folding swim ladder Stidd Ultraleather electric helm chair in pilothouse, plus two Stidd mechanical helm seats on fly bridge Sea and freshwater wash downs at bow and stern, freshwater on fly bridge Aquatech 22 HS prop shafts, bronze struts/cutlass bearings, stainless steel rudders and shafts Five Hi-Intensity LED underwater lights Bronze thru hull fittings Zincs on rudders, shafts & trim tabs Teak bow and stern staffs Aft deck shower and dockside water inlet Six dive tank holders in Lazarette TV/Phone inlet Hepworth heavy duty commercial grade wipers

SIGNIFICANT OPTIONAL UPGRADES

Exceptional crew quarters for two aft of engine room with swim platform entry as well as stairway access from upper aft deck. Crew area consists of head with stall shower, mini galley, plus extensive storage throughout, all done with high quality satin finished varnished paneling Two large storage cabinets in bilge area under twin stateroom, plus in lazarette area Teak decking on walk around side decks, upper aft deck, swim platform, and stairs from aft deck to aft platform Custom granite flooring on lower deck foyer and foyer cabinet countertop Custom granite upgrade for all head areas Canvas carpet covers for salon and pilot house areas Smoke and CO2 detectors throughout the vessel

SAFETY PACKAGE

Winslow 8 Man Life Raft Horn, ships bell Life jackets, Hand Held fire extinguishers, automatic engine room fire system, Flare Gun kit Dock lines and fenders

EXCLUSIONS

Owners personal items, with list of details to be furnished prior to survey of vessel.

Исключения

При продаже яхты исключаются личные вещи владельца.

Отказ от ответственности

Компания предоставляет описание судна или яхты добросовестно, но не может гарантировать точность этой информации, а также не ручается за техническое состояние. Покупатель должен проинструктировать своих агентов или оценщиков исследовать представленную информацию более подробно, по собственному желанию. Продажа судна или яхты, изменение цены или снятие с продажи будет происходить без предварительного уведомления.

ФОТОГРАФИИ









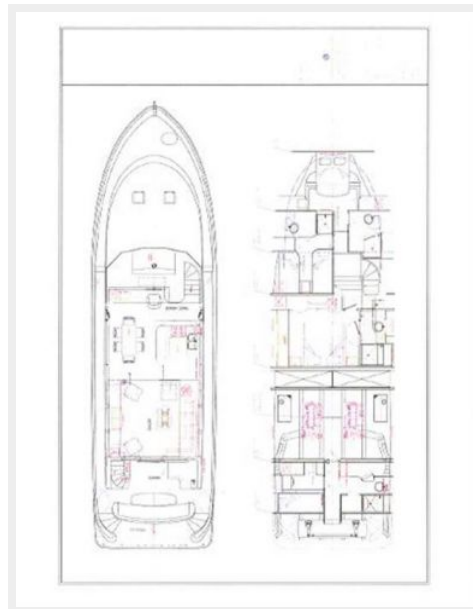
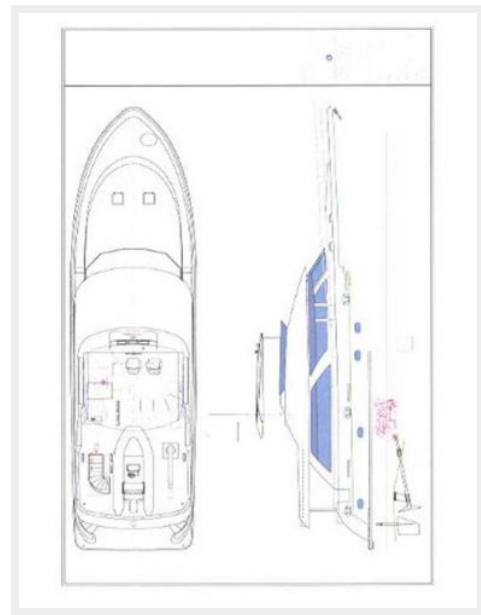

КОНТАКТЫ

Андрей Шестаков (Andrey Shestakov) – ведущий яхтенный брокер отдела продаж яхт и судов компании Shestakov Yacht Sales Inc. Официальный представитель Shestakov Yacht Sales Inc. для русскоговорящих клиентов в центральном офисе компании в Майами/Форт Лодердейл/Флорида/США.

Контактная информация

Email: andrey@shestakovyachtsales.com

Web: shestakovyachtsales.com

Телефоны

Краснодарский край: **+7(918)465-66-44**

США, Майами, Флорида: **+1(954)274-4435**

Время работы

Понедельник – Суббота: **9:00 - 21:00**
EDT

Воскресенье: **Закрито**

Адрес



Harbour Towne Marina, 850 NE 3rd St,
STE 213, Dania, FL 33004