

TOORA LOORA — GRAND BANKS



Builder: GRAND BANKS

Year Built: 2000

Model: Motor Yacht

Price: PRICE ON APPLICATION

Location: United States

LOA: 42' 0" (12.80m)

Beam: 14' 1" (4.29m)

Max Draft: 4' 2" (1.27m)

Cruise Speed: 13 Kts. (15 MPH)

Max Speed: 17 Kts. (20 MPH)

Our experienced yacht broker, Andrey Shestakov, will help you choose and buy a yacht that best suits your needs **TOORA LOORA — GRAND BANKS** from our catalogue. Presently, at Shestakov Yacht Sales Inc., we have a wide variety of yachts available on our sale's list. We also work in close contact with all the big yacht manufacturers from all over the world.

If you would like to buy a yacht **TOORA LOORA — GRAND BANKS** or would like help answering any questions concerning purchasing, selling or chartering a yacht, please call **+1(954)274-4435**

TABLE OF CONTENTS

TABLE OF CONTENTS	2
SPECIFICATIONS	4
Overview	4
Basic Information	4
Dimensions	4
Speed, Capacities and Weight	4
Accommodations	5
Hull and Deck Information	5
Engine Information	5
DETAILED INFORMATION	6
Overview	6
Accommodations	6
Master Cabin	6
Guest Cabin	6
Head	6
Galley	7
Salon	7
Hull and Deck Equipment	7
Machinery and Electrical	7
Electronics and Navigation	8
Broker Remarks	8
Exclusions	8
Disclaimer	8
PHOTOS	9
Salon to Port	9
Salon to Starboard	9
Salon Looking Aft	9
Galley	9

Helm Seat Side Door	10
Galley and Salon Looking Aft	10
Helm	10
Guest Cabin	10
Master Cabin	11
Master Cabing Aft to Port	11
Head Looking Aft	11
Master Cabin Aft to Starboard	11
Head Looking Aft	12
Engine Room Looking Aft	12
Engine Room Looking Forward	12
Aft Deck	12
Aft Deck Forward	13
Bow	13
Bow Looking Aft	13
Flybridge Looking Aft	13
Flybridge Looking Forward	14
Port Aft Profile at Dock	14
TOORA LOORA Layout	14
CONTACTS	15
Contact details	15
Telephones	15
Office hours	15
Address	15

SPECIFICATIONS

Overview

TOORA LOORA (Name Reserved) is in excellent cosmetic and mechanical condition with many recent upgrades/updates including a 2 year old Garmin electronics suite, entirely new exterior canvas, and flawless varnish. Her two stateroom interior has all the comforts any extended cruiser or live-aboard owner would want, as well as fully protected walk-around side decks, a covered cockpit, and easy to navigate stairs up to a spacious flybridge. This particular boat has the lowest hours of any GB 42 Europa currently on the market and she shows beautifully.

Basic Information

Category: Motor Yacht

Model Year: 2000

Year Built: 2000

Country: United States

Vessel Top: 2353

Dimensions

LOA: 42' 0" (12.80m)

LWL: 41' 1" (12.52m)

Beam: 14' 1" (4.29m)

Max Draft: 4' 2" (1.27m)

Clearance: 22' 8" (6.91m)

Speed, Capacities and Weight

Cruise Speed: 13 Kts. (15 MPH)

Max Speed: 17 Kts. (20 MPH)

Displacement: 340000 Pounds

Water Capacity: 278 Gallons

Holding Tank: 55 Gallons

Fuel Capacity: 600 Gallons

Accommodations

Total Cabins: 2

Total Berths: 3

Sleeps: 5

Total Heads: 1

Hull and Deck Information

Hull Material: Fiberglass

Deck Material: Teak

Hull Configuration: Semi-Displacement

Hull Color: White

Hull Finish: Aluminum

Hull Designer: Ken Smith

Engine Information

Engines: 2

Manufacturer: Caterpillar

Model: 3116TA

Engine Type: Inboard

Fuel Type: Diesel

DETAILED INFORMATION

Overview

TOORA LOORA (Name Reserved) is in excellent cosmetic and mechanical condition with many recent upgrades/updates including a 2 year old Garmin electronics suite, entirely new exterior canvas, and flawless varnish. Her two stateroom interior has all the comforts any extended cruiser or live-aboard owner would want, as well as fully protected walk-around side decks, a covered cockpit, and easy to navigate stairs up to a spacious flybridge. This particular boat has the lowest hours of any GB 42 Europa currently on the market and she shows beautifully.

Accommodations

Forward is a centerline queen walk-around berth with its own access to the Starboard head. Just aft to port is the guest stateroom with a large fore and aft running double berth. Up three steps, the galley is to port and the helm to starboard followed by the salon and aft deck. Up and easy flight of stairs from the aft deck is a huge flybridge with aft seating area and helm forward.

Master Cabin

Centerline Queen berth with storage under Great drawer and hanging locker storage to port and starboard Full length mirror Direct separate access to the head Large overhead opening hatch with screen (2) Opening stainless ports with screens and curtains (2) Grand Banks brass reading lamps Sony KLV-S19A10 flatscreen TV Polaroid DVD player Digital Air Conditioning control Carbon monoxide alarm Overhead lighting (2) 110v outlets Fire extinguisher

Guest Cabin

Fore and aft running double berth (2) Grand Banks brass reading lamps Good amount of drawer and hanging locker storage Wall mounted mirror Overhead opening hatch with screen (2) Stainless opening ports with screens and shades Overhead lighting 110V outlet Fire extinguisher

Head

Large head with separate enclosed stall shower Vac-U-Flush freshwater head Simulated marble counter top Single washbasin with hot and cold water Adequate toiletries Overhead opening hatch with screen Stainless opening port with screen and shade Overhead lighting 110v GFI outlet Tankwatch III holding tank monitor panel

Galley

Grunert holding plate refrigeration Grunert holding plate top loading freezer Princess LPG 3 burner stove with oven LPG safety control solenoid Overhead vent Welbilt Turn-Table microwave oven U-Line icemaker Lots of overhead cabinet and drawer storage Integrated "tip out" wastebasket in cabinetry Corian sink and countertop with additional slide out counter board Hot and cold water Digital Air Conditioning control pad Fire extinguisher

Salon

Large L-shaped settee to port with navy ultra-leather upholstery Teak drop leaf salon dining table provides seating / dining for 6 (2) Grand Banks teak arm chairs with navy ultra-leather upholstery Teak TV cabinet Kenwood KTS-MP400 SIRIUS ready digital CD player/stereo and speakers Sony KLV-S23A10 flatscreen TV Sony DVP-NS50P CD/DVD player Salon surrounded by sliding windows with screens and curtains Grand Banks sliding screen pocket door for double entry doors aft Starboard side companionway door Digital Air Conditioning control 12v outlet (3) 110v outlets, one being GFI protected Fire extinguisher

Hull and Deck Equipment

New exterior canvas and isinglass 3 sided flybridge enclosure(2012) New exterior Sunbrella cushions (2012) New exterior mesh front window screen/shade New exterior Sunbrella hatch covers All exterior varnish "wooded" and re-done (2013) Teak decks and swimplatform Stainless stanchions and cleats Achilles HB315DX hard bottom inflatable w/20hp 4-stroke Honda outboard (2009) Brower Systems low profile 1000lb capacity tender davit 4 Person Elliot coastal life raft with cradle (2012) GlobalFix iPro EPIRB (2012) (4) Mustang cold water immersion / survival suits (2012) New Plexiglas for sliding flybridge companionway hatch (2011) (4) Folding deck chairs (2012) Folding teak cocktail table (2012) (2) Pot warp cutters on shafts (2) Cockpit stainless rod holders L-Shaped settee with table to starboard on flybridge Forward and aft facing seating on flybridge Large lazarette storage area with access to engine room Hot and cold shower on aft deck Freshwater wash down spigot Transom door for easy swim platform access Aluminum mast and boom Running rigging on mast replaced (2012) Manual bilge pump Emergency tiller Grand Banks teak bow and stern flag staffs Stainless fold down swim ladder with teak treads 45lb CQR plow primary anchor with chain rode Aluminum Fortress/Danforth type secondary anchor Assorted life jackets, throw-able type 1 PFD's, lines, fenders, flares, boat hook

Machinery and Electrical

2 X Caterpillar 3116TA 350hp Diesels Port currently has 816hrs (6/2014) Starboard currently has 821hrs (6/2014) 8KW Northern Lights Generator which currently has 455hrs (6/2014) Batteries all new (2011) Seaward stainless 18gal hot water heater (2) Engine room blower fans Duel Racor fuel filters on main engines Single Racor fuel filter on generator (2) Oversized Groco

intake strainers for main engines Marine Air reverse cycle air conditioning 12V and 110V overhead lighting 50AMP -120v AC electrical system 12v DC electrical system Forward and aft shore power, phone, and TV outlets. Extensive assorted spare parts inventory

Electronics and Navigation

LOWER HELM: Garmin touch screen AIS Radar/GPSmap 5212 (2012) Garmin GHS 10 VHF with external speaker (2012) ICOM IC-M127 VHF B&G Speed and Depth readouts Simrad Robertson AP22 autopilot RITCHIE powerdamp compass ACR touchpad remote for spotlight Windlass control panel Weems and Plath clock and barometer set (2011) Engine synchronizer Trim tab switches Battery bank level indicator AC and DC Volt indicators 12v outlet 6 Spoke teak ships wheel with teak rim

UPPER HELM: Garmin touch screen AIS Radar/GPSmap 5212 (2012) Garmin GHS 10 VHF with external speaker (2012) B&G Quad Speed and Depth readout Simrad Robertson AP22 autopilot RITCHIE powerdamp compass Kenwood KTS-MP400 SIRIUS ready digital CD player/stereo and BOSE Speakers Engine synchronizer Trim tab switches 6 Spoke teak ships wheel with stainless rim Custom ARRIGONI Design helm chair

Broker Remarks

TOORA LOORA is a very well equipped 42' Grand Banks Europa that has enjoyed obvious good care and recent upgrades/updates. With low hours on both her main engines and generator, her next owner should have many hours of hassle free cruising. She shows very well and is most deserving of inspection. For sale as her owner has decided it's time move to a larger Grand Banks.

Exclusions

Owner's personal belongings.

Disclaimer

The Company offers the details of this vessel or yacht in good faith but cannot guarantee or warrant the accuracy of this information nor warrant the condition of the vessel. A buyer should instruct his representatives, agents, or his surveyors, to investigate such details as the buyer desires validated. This vessel or yacht is offered subject to prior sale, price change, or withdrawal without notice.

PHOTOS

Salon to Port



Salon to Starboard



Salon Looking Aft



Galley



Galley and Salon Looking Aft



Helm Seat Side Door



Helm

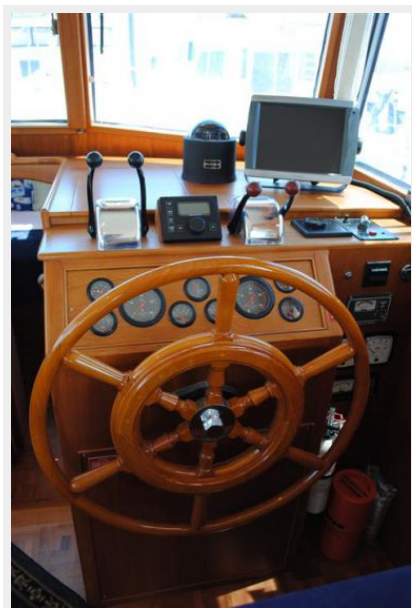

Guest Cabin



Master Cabin



Master Cabing Aft to Port



Head Looking Aft



Master Cabin Aft to Starboard



Head Looking Aft



Engine Room Looking Aft



Engine Room Looking Forward



Aft Deck



Aft Deck Forward



Bow

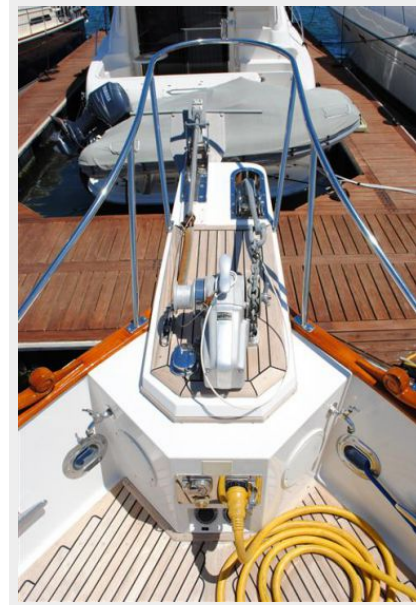

Bow Looking Aft



Flybridge Looking Aft



Flybridge Looking Forward



Port Aft Profile at Dock



TOORA LOORA Layout

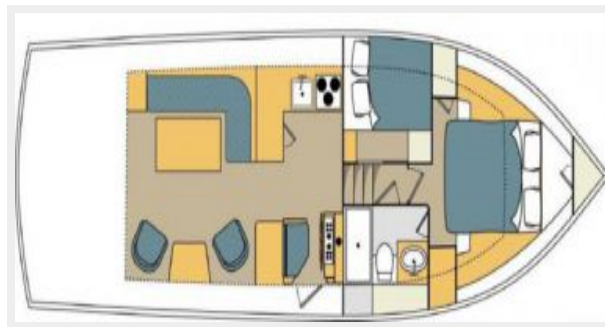

CONTACTS

Andrey Shestakov, leading yacht broker of the sales department of Shestakov Yacht Sales Inc. Shestakov Yacht Sales Inc., the official representative of the Miami/Fort Lauderdale FL headquarters.

Contact details

Email: andrey@shestakovyachtsales.com

Web: shestakovyachtsales.com/en/

Telephones

USA: +1(954)274-4435

Office hours

Monday – Saturday: **9:00 - 21:00** EDT

Sunday: **closed**

Address



Harbour Towne Marina, 850 NE 3rd St,
STE 213, Dania, FL 33004