

TOORA LOORA — GRAND BANKS



Судостроитель: GRAND BANKS

Год постройки: 2000

Модель: Моторная яхта

Цена: **ЦЕНА ЯХТЫ ПО ЗАПРОСУ**

Местонахождение: United States

Длина общая: 42' 0" (12.80m)

Ширина: 14' 1" (4.29m)

Макс. осадка: 4' 2" (1.27m)

Крейс. скорость: 13 Kts. (15 MPH)

Макс. скорость: 17 Kts. (20 MPH)

Купить **TOORA LOORA — GRAND BANKS** а также выбрать подходящую вам яхту из нашего каталога яхт вам поможет опытный яхтенный брокер Андрей Шестаков. На сегодняшний день компания **Shestakov Yacht Sales Inc.** имеет большое количество яхт в собственном списке продаж, а также тесно сотрудничает со всеми крупными яхтенными производителями по всему миру.

Для того чтобы купить яхту **TOORA LOORA — GRAND BANKS** а также проконсультироваться по любому вопросу связанному с покупкой, продажей, чартером яхт позвоните по телефону **+7(918)465-66-44**.

ОГЛАВЛЕНИЕ

ОГЛАВЛЕНИЕ	2
ХАРАКТЕРИСТИКИ	4
Обзор	4
Основная информация	4
Размеры	4
Скорость, вместимость и масса	4
Размещение	5
Корпус и палуба	5
Информация о двигателе	5
ПОДРОБНОЕ ОПИСАНИЕ	6
Overview	6
Accommodations	6
Master Cabin	6
Guest Cabin	6
Head	6
Galley	7
Salon	7
Hull and Deck Equipment	7
Machinery and Electrical	7
Electronics and Navigation	8
Broker Remarks	8
Исключения	8
Отказ от ответственности	8
ФОТОГРАФИИ	9
Salon to Port	9
Salon to Starboard	9
Salon Looking Aft	9
Galley	9

Helm Seat Side Door	10
Galley and Salon Looking Aft	10
Helm	10
Guest Cabin	10
Master Cabin	11
Master Cabing Aft to Port	11
Head Looking Aft	11
Master Cabin Aft to Starboard	11
Head Looking Aft	12
Engine Room Looking Aft	12
Engine Room Looking Forward	12
Aft Deck	12
Aft Deck Forward	13
Bow	13
Bow Looking Aft	13
Flybridge Looking Aft	13
Flybridge Looking Forward	14
Port Aft Profile at Dock	14
TOORA LOORA Layout	14
КОНТАКТЫ	15
Контактная информация	15
Телефоны	15
Время работы	15
Адрес	15

ХАРАКТЕРИСТИКИ

Обзор

TOORA LOORA (Name Reserved) is in excellent cosmetic and mechanical condition with many recent upgrades/updates including a 2 year old Garmin electronics suite, entirely new exterior canvas, and flawless varnish. Her two stateroom interior has all the comforts any extended cruiser or live-aboard owner would want, as well as fully protected walk-around side decks, a covered cockpit, and easy to navigate stairs up to a spacious flybridge. This particular boat has the lowest hours of any GB 42 Europa currently on the market and she shows beautifully.

Основная информация

Тип судна: Моторная яхта

Модельный год: 2000

Год постройки: 2000

Страна: United States

Верх: 2353

Размеры

Длина общая: 42' 0" (12.80m)

Длина по ватерлинии: 41' 1" (12.52m)

Ширина: 14' 1" (4.29m)

Макс. осадка: 4' 2" (1.27m)

Трапы: 22' 8" (6.91m)

Скорость, вместимость и масса

Крейс. скорость: 13 Kts. (15 MPH)

Макс. скорость: 17 Kts. (20 MPH)

Водоизмещение: 340000 Pounds

Вместимость воды: 278 Gallons

Вместимость сточного бака: 55 Gallons **Объем топливного бака:** 600 Gallons

Размещение

Всего кают: 2

Всего коек: 3

Спальные места: 5

Всего ком. состава: 1

Корпус и палуба

Материал корпуса: Fiberglass

Материал палубы: Teak

Комплектация корпуса: Semi-Displacement

Цвет корпуса: White

Отделка корпуса: Aluminum

Дизайнер корпуса: Ken Smith

Информация о двигателе

Двигатели: 2

Производитель: Caterpillar

Модель: 3116TA

Тип двигателя: Inboard

Тип топлива: Diesel

ПОДРОБНОЕ ОПИСАНИЕ

Overview

TOORA LOORA (Name Reserved) is in excellent cosmetic and mechanical condition with many recent upgrades/updates including a 2 year old Garmin electronics suite, entirely new exterior canvas, and flawless varnish. Her two stateroom interior has all the comforts any extended cruiser or live-aboard owner would want, as well as fully protected walk-around side decks, a covered cockpit, and easy to navigate stairs up to a spacious flybridge. This particular boat has the lowest hours of any GB 42 Europa currently on the market and she shows beautifully.

Accommodations

Forward is a centerline queen walk-around berth with its own access to the Starboard head. Just aft to port is the guest stateroom with a large fore and aft running double berth. Up three steps, the galley is to port and the helm to starboard followed by the salon and aft deck. Up and easy flight of stairs from the aft deck is a huge flybridge with aft seating area and helm forward.

Master Cabin

Centerline Queen berth with storage under Great drawer and hanging locker storage to port and starboard Full length mirror Direct separate access to the head Large overhead opening hatch with screen (2) Opening stainless ports with screens and curtains (2) Grand Banks brass reading lamps Sony KLV-S19A10 flatscreen TV Polaroid DVD player Digital Air Conditioning control Carbon monoxide alarm Overhead lighting (2) 110v outlets Fire extinguisher

Guest Cabin

Fore and aft running double berth (2) Grand Banks brass reading lamps Good amount of drawer and hanging locker storage Wall mounted mirror Overhead opening hatch with screen (2) Stainless opening ports with screens and shades Overhead lighting 110V outlet Fire extinguisher

Head

Large head with separate enclosed stall shower Vac-U-Flush freshwater head Simulated marble counter top Single washbasin with hot and cold water Adequate toiletries Overhead opening hatch with screen Stainless opening port with screen and shade Overhead lighting 110v GFI outlet Tankwatch III holding tank monitor panel

Galley

Grunert holding plate refrigeration Grunert holding plate top loading freezer Princess LPG 3 burner stove with oven LPG safety control solenoid Overhead vent Welbilt Turn-Table microwave oven U-Line icemaker Lots of overhead cabinet and drawer storage Integrated "tip out" wastebasket in cabinetry Corian sink and countertop with additional slide out counter board Hot and cold water Digital Air Conditioning control pad Fire extinguisher

Salon

Large L-shaped settee to port with navy ultra-leather upholstery Teak drop leaf salon dining table provides seating / dining for 6 (2) Grand Banks teak arm chairs with navy ultra-leather upholstery Teak TV cabinet Kenwood KTS-MP400 SIRIUS ready digital CD player/stereo and speakers Sony KLV-S23A10 flatscreen TV Sony DVP-NS50P CD/DVD player Salon surrounded by sliding windows with screens and curtains Grand Banks sliding screen pocket door for double entry doors aft Starboard side companionway door Digital Air Conditioning control 12v outlet (3) 110v outlets, one being GFI protected Fire extinguisher

Hull and Deck Equipment

New exterior canvas and isinglass 3 sided flybridge enclosure(2012) New exterior Sunbrella cushions (2012) New exterior mesh front window screen/shade New exterior Sunbrella hatch covers All exterior varnish "wooded" and re-done (2013) Teak decks and swimplatform Stainless stanchions and cleats Achilles HB315DX hard bottom inflatable w/20hp 4-stroke Honda outboard (2009) Brower Systems low profile 1000lb capacity tender davit 4 Person Elliot coastal life raft with cradle (2012) GlobalFix iPro EPIRB (2012) (4) Mustang cold water immersion / survival suits (2012) New Plexiglas for sliding flybridge companionway hatch (2011) (4) Folding deck chairs (2012) Folding teak cocktail table (2012) (2) Pot warp cutters on shafts (2) Cockpit stainless rod holders L-Shaped settee with table to starboard on flybridge Forward and aft facing seating on flybridge Large lazarette storage area with access to engine room Hot and cold shower on aft deck Freshwater wash down spigot Transom door for easy swim platform access Aluminum mast and boom Running rigging on mast replaced (2012) Manual bilge pump Emergency tiller Grand Banks teak bow and stern flag staffs Stainless fold down swim ladder with teak treads 45lb CQR plow primary anchor with chain rode Aluminum Fortress/Danforth type secondary anchor Assorted life jackets, throw-able type 1 PFD's, lines, fenders, flares, boat hook

Machinery and Electrical

2 X Caterpillar 3116TA 350hp Diesels Port currently has 816hrs (6/2014) Starboard currently has 821hrs (6/2014) 8KW Northern Lights Generator which currently has 455hrs (6/2014) Batteries all new (2011) Seaward stainless 18gal hot water heater (2) Engine room blower fans Duel Racor fuel filters on main engines Single Racor fuel filter on generator (2) Oversized Groco

intake strainers for main engines Marine Air reverse cycle air conditioning 12V and 110V overhead lighting 50AMP -120v AC electrical system 12v DC electrical system Forward and aft shore power, phone, and TV outlets. Extensive assorted spare parts inventory

Electronics and Navigation

LOWER HELM: Garmin touch screen AIS Radar/GPSmap 5212 (2012) Garmin GHS 10 VHF with external speaker (2012) ICOM IC-M127 VHF B&G Speed and Depth readouts Simrad Robertson AP22 autopilot RITCHIE powerdamp compass ACR touchpad remote for spotlight Windlass control panel Weems and Plath clock and barometer set (2011) Engine synchronizer Trim tab switches Battery bank level indicator AC and DC Volt indicators 12v outlet 6 Spoke teak ships wheel with teak rim

UPPER HELM: Garmin touch screen AIS Radar/GPSmap 5212 (2012) Garmin GHS 10 VHF with external speaker (2012) B&G Quad Speed and Depth readout Simrad Robertson AP22 autopilot RITCHIE powerdamp compass Kenwood KTS-MP400 SIRIUS ready digital CD player/stereo and BOSE Speakers Engine synchronizer Trim tab switches 6 Spoke teak ships wheel with stainless rim Custom ARRIGONI Design helm chair

Broker Remarks

TOORA LOORA is a very well equipped 42' Grand Banks Europa that has enjoyed obvious good care and recent upgrades/updates. With low hours on both her main engines and generator, her next owner should have many hours of hassle free cruising. She shows very well and is most deserving of inspection. For sale as her owner has decided it's time move to a larger Grand Banks.

Исключения

При продаже яхты исключаются личные вещи владельца.

Отказ от ответственности

Компания предоставляет описание судна или яхты добросовестно, но не может гарантировать точность этой информации, а также не ручается за техническое состояние. Покупатель должен проинструктировать своих агентов или оценщиков исследовать представленную информацию более подробно, по собственному желанию. Продажа судна или яхты, изменение цены или снятие с продажи будет происходить без предварительного уведомления.

ФОТОГРАФИИ

Salon to Port



Salon to Starboard



Salon Looking Aft



Galley



Galley and Salon Looking Aft



Helm Seat Side Door



Helm



Guest Cabin



Master Cabin



Master Cabing Aft to Port



Head Looking Aft



Master Cabin Aft to Starboard



Head Looking Aft



Engine Room Looking Aft



Engine Room Looking Forward



Aft Deck



Aft Deck Forward



Bow

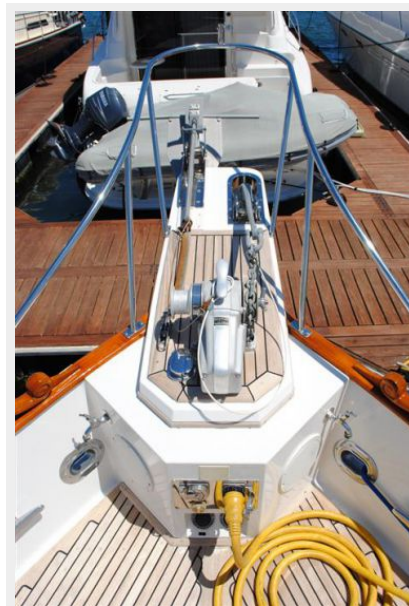

Bow Looking Aft



Flybridge Looking Aft



Flybridge Looking Forward



Port Aft Profile at Dock



TOORA LOORA Layout

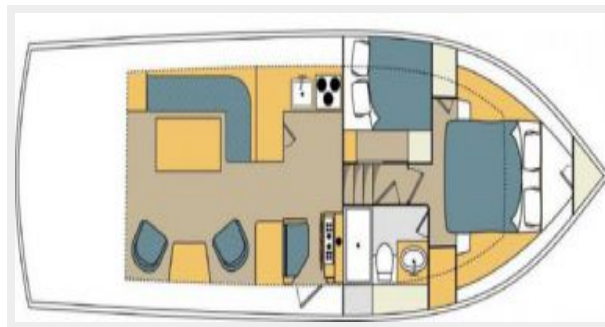

КОНТАКТЫ

Андрей Шестаков (Andrey Shestakov) – ведущий яхтенный брокер отдела продаж яхт и судов компании Shestakov Yacht Sales Inc. Официальный представитель Shestakov Yacht Sales Inc. для русскоговорящих клиентов в центральном офисе компании в Майами/Форт Лодердейл/Флорида/США.

Контактная информация

Email: andrey@shestakovyachtsales.com

Web: shestakovyachtsales.com

Телефоны

Краснодарский край: **+7(918)465-66-44**

США, Майами, Флорида: **+1(954)274-4435**

Время работы

Понедельник – Суббота: **9:00 - 21:00**
EDT

Воскресенье: **Закрыто**

Адрес



Harbour Towne Marina, 850 NE 3rd St,
STE 213, Dania, FL 33004