

## VARSOVIE — NAUTOR'S SWAN



**Builder:** NAUTOR'S SWAN

**Year Built:** 2008

**Model:** Cruising Sailboat

**Price:** **PRICE ON APPLICATION**

**LOA:** 100' (30.48mm)

**Beam:** 23.25

**Min Draft:** 13' 5" (4.09mm)

**Max Draft:** 13' 5" (4.09mm)

Our experienced yacht broker, Andrey Shestakov, will help you choose and buy a yacht that best suits your needs **Varsovie — NAUTOR'S SWAN** from our catalogue. Presently, at Shestakov Yacht Sales Inc., we have a wide variety of yachts available on our sale's list. We also work in close contact with all the big yacht manufacturers from all over the world.

If you would like to buy a yacht **Varsovie — NAUTOR'S SWAN** or would like help answering any questions concerning purchasing, selling or chartering a yacht, please call **+1(954)274-4435**

# TABLE OF CONTENTS

TABLE OF CONTENTS	2
SPECIFICATIONS	4
Overview	4
Basic Information	4
Dimensions	4
Speed, Capacities and Weight	4
Accommodations	4
Hull and Deck Information	5
Engine Information	5
PHOTOS	6
Exterior6	6
Exterior2	6
MainSalon5-100dpi	6
MainSalon4	6
Galley6	7
Galley3	7
Galley4	7
VIP Stateroom	7
AftStateroom2	7
Forward-Guest	7
Crew Cabin Stbd	8
Engine Room 2	8
Exterior-Palma	8
CONTACTS	9
Contact details	9
Telephones	9
Office hours	9
Address	9



---

# SPECIFICATIONS

---

## Overview

---

VARSOVIE benefits from the know-how of all her earlier sisters, being the last of the 100 Series. Modified deck salon, more light inside, more ease of handling and more redundancy. A perfect two owner boat with two equal size master cabins, two further guest cabins plus 4 crew in two cabins.

## Basic Information

---

**Category:** Cruising Sailboat

**Sub Category:** Performance Sailboat

**Model Year:** 2008

**Year Built:** 2008

## Dimensions

---

**LOA:** 100' (30.48mm)

**LWL:** 86' 3" (26.29mm)

**Beam:** 23.25

**Min Draft:** 13' 5" (4.09mm)

**Max Draft:** 13' 5" (4.09mm)

## Speed, Capacities and Weight

---

**Cruise Speed Range:** 2000

**Water Capacity:** 1520 Gallons

**Fuel Capacity:** 834.78 Gal Gallons

## Accommodations

---

**Total Cabins:** 4

**Total Berths:** 5

**Sleeps:** 8

**Total Heads:** 4

**Crew Cabin:** 4

**Crew Berths:** 4

**Crew Heads:** 2

---

## Hull and Deck Information

---

**Hull Material:** GRP

**Deck Material:** Teak and Fiberglass

**Hull Designer:** German Frers

---

## Engine Information

---

**Engines:** 1

**Manufacturer:** Cummins

**Engine Type:** Inboard

**Fuel Type:** Diesel

# PHOTOS



**Exterior6**



**Exterior2**



**MainSalon5-100dpi**



**MainSalon4**



**Galley6**



**Galley3**



**Galley4**



**VIP Stateroom**



**Aft Stateroom2**



**Forward-Guest**



### Crew Cabin Stbd



### Engine Room 2

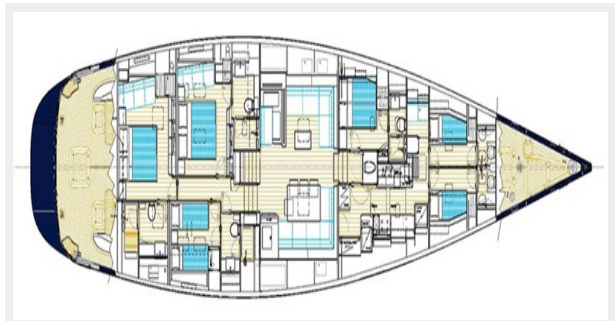

### Exterior-Palma





# CONTACTS

---

Andrey Shestakov, leading yacht broker of the sales department of Shestakov Yacht Sales Inc. Shestakov Yacht Sales Inc., the official representative of the Miami/Fort Lauderdale FL headquarters.

## Contact details

---

Email: [andrey@shestakovyachtsales.com](mailto:andrey@shestakovyachtsales.com)

Web: [shestakovyachtsales.com/en/](http://shestakovyachtsales.com/en/)

## Telephones

---

USA: +1(954)274-4435

## Office hours

---

Monday – Saturday: **9:00 - 21:00** EDT

Sunday: **closed**

## Address

---



Harbour Towne Marina, 850 NE 3rd St,  
STE 213, Dania, FL 33004