

## SEA EAGLE OF SHIAN III — SWAN



**Судостроитель:** [SWAN](#)

**Год постройки:** 1993

**Модель:** Cruising/Racing Sailboat

**Цена:** ЦЕНА ЯХТЫ ПО ЗАПРОСУ

**Местонахождение:** United Kingdom

**Длина общая:** 67' 9" (20.63m)

**Ширина:** 17' 9" (5.40m)

**Мин. осадка:** 11' 6" (3.50m)

**Макс. осадка:** 10' 6" (3.20m)

**Крейс. скорость:** 8 Kts. (9 MPH)

**Макс. скорость:** 10 Kts. (12 MPH)

Купить **SEA EAGLE OF SHIAN III — SWAN** а также выбрать подходящую вам яхту из нашего каталога яхт вам поможет опытный яхтенный брокер Андрей Шестаков. На сегодняшний день компания **Shestakov Yacht Sales Inc.** имеет большое количество яхт в собственном списке продаж, а также тесно сотрудничает со всеми крупными яхтенными производителями по всему миру.

Для того чтобы купить яхту **SEA EAGLE OF SHIAN III — SWAN** а также проконсультироваться по любому вопросу связанному с покупкой, продажей, чартером яхт позвоните по телефону **+7(918)465-66-44**.

# ОГЛАВЛЕНИЕ

ОГЛАВЛЕНИЕ	2
ХАРАКТЕРИСТИКИ	4
Обзор	4
Основная информация	4
Размеры	5
Скорость, вместимость и масса	5
Размещение	5
Корпус и палуба	5
Информация о двигателе	6
ПОДРОБНОЕ ОПИСАНИЕ	7
Refit	7
Accommodations	7
Safety & Fire Protection	8
Communication & Navigation	8
Mechanical	8
Electrical	10
Deck Equipment	10
Sails & Rigging	11
Galley	11
Tenders	11
Исключения	12
Отказ от ответственности	12
ФОТОГРАФИИ	13
КОНТАКТЫ	16
Контактная информация	16
Телефоны	16
Время работы	16
Адрес	16



# ХАРАКТЕРИСТИКИ

## Обзор

Launched in April 1993, she was built with particular attention to detail and an exceptionally long list of extras and upgrades including all of the amenities that one would expect on a yacht of this calibre. The winter 2011 refit included the following upgrades; Sailor Fleet BB250 with additional handset in owners cabin Icom M505 VHF and Command Mic at helm Icom M801 E SSB TH Bury cell phone cradle with external antennal Furuno SC50 satellite compass Furuno GP 32 GPS with data distribution through isolated buffers Raymarine ST60 speed depth and wind systems Additional St60 wind and graphic displays Raymarine SPX30 and 2 off ST6002 control Autopilot system( hydraulic pump also replaced ) SEAME active radar reflector Ruggedized shuttle style comms pc with 17" glass fronted monitor BEP 2 zone Gas alarm system Muster alarm system All navigation light fittings replaced( Aqua signal series 55 ) 2 off Furuno Navnet 3D MFD 12 displays Maxsea time zero explorer software loaded onto comms pc and interfaced to Furuno system Furuno DRS4D digital radar scanner Furuno FA50 AIS transceiver Furuno FAX30 weather fax/ Navtex Replaced Radio batteries Replaced generator battery Mood lighting in saloon Entertainment system consisting of BOSE lifestyle 235 system in saloon, Blue ray player , exterior BOSE 135 speakers in both cockpits. Other improvements include: • New 12mm teak deck laid in 2008 • New Awlgrip Aristo painted topsides in 2008 • Full anti-osmosis treatment including nine coats of Epoxy in 2008 • Full Engine revision including new turbo charger in 2008 • New Navtec rod rigging in 2007 • Mast removed and serviced in 2007, new paint from deck to first spreader Sea Eagle is currently laid up ready for her new owner. She has also been coded to MCA charter standards but please note, some items of equipment may require servicing before she can be re-coded for the current season.

## Основная информация

**Тип судна:** Cruising/Racing Sailboat

**Подкатегория:** Aft Cockpit

**Модельный год:** 1993

**Год постройки:** 1993

**Год обновления:** 2011

**Страна:** United Kingdom

## Размеры

**Длина общая:** 67' 9" (20.63m)

**Длина по ватерлинии:** 54' 9" (16.68m)

**Ширина:** 17' 9" (5.40m)

**Мин. осадка:** 11' 6" (3.50m)

**Макс. осадка:** 10' 6" (3.20m)

## Скорость, вместимость и масса

**Крейс. скорость:** 8 Kts. (9 MPH)

**Макс. скорость:** 10 Kts. (12 MPH)

**Водоизмещение:** 88184.9048 Pounds

**Вместимость воды:** 293.23097772  
Gallons

**Объем топливного бака:** 490.303328512 Gallons  
**Расход топлива:** 2.64172052 Gallons

## Размещение

**Всего кают:** 3

**Всего коек:** 11

**Спальные места:** 11

**Всего ком. состава:** 3

**Каюты экипажа:** 1

**Койки экипажа:** 2

**Комм. состав экипажа:** 1

## Корпус и палуба

**Материал корпуса:** GRP

**Материал палубы:** Teak over Fiberglass

**Комплектация корпуса:** Deep Fin

**Цвет корпуса:** White

**Отделка корпуса:** Stainless Steel

**Дизайнер корпуса:** German Frers

## Информация о двигателе

---

**Двигатели:** 1

**Производитель:** Perkins

**Модель:** Sabre Turbo 184 BHP

**Тип двигателя:** Inboard

**Тип топлива:** Diesel

# ПОДРОБНОЕ ОПИСАНИЕ

## Refit

The winter 2011 refit included the following upgrades; Sailor Fleet BB250 with additional handset in owners cabin Icom M505 VHF and Command Mic at helm Icom M801 E SSB TH Bury cell phone cradle with external antennal Furuno SC50 satellite compass Furuno GP 32 GPS with data distribution through isolated buffers Raymarine ST60 speed depth and wind systems Additional St60 wind and graphic displays Raymarine SPX30 and 2 off ST6002 control Autopilot system( hydraulic pump also replaced ) SEAME active radar reflector Ruggedized shuttle style comms pc with 17" glass fronted monitor BEP 2 zone Gas alarm system Muster alarm system All navigation light fittings replaced( Aqua signal series 55 ) 2 off Furuno Navnet 3D MFD 12 displays Maxsea time zero explorer software loaded onto comms pc and interfaced to Furuno system Furuno DRS4D digital radar scanner Furuno FA50 AIS transceiver Furuno FAX30 weather fax/ Navtex Replaced Radio batteries Replaced generator battery Mood lighting in saloon Entertainment system consisting of BOSE lifestyle 235 system in saloon, Blue ray player , exterior BOSE 135 speakers in both cockpits. Other improvements include: New 12mm teak deck laid in 2008 New Awlgrip Aristo painted topsides in 2008 Full anti-osmosis treatment including nine coats of Epoxy in 2008 Full Engine revision including new turbo charger in 2008 New Navtec rod rigging in 2007 Mast removed and serviced in 2007, new paint from deck to first spreader Sea Eagle is currently laid up ready for her new owner. She has also been coded to MCA charter standards but please note, some items of equipment may require servicing before she can be re-coded for the current season.

## Accommodations

Floorboards with laid teak veneer, providing access to the bilge. Quick pins provided for lifting the floorboards. Topsides where visible lined with teak battens. Overhead lined with removable paneling. Wooden trim inside overhead hatches renewed in 2008 Roller blinds/mosquito screens for hinged deck hatches from 0.5 m width upwards. Cabinets, tables, bureaus, seats, dressers etc. have rounded corners. Doors, partitions and paneling throughout are teak-faced plywood. Door sills have stainless steel chafing pieces. Self-engaging latches with bumpers to hold doors in open position. Hanging lockers are equipped with rods and hooks and have bottom drawers where possible, and their doors are provided with louvers for ventilation Drawers are secured with latches. Wooden companionway ladders with non-slip steps. Upholstery & Linens Hard bottom berths equipped with canvas leeboards. Complete supply of bed linen. Dark Blue covers with white stripes for settees Complete supply of towels for interior and exterior White curtains in saloon recessed behind teak panels Owner's Cabin The master stateroom expands the full beam of the yacht with centreline double berth and an en suite head and separate shower stall. Retractable TV SHARP AQUOS – LC20E1E and a BOSE 3.2.1 home entertainment system. To port, a vanity desk with lockers and mirror above, to starboard, a settee that doubles as an additional berth. On both port and starboard sides, there are hanging lockers, bookshelves, drawers and cabinets. Aft Guest Cabin Forward of the owner's cabin along the starboard side

corridor, there is a guest cabin with upper and lower berths and en-suite head with shower. Also along the aft corridor, there is a Candy washing machine hidden behind a panel on the inboard side Saloon U-Shaped dining settee to port with seating for eight persons around large teak table Settee to starboard with coffee table. Bookshelves and lockers to port and starboard, stbd side bookshelf includes television with combination VHS/DVD player Bar and liquor locker in SB forward corner with Raritan ice maker 2011 Mood lighting in saloon 2011 entertainment system BOSE lifestyle 235 system in saloon, Blue ray player, Exterior BOSE 135 speakers in both cockpits. Forward Guest Cabins (port and starboard side forward of saloon) Double lower berths. Pullman upper berth each side. Hanging lockers and drawers provided Each cabin has en suite head with integrated shower Crew Cabin Pipe berths on both sides with sail bin under, Storage lockers on port side outboard, watertight collision bulkhead aft. Heads Equipped with porcelain washbasin, mirrors, telephone type shower, towel rack, soap and paper holder, trash bin, and lockers. White GRP lining up to washbasin level. Separate shower compartment for Owner with bulkhead mounted shower head.

## Safety & Fire Protection

Total flooding system for engine and generator space with remote control at main companionway. Portable fire extinguishers 1 in galley, 1 nav station, 1 aft stateroom, 2 guest cabins Fire blanket in galley. Safety belts for navigator and cook. Large first aid kit with offshore supplies and medicine (upgraded 2011) 2x Zodiac 6 person life raft 2x MOM8 Man overboard modules on pushpit 1x EPIRB 406 MHz GPS G4 class 2 1x EPIRB 406 MHz GPS Kannard class 2 12x Crew saver 150 N life jackets Smoke alarm in engine room

## Communication & Navigation

INSTRUMENTATION Nav Systems Extensive supply of Navigation equipment included in sale Navigation and Communication system comprehensively upgraded in 2011, consisting of Sailor Fleet BB250 with additional handset in owners cabin Icom M505 VHF and Command Mic at helm Icom M801 E Single Side band TH Bury cell phone cradle with external antennal Furuno SC50 satellite compass Furuno GP 32 GPS with data distribution through isolated buffers Raymarine ST60 speed depth and wind systems Additional ST60 wind and graphic displays Raymarine SPX30 and 2 off ST6002 control Autopilot system (hydraulic pump also replaced ) SEAME active radar reflector Ruggedized shuttle style comms pc with 17" glass fronted monitor 2 x Furuno Navnet 3D MFD 12 displays Maxsea time zero explorer software loaded onto comms pc and interfaced to Furuno system Furuno DRS4D digital radar scanner Furuno FA50 AIS transceiver Furuno FAX30 weather fax/ Navtex Replace Radio batteries Relace generator battery

## Mechanical

ENGINE & SYSTEMS Engine Space Engine space internally sound insulated fire resistance



meeting SOLAS B-15 requirements. Drip tray integral with engine bed. Main Engine (Revised in 2002 and 2008, new turbocharger in 2008) Perkins Sabre M200Ti 6-cylinder turbo-charged and intercooled marine diesel engine, output 165 kW/225 HP at 2500 rpm, with Hurth HSW 630 a reverse/reduction gear 2.52:1. (Total hours 7,107 on 22/1/09) Wet exhaust system with fibreglass silencer, discharge through transom. Silencer provided with drain tap. Thermostat-controlled fresh water cooling with heat exchanger on engine. A separate heat exchanger for the consumable fresh water is included in the same circuit making hot water available whenever the engine is running. Seawater intake with strainer. Discharge through exhaust system. Bow Thruster 11.5 HP MAXPOWER retractable powered by dedicated hydraulic power pack Fuel System Fuel Capacity 1870 Litres in four tanks. Shut-off valves for each tank. Fuel valve chest with return valve for each tank. A dual Racor fuel filter/water separator with water alarm on feed line to engine and a single SWK 2000/5K for diesel generator. Tanks are vented to deck edge. Engine Cockpit Controls Engine control ON/OFF Start and stop buttons/glow button Paralleling button for start and service batteries Single lever control of throttle and gear shift Coolant temperature gauge Oil pressure gauge for engine Tachometer with hour meter Warning light and audible alarm for low oil pressure/high coolant or exhaust temperature Control light for starting and service battery charging Fuel tank gauges Stern Gear Propeller shaft made of high-tensile corrosion resistant steel with flexible shaft coupling. PSS shaft seal. Shaft supported by rubber bearing at bracket and stern tube. Three-bladed feathering propeller, diameter 800 mm by LUKE PLUMBING Sea water hoses of reinforced PVC tubing, fresh water hoses of nylon and copper tubing. All fuel and water tanks are of welded stainless steel, and provided with baffles, inspection covers, sounding plug, and vent pipes. Shower sump tanks are of GRP, integral with the moulded floor liner. Freshwater System Pressurised and heated water. Water capacity 1580 ltr (417 US gallons), in four tanks with one filler line from deck terminating at valve chest under saloon floor. Water tank level gauges, type VDO. Tank vent pipes terminate at galley sink. Deck shower Stbd side aft. Single lever mixing faucets type Oras for washbasins, galley sinks, and showers. The consumable water can be heated either with engine cooling water or with a heating elements working on AC. Hot water tank capacity 2x 60 ltr (15.8 US gallons). Watermaker 190lt/hr Marinco watermaker (New Membranes 2008) Seawater System Electrical deck wash/fire pumps with connection on fore and aft deck, 15 m (50 ft.) hose provided. Sea water tap in galley connected to deck wash pump. Drainage Systems Sinks and wash basins Galley sinks drained through sea cock. Wash basins and showers drain to sump tanks, capacity about 60 ltr (16 US gallons) each. Sump tanks are emptied by manual Whale pump or electrical pump. Outlets above waterline. Bilge pumps Three bilge pumps - one electrical submersible 140 ltr/min (37 US gallons) with automatic switch, and two manual Whale Titan 100 ltr/min (26 gallons). Outlets above waterline. Toilets Vacuflush vacuum assisted toilets using fresh water for flushing, and discharging through sea cock. For midships toilet alternatively to stainless holding tank with indication at 3/4 and 1/1 level. Holding tank emptied overboard by electrical pump Refrigeration System 2x Iceberg refrigeration unit with hold-over plates for refrigerator and freezer Frigoboat engine driven refrigeration compressor Thermostat control enabling freezer to be used as a refrigerator. Ventilation Systems Air Conditioning reverse-cycle Condaria model 75022 Fan coils throughout interior Eberspacher Diesel heater linked to fan coils Natural ventilation in cabins with Dorade type inlets. Exhaust ventilators in heads and in galley 12v Hella Turbo fans throughout interior Engine Area: Air inlet with water trap, outlet with blower. Battery boxes are

ventilated to outside of boat. LPG System Electric solenoid shut-off near cooker, gas bottle stored in vented locker below helmsman seat BEP 2 zone Gas alarm system Muster alarm system

## Electrical

DC 24 V : AC 230V Mood lighting in saloon ELECTRICAL 24v DC system with insulated return, wires are dimensioned to minimise voltage drop. 230v AC is a three-wire system. For lightning protection the headstay, backstay (unless used as SSB antenna), main shroud chain plates and mast step are grounded to ballast keel bolts with heavy cable. DC System New Batteries 24 V 650 Ah for general service 24 V 240 Ah Radio batteries 24 V 240 Ah for main engine start 12 V 135 Ah for diesel generator All battery sets are located in ventilated GRP boxes. Paralleling button for main engine starting batteries and service batteries. AC System The AC system can be fed either by a diesel generator, or a 230 V shore power inlet. Power Systems Koehler 17KVa 50 Hz Generator (New 2007) with sound shield, electronic governor and capacitors

## Deck Equipment

Deck Equipment Folding hydraulic bathing platform on transom Cockpit table for forward cockpit Full cockpit cushions for forward cockpit, including backrests Waterproof Fwd & Aft Cockpit Speakers 16" stainless steel mooring cleats, two on fore deck, two amidships, two aft. Roller Fairleads at stern Pulpit, pushpit and lifeline stanchions 750 mm high of stainless steel, with bases bolted through deck. Spacing conforming to ORC requirements. Pulpit of the open type, and equipped with a seat. Stainless lifelines. Gates in lifelines each side amidships. Socket for flag pole on pushpit. Stowage for two eight-man liferafts in cockpit lockers. Aluminium mast collar GRP moulded hood for companionway hatch GRP moulded dorade ventilation boxes, lazarette, cockpit and foredeck hatches. All navigation light fittings replaced 2011 (Aqua signal series 55) Hatches and Portlights On fore deck two-part hinged aluminium hatches to deck stowage, and anchor windlass. Sliding hatch of aluminium and tinted Perspex above sail locker Deck hatches and portholes Goiot. Main companionway lockable sliding hatch of tinted acrylic. In aft cockpit hinged GRP hatches to lazarette. Gas locker under helmsman's seat. Liferaft lockers in aft cockpit. Winches 2x Primaries Harken 1100 ST hydraulic winches with removable pedestal coffee grinders 2x Secondary Harken 980.2 ST hydraulic 1x Main Halyard Harken 66.3 ST hydraulic 1x Main Sheet Harken 66.2 ST hydraulic 1x Main Sheet Harken 66.2 ST manual 1x Halyard Harken 66.2 ST hydraulic 2x Halyards Harken 66.2 ST manual 1x Topping lift Harken 56.2 ST manual 1x Staysail Halyard Harken 56.2 ST manual 2x Traveller Harken 42.2 ST manual 2x Runners Harken 66.2 ST hydraulic Shore power inlet #1 230 V AC 50 A Shore Power inlet #2 115 V 50 A via 6 kVA transformer Each inlet is provided with polarity alarm, main switch and land connecting cable. Inverters VICTRON Atlas 24/220 volts 2000 watts VICTRON Atlas 24/220 volts 300 watts HEART INTERFACE Freedom 10 24/120 volts 1000 watts Charging The service batteries are charged by a 140 A alternator on the main engine 3 x VICTRON Skylla 50 amp chargers Main engine starting batteries are charged by a 55 A alternator on the main engine Diesel generator starting battery is charged by a 50 A alternator on the generator engine.

## Sails & Rigging

Scantlings to Nautor's standards. Spars built of extruded aluminium alloy sections. Triple spreader masthead rig with discontinuous shrouds. I = 27.30 m 89.57 ft. Fore triangle 107.8 m<sup>2</sup> 1161 sq.ft. J = 7.90 m 25.92 ft. Main sail 92.4 m<sup>2</sup> 994.4 sq.ft. P = 24.80 m 81.36 ft. 150% genoa 161.7 m<sup>2</sup> 1741 sq.ft. E = 7.45 m 24.44 ft. Spinnaker 388 m<sup>2</sup> 4179 sq.ft. Mast Nautor mast of oval section, with external tangs and Harken System C track for full-batten mainsail. Tapered and welded masthead with two spinnaker cranes and three Harken halyard sheaves. Internal wiring, shielded in PVC tubes secured to mast. Open spreaders of polished stainless tubing with adjustable longitudinal angle. Spinnaker gooseneck track with line driver tackle on forward side. One toggle pin each side for jockey pole. Neoprene mast boot with Dacron cover. Standing Rigging (New 2008) Of Navtec Nitronic rod., Babystay, inner forestay, runners and checkstay's of stainless 1 x 19 wire with Norseman terminals. Shroud rollers on babystay and main shrouds. Boom Of oval, tapered section with internal two-part outhaul led to Lewmar 30 CST winch, and arranged for slab reefing with three reefing lines. Poles One spinnaker pole and one jockey pole of round section with appropriate fittings. Spinnaker pole provided with recessed handles Removable aluminium bowsprit prod attached to stemhead fitting Rig Hydraulics For backstay adjustment, one Navtec hydraulic cylinder. For babystay and inner forestay adjustment under-deck cylinders. Hydraulic boom vang with high-pressure return. Four-function one-gauge System 50 central control panel in aft cockpit. Running Rigging (Under Construction) MAST & BOOM White Painted Nautor Aluminum 3-spreader mast with conventional boom; Anchor Windlass Recessed electric windlass, Lofrans Titan "A" with single gypsy and rope drum. Hand control with 3.5 m (11') cable. Chain locker with hatch. External control buttons mounted on foredeck Canvas Awning Main Sail Cover Collapsible bimini for forward and aft cockpits Centre Cockpit Dodger (new 2008) Table cover Wheel covers Console cover Winch covers North Sail Spectra (main sail 2008) Shore Sail Dacron 140% roller furling Genoa (North Sail 2002) Doyle tri-radial 115% roller furling Yankee Doyle tri-radial fore-staysail Doyle storm staysail Doyle storm trysail North Sails asymmetrical spinnaker (2000)

## Galley

Galley The U-shaped galley is located to port amidships and includes: Double Stainless steel sinks Counter tops in Blue/Grey Corian Front loading double-door refrigerator 240 ltr (8.5 cu.ft.) Cooled vegetable locker 240 ltr (8.5 cu.ft.) Top loading freezer 140 ltr (5.0 cu.ft) Whirlpool Microwave oven (powered by 220v inverter) Insulated and sheathed space for 4-burner gas stove and oven Overhead extractor hood with light Miele Dishwasher Lockers, drawers and storage areas Drawer type drinks refrigerator (24 volt) Teak bread board Crockery, cutlery, etc included in sale

## Tenders

2.7m Zodiac inflatable dinghy with 25 hp Yamaha outboard

---

## Исключения

---

При продаже яхты исключаются личные вещи владельца.

---

## Отказ от ответственности

---

Компания предоставляет описание судна или яхты добросовестно, но не может гарантировать точность этой информации, а также не ручается за техническое состояние. Покупатель должен проинструктировать своих агентов или оценщиков исследовать представленную информацию более подробно, по собственному желанию. Продажа судна или яхты, изменение цены или снятие с продажи будет происходить без предварительного уведомления.

# ФОТОГРАФИИ





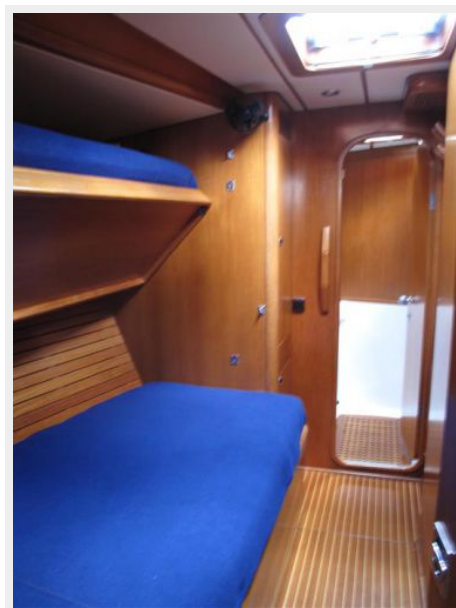

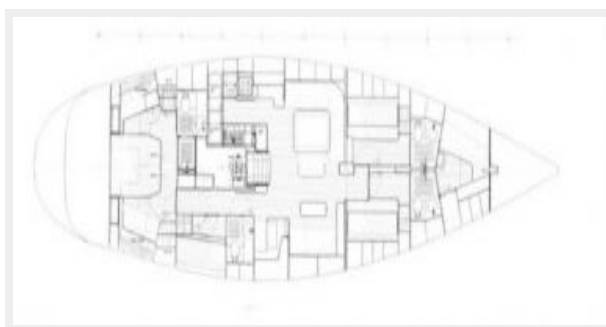

# КОНТАКТЫ

---

Андрей Шестаков (Andrey Shestakov) – ведущий яхтенный брокер отдела продаж яхт и судов компании Shestakov Yacht Sales Inc. Официальный представитель Shestakov Yacht Sales Inc. для русскоговорящих клиентов в центральном офисе компании в Майами/Форт Лодердейл/Флорида/США.

## Контактная информация

---

Email: [andrey@shestakovyachtsales.com](mailto:andrey@shestakovyachtsales.com)

Web: [shestakovyachtsales.com](http://shestakovyachtsales.com)

## Телефоны

---

Краснодарский край: **+7(918)465-66-44**

США, Майами, Флорида: **+1(954)274-4435**

## Время работы

---

Понедельник – Суббота: **9:00 - 21:00**  
EDT

Воскресенье: **Закрето**

## Адрес

---



Harbour Towne Marina, 850 NE 3rd St,  
STE 213, Dania, FL 33004