

FIRST FORTY — NORDHAVN



Builder: NORDHAVN

Year Built: 1999

Model: Trawler

Price: PRICE ON APPLICATION

Location: United States

LOA: 40' 0" (12.19m)

Beam: 14' 5" (4.39m)

Min Draft: 4' 9" (1.45m)

Max Draft: 4' 9" (1.45m)

Cruise Speed: 7 Kts. (8 MPH)

Max Speed: 8 Kts. (9 MPH)

Our experienced yacht broker, Andrey Shestakov, will help you choose and buy a yacht that best suits your needs **First Forty — NORDHAVN** from our catalogue. Presently, at Shestakov Yacht Sales Inc., we have a wide variety of yachts available on our sale's list. We also work in close contact with all the big yacht manufacturers from all over the world.

If you would like to buy a yacht **First Forty — NORDHAVN** or would like help answering any questions concerning purchasing, selling or chartering a yacht, please call **+1(954)274-4435**

TABLE OF CONTENTS

TABLE OF CONTENTS	2
SPECIFICATIONS	5
Overview	5
Basic Information	5
Dimensions	5
Speed, Capacities and Weight	5
Accommodations	6
Hull and Deck Information	6
Engine Information	6
DETAILED INFORMATION	7
40' Nordhavn Overview	7
40' Nordhavn Vessel Walkthrough	7
40' Nordhavn Accommodations	7
40' Nordhavn Salon	7
40' Nordhavn Galley	7
40' Nordhavn Dining	8
40' Nordhavn Master Stateroom	8
40' Nordhavn Guest Stateroom	8
40' Nordhavn Laundry	8
40' Nordhavn Pilothouse	8
40' Nordhavn Aft Deck	8
40' Nordhavn Audio & Visual Equipment	8
40' Nordhavn Electronics	9
40' Nordhavn Electrical Equipment	9
40' Nordhavn Engine/Mechanical Equipment	10
40' Nordhavn Deck Equipment	10
40' Nordhavn Tender	11
40' Nordhavn Safety & Fire Protection	11

40' Nordhavn Exclusions	11
40' Nordhavn Disclaimer	12
Exclusions	12
Disclaimer	12
PHOTOS	13
40' Nordhavn starboard aft profile	13
40' Nordhavn starboard forward profile	13
40' Nordhavn aft profile	13
40' Nordhavn port aft profile	13
40' Nordhavn anchor windlass	14
40' Nordhavn foredeck	14
40' Nordhavn port side deck	14
40' Nordhavn foredeck aft	14
40' Nordhavn starboard side deck	15
40' Nordhavn flybridge	15
40' Nordhavn tender	15
40' Nordhavn aftdeck	15
40' Nordhavn aftdeck seating	15
40' Nordhavn swimplatform	15
40' Nordhavn salon forward	16
40' Nordhavn salon aft	16
40' Nordhavn salon port	16
40' Nordhavn salon port aft	16
40' Nordhavn salon starboard	16
40' Nordhavn salon starboard seating	16
40' Nordhavn galley photo2	17
40' Nordhavn galley photo1	17
40' Nordhavn pilothouse forward	17
40' Nordhavn pilothouse port	17

40' Nordhavn pilothouse starboard	17
40' Nordhavn pilothouse helm	17
40' Nordhavn pilothouse seating photo1	18
40' Nordhavn pilothouse seating photo2	18
40' Nordhavn master stateroom	18
40' Nordhavn master stateroom port	18
40' Nordhavn washer-dryer	18
40' Nordhavn master stateroom starboard	18
40' Nordhavn engine room forward	19
40' Nordhavn engine room aft	19
40' Nordhavn main engine	19
40' Nordhavn Racor fuel filters	19
40' Nordhavn stabilizer system	19
40' Nordhavn electrical panel	19
40' Nordhavn generator sound box	20
40' Nordhavn generator	20
40' Nordhavn layout1	20
40' Nordhavn layout2	20
CONTACTS	21
Contact details	21
Telephones	21
Office hours	21
Address	21

SPECIFICATIONS

Overview

First Forty is a very well maintained 40' Nordhavn trawler. She offers two staterooms, a fuel efficient single Lugger 105hp main engine, stabilizers, bowthruster and numerous updates. She has cruised the entire East Coast in safety and comfort and is turn-key for her new owner. The sellers have owned her for 8 years and are now ready to move onto their next adventure.

Basic Information

Category: Trawler

Sub Category: Raised Pilothouse

Model Year: 1999

Year Built: 1999

Country: United States

Cockpit: Yes

Dimensions

LOA: 40' 0" (12.19m)

LWL: 35' 4" (10.77m)

Beam: 14' 5" (4.39m)

Min Draft: 4' 9" (1.45m)

Max Draft: 4' 9" (1.45m)

Speed, Capacities and Weight

Cruise Speed: 7 Kts. (8 MPH)

Cruise Speed Range: 3000

Max Speed: 8 Kts. (9 MPH)

Displacement: 50000 Pounds

Water Capacity: 200 Gallons

Holding Tank: 40 Gallons

Fuel Capacity: 920 Gallons

Accommodations

Total Cabins: 2

Total Berths: 3

Sleeps: 4

Total Heads: 1

Hull and Deck Information

Hull Material: Fiberglass

Deck Material: Composite Fiberglass

Hull Configuration: Full Displacement

Engine Information

Engines: 1

Manufacturer: Luggier

Model: LP668D

Engine Type: Inboard

Fuel Type: Diesel

DETAILED INFORMATION

40' Nordhavn Overview

First Forty is a very well maintained 40' Nordhavn trawler. She offers two staterooms, a fuel efficient single Lugger 105hp main engine, stabilizers, bowthruster and numerous updates. She has cruised the entire East Coast in safety and comfort and is turn-key for her new owner. The sellers have owned her for 8 years and are now ready to move onto their next adventure.

40' Nordhavn Vessel Walkthrough

Entering the salon from the aftdeck, you will find wrap-around seating and a teak table to starboard, a washer/dryer in a cabinet starboard forward, cabinet and lounge chair to port and the galley port forward. Walking forward, you can step down into the guest companionway to the guest stateroom to port, the master stateroom forward and the head to starboard. Step up into the pilothouse and you will find wing doors to each side deck. The engine room is accessed via a door from the guest stateroom or a salon sole hatch.

40' Nordhavn Accommodations

First Forty offers a master stateroom forward with island queen size berth and a guest stateroom to port with over/under bunks. The head is to starboard and includes an enclosed shower.

40' Nordhavn Salon

The large salon offers built-in seating (Recovered in 2012) with storage underneath and a teak table to starboard, a washer/dryer in a cabinet starboard forward, an Erkornes stressless lounge chair, ottoman and storage cabinet to port, opening windows on each side and aft with curtains and new carpet.

40' Nordhavn Galley

The galley is located port forward in the salon.

- Princess 3-burner gas cooktop and oven
- Norcold refrigerator/freezer (2011)
- GE microwave oven (2012)
- Double stainless steel sinks

- Corian countertop
- Storage drawers and cabinets and a spice rack
- Teak & Spruce sole

40' Nordhavn Dining

Dining space is available at the salon seating and teak table.

40' Nordhavn Master Stateroom

The master stateroom is located forward and offers an island queen size berth, nightstands, overhead hatch, 2 portlights, storage drawers and cabinets, hanging lockers, reading lights, carpet, a built-in seat and direct access to the head with enclosed shower to starboard.

40' Nordhavn Guest Stateroom

The guest stateroom is located to port and offers over/under bunks (lower berth converts to a double size berth), reading lights, hanging locker, storage drawers, carpet and a door to the engine room. The head is to starboard.

40' Nordhavn Laundry

- Splendide 2000 combo washer/dryer

40' Nordhavn Pilothouse

The pilothouse offers a full helm forward with storage underneath, a benchseat and table aft, split Diamond Seaglaze wing doors with screens to each side deck, a folding chart table and an overhead hatch.

40' Nordhavn Aft Deck

The aftdeck offers a non-skid deck, transom door, lazarette access, removable steps on the port side, a boarding gate on the starboard side, built-in seating with storage on each side, hot/cold fresh water shower and an integral fiberglass swimplatform.

40' Nordhavn Audio & Visual Equipment

Polaroid flat screen TV in the salon

- Stereo/CD player with four Toshiba speakers in the salon
- Sirius satellite radio
- Shakespeare Seawatch TV antenna

40' Nordhavn Electronics

Garmin 2210 GPSMap chart plotter (2007)

- Simrad AP21 autopilot
- Raymarine ST40 wind gauge (2012)
- Furuno GP-36 DGPS
- Furuno FCV-667 Color Video Sounder
- Furuno 64nm Radar
- Ritchie Powerdamp magnetic compass
- Icom IC-M127 VHF
- Weems & Plat ship's clock in the pilothouse
- Weems & Plath barometer and clock in the salon

40' Nordhavn Electrical Equipment

- Kilo Pak 12kW generator with 1243 hours
- Leece-Neville 140 amp alternator (2010)
- Xantrex Link 10 battery monitor
- Freedom 2500 watt inverter
- 3 X 8D AGM house batteries (2012)
- 1 X 4D main engine start battery (2009)
- 1 X Group 27 generator start battery (2009)
- 12vdc outlet in the pilothouse

- 50 amp shore cord

40' Nordhavn Engine/Mechanical Equipment

- Single Lugger 105hp main engine with 3913 hours
- Twin Disc MG5050 gearbox
- Morse engine controls
- Fuel manifold
- Dual Racor 75/900FGX fuel filters with vacuum gauge for the main engine
- Racor 500FG fuel filter for the generator
- Gulf Coast fuel polishing system
- Fuel tanks cleaned in 2011
- Reverso oil change system
- Max Power bowthruster (2007)
- Naiad 174 stabilizer system with M

40' Nordhavn Deck Equipment

- Maxwell 2200 anchor windlass with foot controls and helm controls
- Bruce anchor with 300' of 3/8" anchor chain
- Fortress FX-37 spare anchor
- Double anchor rollers
- Fresh water washdown fore and aft and raw water washdown forward
- Stainless steel deck hardware
- Stainless steel rails on the bow pulpit and aft and stainless steel stanchions with double lifelines on the foredeck
- Non-skid decks
- Foredeck storage lockers

-
- Portuguese bridge with gate to the foredeck
 - 2 X fresh air intake Dorades
 - Steps to the flybridge on each side
 - Spreader lights

40' Nordhavn Tender

Alliance 10'6" RIB

- Honda 15hp 4-stroke outboard
- Flybridge mast and boom davit system
- Weaver swim platform davit system

40' Nordhavn Safety & Fire Protection

- ACR EPIRB
- Radar reflector
- AFI horns
- Fire extinguishers
- Kidde smoke detector
- Newmar propane control in the galley
- Manual Edson bilge pump
- Rule bilge pump with high water alarm (2013)
- Par bilge pump (2009)

40' Nordhavn Exclusions

- Sellers' personal belongings
- Artwork

40' Nordhavn Disclaimer

The Company offers the details of this vessel in good faith but cannot guarantee or warrant the accuracy of this information nor warrant the condition of the vessel. A buyer should instruct his agents, or his surveyors, to investigate such details as the buyer desires validated. This vessel is offered subject to prior sale, price change, or withdrawal without notice.

Exclusions

Owner's personal belongings.

Disclaimer

The Company offers the details of this vessel or yacht in good faith but cannot guarantee or warrant the accuracy of this information nor warrant the condition of the vessel. A buyer should instruct his representatives, agents, or his surveyors, to investigate such details as the buyer desires validated. This vessel or yacht is offered subject to prior sale, price change, or withdrawal without notice.

PHOTOS

40' Nordhavn starboard forward profile



40' Nordhavn starboard aft profile



40' Nordhavn port aft profile



40' Nordhavn aft profile



40' Nordhavn anchor windlass



40' Nordhavn foredeck



40' Nordhavn port side deck



40' Nordhavn foredeck aft



40' Nordhavn starboard side deck



40' Nordhavn flybridge



40' Nordhavn tender



40' Nordhavn aftdeck



40' Nordhavn aftdeck seating



40' Nordhavn swimplatform



40' Nordhavn salon forward



40' Nordhavn salon aft



40' Nordhavn salon port



40' Nordhavn salon port aft



40' Nordhavn salon starboard



40' Nordhavn salon starboard seating



40' Nordhavn galley photo2



40' Nordhavn galley photo1



40' Nordhavn pilothouse forward



40' Nordhavn pilothouse port



40' Nordhavn pilothouse starboard



40' Nordhavn pilothouse helm



40' Nordhavn pilothouse seating photo1



40' Nordhavn pilothouse seating photo2



40' Nordhavn master stateroom



40' Nordhavn master stateroom port



40' Nordhavn washer-dryer



40' Nordhavn master stateroom starboard



40' Nordhavn engine room forward



40' Nordhavn engine room aft



40' Nordhavn main engine



40' Nordhavn Racor fuel filters



40' Nordhavn stabilizer system



40' Nordhavn electrical panel



40' Nordhavn generator sound box



40' Nordhavn generator

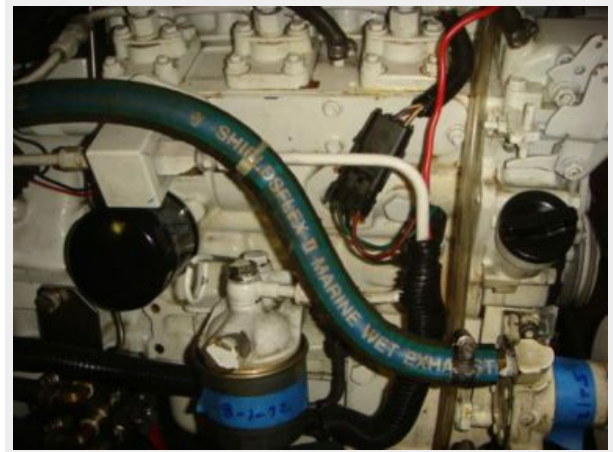

40' Nordhavn layout1

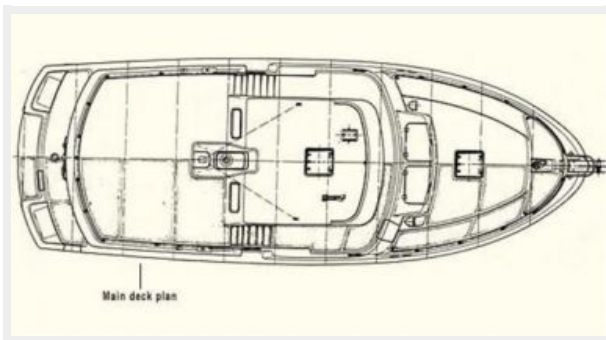

40' Nordhavn layout2

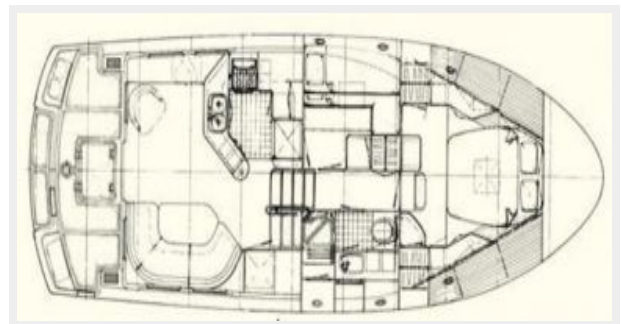

CONTACTS

Andrey Shestakov, leading yacht broker of the sales department of Shestakov Yacht Sales Inc. Shestakov Yacht Sales Inc., the official representative of the Miami/Fort Lauderdale FL headquarters.

Contact details

Email: andrey@shestakovyachtsales.com

Web: shestakovyachtsales.com/en/

Telephones

USA: +1(954)274-4435

Office hours

Monday – Saturday: **9:00 - 21:00** EDT

Sunday: **closed**

Address



Harbour Towne Marina, 850 NE 3rd St,
STE 213, Dania, FL 33004