

## FIRST FORTY — NORDHAVN



**Судостроитель:** [NORDHAVN](#)

**Год постройки:** 1999

**Модель:** Траулер

**Цена:** **ЦЕНА ЯХТЫ ПО ЗАПРОСУ**

**Местонахождение:** United States

**Длина общая:** 40' 0" (12.19m)

**Ширина:** 14' 5" (4.39m)

**Мин. осадка:** 4' 9" (1.45m)

**Макс. осадка:** 4' 9" (1.45m)

**Крейс. скорость:** 7 Kts. (8 MPH)

**Макс. скорость:** 8 Kts. (9 MPH)

Купить **First Forty — NORDHAVN** а также выбрать подходящую вам яхту из нашего каталога яхт вам поможет опытный яхтенный брокер Андрей Шестаков. На сегодняшний день компания **Shestakov Yacht Sales Inc.** имеет большое количество яхт в собственном списке продаж, а также тесно сотрудничает со всеми крупными яхтенными производителями по всему миру.

Для того чтобы купить яхту **First Forty — NORDHAVN** а также проконсультироваться по любому вопросу связанному с покупкой, продажей, чартером яхт позвоните по телефону **+7(918)465-66-44**.

# ОГЛАВЛЕНИЕ

---

ОГЛАВЛЕНИЕ	2
ХАРАКТЕРИСТИКИ	5
Обзор	5
Основная информация	5
Размеры	5
Скорость, вместимость и масса	5
Размещение	6
Корпус и палуба	6
Информация о двигателе	6
ПОДРОБНОЕ ОПИСАНИЕ	7
40' Nordhavn Overview	7
40' Nordhavn Vessel Walkthrough	7
40' Nordhavn Accommodations	7
40' Nordhavn Salon	7
40' Nordhavn Galley	7
40' Nordhavn Dining	8
40' Nordhavn Master Stateroom	8
40' Nordhavn Guest Stateroom	8
40' Nordhavn Laundry	8
40' Nordhavn Pilothouse	8
40' Nordhavn Aft Deck	8
40' Nordhavn Audio & Visual Equipment	8
40' Nordhavn Electronics	9
40' Nordhavn Electrical Equipment	9
40' Nordhavn Engine/Mechanical Equipment	10
40' Nordhavn Deck Equipment	10
40' Nordhavn Tender	11
40' Nordhavn Safety & Fire Protection	11

40' Nordhavn Exclusions	11
40' Nordhavn Disclaimer	12
Исключения	12
Отказ от ответственности	12
<b>ФОТОГРАФИИ</b>	<b>13</b>
40' Nordhavn starboard aft profile	13
40' Nordhavn starboard forward profile	13
40' Nordhavn aft profile	13
40' Nordhavn port aft profile	13
40' Nordhavn anchor windlass	14
40' Nordhavn foredeck	14
40' Nordhavn port side deck	14
40' Nordhavn foredeck aft	14
40' Nordhavn starboard side deck	15
40' Nordhavn flybridge	15
40' Nordhavn tender	15
40' Nordhavn aftdeck	15
40' Nordhavn aftdeck seating	15
40' Nordhavn swimplatform	15
40' Nordhavn salon forward	16
40' Nordhavn salon aft	16
40' Nordhavn salon port	16
40' Nordhavn salon port aft	16
40' Nordhavn salon starboard	16
40' Nordhavn salon starboard seating	16
40' Nordhavn galley photo2	17
40' Nordhavn galley photo1	17
40' Nordhavn pilothouse forward	17
40' Nordhavn pilothouse port	17

40' Nordhavn pilothouse starboard	17
40' Nordhavn pilothouse helm	17
40' Nordhavn pilothouse seating photo1	18
40' Nordhavn pilothouse seating photo2	18
40' Nordhavn master stateroom	18
40' Nordhavn master stateroom port	18
40' Nordhavn washer-dryer	18
40' Nordhavn master stateroom starboard	18
40' Nordhavn engine room forward	19
40' Nordhavn engine room aft	19
40' Nordhavn main engine	19
40' Nordhavn Racor fuel filters	19
40' Nordhavn stabilizer system	19
40' Nordhavn electrical panel	19
40' Nordhavn generator sound box	20
40' Nordhavn generator	20
40' Nordhavn layout1	20
40' Nordhavn layout2	20
<b>КОНТАКТЫ</b>	<b>21</b>
Контактная информация	21
Телефоны	21
Время работы	21
Адрес	21

# ХАРАКТЕРИСТИКИ

## Обзор

First Forty is a very well maintained 40' Nordhavn trawler. She offers two staterooms, a fuel efficient single Lugger 105hp main engine, stabilizers, bowthruster and numerous updates. She has cruised the entire East Coast in safety and comfort and is turn-key for her new owner. The sellers have owned her for 8 years and are now ready to move onto their next adventure.

## Основная информация

<b>Тип судна:</b> Траулер	<b>Подкатегория:</b> Raised Pilothouse
<b>Модельный год:</b> 1999	<b>Год постройки:</b> 1999
<b>Страна:</b> United States	<b>Кубрик:</b> Да

## Размеры

<b>Длина общая:</b> 40' 0" (12.19m)	<b>Длина по ватерлинии:</b> 35' 4" (10.77m)
<b>Ширина:</b> 14' 5" (4.39m)	<b>Мин. осадка:</b> 4' 9" (1.45m)
<b>Макс. осадка:</b> 4' 9" (1.45m)	

## Скорость, вместимость и масса

<b>Крейс. скорость:</b> 7 Kts. (8 MPH)	<b>Дальность на крейсерской скорости:</b> 3000
<b>Макс. скорость:</b> 8 Kts. (9 MPH)	<b>Водоизмещение:</b> 50000 Pounds
<b>Вместимость воды:</b> 200 Gallons	<b>Вместимость сточного бака:</b> 40 Gallons
<b>Объем топливного бака:</b> 920 Gallons	

## Размещение

---

**Всего кают:** 2

**Всего коек:** 3

**Спальные места:** 4

**Всего ком. состава:** 1

## Корпус и палуба

---

**Материал корпуса:** Fiberglass

**Материал палубы:** Composite Fiberglass

**Комплектация корпуса:** Full  
Displacement

## Информация о двигателе

---

**Двигатели:** 1

**Производитель:** Luger

**Модель:** LP668D

**Тип двигателя:** Inboard

**Тип топлива:** Diesel

---

# ПОДРОБНОЕ ОПИСАНИЕ

---

## 40' Nordhavn Overview

---

First Forty is a very well maintained 40' Nordhavn trawler. She offers two staterooms, a fuel efficient single Luger 105hp main engine, stabilizers, bowthruster and numerous updates. She has cruised the entire East Coast in safety and comfort and is turn-key for her new owner. The sellers have owned her for 8 years and are now ready to move onto their next adventure.

## 40' Nordhavn Vessel Walkthrough

---

Entering the salon from the aftdeck, you will find wrap-around seating and a teak table to starboard, a washer/dryer in a cabinet starboard forward, cabinet and lounge chair to port and the galley port forward. Walking forward, you can step down into the guest companionway to the guest stateroom to port, the master stateroom forward and the head to starboard. Step up into the pilothouse and you will find wing doors to each side deck. The engine room is accessed via a door from the guest stateroom or a salon sole hatch.

## 40' Nordhavn Accommodations

---

First Forty offers a master stateroom forward with island queen size berth and a guest stateroom to port with over/under bunks. The head is to starboard and includes an enclosed shower.

## 40' Nordhavn Salon

---

The large salon offers built-in seating (Recovered in 2012) with storage underneath and a teak table to starboard, a washer/dryer in a cabinet starboard forward, an Erkornes stressless lounge chair, ottoman and storage cabinet to port, opening windows on each side and aft with curtains and new carpet.

## 40' Nordhavn Galley

---

The galley is located port forward in the salon.

- Princess 3-burner gas cooktop and oven
- Norcold refrigerator/freezer (2011)
- GE microwave oven (2012)
- Double stainless steel sinks

- Corian countertop
- Storage drawers and cabinets and a spice rack
- Teak & Spruce sole

---

## 40' Nordhavn Dining

---

Dining space is available at the salon seating and teak table.

---

## 40' Nordhavn Master Stateroom

---

The master stateroom is located forward and offers an island queen size berth, nightstands, overhead hatch, 2 portlights, storage drawers and cabinets, hanging lockers, reading lights, carpet, a built-in seat and direct access to the head with enclosed shower to starboard.

---

## 40' Nordhavn Guest Stateroom

---

The guest stateroom is located to port and offers over/under bunks (lower berth converts to a double size berth), reading lights, hanging locker, storage drawers, carpet and a door to the engine room. The head is to starboard.

---

## 40' Nordhavn Laundry

---

- Splendide 2000 combo washer/dryer

---

## 40' Nordhavn Pilothouse

---

The pilothouse offers a full helm forward with storage underneath, a benchseat and table aft, split Diamond Seaglaze wing doors with screens to each side deck, a folding chart table and an overhead hatch.

---

## 40' Nordhavn Aft Deck

---

The aftdeck offers a non-skid deck, transom door, lazarette access, removable steps on the port side, a boarding gate on the starboard side, built-in seating with storage on each side, hot/cold fresh water shower and an integral fiberglass swimplatform.

---

## 40' Nordhavn Audio & Visual Equipment

---



Polaroid flat screen TV in the salon

- Stereo/CD player with four Toshiba speakers in the salon
- Sirius satellite radio
- Shakespeare Seawatch TV antenna

---

## 40' Nordhavn Electronics

---

Garmin 2210 GPSMap chart plotter (2007)

- Simrad AP21 autopilot
- Raymarine ST40 wind gauge (2012)
- Furuno GP-36 DGPS
- Furuno FCV-667 Color Video Sounder
- Furuno 64nm Radar
- Ritchie Powerdamp magnetic compass
- Icom IC-M127 VHF
- Weems & Plat ship's clock in the pilothouse
- Weems & Plath barometer and clock in the salon

---

## 40' Nordhavn Electrical Equipment

---

- Kilo Pak 12kW generator with 1243 hours
- Leece-Neville 140 amp alternator (2010)
- Xantrex Link 10 battery monitor
- Freedom 2500 watt inverter
- 3 X 8D AGM house batteries (2012)
- 1 X 4D main engine start battery (2009)
- 1 X Group 27 generator start battery (2009)
- 12vdc outlet in the pilothouse

- 50 amp shore cord

---

## 40' Nordhavn Engine/Mechanical Equipment

---

- Single Lugger 105hp main engine with 3913 hours
- Twin Disc MG5050 gearbox
- Morse engine controls
- Fuel manifold
- Dual Racor 75/900FGX fuel filters with vacuum gauge for the main engine
- Racor 500FG fuel filter for the generator
- Gulf Coast fuel polishing system
- Fuel tanks cleaned in 2011
- Reverso oil change system
- Max Power bowthruster (2007)
- Naiad 174 stabilizer system with M

---

## 40' Nordhavn Deck Equipment

---

- Maxwell 2200 anchor windlass with foot controls and helm controls
- Bruce anchor with 300' of 3/8" anchor chain
- Fortress FX-37 spare anchor
- Double anchor rollers
- Fresh water washdown fore and aft and raw water washdown forward
- Stainless steel deck hardware
- Stainless steel rails on the bow pulpit and aft and stainless steel stanchions with double lifelines on the foredeck
- Non-skid decks
- Foredeck storage lockers

- Portuguese bridge with gate to the foredeck
- 2 X fresh air intake Dorades
- Steps to the flybridge on each side
- Spreader lights

## **40' Nordhavn Tender**

---

Alliance 10'6" RIB

- Honda 15hp 4-stroke outboard
- Flybridge mast and boom davit system
- Weaver swim platform davit system

## **40' Nordhavn Safety & Fire Protection**

---

- ACR EPIRB
- Radar reflector
- AFI horns
- Fire extinguishers
- Kidde smoke detector
- Newmar propane control in the galley
- Manual Edson bilge pump
- Rule bilge pump with high water alarm (2013)
- Par bilge pump (2009)

## **40' Nordhavn Exclusions**

---

- Sellers' personal belongings
- Artwork

---

## 40' Nordhavn Disclaimer

---

The Company offers the details of this vessel in good faith but cannot guarantee or warrant the accuracy of this information nor warrant the condition of the vessel. A buyer should instruct his agents, or his surveyors, to investigate such details as the buyer desires validated. This vessel is offered subject to prior sale, price change, or withdrawal without notice.

---

## Исключения

---

При продаже яхты исключаются личные вещи владельца.

---

## Отказ от ответственности

---

Компания предоставляет описание судна или яхты добросовестно, но не может гарантировать точность этой информации, а также не ручается за техническое состояние. Покупатель должен проинструктировать своих агентов или оценщиков исследовать представленную информацию более подробно, по собственному желанию. Продажа судна или яхты, изменение цены или снятие с продажи будет происходить без предварительного уведомления.

# ФОТОГРАФИИ

40' Nordhavn starboard forward profile



40' Nordhavn starboard aft profile



40' Nordhavn port aft profile



40' Nordhavn aft profile



**40' Nordhavn anchor windlass**



**40' Nordhavn foredeck**



**40' Nordhavn port side deck**



**40' Nordhavn foredeck aft**



**40' Nordhavn starboard side deck**



**40' Nordhavn flybridge**



**40' Nordhavn tender**



**40' Nordhavn aftdeck**



**40' Nordhavn aftdeck seating**



**40' Nordhavn swimplatform**





**40' Nordhavn salon forward**



**40' Nordhavn salon aft**



**40' Nordhavn salon port**



**40' Nordhavn salon port aft**



**40' Nordhavn salon starboard**



**40' Nordhavn salon starboard seating**





40' Nordhavn galley photo1



40' Nordhavn galley photo2



40' Nordhavn pilothouse forward



40' Nordhavn pilothouse port



40' Nordhavn pilothouse starboard



40' Nordhavn pilothouse helm



40' Nordhavn pilothouse seating photo1



40' Nordhavn pilothouse seating photo2



40' Nordhavn master stateroom



40' Nordhavn master stateroom port



40' Nordhavn washer-dryer



40' Nordhavn master stateroom starboard





**40' Nordhavn engine room forward**



**40' Nordhavn engine room aft**



**40' Nordhavn main engine**



**40' Nordhavn Racor fuel filters**



**40' Nordhavn stabilizer system**



**40' Nordhavn electrical panel**



40' Nordhavn generator sound box



40' Nordhavn generator



40' Nordhavn layout1

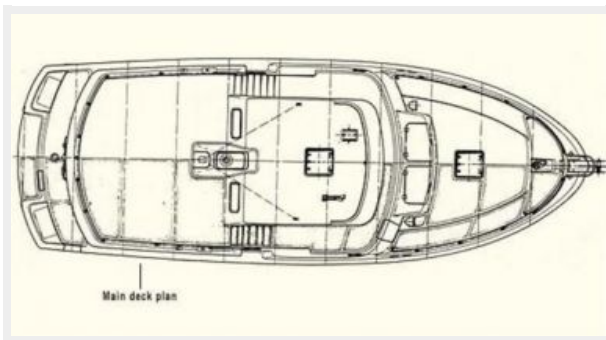

40' Nordhavn layout2

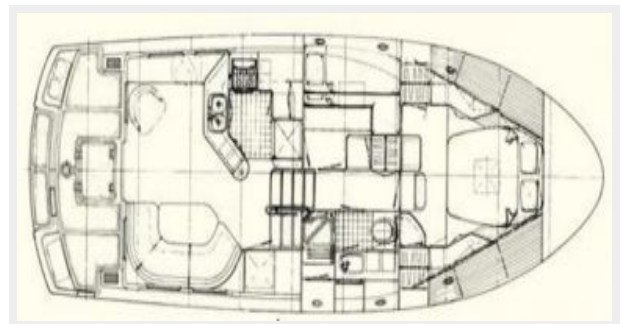

# КОНТАКТЫ

---

Андрей Шестаков (Andrey Shestakov) – ведущий яхтенный брокер отдела продаж яхт и судов компании Shestakov Yacht Sales Inc. Официальный представитель Shestakov Yacht Sales Inc. для русскоговорящих клиентов в центральном офисе компании в Майами/Форт Лодердейл/Флорида/США.

## Контактная информация

---

Email: [andrey@shestakovyachtsales.com](mailto:andrey@shestakovyachtsales.com)

Web: [shestakovyachtsales.com](http://shestakovyachtsales.com)

## Телефоны

---

Краснодарский край: **+7(918)465-66-44**

США, Майами, Флорида: **+1(954)274-4435**

## Время работы

---

Понедельник – Суббота: **9:00 - 21:00**  
EDT

Воскресенье: **Закрито**

## Адрес

---



Harbour Towne Marina, 850 NE 3rd St,  
STE 213, Dania, FL 33004