

NO NAME — ENDEAVOUR



Судостроитель: ENDEAVOUR

Год постройки: 1997

Модель: Катамаран

Цена: ЦЕНА ЯХТЫ ПО ЗАПРОСУ

Местонахождение: United States

Длина общая: 30' 0" (9.14m)

Ширина: 14' 6" (4.42m)

Макс. осадка: 2' 10" (0.86m)

Купить **NO NAME — ENDEAVOUR** а также выбрать подходящую вам яхту из нашего каталога яхт вам поможет опытный яхтенный брокер Андрей Шестаков. На сегодняшний день компания **Shestakov Yacht Sales Inc.** имеет большое количество яхт в собственном списке продаж, а также тесно сотрудничает со всеми крупными яхтенными производителями по всему миру.

Для того чтобы купить яхту **NO NAME — ENDEAVOUR** а также проконсультироваться по любому вопросу связанному с покупкой, продажей, чартером яхт позвоните по телефону **+7(918)465-66-44**.

ОГЛАВЛЕНИЕ

ОГЛАВЛЕНИЕ	2
ХАРАКТЕРИСТИКИ	3
Обзор	3
Основная информация	8
Размеры	9
Скорость, вместимость и масса	9
Размещение	9
Корпус и палуба	9
Информация о двигателе	9
ФОТОГРАФИИ	10
КОНТАКТЫ	14
Контактная информация	14
Телефоны	14
Время работы	14
Адрес	14

ХАРАКТЕРИСТИКИ

Обзор

This Endeavour Cat 30 Mark II is the highly desirable additional interior headroom model. A large U-shaped cockpit and rail mounted seating on the bow allows ample seating for friends and family. She is equipped with a simple yet efficient main sail and self-tacking jib set up for effortless sailing. Below deck the Endeavour Cat impresses with her spaciousness air-conditioned accommodations and seating for 6 around the U-shaped settee in the main salon. Private queen berth state rooms on each side with a large head with separate walk in shower stall to starboard and fully equipped galley down to port with plenty of countertop space for preparing gourmet meals.

Fully equipped with Air Conditioning, Genset, Dinghy with Outboard, Lazy Jacks for fully battened mainsail, Shoal Draft, 15' Beam and Low Engine Hours! This Catamaran is ready for cruising comfortably!

This 30' Endeavour MKII Cat is the only one available in the United States. Don't miss out! Call today! Specs Designer: Endeavour Design Team Flag of Registry: United States Keel: Fin Hull Shape: Catamaran Dimensions LOA: 30 ft 0 in Beam: 14 ft 6 in LWL: 29 ft 6 in Maximum Draft: 2 ft 10 in Displacement: 7800 lbs Bridge Clearance: 46 ft 6 in Headroom: 6 ft 4 in Dry Weight: 7800 lbs Engines Engine 1: Engine Brand: Volvo Year Built: 1999 Engine Type: Inboard Engine/Fuel Type: Diesel Location: Port Engine Hours: 1200 Drive Type: Sail drive Engine Power: 9 HP Engine 2: Engine Brand: Volvo Year Built: 1999 Engine Type: Inboard Location: Starboard Engine Hours: 1200 Propeller: Folding propeller Drive Type: Sail drive Engine Power: 9 HP Tanks Fresh Water Tanks: Aluminum (90 Gallons) Fuel Tanks: Aluminum (60 Gallons) Accommodations Number of single berths: 2 Number of cabins: 2 Number of heads: 1 Electronics VHF - ICOM IC-M304 Compass - Ritchie GPS - Garmin 45xl CD player - Jensen Log-speedometer - Autohelm NAVDATA Depthsounder - Autohelm Autopilot - Raytheon ST4000 Radar - Raytheon Pathfinder SL70 Radio - Jensen Plotter - Garmin GPSmap 492 Sails Genoa Battened mainsail Rigging Steering wheel Inside Equipment Marine head - Jabsco Manual bilge pump Air conditioning - Cruisair 1600BTU reverse cycle Hot water Oven - Hillerange Microwave oven - Goldstar Electric bilge pump Refrigerator Battery charger - 30 AMP Electrical Equipment Shore power inlet Outside Equipment/Extras Tender - West Marine 9.5' w/ Yamaha 4 stroke Swimming ladder Cockpit table Cockpit cushions Davits Cockpit shower Covers Mainsail cover Spray hood Bimini Top Genoa cover

Manufacturer Provided Description

The Endeavourcat 30 Mk II offers a perfect blend of spacious interior accommodations and performance for the cruising family. The shoal draft and moderate sail plan allow the cruiser to explore areas inaccessible to the average boat. Based on the highly successful Endeavourcat 30, the new Mk II incorporates some very exciting features which will

increase the "livability and cruising" potential immensely. The interior improvements include 6-foot headroom and enlarged seating in the salon, with increased window area for more visibility and light, as well as increased water tankage. An extra 22 inches of waterline improve speed and ride. Twin Volvo 9 hp diesel inboards with sail drives make this catamaran easy to maneuver in tight places. With these features combined with the already proven attributes of the original Endeavourcat 30, the Endeavourcat 30 Mk II is known as the "the ultimate family cruiser." All Endeavours 30 MKIIs are manufactured to standards approved for ABS certification.

Accommodations

The large cockpit of this catamaran flows directly into the salon via the retractable coach roof making it very comfortable to relax and enjoy the spacious salon. With a wrap around settee you can sit back and take in the views. The galley down arrangement to port is clean and efficient with plenty of storage. With two queen berths, one in each hull and a full walk in shower and head this boat feels like a much larger boat.

EndeavourCat 30' MKII Specifications

Standard Equipment Construction - Hull, deck and structural bulkheads manufactured of biaxial fiberglass with isophthalic - vinylester resins and Nida Core (polypropylene honeycomb core), vacuum-bagged - Hull to deck fastened chemically and mechanically - Twin fiberglass molded keels, foam filled with integral sumps - Twin high-density foam - fiberglass balanced rudders.

Sails & Sail Handling -

Aluminum mast and boom

Tri-stay rig, stainless steel standing rigging

Full-batten Dacron mainsail with large roach

Strong sail track system

Integral boom bag

Lazyjacks

Self-tacking, full-batten Dacron jib with Camber Spar

Topping lift

Main halyard, main sheet, and one single line reef lead to self-tailing winch

Jib sheet

Jib halyard and boom brake lead to self-tailing winch

Rigid boom vang

Sheet stoppers

Mechanical, Electrical & Plumbing

90 gal. water tank with gauge and filter

12 V hot & cold water pressure system

60 gal. fuel tank with gauge

30 gal. holding tank with level indicator

210 amp house system Lifeline marine batteries (2)

110 V shore power system

Premier Plus AC-DC electrical panel

30 amp shore cord

40 amp Smart battery charger

Running lights, anchor lights, combo steaming and foredeck light

20 lb. aluminum propane tank in separate vented locker

Deck mounted fuel, water and holding tank access

Remote shutoff for propane

Engine exchange water heater 110 V - 12 V interior lighting

12 V automatic (2), manual bilge pumps (2)

Non-corrosive, fiberglass reinforced Marelon through-hulls and seacocks

12 V macerator for holding tank pump-out

Deck - Pedestal mounted hydraulic steering with stainless steel wheel and shift - throttle controls

Adjustable helm seat with foot rest

Stainless steel pedestal guard

Emergency tiller

4" binnacle compass

Aluminum opening ports with screens

Stainless steel stanchions

Molded PVC rub-rail

Molded fiberglass bow corner rail seats

Bow and stern corner rails with lifelines

Double lifelines

Lifeline gates - port, starboard, forward, aft

Large sliding companionway hatch

Molded fiberglass double companionway doors

Stainless steel anchor roller and cleat

Stainless steel bow, stern and amidships cleats

Self-draining foredeck storage lockers

Cockpit lazarette storage

Stainless steel boarding ladder on starboard. transom steps

Molded non-skid on all deck surfaces

Bimini - dodger combo

Engines - Twin Volvo 9 hp diesel engines with sail drives and folding propellers

Engine cranking marine battery (2)

55 amp alternators (2)

Fuel filters

Battery disconnect switches

Engine battery parallel switch

3.5 kW diesel generator

16,000 BTU Cruisair Air Conditioning

Dual station VHF

Raytheon ST60 Tridata (depth - speed - log)

Raytheon ST60 Wind Monitor

Raytheon ST5000 hydraulic Autopilot

Garmin GPS with depth sounder

Raytheon SL72 Pathmaker 24 n.m radar with custom stainless mount

AM-FM Stereo-CD with four speakers - 10 disc CD Changer

TV antenna

TV - phone inlet - dockside with cord

Transom rack with davits and rail-mounted grill - cooler

Cockpit table - Cockpit pit cushions

Hot & cold deck shower

Salt water wash down at bow

Engines

Next Power Generator 4 kw 118 hours

Twin Volvo 9 H.P. FWC Engines with Volvo Saildrives S120s

Raw Water Strainer

Fuel Filters

Engine Alarms

Sail Area

IJPE : 425.00 sq ft I : 29.00 ft J : 8.17 ft P : 35.00 ft E : 17.50 ft Working Sail Area : 482.00 sq ft

Основная информация

Тип судна: Катамаран

Модельный год: 1997

Год постройки: 1997

Страна: United States

Размеры

Длина общая: 30' 0" (9.14m)

Длина по ватерлинии: 26' 6" (8.08m)

Ширина: 14' 6" (4.42m)

Макс. осадка: 2' 10" (0.86m)

Трапы: 46' 6" (14.17m)

Скорость, вместимость и масса

Водоизмещение: 7800 Pounds

Вместимость воды: 90 Gallons

Объем топливного бака: 60 Gallons

Размещение

Всего кают: 2

Корпус и палуба

Материал корпуса: Fiberglass

Информация о двигателе

Двигатели: 2

Производитель: Volvo

Модель: Sail Drive

Тип двигателя: Inboard

Тип топлива: Diesel

ФОТОГРАФИИ

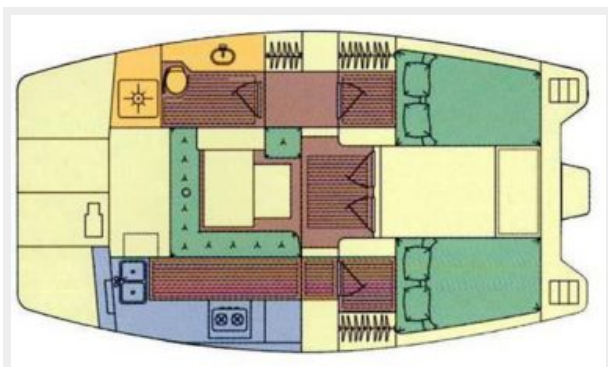

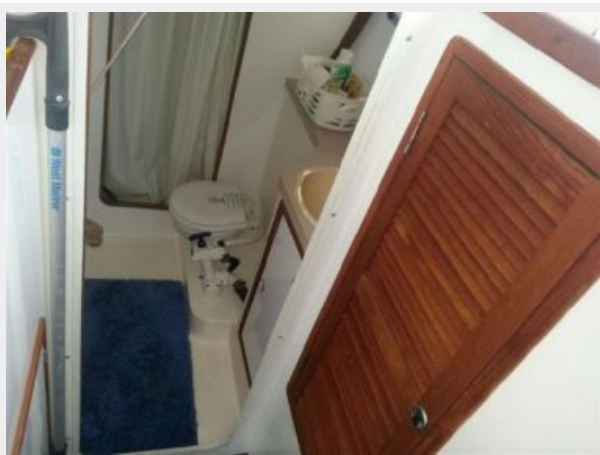





КОНТАКТЫ

Андрей Шестаков (Andrey Shestakov) – ведущий яхтенный брокер отдела продаж яхт и судов компании Shestakov Yacht Sales Inc. Официальный представитель Shestakov Yacht Sales Inc. для русскоговорящих клиентов в центральном офисе компании в Майами/Форт Лодердейл/Флорида/США.

Контактная информация

Email: andrey@shestakovyachtsales.com

Web: shestakovyachtsales.com

Телефоны

Краснодарский край: **+7(918)465-66-44**

США, Майами, Флорида: **+1(954)274-4435**

Время работы

Понедельник – Суббота: **9:00 - 21:00**
EDT

Воскресенье: **Закрето**

Адрес



Harbour Towne Marina, 850 NE 3rd St,
STE 213, Dania, FL 33004