

TAIRUA — RIVAL BOWMAN



Builder: RIVAL BOWMAN

Year Built: 2001

Model: Cruising Sailboat

Price: PRICE ON APPLICATION

Location: United Kingdom

LOA: 49' 10" (15.19m)

Beam: 14' 2" (4.32m)

Min Draft: 6' 0" (1.83m)

Cruise Speed: 8 Kts. (9 MPH)

Max Speed: 9 Kts. (10 MPH)

Our experienced yacht broker, Andrey Shestakov, will help you choose and buy a yacht that best suits your needs **TAIRUA — RIVAL BOWMAN** from our catalogue. Presently, at Shestakov Yacht Sales Inc., we have a wide variety of yachts available on our sale's list. We also work in close contact with all the big yacht manufacturers from all over the world.

If you would like to buy a yacht **TAIRUA — RIVAL BOWMAN** or would like help answering any questions concerning purchasing, selling or chartering a yacht, please call **+1(954)274-4435**

TABLE OF CONTENTS

TABLE OF CONTENTS	2
SPECIFICATIONS	4
Overview	4
Basic Information	4
Dimensions	4
Speed, Capacities and Weight	4
Accommodations	4
Hull and Deck Information	5
Engine Information	5
DETAILED INFORMATION	6
Owner's Comments	6
Construction	7
Machinery	8
Electrical Systems	9
Plumbing Systems	10
Tankage	10
Navigation Equipment	11
Domestic Equipment	12
Accommodation	12
Deck Equipment	13
Exclusions	15
Disclaimer	16
PHOTOS	17
CONTACTS	24
Contact details	24
Telephones	24
Office hours	24
Address	24

SPECIFICATIONS

Overview

From 2001 a truly cherished example of these bluewater 4x4's a glowing testimony the build quality of these yachts.

Basic Information

Category: Cruising Sailboat

Sub Category: Center Cockpit

Model Year: 2001

Year Built: 2001

Country: United Kingdom

Dimensions

LOA: 49' 10" (15.19m)

LWL: 38' 3" (11.66m)

Beam: 14' 2" (4.32m)

Min Draft: 6' 0" (1.83m)

Speed, Capacities and Weight

Cruise Speed: 8 Kts. (9 MPH)

Cruise Speed Range: 600

Max Speed: 9 Kts. (10 MPH)

Displacement: 34330.38343864 Pounds

Water Capacity: 166.42839276 Gallons

Fuel Capacity: 166.42839276 Gallons

Accommodations

Total Cabins: 2

Total Berths: 6

Total Heads: 2

Hull and Deck Information

Hull Material: GRP

Deck Material: GRP

Hull Designer: Chuck Paine

Engine Information

Engines: 1

Manufacturer: Perkins

Model: M92

Engine Type: Inboard

Fuel Type: Diesel

DETAILED INFORMATION

Owner's Comments

My partner Lesley and I had for many years chartered in almost every part of the world that offered charter facilities and were particularly taken with the islands and passages of NW British Columbia and SE Alaska. Chartering in these areas was difficult and not really available for long periods. In 2000 we decided to acquire a boat and take it to Vancouver as a long term base for further exploration. This resulted in a new Bowman 48DS being commissioned on the basis of its design features for extended bluewater cruising, the reputation of Chuck Paine for sea-kindly yachts and the ease of handling features incorporated in the Bowman build. TAIRUA was launched in May 2001 and after some sea trials we sailed direct to the Canaries to join that year's ARC. From there we cruised in bursts to fit the weather windows as follows:

- Up and down the Caribbean islands from a base in St. Lucia.
- Along the coastal islands of Venezuela to Bonaire.
- Bonaire, Curacao, Aruba and on to the San Blas islands and then to Bocas del Toro (northern Panama).
- Through the Panama canal and on to the Galapagos islands.
- Galapagos to Hawaii following the traditional sailing ship route which takes you west then north (a journey of over 4,000 miles which took us 28 days, at times covering over 200 miles per day comfortably and at others becalmed!).
- Hawaii to Sitka in SE Alaska.
- Sitka to Vancouver via the inside passage. Vancouver became our base for the next 6-7 years.

From this base we cruised from Olympia in the south to Glacier Bay in the north exploring the many and varied passages and islands in this extraordinary archipelago (covering over 1,000 nm as the crow flies).

In 2010 we decided to move on and trucked her from Vancouver to Kingston at the start of the St. Lawrence waterway. From there we sailed to the Bras d'Or Lakes in Nova Scotia to winter over.

We left Nova Scotia in 2012 to cruise Maine.

Departed Maine in 2013 and sailed across the Atlantic to Costa del Sol, Spain. And in 2014 returned to the UK.

Throughout all this she has been sailed mostly by myself and one other competent crew, and occasionally only me. She has seen days of calm and 55+ Kts across the deck in Alaskan waters. The crew have always complimented her (and Chuck Paine) with a brilliant seaworthy design.

Maintenance has always been a priority item as in those waters things needed to be attended to before they became an issue in a remote place. The Whispergen unit was replaced under warranty in 2003. The hatch lenses were replaced under Lewmar warranty in 2004. The engine has been serviced, impeller and all filters replaced each year, new batteries (AGM) were installed in 2013. Standing rigging has been checked each year since 2010 as we have had to unstep the mast for winterisation (always indoor). In 2013 the cap shrouds showed a small abrasion effect and were replaced. The Max prop was fully serviced and rebalanced in 2010.

The black water holding tank was upgraded to plastic in 2008.

All halyards, sheets, etc. checked each year and the only replacement needed has been the topping lift (2013).

Whilst in Canadian and US waters the sails were stored and checked by North Sails each year. Some fullness was removed from the Yankee in 2008 but other than some chafe issues North have given them a good report each year. Having said that I realise that even Vectran has its limits and a new suit should be seriously considered if an extended cruise is planned.

Note: A unique point for TAIRUA – she has a Panama Canal Measurement Certificate which means she can register for transit before arriving in Panama itself. This is a saving of a few weeks delay in the normal process of arrive and then request (and wait for) a measurement.

Construction

RCD Status: The yacht conforms with the essential safety requirements of Directive 94/25EC

(Recreational Craft Directive) and is categorised A – “Ocean”; plate affixed to confirm category.

Hull, Deck & Superstructure Construction:

- Hand laid GRP hull with isophthalic resin; epoxy coated below waterline. 1m wide Kevlar included in lay-up around waterline area.
- Hull Colour: Midnight Blue, AwlGrip painted 2013.
- GRP superstructure, in off white.
- Teak external trim.
- Teak laid side decks, superstructure tops and cockpit.

Keel & Rudder:

- Lead keel, bolted externally.
- Skeg hung Grp foamed filled rudder on 2" stainless stock.

Machinery

Engine & Gearboxes:

- 1 x Perkins M92 64kW diesel engine.
- Hurth HSW 450A reduction gearbox; 2.04:1.

Maintenance & Performance:

- Engine hours – approx 2,500 as of arrival in Lymington.
- Engine last serviced: June 2014. Winterised September 2014
- Cruising speed – approx 7.5 knots @ 1600rpm.
- Maximum speed – approx 8.5 knots @ 2200rpm.
- Fuel consumption at cruising speed – approx 7 litres per hour.
- Range @ cruising speed – approx 600 Nm. Additional fuel tank installed at build time.

Propulsion & Steering:

- Max Prop 3-bladed propeller.
- One wheel (Edson) cable steering.

Electrical Systems

Voltage Systems:

- 12vDC/24vDC domestic system with 220v/110AC ring main from inverter and/or shorepower.

Battery Banks:

- 6 x AGM Service Batteries in 3 x 24v banks for 309 amp hrs. New 2013.
- 2x AGM engine batteries for 24v working. New 2013.
- All batteries secured with hold down bars.

Battery Chargers:

- 24v Combi inverter charger 2500 w.
- 24v 3A trickle charger for Engine bank when wintering over.

Alternators:

- 110A 24v Leece Neville alternator for Service bank, Balmar ARS-5 regulator.
- 60A 24v Prestolite alternator for Engine bank, internal regulator.

Generator:

- WhisperTech external combustion 900w generator with fresh water cooling via central heating radiators and hot water calorifier. Heat exchanger to sea water.
- Generator hours – approx 200 as of June 2014.

- Generator last serviced: June 2014.

Shore Power:

- 230 / 110 input to isolation transformer and ring main within the yacht.

Plumbing Systems

Fresh Water & Water Heating System:

- Hot water from calorifier with 220v immersion element.
- Engine and generator plumbed to calorifier.

Watermaker:

- Spectra 350, currently not in commission.

Bilge Pumps:

- Electric and manual main bilge.
- Electric and manual forward sail locker.
- All electric bilge pumps have dual and independent level monitors.

Tankage

Fuel:

- 2 x Tanks aft for fuel - 225 litres each - plus amidships fuel tank - 180 litres. Total capacity of 630 L.

Fresh water:

- Total capacity of 630 litres in 2 x tanks.

Grey/Blackwater holding tanks:

- Grey water holding tank for forward and aft heads, and galley.
- Black water holding tank to forward and aft heads; replaced in polycarbonate in 2008.

Navigation Equipment

Cockpit

- B&G Hydra pilot.

In companionway:

- B&G Hydra 2000 Synchro wind speed and direction indicator, boat speed, depth.
- Garmin 3210 colour chart plotter display.
- InterPhase Probe forward looking echo sounder.

At chart table:

- B&G Hydra 2000 wind/speed/depth multi repeater.
- B&G Sonic speed.
- Furuno NavText.
- Furuno GPS 36.
- Furuno 1382 radar with ARPA.
- WatchMate AIS class B.

Communications Equipment:

- Furuno FM-2721 VHF with DSC.
- Garmin 725 VHF handheld.
- Motorola 9500 Iridium handset.
- Kenwood TRC-70 SSB with SGC auto-tune and ground plate.

Domestic Equipment

Galley:

- Taylor 041 gas cooker.
- Isotherm electric water cooled refrigeration.
- Isotherm electric water cooled deep freeze
- Nova 1000 washing machine.

Heads/Showers:

- 2 x Jabsco manual WCs.
- 2 x showers hot/cold water.

Heating & Ventilation:

- Hot water / radiator heating from generator.
- 10x opening hatches.
- 4 x stainless Dorade vents with Stainless crash bars.

Entertainment:

- Sony stereo radio/CD (10x cassette)/tape in saloon.

Lighting:

- 24v deckhead and reading lights most converted to LED over past 2 years.

Accommodation

Summary of Accommodation:

- Teak (matt varnish) interior finish.
- Veneered bulkheads with solid teak trim throughout.

- Teak and holly sole boards.
- Blue super suede upholstery.
- 2x single berths in forepeak with dressing table and drawer stowage between. Roll out pilot berths above each.
- Forward heads to port, drawer and hanging stowage to starboard. Additional chart stowage above.
- Luxury saloon with twin roll out pilot berths on port and starboard sides.
- Large teak saloon table with wine / spirit stowage under.
- Navigation area with chart table to suit 1/2 admiralty chart.
- Work bench and spare parts store aft of navigation area.
- Wet hanging locker.
- Aft master cabin with double berth, dressing table, en-suite heads and shower.

Deck Equipment

Rig:

- Cutter-headed sloop with Schaefer furling gear on headsail.
- Hank on stay sail
- Selden spars.
- Stainless steel standing rigging.
- Cap shrouds 2013
- Harken backstay adjuster.
- Mast stowing spinnaker pole.
- Insulated backstay.
- In-mast mainsail furling by Hood.
- Mast steps to lower cross-tree.
- Selden rodkicker.

Winches:

- 2 x Lewmar ST64 primaries
- 2 x Lewmar ST50 secondaries
- 1 x Lewmar ST44 Mainsheet
- 1 x Lewmar ST44 companionway.
- 1 x Lewmar ST44 electric companionway.
- 1 x Lewmar ST 48 mast

Sails:

- Hood vertical batten mainsail in Vectran.
- Hood yankee in Vectran.
- Hood staysail in Vectran with self-tack sheeting.
- Hood storm staysail in Dacron Dayglow Orange.

General:

- Pulpit, pushpit, guard rails, bathing ladder and boarding gates.

Anchoring & Mooring Equipment:

- Lewmar Ocean electric windlass.
- Anchors; 1 x 34kg CQR with 100m chain. 1 x 20kg CQR with 20m chain and 15m warp.
- Transom mounted anchor roller.
- Windlass controls forward deck and at cockpit pedestal.

Covers, Canvas & Cushions:

- Cockpit seat cushions.

- Dodger and Bimini.

Tender & Outboard:

- Avon 3.3m inflatable.
- Yamaha Malta 4hp outboard.

Safety Equipment:

- 6 man Liferaft in canister – double floor white E pack.(due inspection)
- 1 x horseshoe lifebuoy with Dan buoy.
- 1 x horseshoe lifebuoy.

Fire-fighting equipment:

- 3 x Fire extinguishers in cabins.
- 1 x Engine room auto extinguisher.
- 1 x On-deck fire extinguisher.
- All due service

Additional:

- Perkins on-board spares kit.
- A set of Whispergen spares
- A full set of tools in two tool bags
- Comprehensive selection rope and cordage to cover most cruising situations

Exclusions

Owner's personal belongings.

Disclaimer

The Company offers the details of this vessel or yacht in good faith but cannot guarantee or warrant the accuracy of this information nor warrant the condition of the vessel. A buyer should instruct his representatives, agents, or his surveyors, to investigate such details as the buyer desires validated. This vessel or yacht is offered subject to prior sale, price change, or withdrawal without notice.

PHOTOS













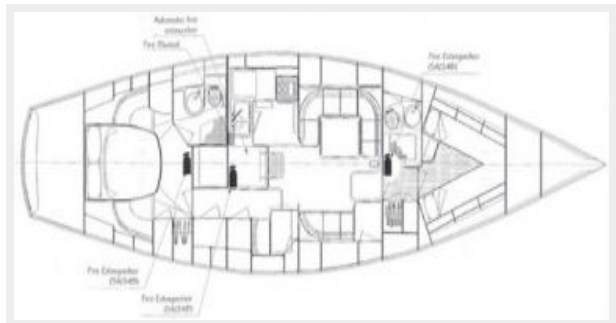
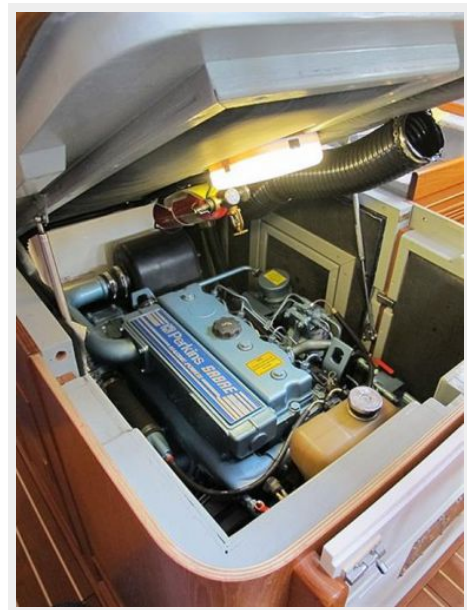
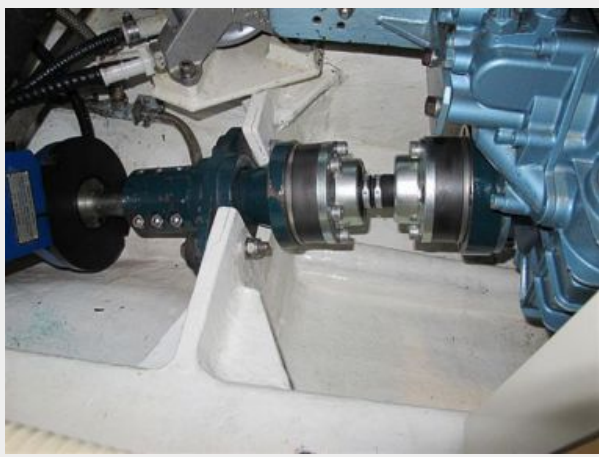
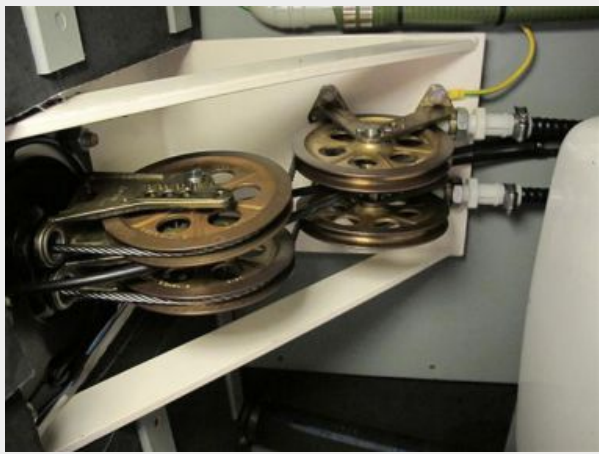

CONTACTS

Andrey Shestakov, leading yacht broker of the sales department of Shestakov Yacht Sales Inc. Shestakov Yacht Sales Inc., the official representative of the Miami/Fort Lauderdale FL headquarters.

Contact details

Email: andrey@shestakovyachtsales.com

Web: shestakovyachtsales.com/en/

Telephones

USA: +1(954)274-4435

Office hours

Monday – Saturday: **9:00 - 21:00** EDT

Sunday: **closed**

Address



Harbour Towne Marina, 850 NE 3rd St,
STE 213, Dania, FL 33004