

NATI TOO — FERRETTI



Судостроитель: FERRETTI

Год постройки: 2005

Модель: Моторная яхта

Цена: **ЦЕНА ЯХТЫ ПО ЗАПРОСУ**

Местонахождение: Spain

Длина общая: 96' 2" (29.31m)

Ширина: 23' 4" (7.11m)

Макс. осадка: 6' 3" (1.91m)

Макс. скорость: 24 Kts. (28 MPH)

Купить **NATI TOO — FERRETTI** а также выбрать подходящую вам яхту из нашего каталога яхт вам поможет опытный яхтенный брокер Андрей Шестаков. На сегодняшний день компания **Shestakov Yacht Sales Inc.** имеет большое количество яхт в собственном списке продаж, а также тесно сотрудничает со всеми крупными яхтенными производителями по всему миру.

Для того чтобы купить яхту **NATI TOO — FERRETTI** а также проконсультироваться по любому вопросу связанному с покупкой, продажей, чартером яхт позвоните по телефону **+7(918)465-66-44**.

ОГЛАВЛЕНИЕ

ОГЛАВЛЕНИЕ	2
ХАРАКТЕРИСТИКИ	4
Основная информация	4
Размеры	4
Скорость, вместимость и масса	4
Размещение	4
Корпус и палуба	4
Информация о двигателе	5
ПОДРОБНОЕ ОПИСАНИЕ	6
Description	6
Fly Bridge	6
Main Deck	6
Lower Deck	7
Entertainment System	8
Electronics	8
Electrical System	9
Mechanical	9
Deck & Hull equipment	9
Additional	10
Исключения	10
Отказ от ответственности	10
ФОТОГРАФИИ	11
Running	11
Flybridge dining	11
Flybridge Jacuzzi	11
Flybridge Dining and BBQ	11
Flybridge Helm Position	12
Foredeck	12

Forward sunbed	12
Sidedecks	12
Helm position	12
Aft Deck Dining	12
Aft Dining Space	13
Aft Dining Space	13
Saloon	13
Dining Area Saloon and Bar	13
Upper Saloon Dining Area	13
Galley	13
Main Bridge	14
Upper Deck Master Stateroom	14
Master Stateroom Bathroom	14
VIP Stateroom	14
Twin Stateroom	15
Twin showing Pullman Bed	15
Engine	15
Stern with garage door	15
Garage	15
Profile	16
FLYBRIDGE	16
MAIN DECK	16
LOWER DECK	16
КОНТАКТЫ	17
Контактная информация	17
Телефоны	17
Время работы	17
Адрес	17

ХАРАКТЕРИСТИКИ

Основная информация

Тип судна: Моторная яхта

Модельный год: 2005

Год постройки: 2005

Страна: Spain

Открытая палуба мостика: Да

Размеры

Длина общая: 96' 2" (29.31m)

Ширина: 23' 4" (7.11m)

Макс. осадка: 6' 3" (1.91m)

Скорость, вместимость и масса

Макс. скорость: 24 Kts. (28 MPH)

Чистый вес: 169 Pounds

Вместимость воды: 792.516156 Gallons

Объем топливного бака: 3117.2302136 Gallons

Размещение

Всего кают: 4

Всего ком. состава: 10

Каюта капитана: Да

Койки экипажа: 4

Корпус и палуба

Материал корпуса: Fiberglass

Материал палубы: Teak over Fiberglass

Информация о двигателе

Двигатели: 2

Производитель: MTU

Модель: 16V 2000 M91

Тип двигателя: Inboard

Тип топлива: Diesel

ПОДРОБНОЕ ОПИСАНИЕ

Description

'Nati Too' is an elegant 2005 Ferretti Custom Line 94, offered seriously for sale and in pristine condition. One of the last Ferretti 94s to be built, 'Nati Too' has been finished to an exceptionally high standard throughout, with no expense having been spared on her maintenance.

Fitted with twin 2000HP MTU 16V 2000 M91 engines and being one of only two Ferretti 94s fitted with the superb anti roll Gyro stabilizers, 'Nati Too' comfortably reaches a top speed of 24 knots. Her huge specification includes, flybridge spa tub, flybridge crane, Idromar water maker, CCTV, KVH G8 Satellite TV system and 3 x Kohler 27kw generators.

The gleaming white hull and superstructure of 'Nati Too' is complimented beautifully by the light and airy interior which has been completed using cherry wood with a satin finish and accessorised wonderfully by the cream carpets and white leather soft furnishings. The extensive exterior areas of the flybridge, aft deck and foredeck provide guests onboard with excellent al fresco entertaining and dining spaces.

The sumptuous accommodation on 'Nati Too' consists of four en suite staterooms with berths for up to ten guests and comprises of a private, main deck, full beam, master suite forward, whilst the remaining guest accommodation is located on the lower deck and includes a grand full beam VIP stateroom aft with two en suite twin guest cabins forward to port and starboard, which are both fitted with an additional Pullman berth. The crew accommodation is accessed via a separate staircase in the galley.

Fly Bridge

Ascending to the flybridge from the stairs in the aft cockpit, there is an s-shaped sofa seating area running along the port side, the aft of which wraps around the luxurious flybridge spa tub, while heading forwards the other half of the s-shape incorporates the al fresco dining area which is serviced by the well equipped wet bar to starboard.

Forward and to port is the flybridge helm, which has bench style helm seating to both port and starboard.

Centrally located are the stairs down to the main bridge area. This staircase enables the crew to discretely service the guests on the flybridge from the main deck galley with ease.

Accessed along the port and starboard side decks is the secluded foredeck which provides an excellent area for those sun worshippers onboard to enjoy the vista ahead.

Main Deck

Stepping onboard 'Nati Too' you arrive in the capacious aft cockpit which provides a great al fresco dining area and is fitted with oval dining table and ample seating.

Heading forward through the floor to ceiling tinted glass sliding doors, you arrive in the light and airy main deck saloon, which has a relaxed c-shaped sofa seating area to port and drinks bar to starboard. Heading forward to port is the formal dining area with modern glass dining table for seating for up to eight guests.

Forward and to the port of the formal dining is a door leading into the well equipped galley, ready to cater for all the needs of those onboard. To the aft of the galley are the separate stairs which take you down to the separate crew quarters.

To the starboard of the formal dining area, heading into the corridor you will find the atrium staircase to port which descends to the lower deck and ascends to the bridge, whilst forward of the stairwell and to starboard is the day head.

Finally you arrive in the stunning main deck, full beam, master stateroom. This has a large L-shaped sofa area to the starboard of the bed, with dressing table running along the port side. The sumptuous en suite on the port side is fitted with twin basins, WC, bidet and large walk in shower. The walk in wardrobe to the starboard side is of a great size.

Ascending the stairs from the main deck you arrive in the high tech bridge. As well as being fitted with an array of navigational and electronic equipment, there is also a sofa area to port and chart table to starboard. The stairs to the flybridge are centrally located..

Lower Deck

Once you have descended the stairs from the main deck you arrive in the lower deck lobby. Heading aft you will arrive in the very spacious, full beam VIP guest cabin, its luxurious en suite is fitted with a Jacuzzi bath, twin basins and WC and bidet which can be separated from the rest of the en suite with a sliding door. The VIP cabin also has a large walk in wardrobe, sofa seating area and vanity table.

Heading forwards to both port and starboard are two beautifully appointed en suite twin cabins. Both twin cabins are also fitted with an additional Pullman berth.

The crew accommodation is located on the lower deck, in the bow. Access is from a separate staircase descending from the main deck galley. The crew quarters consist of a double captains cabin with additional Pullman berth and en suite and a twin bunk cabin with en suite. The communal area consists of a sofa seating area with table and basic galley.

The large tender garage can either be accessed from the transom or via internal stairs, located in the aft cockpit.

From either entrance point you can then access the storage area and engine room.

Entertainment System

KVH G8 Satellite TV System

KVH Fleet 55 Satellite Communications System

Large Flatscreen TV in Salon on drop down mechanism from ceiling

Large Flatscreen TV in VIP and Master Cabins

TV in Guest Cabins and Crew Area Hard Drive Music System by Masters through entire boat

NAD Sony Surround Sound System in Salon

Denon DVD/CD/Radio to all Cabins

IPOD Docking Stations to whole boat

PC with Printer/Scanner/Fa and UPS

Onboard Wifi and ability to link to external networks

Digibox for Spanish TV Reception

Electronics

Simrad CX54 Color Radar/Plotter with GPS

Simrad 45cm Color Plotter Screen

Geonav GPS Chart Plotter

3D Navnet Color Plotter on Flybridge

Simrad AP25 Autopilot

Simrad IS15 Speed

Simrad IS15 Depth

Interphase forward looking Sounder (2) Dual station Shipmate RS87 VHF (DSC) (4) handsets (1) Crew area

Furuno SSB Radio

Raymarine 430 Loud Hailer

Micronet Tacktick Wind Indicator

Navted NX300 Weather Station

(2) Anchor Chain Counters

Internal Phone System

Electrical System

24/220 volt system with shore support

Clendinning Cable Master Mastervolt Chargers

Mastervolt Inverter

Mechanical

Engines: 2 x MTU 16V 2000 M91, 2000HP Engine hours as of June 2015: Port: 2487
Starboard: 2479

Engines serviced in June 2015

3 x Kohler 27KW Generators (320h, 3250h & 1110h @ 11/10) all with Digital Read Outs

One Generator exclusively for ARG Stabilizers Generator hours as of June 2015:

#1 Gen : 4098

#2 Gen : 4097 #3 Gen : 2655 All Kohler gens serviced annually, and last in June 2015

Deck & Hull equipment

Bimini Top on Flybridge

Teak on Flybridge

Jacuzzi on Flybridge

Full Bar with (2) Refrigerators, Ice Maker, Sink and BBQ Grill on Flybridge

Lifting Mechanism in Garage for Jetski

Extra Chest Refrigerator on Aft Deck

Shower Stall on Aft Deck

Large Aft Deck Table w/ (4) Stowable Exterior Chairs (Varnished 2010)

Besenzoni Crane to Flybridge

Bensenzoni Hydraulic Steel & Teak Passerelle

Avon Sport JetRIB 400 DL

Additional

Large hydraulic platform that hides the tender and has room for a jet ski as well. Tons of storage for bicycles, dive tanks, etc.

Hydraulic Steering

Electronic MTU Engine Controls

American Thruster Bow Thruster

Third Station Controls with Rudder Joystick in Aft Cockpit

(2) 8 Person life rafts

(2) Life rings with light and throwing line

CCTV System with (5) Cameras

Smoke alarm system Bilge alarm system

Исключения

При продаже яхты исключаются личные вещи владельца.

Отказ от ответственности

Компания предоставляет описание судна или яхты добросовестно, но не может гарантировать точность этой информации, а также не ручается за техническое состояние. Покупатель должен проинструктировать своих агентов или оценщиков исследовать представленную информацию более подробно, по собственному желанию. Продажа судна или яхты, изменение цены или снятие с продажи будет происходить без предварительного уведомления.

ФОТОГРАФИИ

Running



Flybridge dining



Flybridge Dining and BBQ



Flybridge Jacuzzi



Flybridge Helm Position



Foredeck



Forward sunbed



Side decks

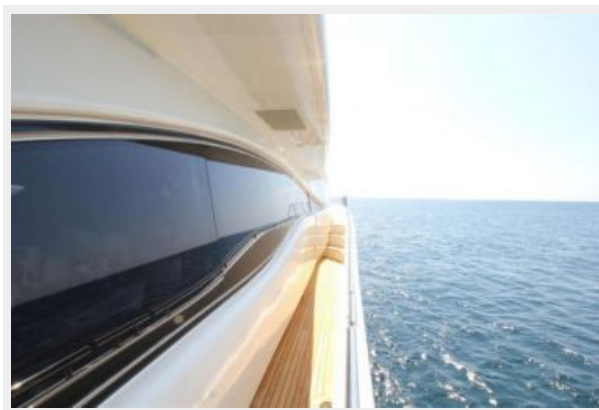

Helm position



Aft Deck Dining



Aft Dining Space



Aft Dining Space



Saloon



Dining Area Saloon and Bar



Upper Saloon Dining Area



Galley



Main Bridge



Upper Deck Master Stateroom



Master Stateroom Bathroom



VIP Stateroom



Twin Stateroom



Twin showing Pullman Bed



Engine



Stern with garage door



Garage



Profile



FLYBRIDGE

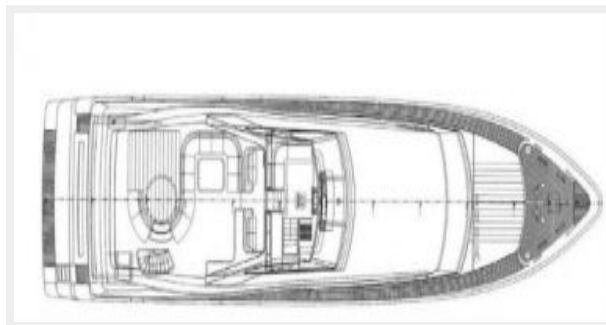

MAIN DECK

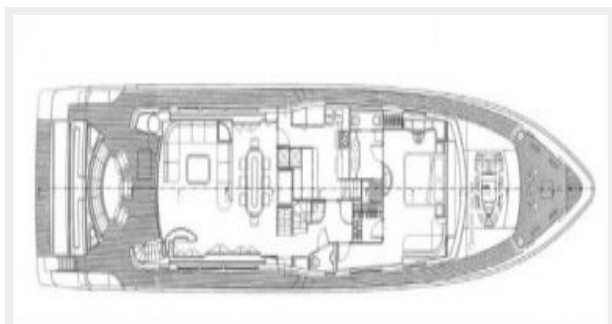

LOWER DECK

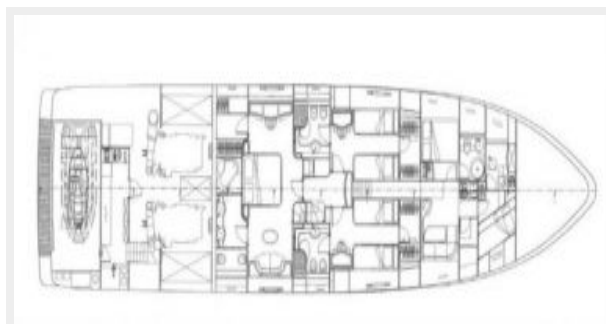

КОНТАКТЫ

Андрей Шестаков (Andrey Shestakov) – ведущий яхтенный брокер отдела продаж яхт и судов компании Shestakov Yacht Sales Inc. Официальный представитель Shestakov Yacht Sales Inc. для русскоговорящих клиентов в центральном офисе компании в Майами/Форт Лодердейл/Флорида/США.

Контактная информация

Email: andrey@shestakovyachtsales.com

Web: shestakovyachtsales.com

Телефоны

Краснодарский край: **+7(918)465-66-44**

США, Майами, Флорида: **+1(954)274-4435**

Время работы

Понедельник – Суббота: **9:00 - 21:00**
EDT

Воскресенье: **Закрито**

Адрес



Harbour Towne Marina, 850 NE 3rd St,
STE 213, Dania, FL 33004