

CRICKET — OCEAN YACHTS



Builder: [Ocean Yachts](#)

Year Built: 2000

Model: Sport Fisherman

Price: PRICE ON APPLICATION

Location: United States

LOA: 43' 10" (13.36m)

Beam: 15' 2" (4.62m)

Min Draft: 3' 7" (1.09m)

Cruise Speed: 24 Kts. (28 MPH)

Max Speed: 30 Kts. (35 MPH)

Our experienced yacht broker, Andrey Shestakov, will help you choose and buy a yacht that best suits your needs **CRICKET — Ocean Yachts** from our catalogue. Presently, at Shestakov Yacht Sales Inc., we have a wide variety of yachts available on our sale's list. We also work in close contact with all the big yacht manufacturers from all over the world.

If you would like to buy a yacht **CRICKET — Ocean Yachts** or would like help answering any questions concerning purchasing, selling or chartering a yacht, please call **+1(954)274-4435**

TABLE OF CONTENTS

TABLE OF CONTENTS	2
SPECIFICATIONS	3
Overview	3
Basic Information	3
Dimensions	3
Speed, Capacities and Weight	4
Accommodations	4
Hull and Deck Information	4
Engine Information	4
DETAILED INFORMATION	5
Accommodations	5
Engines and Machinery	5
Electrical Equipment	5
Fishing Equipment	5
Deck Equipment	6
Cockpit	6
Disclaimer	6
Exclusions	7
Disclaimer	7
PHOTOS	8
CONTACTS	15
Contact details	15
Telephones	15
Office hours	15
Address	15

SPECIFICATIONS

Overview

This boat has 1170 Hours on Twin Volvo 480's and . . . Needs some TLC, Clean-up and odds n ends mechanical repairs but will be a great deal for someone who wants a low hour 43 Ocean at a Great price who is not afraid to buy right and put some money/sweat equity into the deal. One of the most popular designs by Ocean Yachts the 43 is fast, economical to run, and has a fantastic interior layout

The 43 Ocean Super Sport with her stylish rakish profile better and than average performance also boasts a well finished interior with a spacious salon and an innovative master stateroom layout. Built on a tapered modified vee hull with a shallow keel and a well flared bow, The 43 SS featured a long list of standard equipment. Her spacious 2 stateroom interior floorplan is arranged with private head in the forepeak of the bow in the master stateroom, a guest stateroom tucked in under the galley with double bed and a guest/day head directly across companionway. Her wide open salon features an L-shaped settee to port with breakfast bar forward and mid level galley only 1 step down from the salon. To port is an occasional chair and an L-shaped dinette tucked in all the way forward. The cockpit has a freezer, a huge fish box, transom livewell, washdowns, tackle storage lockers, a transom door and cockpit engine room access. Additional features include central vacuum, wide side decks, engine room washdown and a bow pulpit, Her Twin 480 HP Volvo's will cruise her in the mid 20's and a top end of 30 plus knots.

BROKER COMMENTS: Great Layout/Model for Family Cruising/Fishing, Low Hours on Engines/Genset, Needs some TLC and Detail work but overall good 2000 model year boat **PRICED TO SELL !!**

Basic Information

Category: Sport Fisherman

Sub Category: Convertible

Model Year: 2000

Year Built: 2000

Country: United States

Vessel Top: Hardtop

Dimensions

LOA: 43' 10" (13.36m)

Beam: 15' 2" (4.62m)

Min Draft: 3' 7" (1.09m)

Clearance: 15' 5" (4.70m)

Speed, Capacities and Weight

Cruise Speed: 24 Kts. (28 MPH)

Max Speed: 30 Kts. (35 MPH)

Displacement: 37000 Pounds

Water Capacity: 94 Gallons

Fuel Capacity: 438 Gallons

Accommodations

Total Cabins: 2

Sleeps: 6

Total Heads: 2

Hull and Deck Information

Hull Material: Fiberglass

Hull Configuration: Modified V-Hull

Engine Information

Manufacturer: Volvo

Engine Type: Inboard

Fuel Type: Diesel

DETAILED INFORMATION

Accommodations

Beginning forward is the master stateroom with off-center queen berth and ensuite heard all the way forward in the Vee. The guest stateroom is next aft along the port side with twin berths that convert to a large double. The guest head is across to starboard with stall shower and washer/dryer. Up to the salon and galley areas. The galley is on the port side and features Corian® counters and sink top, microwave oven, Insta-hot water faucet, 2 burner stove, refrigerator/freezer with a dining area across to starboard with L-shaped seating and a large hi-gloss table. The salon is full-width and features an L-shaped settee (with rod storage), occasional chair, hi-lo table and complete entertainment center. Interior colors are crisp and neutral.

Engines and Machinery

Emergency engine "Y" valve bilge pump, Steering is hydraulic wheel. Head types overboard, holding & electric.

- Marine air 40,000 btu reverse cycle air conditioner
- Fresh water cooling system
- (2) spare propellers
- Engine synchronizers
- Emergency engine stop
- Fuel shut-off valve
- Fume alarm
- Fire control system
- Oil transfer system
- Raw water sea strainer
- (2) Bilge blowers
- Fuel filter
- (3) Bilge pumps

Electrical Equipment

- 110V AC electrical system
- 7.6 kw Westerbeke generator
- Battery parallel switch
- 12V DC electrical system
- Auto/manual 60 amp's battery charger
- (4) batteries

Fishing Equipment

- Rupp 30' Outriggers
- Rupp center rigger

- **Fighting Chair**
- **Fish box**
- **Bait freezer**
- **(8) rod holders**
- **Cockpit sink**
- **Transom Livewell**
- **Tackle Storage Lockers**

Deck Equipment

Glendinning cablemaster, the windlass has both deck and bridge controls. Fenders and lines, search lights and spreader lights.

- **Danforth anchor**
- **Side stanchions**
- **Transom door**
- **Wash down system**
- **Bow rail**
- **Coast guard safety package**
- **Hailer**
- **(6) life jackets**
- **Swim platform with ladder**
- **Bow pulpit**
- **Alden EPIRB with emergency GPS**
- **Lewmar Concept II windlass**
- **Navigation light**

Cockpit

- **(4) Rod holders**
- **Cockpit side lockers**
- **Fish box**
- **Boarding step box**
- **Freezer**
- **Live baitwell**
- **Door to engine room**
- **Tackle locker w/sink & fresh water**
- **Transom door & hinged gate**
- **Fresh & Salt water washdowns**
- **Dockside connection**
- **Fresh water spigot**

Disclaimer

The Company offers the details of this vessel in good faith but cannot guarantee or warrant the accuracy of this information nor warrant the condition of the vessel. A buyer should instruct his agents, or his surveyors, to investigate such details as the buyer desires validated. This vessel is offered subject to prior sale, price change, or withdrawal without notice.

Exclusions

Owner's personal belongings.

Disclaimer

The Company offers the details of this vessel or yacht in good faith but cannot guarantee or warrant the accuracy of this information nor warrant the condition of the vessel. A buyer should instruct his representatives, agents, or his surveyors, to investigate such details as the buyer desires validated. This vessel or yacht is offered subject to prior sale, price change, or withdrawal without notice.

PHOTOS

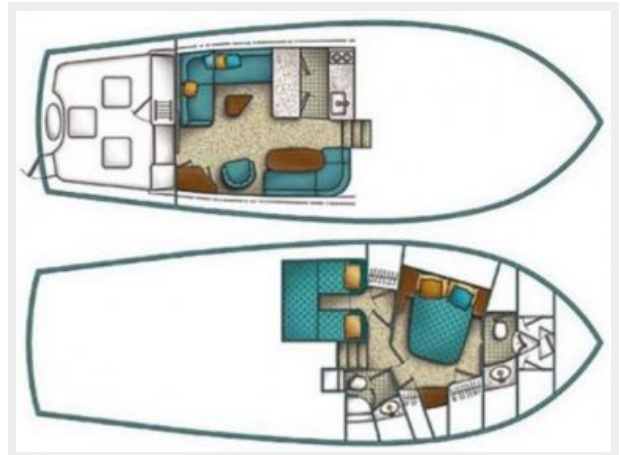





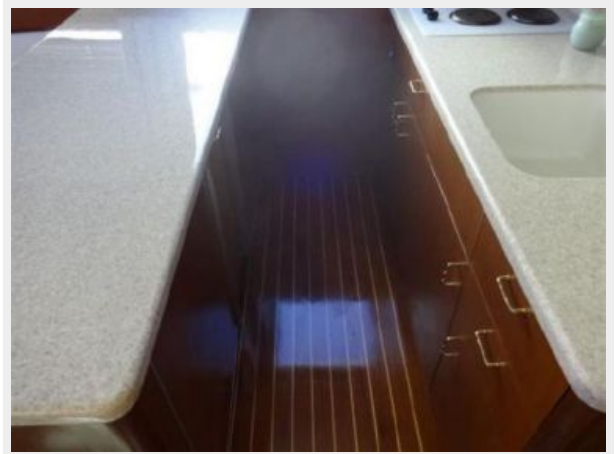



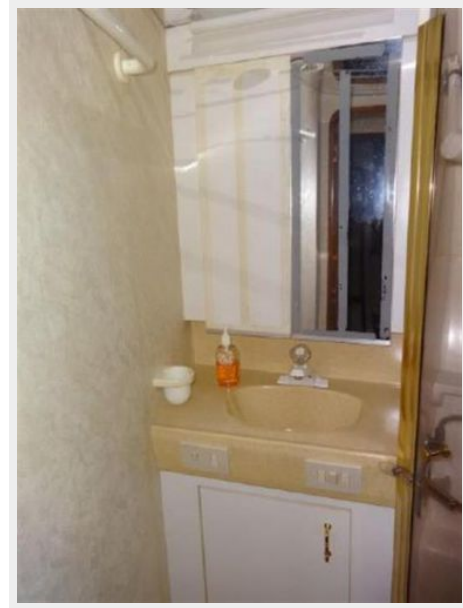



CONTACTS

Andrey Shestakov, leading yacht broker of the sales department of Shestakov Yacht Sales Inc. Shestakov Yacht Sales Inc., the official representative of the Miami/Fort Lauderdale FL headquarters.

Contact details

Email: andrey@shestakovyachtsales.com

Web: shestakovyachtsales.com/en/

Telephones

USA: +1(954)274-4435

Office hours

Monday – Saturday: **9:00 - 21:00** EDT

Sunday: **closed**

Address



Harbour Towne Marina, 850 NE 3rd St,
STE 213, Dania, FL 33004