

49FT 2008 HUNTER 49 THE ULTIMATE HUNTER — HUNTER



Builder: HUNTER

Year Built: 2008

Model: Cruising/Racing Sailboat

Price: PRICE ON APPLICATION

Location: United States

LOA: 49' 0" (14.94m)

Beam: 14' 9" (4.50m)

Max Draft: 5' 6" (1.68m)

Our experienced yacht broker, Andrey Shestakov, will help you choose and buy a yacht that best suits your needs 49ft 2008 Hunter 49 The Ultimate Hunter 49/50 — HUNTER from our catalogue. Presently, at Shestakov Yacht Sales Inc., we have a wide variety of yachts available on our sale's list. We also work in close contact with all the big yacht manufacturers from all over the world.

If you would like to buy a yacht 49ft 2008 Hunter 49 The Ultimate Hunter 49/50 — HUNTER or would like help answering any questions concerning purchasing, selling or chartering a yacht, please call +1(954)274-4435

TABLE OF CONTENTS

TABLE OF CONTENTS	2
SPECIFICATIONS	4
Basic Information	4
Dimensions	4
Speed, Capacities and Weight	4
Accommodations	4
Hull and Deck Information	4
Engine Information	5
DETAILED INFORMATION	6
Introduction	6
Broker's Comments	6
Accommodations	6
Factory Upgrades	7
Upgrades and Enhancements	7
Electronics	8
Hull & Deck	8
Sails & Rigging	8
General Safety Equipment	9
Manufacturer Provided Description	9
Exclusions	9
Disclaimer	9
PHOTOS	10
Hunter 49 Layout	10
Hunter 49 Galley	10
Hunter 49 Main Salon	10
Hunter 49 Ice Maker	10
Hunter 49 Dinette	10
Hunter 49 Main Salon	11

Hunter 49 Main Salon looking Aft	11
Hunter 49 Main Salon Multi Display TV	11
Hunter 49 Owner's Stateroom	11
Hunter 49 Navigation Station	11
Hunter 49 Main Salon Portside	11
Hunter 49 Port Guest Stateroom	12
Hunter 49 Port Guest Stateroom	12
Hunter 49 Starboard Guest Stateroom	12
Hunter 49 Port Helm	13
Hunter 49 Chartplotter	13
Hunter 49 Starboard Helm	13
CONTACTS	14
Contact details	14
Telephones	14
Office hours	14
Address	14

SPECIFICATIONS

Basic Information

Category: Cruising/Racing Sailboat

Sub Category: Cutter

Model Year: 2008

Year Built: 2008

Country: United States

Dimensions

LOA: 49' 0" (14.94m)

LWL: 43' 10" (13.36m)

Beam: 14' 9" (4.50m)

Max Draft: 5' 6" (1.68m)

MFG Length: 49' 11" (15.21m)

Speed, Capacities and Weight

Displacement: 32813 Pounds

Water Capacity: 200 Gallons

Holding Tank: 52 Gallons

Fuel Capacity: 150 Gallons

Accommodations

Total Berths: 6

Total Heads: 2

Hull and Deck Information

Hull Material: Fiberglass

Engine Information

Engines: 1

Manufacturer: Yanmar

Model: 47H4-HTE

Engine Type: Inboard

Fuel Type: Diesel

DETAILED INFORMATION

Introduction

Every once in awhile, an exceptional boat comes on the market that is heads and shoulder above the competition. Sweet Melissa is such a boat. Dozens of this popular aft cockpit Hunter 49 and 50 have been built, but none match the upgrades, enhancements and success of Sweet Melissa.

The knowledgeable owner is an industrial design engineer, an experienced sailor and previous Hunter owner. He lavishly prepared this Hunter 49 to be the ultimate in performance, comfort and convenience. Numerous ingenious enhancements were made to the mechanical, electrical and plumbing systems to improve the livability, reliability, durability and performance.

The Hunter 49 was awarded "Boat of the Year" Honors from Cruising World Magazine for her luxurious accommodations, great looks and advanced design.

Twice in the past two years, Sweet Melissa was honored as the fastest boat in the highly competitive St Petersburg to Isla Mujeres, Mexico race.

If you are seeking a comfortable, easy to handle, easy to maintain and dependable boat that will be exhilarating to sail, I invite you to seriously consider this Hunter 49.

Broker's Comments

After sailing Sweet Melissa nearly 500 miles from Florida to Mexico, I was both surprised and impressed. I was surprised how fast she sailed in light winds. Certainly any boat will move quickly with strong enough winds and Sweet Melissa did sustained long periods of 10+ knots with just the main, staysail and jib. However, when the wind was from 5 to 10 knots, she would do half the wind speed, which is amazing for such a large boat.

When the storm hit and the waves were over 20 feet, Sweet Melissa sliced through the waves cleanly and quickly without pounding. I was impressed that there wasn't any creaking inside the boat as she worked her way through rough sea and how comfortable I was down below when I was off watch. Even in challenging conditions, Sweet Melissa is set up to be an easy boat to sail. Whereas a 49' boat racing to Mexico would carry a crew of 6 to 10. We did the trip comfortably with only 4 people.

In 40 years, Hunter has come a long way from being an inexpensive boat entry level boat, to one of the better yacht builder in the world. Melissa is a great boat, owned by a great owner and is in great condition. She's is ready to go on her next great adventure.

Accommodations

FORWARD CABIN Cabin Lighting, Electrical Outlets, AC/DC Hanging Lockers, (2) Cedar Lined Hatches, Deck Opening w/Screens Head, Private w/Vanity, Corian Countertop & Opening Hatch Mattress, Innerspring Shower Stall Compartment w/Pump Smoke & Carbon Monoxide Detectors Storage Cabinet, Drawers, Shelving Vanity, Ensuite w/Corian Countertops **MAIN HEAD (AFT)** Access Door, Dual Electrical Outlets, AC and DC Hatch, (1) Deck, Ports (3) Opening Shower Stall w/Adj. Shower Head, Seat and Sump Pump Storage Compartments Vanity w/Corian Countertop **NAVIGATION STATON** 12 Volt Switching System Chair Custom Swiveling Chart Table, w/Adjustable Light Electrical Outlets, AC/DC w/Jack Space for Electronics Storage Cabinets, Plotting Gear **MAIN SALON** Accord Shades Cabin Lighting, Courtesy Floor Lighting Deck Side Windows, Fixed w/Shades Deck Windshield Ports, Fixed Deluxe Cushion/Fabric Package Dinette Table Convertible to Berth Dorade Vents (2) Electrical Outlets AC & DC Everwear Gloss Laminate Sole Cherry Finish Laminate Handrails, Hardwood Both Sides Hatches (2) Deck, Opening w/Screens Leaf, Removable for Dinette Table Ports, (2) Hull, Fixed Selected Hardwood Trim Shade Package, Supreme Smoke & Carbon Monoxide Detectors Storage Lockers & Shelving **GUEST CABINS** Berth, dbl. or Queen w/Innerspring Mattress & Bedding Package Cabin Lighting Electrical Outlets, AC & DC Hanging Locker (1) Cedar Lined Hanging Wet Locker, Port Side Headboard Padded, Lounge Chair Ports/Hatches Opening w/Screens Private Entrance to Head Storage Cabinet Storage Drawers/Bins **GALLEY** Corian Countertops w/Backsplash Hatch (1) Deck, Opening Dish Setting Pkg. w/Lighted Self-Draining Storage Cabinet Electrical Outlet, AC Faucet Chrome Pull Out Dual Function Freezer, Top Opening Fresh Water System, Hot & Cold Ice Maker Microwave/Coffeemaker Combo Ports (2) Opening w/Screens Range Hood w/Light & Fan Refrigerator, Front Opening SS Sinks, Dbl. SS w/Cutting Board Storage Cabinets/Drawers/Shelving Stove, 3 Burner LPG Gimballed w/Oven Waste Bin, Built In

Factory Upgrades

Furling Mast w/Vertical Battens, Inverter w/Link 1000, Electric Winch Upgrade, Quiet Flush Heads Cockpit Stereo Fridge & Freezer Oceanair Shades Memory Foam Mattress Raymarine ST60 Tridata Repeater Raymarine St 60 Wind Air Conditioning System (UPGRADED) Bow Thruster 6 hp Electric Winch Upgrade Port Helm Station Winch #54 Raymarine 7001+Autopilot Smart Controller Wireless Remote TV Antenna Package Ultra-Leather Interior Cushions

Upgrades and Enhancements

- Re-engineered electrical system for better reliability and capacity
- Re-engineered and strengthened anchor platform with Spinnaker attachment
- Re - engineered Fuel system to included constant polishing system
- Re-engineered Waste system to reduce holding tank odor
- Re-engineered Air conditioning system to have condensate drain into grey water tank used for flushing heads.
- Relocated House Battery Banks lower in the boat for greater stability.

- Re-engineered electrical system to provide more reliable recharging of House Battery Banks
- Engineered a fresh water flush system for Engine and Generator
- Upgraded sea water strainers for engine and generator
- Navigation System interfaced with Entertainment System - Can watch TV/Movies and see chart plotter on any of 5 TVs
- Satellite TV
- Locomotive Horn on mast with separate compressor
- Performance Main, Staysail and Genoa
- Re-designed cockpit cushions with back bolsters

Electronics

The Best integration of TV's with other systems we've seen. TV's in all three Staterooms have DVD players and all TV's have multi function displays that Interface with Navigation, Satellite antenna, Sat radio and sonar. Convenient to watch a movie while viewing chartplotter and radar

Garmin GPSmap 4212 Cockpit Chartplotter
 Garmin GPS 5208 Nav Station Chartplotter (2)
 Raymarine ST70 Multifunction Color Displays (2)
 Raymarine Depth Speed Repeater
 Satellite TV Antenna 2
 Raymarine Depth Speed
 Raymarine Speed
 Raymarine Depth 1
 Raymarine Wind Machine 1
 Digital Engine gauge
 Raymarine Auto pilot
 Wireless Auto pilot Control
 Weather Sat
 Sat radio Interfaced
 Sat TV and DVD system
 Sony stereo system with 4 speakers
 Interfaced with Sat TV and Sat Radio system
 Fish finder transducer
 36 Mile Radar
 Cell Phone repeater system

Hull & Deck

Anchor Roller, Dbl. Offset Anchor Well w/Space for Rode/Chain Anchor Windlass, Electric Stainless Steel Bow Pulpit Reinforced Cockpit Arch, SS w/Mainsheet Traveler Dorade Vents (2) Fresh Water Hook-up, Dockside Hatches, Opening Deck w/Screens HKT Kevlar Hull Reinforcement Hull, FRP/Balsa Sandwich Above Waterline, Solid FRP Bottom Hull, Structural Grid Reinforcement Lifelines, Dbl. w/3 Gates & Stanchions Lockers, (2) Transom Storage LPG Tank Storage for (2) Bottles Maxguard Gelcoats for UV Protection Mooring Cleats, (8) Stainless Steel Non-skid Deck, Ports, (2) Fixed Ports (10) Opening w/Screens Rubrail, w/SS Insert Rudder, Balanced Spade w/SS Shaft Sail Locker, Fwd w/Watertight Bulkhead Swim Platform w/SS Telescoping Ladder Through Bolted Hull to Deck Joint w/Rubrail, Fittings Windshield Fixed Ports, w/Cover Extended side curtail for Bimini Cockpit Cushions with Seat Backs

Sails & Rigging

Owner ordered this Hunter 49 with a cutter rig for better performance. Selden In Mast Main Furling System Self Tacking StaySail Furling System Boom Vang Internal Halyards Led to Cockpit Jib Furling System, Spinnaker and gear Traveler, Arch Mounted for Mainsheet Winch Handles, Winches (2) Rigging 2-Speed Electric Self Tailing Winches Winch (1) at Port Helm, 2-

Speed Electric Self-Tailing Winch on Cabin Top Windex® Wind Indicator Anchor Platform re-engineered and strengthen to old tack for Spinnaker

General Safety Equipment

Air Horn & Fog Bell Anchor & Line Carbon Monoxide & Smoke Detectors Emergency Tiller Fire Extinguishers Handheld & System GFI Receptacles Hand-Held Flares, Life Jackets High Bilge Water Alarm & Pump NMMA Certification on All Systems Reference Book, Chapmans Piloting Throwable Floation Cushion

Manufacturer Provided Description

A luxurious passagemaker with a versatile floor plan for total extended offshore cruising, the Hunter 49 offers a complete range of live aboard accommodations and outstanding entertainment features. With an overall length of 49 feet 11 inches , plus a 14 feet 5 inch beam and 6 feet 9 inches of salon headroom, the Hunter 49 is a BIG boat with impressive interior volume.

Driving the Hunter 49's new hull is a specially engineered sail plan that achieves maximum efficiency while maintaining the Hunter trademark of single-handed sail-ability, which is a great feature for a boat of this size. Components aboard the Hunter 49 include Hunter's famous mainsheet traveler arch, backstayless B & R rig, a battened full roach main sail, and two headsail options: single self-tacking jib or self-tacking staysail with overlapping jib. A dual-ended mainsheet allows adjustments from both the cockpit and companionway, and all sheets and halyards end at the cockpit.

Exclusions

Owner's personal belongings.

Disclaimer

The Company offers the details of this vessel or yacht in good faith but cannot guarantee or warrant the accuracy of this information nor warrant the condition of the vessel. A buyer should instruct his representatives, agents, or his surveyors, to investigate such details as the buyer desires validated. This vessel or yacht is offered subject to prior sale, price change, or withdrawal without notice.

PHOTOS

Hunter 49 Layout

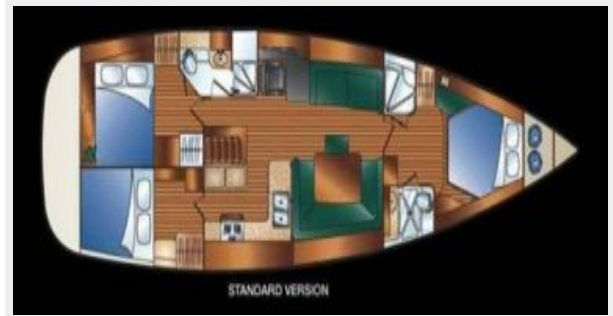

Hunter 49 Main Salon



Hunter 49 Galley



Hunter 49 Ice Maker



Hunter 49 Dinette



Hunter 49 Main Salon looking Aft



Hunter 49 Main Salon



Hunter 49 Main Salon Multi Display TV



Hunter 49 Owner's Stateroom



Hunter 49 Main Salon Portside



Hunter 49 Navigation Station



Hunter 49 Port Guest Stateroom



Hunter 49 Port Guest Stateroom



Hunter 49 Starboard Guest Stateroom



Hunter 49 Port Helm



Hunter 49 Chartplotter



Hunter 49 Starboard Helm



CONTACTS

Andrey Shestakov, leading yacht broker of the sales department of Shestakov Yacht Sales Inc. Shestakov Yacht Sales Inc., the official representative of the Miami/Fort Lauderdale FL headquarters.

Contact details

Email: andrey@shestakovyachtsales.com

Web: shestakovyachtsales.com/en/

Telephones

USA: +1(954)274-4435

Office hours

Monday – Saturday: **9:00 - 21:00** EDT

Sunday: **closed**

Address



Harbour Towne Marina, 850 NE 3rd St,
STE 213, Dania, FL 33004