

ALESSANDRA — JEFFERSON



Builder: JEFFERSON

LOA: 37' 0" (11.28m)

Year Built: 1989

Beam: 14' 5" (4.39m)

Model: Cruiser

Min Draft: 3' 4" (1.02m)

Price: PRICE ON APPLICATION

Location: United States

Our experienced yacht broker, Andrey Shestakov, will help you choose and buy a yacht that best suits your needs **ALESSANDRA — JEFFERSON** from our catalogue. Presently, at Shestakov Yacht Sales Inc., we have a wide variety of yachts available on our sale's list. We also work in close contact with all the big yacht manufacturers from all over the world.

If you would like to buy a yacht **ALESSANDRA — JEFFERSON** or would like help answering any questions concerning purchasing, selling or chartering a yacht, please call **+1(954)274-4435**

TABLE OF CONTENTS

TABLE OF CONTENTS	2
SPECIFICATIONS	5
Overview	5
Basic Information	5
Dimensions	5
Speed, Capacities and Weight	5
Accommodations	5
Hull and Deck Information	6
Engine Information	6
DETAILED INFORMATION	7
Manufacturer Provided Description	7
Vessel Walkthrough & Accommodations	7
Galley	7
Deck and Hull Equipment	8
Electrical Equipment	8
Navigation & Electronics Equipment	8
Mechanical	9
Exclusions	9
Disclaimer	9
PHOTOS	10
Enclosed Aft Deck - Entrance to Salon	10
Salon Forward	10
Salon to Port	10
Salon to Starboard	10
Lower Helm	10
Open Dinette and Galley	10
Galley to Port	11
Refrigerator	11

Galley Maid 3 Burner Stove	11
Guest Stateroom	11
Guest/Day Head to Port	12
Guest Shower to Starboard	12
Convertible Dinette to Starboard	12
Electrical Panel	12
Entrance to Master Stateroom	13
Salon Aft - Steps to Sundeck	13
Master Stateroom	13
MSR to Starboard	13
Master Ensuite Head	14
MSR to Port	14
Master Shower	14
Floor Plan	14
Enclosed Sundeck	15
Entertainment Center	15
Fully Enclosed Flybridge	15
Flybridge Helm	15
Flybridge Seating to Starboard	15
Flybridge Seating to Port	15
Dinghy Stored on Aft Deck	16
Flybridge Bow View	16
Cabin and Flybridge View Aft	16
Ground Tackle	16
Starboard Side Deck Aft	17
Port Side Deck Aft	17
Engine Room	17
Cummins Onan Genset (New 2012)	17
New Bottom Paint 2014	17

Starboard Bow	17
Running Gear	18
Passerelle for Safe Boarding	18
Throw the Lines and Go!	18
CONTACTS	19
Contact details	19
Telephones	19
Office hours	19
Address	19

SPECIFICATIONS

Overview

A great vessel to live aboard, cruise the Great Loop, or explore the Bahamas! Easy to see just 45 minutes north of the West Palm Beach airport.

Basic Information

Category: Cruiser

Sub Category: Double Cabin

Model Year: 1989

Year Built: 1989

Country: United States

Vessel Top: 2369

Fly Bridge: Yes

Cockpit: Yes

Dimensions

LOA: 37' 0" (11.28m)

Beam: 14' 5" (4.39m)

Min Draft: 3' 4" (1.02m)

Speed, Capacities and Weight

Displacement: 2700 Pounds

Water Capacity: 120 Gallons

Holding Tank: 35 Gallons

Fuel Capacity: 350 Gallons

Accommodations

Total Cabins: 2

Total Berths: 2

Sleeps: 4

Total Heads: 2

Hull and Deck Information

Hull Material: Fiberglass

Engine Information

Engines: 2

Manufacturer: Cummins

Model: 6BTA5.9

Engine Type: Inboard

Fuel Type: Diesel

DETAILED INFORMATION

Manufacturer Provided Description

Imported by Jefferson in the late 1980's, the 37 Sundeck combined a traditional teak interior with solid construction and contemporary styling. In most respects, the 37 is typical of most Taiwan yachts of her era. Construction is solid fiberglass, and her low deadrise semi-planing, solid fiberglass hull incorporates a (2) stateroom, galley down floor plan with a beautiful teak interior, a tub/shower in the aft head and a standard lower helm station. Wrap around salon windows provide plenty of outside natural lighting. One of the more attractive features of the Jefferson 37 is her spacious, full-width aft deck. The flybridge is arranged with the helm mid-bridge and guest seating forward. A bow pulpit, radar arch and swim platform were standard.

The 250hp Cummins diesels will cruise the Jefferson 37 Sundeck at a modest 15-16 knots and deliver a top speed of just under 20 knots.

Vessel Walkthrough & Accommodations

ALESSANDRA has the popular (2) stateroom layout. The Master Stateroom has a centerline marine queen berth, full head with large separate shower, lots of drawer & closet space. All wood is teak throughout. Salon has lower helm station to starboard. To port is the TV and storage for the entertainment system. There is a comfortable sofa & chair. The galley is (3) steps down, with full galley to port. with a convertible dinette that seats (6) to starboard. The Guest Stateroom forward has offset Queen to starboard with drawers and hanging lockers. The head is to port and a full shower to starboard. Aft deck has hardtop, full wet bar with Uline ice maker and sink. Large flybridge has seating for (6).

- Aft Master Stateroom with island queen berth
- Master ensuite Jabsco electric headwith separate shower
- VIP Guest Stateroom forward with offset queen berth
- Forward Jabsco electric headand separate shower
- Convertible Dinette seats (6), sleeps (2)
- Carpeting
- Drapes
- Sofa and chair
- Alpine stereo with CD changer
- Samsung DVD player
- Aft Deck Entertainment Center with Uline ice maker and sink

Galley

- Dometic refrigerator/freezer
- Stainless hot water heater.
- Galley Maid "Countess" 3-burner stove top
- Sharp Carousel II microwave
- Large round stainless steel sink
- Black & Decker toaster oven
- Lots of drawers and storage space
- 10 gallon hot water tank

Deck and Hull Equipment

Full Flybridge enclosure. Chain and rope Windlass. Full aft enclosure. Full lower station. All portholes replaced in 2003. Bottom painted 2014.

- 11' Achilles inflatable keel with a 9.9 HP Mercury
- CQR Anchor with 15' 3/8" chain and 200' rode
- Electric windlass
- Bow pulpit and rails
- Fiberglass deck (no teak deck to maintain!)
- Fenders and lines
- Navigation lights
- Single electric remote control search light (remote rotating is not working)
- Covers and canvas
- Coast Guard approved safety package
- 4 cushioned chairs on aft deck

Electrical Equipment

- Cummins Onan 8 kW Generator (NEW 2012 - Less than 300 hours)
- Minikota battery charger
- (4) Marino 30 amp dockside electrical cables
- 12V Mastervolt AGM 160 amp/hrt; (2) 8D (2013) House/Engine and (1) 4D (2014) starting battery for genset

Navigation & Electronics Equipment

- Robertson AP1-1 autopilot
- (2) Gemini 6" compass
- Data Marine Dart Depth Sounder
- Jensen MCC8320 Stereo
- Icom M56 and Standard Horizon Intrepid VHF
- Furuno 173 MK3 Radar
- Furuno GP-31 GPS

Mechanical

- Aqua Air reverse cycle air conditioning
- (2) bilge blowers
- (4) automatic bilge pumps
- Bridge controls
- Engine alarm
- Fuel shut-off valve
- X-Changer Lube oil storage & transfer system
- (2) Algae-X fuel cleaners
- (2) extra propellers
- Hydraulic steering
- Glendinning Synchronizers
- Trim Tabs

Exclusions

Owner's personal belongings.

Disclaimer

The Company offers the details of this vessel or yacht in good faith but cannot guarantee or warrant the accuracy of this information nor warrant the condition of the vessel. A buyer should instruct his representatives, agents, or his surveyors, to investigate such details as the buyer desires validated. This vessel or yacht is offered subject to prior sale, price change, or withdrawal without notice.

PHOTOS

Enclosed Aft Deck - Entrance to Salon



Salon Forward



Salon to Port



Salon to Starboard



Lower Helm



Open Dinette and Galley



Galley to Port



Refrigerator



Galley Maid 3 Burner Stove



Guest Stateroom



Guest/Day Head to Port



Guest Shower to Starboard



Convertible Dinette to Starboard



Electrical Panel



Entrance to Master Stateroom

Salon Aft - Steps to Sundeck



Master Stateroom



MSR to Starboard



MSR to Port



Master Ensuite Head



Master Shower



Floor Plan

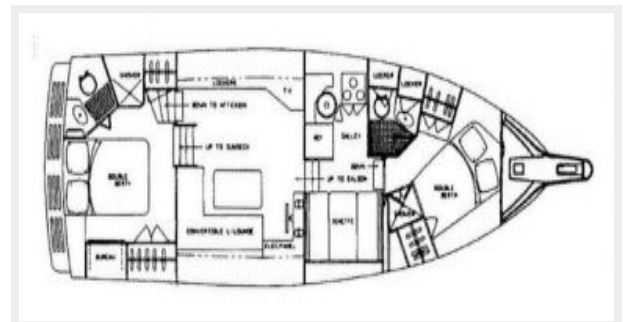

Enclosed Sundeck



Entertainment Center



Fully Enclosed Flybridge



Flybridge Helm



Flybridge Seating to Starboard



Flybridge Seating to Port



Dinghy Stored on Aft Deck



Flybridge Bow View

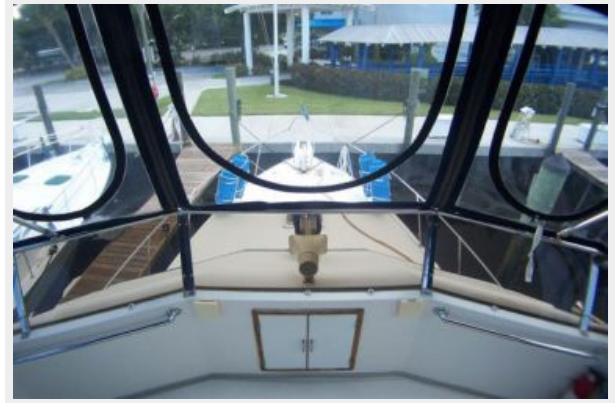

Cabin and Flybridge View Aft

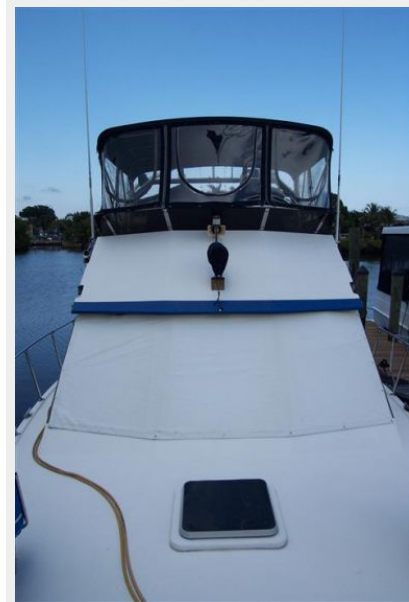

Ground Tackle

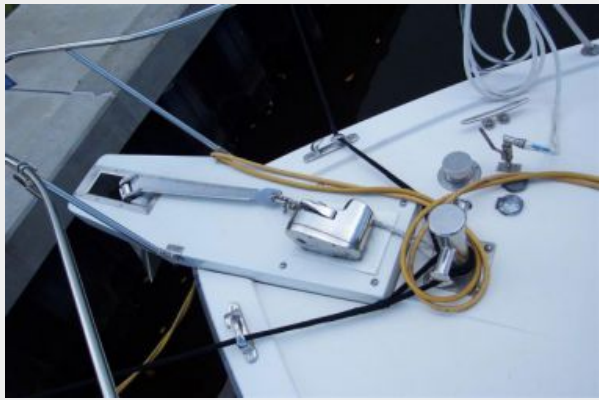

Starboard Side Deck Aft



Port Side Deck Aft

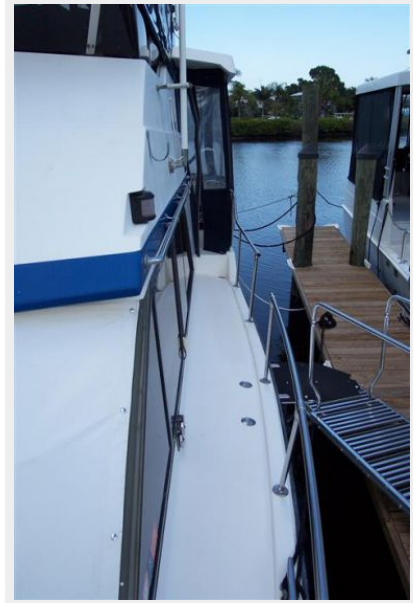

Engine Room



Cummins Onan Genset (New 2012)



New Bottom Paint 2014



Starboard Bow



Running Gear



Passerelle for Safe Boarding



Throw the Lines and Go!



CONTACTS

Andrey Shestakov, leading yacht broker of the sales department of Shestakov Yacht Sales Inc. Shestakov Yacht Sales Inc., the official representative of the Miami/Fort Lauderdale FL headquarters.

Contact details

Email: **andrey@shestakovyachtsales.com**

Web: shestakovyachtsales.com/en/

Telephones

USA: +1(954)274-4435

Office hours

Monday – Saturday: **9:00 - 21:00** EDT

Sunday: **closed**

Address



Harbour Towne Marina, 850 NE 3rd St,
STE 213, Dania, FL 33004