

SHANGRI-LA — HERITAGE EAST

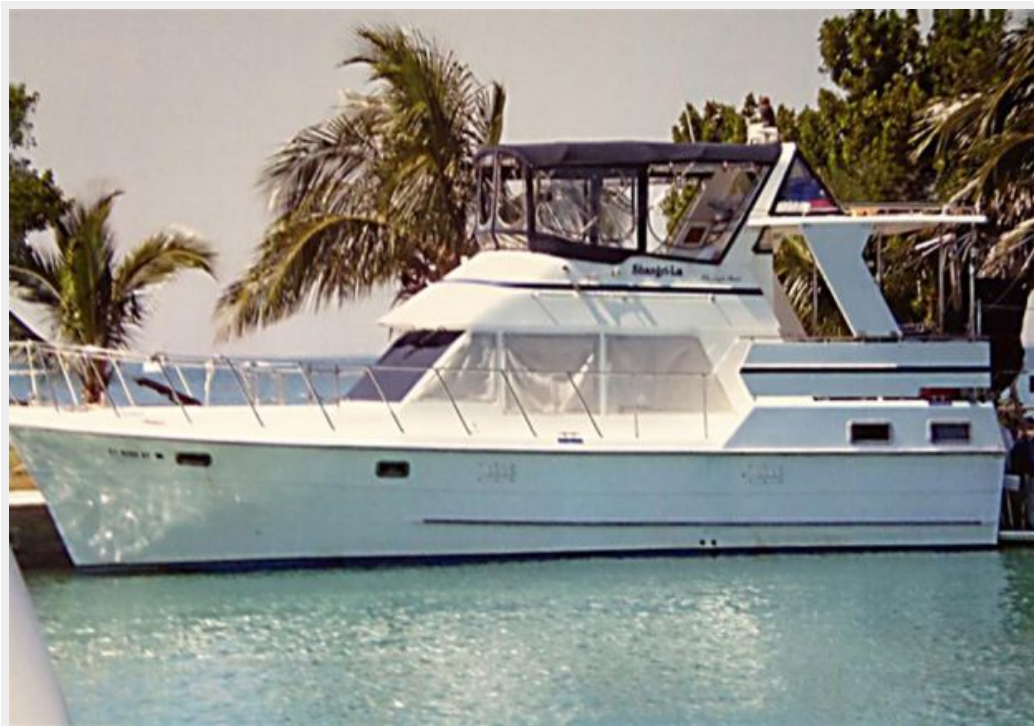

Судостроитель: HERITAGE EAST

Год постройки: 1998

Модель: Крейсер

Цена: ЦЕНА ЯХТЫ ПО ЗАПРОСУ

Местонахождение: United States

Длина общая: 36' 0" (10.97m)

Ширина: 12' 7" (3.84m)

Мин. осадка: 4' 6" (1.37m)

Купить **SHANGRI-LA — HERITAGE EAST** а также выбрать подходящую вам яхту из нашего каталога яхт вам поможет опытный яхтенный брокер Андрей Шестаков. На сегодняшний день компания Shestakov Yacht Sales Inc. имеет большое количество яхт в собственном списке продаж, а также тесно сотрудничает со всеми крупными яхтенными производителями по всему миру.

Для того чтобы купить яхту **SHANGRI-LA — HERITAGE EAST** а также проконсультироваться по любому вопросу связанному с покупкой, продажей, чартером яхт позвоните по телефону **+7(918)465-66-44**.

ОГЛАВЛЕНИЕ

ОГЛАВЛЕНИЕ	2
ХАРАКТЕРИСТИКИ	5
Обзор	5
Основная информация	5
Размеры	5
Скорость, вместимость и масса	5
Размещение	5
Корпус и палуба	6
Информация о двигателе	6
ПОДРОБНОЕ ОПИСАНИЕ	7
Introduction	7
Vessel Walkthrough & Accommodations	7
Salon	8
Galley	8
Sundeck	8
Flybridge	9
Mechanical	9
Electrical Equipment	10
Deck and Hull Equipment	10
Transom	11
Исключения	11
Отказ от ответственности	11
ФОТОГРАФИИ	12
Entrance from Sundeck to Salon	12
Beautiful Master Stateroom	12
MSR to Port	12
MSR to Starboard	12
Ensuite Head	13

Splendied Washer/Dryer	13
Salon Forward	13
Salon to Starboard	13
Lower Helm	14
Helm Gauges	14
Steps to Open Galley	14
Galley to Port	14
Three Burner Princess Propane Stove/Oven	15
Double SS Sinks	15
FLoward Head Convenient to Salon	15
Guest/Day Head	15
Entrance to Guest Stateroom	16
Guest Stateroom Forwad	16
Guest Stateroom to Port	16
Salon to Starboard	16
Salon Aft	16
Electrical Penal	16
Sundeck Entrace to Salon	17
Floor Plan	17
Covered Outdoor Living Space	17
Sundeck to Starboard	17
Wet Bar for Entertaining - Molded Steps to Flybridge	17
Flybridge Forward	17
Flybridge Instruments	18
JRC Radar/Ratheon Autopilot and Depth	18
Standard Horizon VHF	18
Flybridge Aft	18
Foredeck View from Flybridge	18
Fender Holders on Bow	18

Port Side Deck Aft	19
Anchor Pulpit	19
Cabin and Flybridge View Aft	19
Starboard Side Deck Aft	19
Easy Access to Fuel Tanks	20
Engine Access	20
Clean Engine Room	20
Kohler Genset	20
Cummins 6BT5.9-M	20
Custom Dinghy Davits	20
Stern View	21
Steps to Swim Platform	21
КОНТАКТЫ	22
Контактная информация	22
Телефоны	22
Время работы	22
Адрес	22

ХАРАКТЕРИСТИКИ

Обзор

The Heritage East has big boat comfort with small boat economy. Walking into the salon, you will appreciate the beautiful teak interior. Guest Stateroom and head is forward for privacy and a comfortable master stateroom aft with island queen berth and ensuite head. The aft deck with hard top is a great space for outdoor living and entertaining.

Easy to see - just 45 minutes north of the West Palm Beach airport.

Основная информация

Тип судна: Крейсер	Подкатегория: Double Cabin
Модельный год: 1998	Год постройки: 1998
Страна: United States	Верх: 2369
Открытая палуба мостика: Да	Кубрик: Да

Размеры

Длина общая: 36' 0" (10.97m)	Ширина: 12' 7" (3.84m)
Мин. осадка: 4' 6" (1.37m)	

Скорость, вместимость и масса

Водоизмещение: 23000 Pounds	Вместимость воды: 170 Gallons
Вместимость сточного бака: 30 Gallons	Объем топливного бака: 335 Gallons

Размещение

Всего кают: 2	Всего коек: 2
Спальные места: 4	Всего ком. состава: 2

Корпус и палуба

Материал корпуса: Fiberglass

Комплектация корпуса: Semi-Displacement

Информация о двигателе

Двигатели: 1

Производитель: Cummins

Модель: 6BT5.9-M

Тип двигателя: Inboard

Тип топлива: Diesel

ПОДРОБНОЕ ОПИСАНИЕ

Introduction

The Heritage East 36 Sundeck is an updated version of the popular Nova 36 Sundeck, one of the better-selling Taiwan imports of her type during the mid to late-1980's. Now produced in mainland China, she's built on a solid fiberglass semi-displacement hull with moderate beam, hard chines and a full-length, prop-protecting keel. The two-stateroom floor plan of the Heritage is arranged with queen berth in Master and an off-set double berth forward, and the lavish application of interior teak cabinetry and woodwork is one of her most appealing features. Storage is plentiful, and there is a sliding deck access door at the lower helm. Note that the overhead grab rails in the salon are a welcome convenience.

Bow to stern quality of materials is the most remarkable feature of the Heritage East. Generations of woodworking skills are demonstrated by ornate detailing of exotic hard-woods and highly varnished teak and holly sole. Storage efficiency is incomparable with ample drawer, cubby, hanging locker and equipment storage space that has been engineered to take advantage of every opportunity.

Outside, a panoramic view awaits you. A full-width sundeck with fiberglass hardtop has room for entertaining and features a full wet bar with sink, storage cabinets and icemaker. A unique stairway leads to a full-width fiberglass swim platform. Wide side decks feature an aggressive non-skid pattern for safe maneuverability in all conditions.

Molded stairs provide easy access to the flybridge from the sundeck. There is a center line adjustable helm chair and ample seating for the first mate and guests with bench seating and a nice teak table. Additional features include a tilting radar arch, wide side decks, a spacious engine room and a bow pulpit. A comfortable ride, a single 220-hp Cummins will cruise the Heritage 36 efficiently at 8 knots.

Vessel Walkthrough & Accommodations

The Heritage East is exceptionally livable. The master stateroom, with a private head and separate shower compartment easily accommodates a full-size walk-around queen berth. Wardrobe locker offers ample storage. A washer/dryer is installed. Five functional portholes and large transom hatch offer comfortable ventilation and full vista views.

- Center island queen berth
- Dual night stands
- Hanging locker
- Drawer storage
- Screened opening ports
- Screened opening hatch

Guests will appreciate their own forward private stateroom with an offset double berth, settee and adjacent head and shower.

Salon

- Large foldable table with (4) chairs stored inside. Large enough to seat 6 or would make a great desk.
- Vizio 19" HDTV
- Lower helm station
- Teak and holly sole
- Lots of cabinet storage
- (2) lounge chairs with ottoman
- (2) opening windows: (1) each on port and starboard
- (2) overhead teak handholds
- Opening door to deck at starboard helm station

Galley

The U-shaped galley is to port.

- Condo Size Norcold AC/DC refrigerator w/freezer
- (3) burner Princess propane stove and ovenw/propane solenoid control
- Sunbeam microwave oven
- Pressure fresh water system
- (2) Water gauges
- (1) Holding Tank gauge
- Filtered drinking water faucet
- Electric hot water heater w/engine heat exchanger
- Teak storage cupboards and drawers
- Dual stainless deep sinks
- Laminated counter surfaces

Sundeck

- Ice Maker (110v outlet not working)
- Wet bar with (4) storage cabinets
- Molded stairs to flybridge
- Molded stairs down to swim platform
- Hinged door to passageway down to salon
- SS railings and stanchions with fiberglass weather boards
- Deck/dock box
- (4) 12v overhead lighting
- Fiberglass hard top

- SS chocks and cleats
- (1) Life ring throwable
- (1) 12v outlet
 - Ice Maker (1 110v outlet not working)
 - Wet bar with (4) storage cabinets
 - Molded stairs to flybridge
 - Molded stairs down to swim platform
 - Hinged door to passageway down to salon
 - SS railings and stanchions with fiberglass weather boards
 - Deck/dock box
 - (4) 12v overhead lighting
 - Fiberglass hard top
 - SS chocks and cleats
 - (1) Life ring throwable
 - (1) 12v outlet

Flybridge

She has a bimini top with full enclosure on the bridge. The helm is equipped with a center line adjustable helm chair and ample seating for the first mate and guests.

- Cushioned port & starboard bench seating w/storage
- Adjustable height teak table
- SS frame bimini top w/full enclosure
- Raytheon Autopilot, Depth
- Standard Horizon VHF radio
- JRC Radar 1000
- Hydraulic wheel steering
- 12v plug
- Todd helm seat
- Hinged fiberglass radar arch
- Ritchie compass
- (1) 110v duplex outlet

Mechanical

Engine room access is through two large floor hatches or hinged galley steps. Full sound insulation and diamond plate flooring provide 360 degree inspection and easy access to single engine propulsion and auxiliary components.

- Single 220hp Cummins 6BT5.9-M Diesel - Fresh water cooled with full maintenance records
- Spare parts
- Engine room sound insulation
- Waste tank level gauge
- Dual Racor 900 fuel filters w/vacuum gauge
- Fiberglass muffler

- (2) Mermaid marine air conditioners w/digital controls-- 15,000BTUHeat/AC Salon & MSR; 12,000BTU AC onlyV-Berth & Galley
- Marine Hardware bow thruster
- Morse engine controls
- Fresh water cooling systems
- Raw water sea strainers
- Holding tank w/deck & macerator discharge
- (2) electric bilge pumps
- Shower sump pump
- Dripless stuffing box
- Water tank level gauges

Electrical Equipment

- 110v AC electrical system
- 12v DC electrical system
- Electrical bonding system
- Kohler 8 KW generator
- Prostat 1800 watt inverter
- 120 amp custom alternator w/external regulator (new December 2005)
- Dual zinc savers
- Xantrex 40 amp "Smart" (3) bank battery charger w/remote display (new May 2005)
- (8) Wet cell Trojan golf cart batteries in (2) banks = 900 amp hours
- Generator starting battery
- (2) 30 amp dockside electrical cables w/splitters

Deck and Hull Equipment

Designed for minimal upkeep, the exterior features stainless steel handrails (no teak!). The hand laid fiberglass hull incorporates the highest quality laminates, resins and gelcoats with an epoxy coated bottom to resist blistering. Full keel stability, a fully protected prop and standard bow thruster ensure safe travel.

- Bow Thruster w/dual controls for upper & lower stations
- (6) 12" SS cleats (foredeck, midship, sundeck)
- (4) SS chocks (foredeck, sundeck)
- SS railings and stanchions all the way around outside deck
- Port and starboard midship opening gates
- (6) SS fender holders
- Foredeck high-powered raw water wash down
- Foredeck pressurized fresh water
- Lewmar (highest quality) chain (stbd) and rode (port) windlass
- (1) SS Sampson post
- (1) 45 lb CQR (port roller) with chain and rode

- (1) 20 kg Bruce (stbd roller) all chain
- Fiberglass molded anti-skid pattern on all deck walking surfaces
- No external teak to up keep!
- Top of fuel tanks in EXCELLENT viewable condition around the filler

Transom

- Hinged custom-made dinghy davit powered by electric motor
- (3) Davit arms (3 to 1 ratio) to deliver bikes, motor-scooter, small motorcycle, etc. into receiving rack located above dinghy rack

Исключения

При продаже яхты исключаются личные вещи владельца.

Отказ от ответственности

Компания предоставляет описание судна или яхты добросовестно, но не может гарантировать точность этой информации, а также не ручается за техническое состояние. Покупатель должен проинструктировать своих агентов или оценщиков исследовать представленную информацию более подробно, по собственному желанию. Продажа судна или яхты, изменение цены или снятие с продажи будет происходить без предварительного уведомления.

ФОТОГРАФИИ

Entrance from Sundeck to Salon



Beautiful Master Stateroom



MSR to Port



MSR to Starboard



Ensuite Head



Splendied Washer/Dryer



Salon Forward



Salon to Starboard



Lower Helm



Helm Gauges



Steps to Open Galley



Galley to Port



Three Burner Princess Propane Stove/Oven

Double SS Sinks



FLorward Head Convenient to Salon



Guest/Day Head



Entrance to Guest Stateroom



Guest Stateroom Forward



Guest Stateroom to Port



Salon to Starboard



Salon Aft



Electrical Penal



Floor Plan

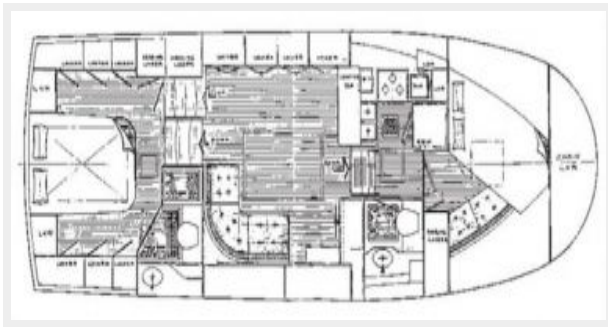

Sundeck Entrance to Salon



Covered Outdoor Living Space



Sundeck to Starboard



Wet Bar for Entertaining - Molded Steps to Flybridge



Flybridge Forward



Flybridge Instruments



JRC Radar/Ratheon Autopilot and Depth



Standard Horizon VHF



Flybridge Aft



Foredeck View from Flybridge

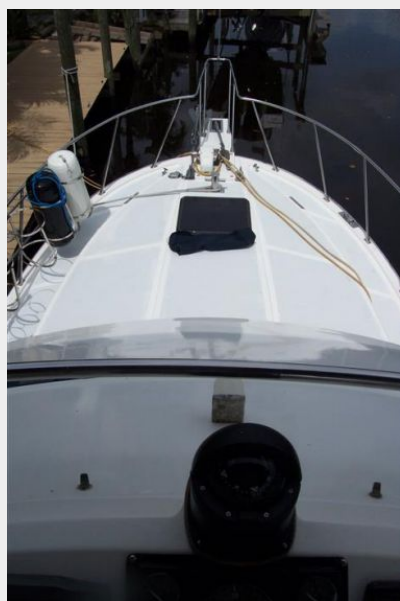

Fender Holders on Bow



Anchor Pulpit



Port Side Deck Aft



Cabin and Flybridge View Aft



Starboard Side Deck Aft



Easy Access to Fuel Tanks



Engine Access



Clean Engine Room



Kohler Genset



Cummins 6BT5.9-M



Custom Dinghy Davits



Steps to Swim Platform



Stern View



КОНТАКТЫ

Андрей Шестаков (Andrey Shestakov) – ведущий яхтенный брокер отдела продаж яхт и судов компании Shestakov Yacht Sales Inc. Официальный представитель Shestakov Yacht Sales Inc. для русскоговорящих клиентов в центральном офисе компании в Майами/Форт Лодердейл/Флорида/США.

Контактная информация

Email: andrey@shestakovyachtsales.com

Web: shestakovyachtsales.com

Телефоны

Краснодарский край: **+7(918)465-66-44**

США, Майами, Флорида: **+1(954)274-4435**

Время работы

Понедельник – Суббота: **9:00 - 21:00**
EDT

Воскресенье: **Закрито**

Адрес



Harbour Towne Marina, 850 NE 3rd St,
STE 213, Dania, FL 33004