

# ALBIN 28 TOURNAMENT EXPRESS — ALBIN



**Builder:** [ALBIN](#)

**Year Built:** 1996

**Model:** Sport Fisherman

**Price:** PRICE ON APPLICATION

**Location:** United States

**LOA:** 28' 0" (8.53m)

**Beam:** 10' 0" (3.05m)

**Cruise Speed:** 19 Kts. (22 MPH)

**Max Speed:** 28 Kts. (32 MPH)

Our experienced yacht broker, Andrey Shestakov, will help you choose and buy a yacht that best suits your needs **Albin 28 Tournament Express — ALBIN** from our catalogue. Presently, at Shestakov Yacht Sales Inc., we have a wide variety of yachts available on our sale's list. We also work in close contact with all the big yacht manufacturers from all over the world.

If you would like to buy a yacht **Albin 28 Tournament Express — ALBIN** or would like help answering any questions concerning purchasing, selling or chartering a yacht, please call **+1(954)274-4435**

# TABLE OF CONTENTS

---

|                                   |   |
|-----------------------------------|---|
| TABLE OF CONTENTS                 | 2 |
| SPECIFICATIONS                    | 4 |
| Overview                          | 4 |
| Basic Information                 | 4 |
| Dimensions                        | 4 |
| Speed, Capacities and Weight      | 4 |
| Accommodations                    | 4 |
| Hull and Deck Information         | 4 |
| Engine Information                | 5 |
| DETAILED INFORMATION              | 6 |
| Deck and Hull                     | 6 |
| Mechanical and Electrical Systems | 6 |
| Accommodations and Interior       | 6 |
| Electronics                       | 7 |
| Disclaimer                        | 7 |
| Exclusions                        | 7 |
| Disclaimer                        | 7 |
| PHOTOS                            | 8 |
| Cruising Home                     | 8 |
| In Her Shed                       | 8 |
| Actual Helm                       | 8 |
| Helm & Controls                   | 8 |
| Cockpit                           | 8 |
| Truly Hunter Green                | 9 |
| Manufacturer Provider Image       | 9 |
| Manufacturer Provider Image       | 9 |
| Engine                            | 9 |
| Manufacturer Provider Image       | 9 |

---

|                             |    |
|-----------------------------|----|
| Manufacturer Provider Image | 10 |
| Manufacturer Provider Image | 10 |
| Dinette                     | 10 |
| CONTACTS                    | 11 |
| Contact details             | 11 |
| Telephones                  | 11 |
| Office hours                | 11 |
| Address                     | 11 |

---

# SPECIFICATIONS

---

## Overview

---

Truly economical family fisherman or cruiser. Dependable Cummins power and easy to service motor box, make the Albin 28" one of the most practicable boats in her class. First owner fished her in the bay. Current owners have cruised her, and want to move up to a trawler. All reasonable offers will be considered. They have found their next boat.

## Basic Information

---

**Category:** Sport Fisherman

**Model Year:** 1996

**Year Built:** 1996

**Country:** United States

## Dimensions

---

**LOA:** 28' 0" (8.53m)

**Beam:** 10' 0" (3.05m)

## Speed, Capacities and Weight

---

**Cruise Speed:** 19 Kts. (22 MPH)

**Max Speed:** 28 Kts. (32 MPH)

**Displacement:** 7500 Pounds

**Water Capacity:** 36 Gallons

**Holding Tank:** 20 Gallons

**Fuel Capacity:** 132 Gallons

## Accommodations

---

**Total Heads:** 1

## Hull and Deck Information

---

**Hull Material:** Fiberglass

---

## Engine Information

---

**Engines:** 1

**Manufacturer:** Cummins

**Engine Type:** Inboard

**Fuel Type:** Diesel

---

# DETAILED INFORMATION

---

## Deck and Hull

---

- Bow pulpit w/ roller
- 3 Windshield wipers
- F W inlet
- S W washdown
- Cockpit hot / cold shower
- Hardtop w/ handrails
- Rocket launcher on hardtop
- S S bow rail
- Ritchie compass
- Cockpit gunwale mount rod holders
- Transom fish boxes
- Transom livewell
- Custom sunshade off the hardtop

## Mechanical and Electrical Systems

---

- Cummins 330 hp installed in 2008
- Dripless shaft seal
- Vetus Bow thruster
- Bennett trim tabs
- Pro Sport battery charger
- Cruise Air w/ reverse cycle heat / air conditioning w/ SMX control
- Oil transfer pump
- 30 amp Shore power cord
- Block heater

## Accommodations and Interior

---

- Microwave
- Norfold Refrigerator
- Vizio flat screen TV
- Single burner stove
- Manual head
- Canvas cabin sunshades
- Tilt steering helm

---

## Electronics

---

- Furuno 1632 Radar
- Ray E-7 Chart plotter ( new 2012 )
- Raytheon Chart plotter
- Standard Horizon V H F GX 2100
- Ray Marine smart pilot w/ remote autopilot
- Jensen stereo w/ water proof speakers
- Remote spotlight

---

## Disclaimer

---

While we attempt to display current and accurate data, this listing may not reflect the most recent transactions or may contain occasional data entry errors. Selling agent makes no warranties, express or implied, regarding the content or availability of the products described herein. All inventory listed is subject to availability and prior sale. Please consult selling agent for details. Prices are quoted for the USA only and may not include transportation, taxes, or other applicable charges. Photographs may be representative only and may vary somewhat from the actual items offered for sale. We will not be responsible for inaccurate data obtained from our site. Please check with your local dealer to ensure that you have the latest information available. Information on this web site could include technical inaccuracies or typographical errors. Changes may be periodically made to the information or the products herein. Questions or comments regarding these policies may be directed to website hosting agent.

---

## Exclusions

---

Owner's personal belongings.

---

## Disclaimer

---

The Company offers the details of this vessel or yacht in good faith but cannot guarantee or warrant the accuracy of this information nor warrant the condition of the vessel. A buyer should instruct his representatives, agents, or his surveyors, to investigate such details as the buyer desires validated. This vessel or yacht is offered subject to prior sale, price change, or withdrawal without notice.

# PHOTOS

**Cruising Home**



**In Her Shed**



**Actual Helm**



**Helm & Controls**



**Cockpit**





### Truly Hunter Green



### Manufacturer Provider Image



### Manufacturer Provider Image

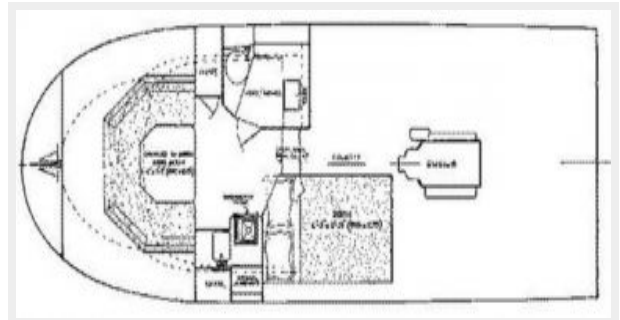

### Engine



### Manufacturer Provider Image



**Manufacturer Provider Image**



**Manufacturer Provider Image**



**Dinette**



---

# CONTACTS

---

Andrey Shestakov, leading yacht broker of the sales department of Shestakov Yacht Sales Inc. Shestakov Yacht Sales Inc., the official representative of the Miami/Fort Lauderdale FL headquarters.

---

## Contact details

---

Email: [andrey@shestakovyachtsales.com](mailto:andrey@shestakovyachtsales.com)

Web: [shestakovyachtsales.com/en/](http://shestakovyachtsales.com/en/)

---

## Telephones

---

USA: +1(954)274-4435

---

## Office hours

---

Monday – Saturday: **9:00 - 21:00** EDT

Sunday: **closed**

---

## Address

---



Harbour Towne Marina, 850 NE 3rd St,  
STE 213, Dania, FL 33004