

68M COMMANDER — TIRANIAN YACHTS



Builder: [Tiranian Yachts](#)

Year Built: 2017

Model: Mega Yacht

Price: PRICE ON APPLICATION

Location: Italy

LOA: 223' 2" (68.00m)

Beam: 42' 0" (12.80m)

Max Draft: 13' 0" (3.95m)

Cruise Speed: 15 Kts. (17 MPH)

Max Speed: 16 Kts. (18 MPH)

Our experienced yacht broker, Andrey Shestakov, will help you choose and buy a yacht that best suits your needs 68m Commander — Tiranian Yachts from our catalogue. Presently, at Shestakov Yacht Sales Inc., we have a wide variety of yachts available on our sale's list. We also work in close contact with all the big yacht manufacturers from all over the world.

If you would like to buy a yacht 68m Commander — Tiranian Yachts or would like help answering any questions concerning purchasing, selling or chartering a yacht, please call **+1(954)274-4435**

TABLE OF CONTENTS

TABLE OF CONTENTS	2
SPECIFICATIONS	3
Basic Information	3
Dimensions	3
Speed, Capacities and Weight	3
Accommodations	3
Hull and Deck Information	3
Engine Information	4
DETAILED INFORMATION	5
Description	5
Exclusions	5
Disclaimer	5
PHOTOS	6
CONTACTS	9
Contact details	9
Telephones	9
Office hours	9
Address	9

SPECIFICATIONS

Basic Information

Category: Mega Yacht	Model Year: 2017
Year Built: 2017	Country: Italy
Vessel Top: Enclosed P.H. W/Sundeck	Helipad: Yes

Dimensions

LOA: 223' 2" (68.00m)	Beam: 42' 0" (12.80m)
Max Draft: 13' 0" (3.95m)	

Speed, Capacities and Weight

Cruise Speed: 15 Kts. (17 MPH)	Cruise Speed Range: 5500
Max Speed: 16 Kts. (18 MPH)	Gross Tonnage: 1869 Pounds

Accommodations

Total Cabins: 5	Total Berths: 10
Sleeps: 10	Captain Cabin: True
Crew Cabin: 8	Crew Sleeps: 16

Hull and Deck Information

Hull Material: Steel	Exterior Designer: Egg and Dart
Interior Designer: Egg and Dart	

Engine Information

Engines: 2

Manufacturer: Caterpillar

Model: 3516B

Engine Type: Inboard

Fuel Type: Diesel

DETAILED INFORMATION

Description

This exceptional 68m Mega Yacht opportunity is one of a more classic design. Form follows function, that is the base for this extraordinary vessel. The interior layouts on Commander strictly divide the service and crew area from the private Owner and Guest section and convinces with clever and fancy layouts and a new definition of living. The extensive open spaces imply the feeling of luxury and individuality. The yacht is equipped with an elevator straight thru all levels from the wine cellar in the lower deck all the way to Helideck. One of the main interior features is the “Art Lobby” with a beautiful Main Staircase that is located on the main deck. This generous size yacht can fully equip 16 crew very comfortable with Captain and Engineer accommodations right behind the wheelhouse location. Spacious layouts both on the interior and exterior make this a novelty to the Mega Yacht market. We encourage any interested parties to please call with or email to set up a time to discuss in further detail.

Exclusions

Owner's personal belongings.

Disclaimer

The Company offers the details of this vessel or yacht in good faith but cannot guarantee or warrant the accuracy of this information nor warrant the condition of the vessel. A buyer should instruct his representatives, agents, or his surveyors, to investigate such details as the buyer desires validated. This vessel or yacht is offered subject to prior sale, price change, or withdrawal without notice.

PHOTOS



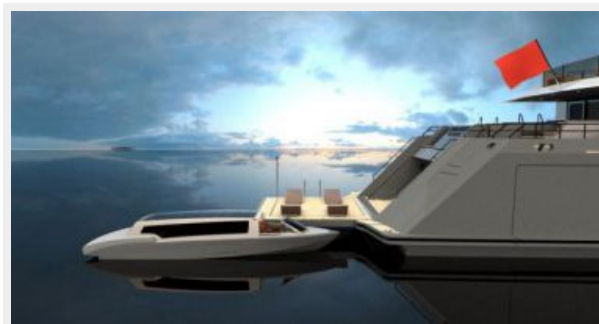
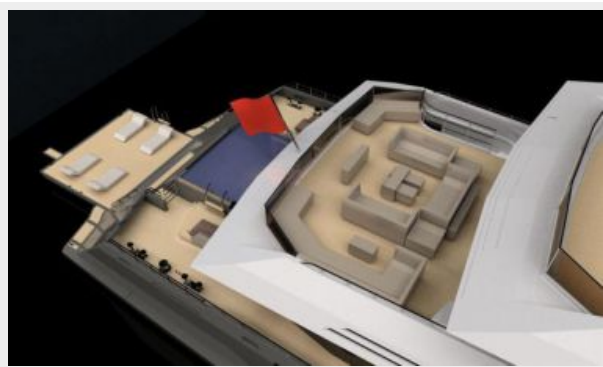



CONTACTS

Andrey Shestakov, leading yacht broker of the sales department of Shestakov Yacht Sales Inc. Shestakov Yacht Sales Inc., the official representative of the Miami/Fort Lauderdale FL headquarters.

Contact details

Email: **andrey@shestakovyachtsales.com**

Web: shestakovyachtsales.com/en/

Telephones

USA: **+1(954)274-4435**

Office hours

Monday – Saturday: **9:00 - 21:00 EDT**

Sunday: **closed**

Address



Harbour Towne Marina, 850 NE 3rd St,
STE 213, Dania, FL 33004