

HALCYON — LITTLE HARBOR



Судостроитель: LITTLE HARBOR

Год постройки: 1982

Модель: Cruising/Racing Sailboat

Цена: ЦЕНА ЯХТЫ ПО ЗАПРОСУ

Местонахождение: United States

Длина общая: 75' 0" (22.86m)

Ширина: 18' 4" (5.59m)

Мин. осадка: 7' 0" (2.13m)

Макс. осадка: 15' 0" (4.57m)

Макс. скорость: 8 Kts. (9 MPH)

Купить **HALCYON — LITTLE HARBOR** а также выбрать подходящую вам яхту из нашего каталога яхт вам поможет опытный яхтенный брокер Андрей Шестаков. На сегодняшний день компания **Shestakov Yacht Sales Inc.** имеет большое количество яхт в собственном списке продаж, а также тесно сотрудничает со всеми крупными яхтенными производителями по всему миру.

Для того чтобы купить яхту **HALCYON — LITTLE HARBOR** а также проконсультироваться по любому вопросу связанному с покупкой, продажей, чартером яхт позвоните по телефону **+7(918)465-66-44**.

ОГЛАВЛЕНИЕ

ОГЛАВЛЕНИЕ	2
ХАРАКТЕРИСТИКИ	5
Обзор	5
Основная информация	5
Размеры	5
Скорость, вместимость и масса	5
Размещение	6
Корпус и палуба	6
Информация о двигателе	6
ПОДРОБНОЕ ОПИСАНИЕ	7
Vessel Overview	7
Interior Accommodations	7
Main Salon	7
Galley	7
Master Stateroom	8
Port Guest Stateroom	8
Starboard Guest Stateroom	8
Crew Stateroom and Lounge	8
Deck Layout	8
Main Cockpit and Helm Station	9
Pilothouse	9
Hull and Deck	9
Spars, Rigging and Deck Gear	9
Winches	10
Sails	10
Engine and Mechanical Systems	10
Fresh Water System	10
Bilge Pump	11

Electrical System	11
Deck and Anchor Gear	11
Safety Equipment	11
Equipment	11
Brokers Remarks	11
Исключения	12
Отказ от ответственности	12
ФОТОГРАФИИ	13
Foredeck	13
Starboard Profile	13
Foredeck Aft	13
Evening on Deck	13
Owners Cockpit	13
Pilothouse	13
Pilothouse Aft	14
Pilothouse Controls	14
Main Salon Stbd	14
Main Salon Aft	14
Galley	14
Crew Quarters Forward	14
Owner Stateroom	15
Owner Stateroom Aft	15
Owner Stateroom Office	15
Starboard Stateroom as Double	15
КОНТАКТЫ	16
Контактная информация	16
Телефоны	16
Время работы	16
Адрес	16

ХАРАКТЕРИСТИКИ

Обзор

Ted Hood's "Whale bottom" design of the Little Harbor 75's, created a fleet of yachts with exceptional sailing capabilities and the interior volume, comfort and amenities of a far larger yacht. HALCYON is a joy to sail, with fully automated sail handling systems, shallow draft for access to all ports, a "trim board" for balance in all conditions and a comfortable protected cockpit arrangement second to none. Her on deck pilothouse provides a second helm station and lounge and her interior has been described by a past owner as "the nicest flat in any city we visit". Completely rebuilt in all respects in 2007, she has been maintained in top condition. She is ready to cruise all oceans in comfort and safety.

Основная информация

Тип судна: Cruising/Racing Sailboat **Модельный год:** 1982

Год постройки: 1982 **Год обновления:** 2007

Страна: United States

Размеры

Длина общая: 75' 0" (22.86m) **Ширина:** 18' 4" (5.59m)

Мин. осадка: 7' 0" (2.13m) **Макс. осадка:** 15' 0" (4.57m)

Скорость, вместимость и масса

Макс. скорость: 8 Kts. (9 MPH) **Чистый вес:** 43 Pounds

Вместимость сточного бака: 80 Gallons **Объем топливного бака:** 780 Gallons

Размещение

Всего кают: 3

Спальные места: 7

Всего ком. состава: 4

Каюты экипажа: 1

Койки экипажа: 2

Корпус и палуба

Материал корпуса: Composite Fiberglass Комплектация корпуса: Centerboard

Цвет корпуса: Blue

Дизайнер экстерьера: Ted hood

Дизайнер интерьера: Ted Hood

Информация о двигателе

Двигатели: 2

Производитель: Volvo

Модель: D4

Тип двигателя: Inboard

Тип топлива: Diesel

ПОДРОБНОЕ ОПИСАНИЕ

Vessel Overview

Ted Hood's "Whale bottom" design of the Little Harbor 75's, created a fleet of yachts with exceptional sailing capabilities and the interior volume, comfort and amenities of a far larger yacht. HALCYON is a joy to sail, with fully automated sail handling systems, shallow draft for access to all ports, a "trim board" for balance in all conditions and a comfortable protected cockpit arrangement second to none. Her on deck pilothouse provides a second helm station and lounge and her interior has been described by a past owner as "the nicest flat in any city we visit". Completely rebuilt in all respects in 2007, she has been maintained in top condition. She is ready to cruise all oceans in comfort and safety.

Interior Accommodations

The Hood 'Whale bottom' design creates extraordinary volume for comfortable accommodations below decks, allowing an interior that rivals far larger yachts. HALCYON is the only of her sisterships that utilizes the full beam of her main salon, below the pilothouse, which creates remarkable spaciousness. Interior woodwork is of varnished teak, with new teak and holly cabin soles 2007 and a comfortable décor throughout.

Main Salon

The full-beam spaciousness of HALCYON's MAIN SALON, is further accentuated by large hull ports on each side that offer a full harbor and ocean view from all salon seating. Forward in the salon, a service bar connects the salon with the galley, which can be separated with privacy doors. All machinery is easily accessible below the salon floor with fully automatic hydraulic risers. -L shaped settee aft to port -Dining table and settees to starboard, settee converts to face to port as well -New teak cabin sole (2007) with custom hatches to access machinery below - Custom AV system with DVD/CD/iPod, Sharp LCD TV and satellite receiver (2007) -Upholstery & slipcovers (2007) -(2) Overhead opening hatches -(6) Opening ports to deck level -(4) Large fixed ports port and starboard

Galley

Adjoining the Salon forward, the Galley is also full- beam width with a tremendous amount of cabinet, counter, storage and refrigerated space. This area can be fully open to the salon, or separated for crew/guest privacy. -5 Star, 4 burner stove with oven and broiler (2007) -DCS convection microwave oven (2007) -Kitchen Aid trash compactor (2007) -Double stainless steel sinks -Double door Grunert AC holding plate refrigeration w/24V DC back-up (2007) -Single door Grunert AC holding plate freezer w/24 V DC back-up (2007) -Asko clothes washer and dryer

(2007) -Jet Tech F14 dishwasher (2007)

Master Stateroom

The full-beam Master Stateroom is aft, with a large double berth slightly offset to starboard but offering access from both sides. Outboard to port is a full desk area and in the passageway aft to the private Owner's Cockpit, there is a full shower compartment to port and head to starboard. - Queen berth with drawers beneath -Large hanging lockers plus many stowage lockers and drawers -Desk area with navigation repeaters; GPS, radar/Raymarine, etc.. -Custom AV system with CD/DVD/iPod, Toshiba LCD TV and satellite receiver (2007) -Sirius radio (2007) -(5) opening ports

Port Guest Stateroom

Forward of the master stateroom in to port in the passageway, the stateroom has a queen size berth which can be separated to create twin berths for exceptional layout flexibility. -Ensuite head and stall shower -Ample stowage in drawers, cabinets & hanging locker -Opening port - Custom AV system (2007)

Starboard Guest Stateroom

Aft of the main salon to starboard, the stateroom has twin lower berths, with a third single berth above and outboard to starboard. -Ensuite head and stall shower -Ample stowage in drawers, cabinets & hanging locker -Opening port -Custom AV system (2007)

Crew Stateroom and Lounge

Crew quarters aboard HALCYON are completely separate and self-contained, forward of and adjoining the galley, direct access to all laundry facilities, navigation/communication repeaters and entertainment system. -Full dinette/lounge to port -Lower single and upper double berth to starboard -Ensuite head & stall shower -Custom entertainment/AV system (2007) -Ray marine E80, 8" display for Radar, GPS, Plotter (2007) -Standard Horizon VHF (2007) -(3) Overhead hatches

Deck Layout

HALCYON has one of the most comprehensive and innovative deck arrangements of any yacht her size, with a large center cockpit centered around a large teak drop leaf table, with access to all sailing functions as well. Immediately forward and two steps down is the comfortable and well protected pilothouse, with full controls and navigation repeaters. Fully aft is the private Owner's cockpit with direct access to the owner's suite and forward on deck is the broad expanse of her

teak foredeck and sailhandling systems.

Main Cockpit and Helm Station

The steering pedestal is aft in the cockpit with all power controls and all sailhandling controls, winches, etc., within easy reach. Adjoining the pedestal, the central drop leaf teak folding table can comfortably seat 8 guests for dining and has ice box stowage for drinks. The area is completely protected with a full bimini and also offers convenient access to sail handling systems, electric winches, etc. -Volvo Penta electronic engine panels and electronic controls (2007/2013) -Lewmar bow thruster control (2007) -9" Danforth Constellation compass -Standard Horizon RAM VHF radio (2007) -Raymarine E120 12" Display for GPS, Plotter, radar, AP, etc. - Raymarine Graphic ST60 speed, distance, depth meters (2007) -Raymarine ST windspeed, AWI indicator (2007) -Raymarine rudder angle indicator (2007)

Pilothouse

Immediately forward and two steps down from the cockpit, the adjoining Pilothouse has a full settee to starboard and to port, a comfortable helm seat and settee outboard. The area is fully protected from the elements with full 360 degree visibility, plus all controls and navigation/communications for the yacht. The area is fully heated or air-conditioned with the aft closure in place. Connected with the cockpit, this area completes over 20' of protected indoor/outdoor control, lounge and entertainment areas. -Volvo Penta electronic engine panels and controls (2007/2013) -Lewmar bow thruster control (2007) -6" Danforth Constellation compass -Raymarine E120 12" display for GPS/Plotter/Radar, AP, etc. (2007) -(2) Standard Horizon VHF radio (2007) -ICOM IC-M710 SSB radio (2007) -Robertson AP 300X autopilot (2007) -Raymarine Graphic ST60 windspeed and AWI (2007) -Furuno Radar (2007) -EPIRB (2007) -Sirius Radio (2007) -Wave WiFi booster throughout the yacht (2007) -Cellular signal amplifier (2007) -External GPS/USB for laptop/Nobletec software (2007) -Multiple client software programs (2007) -Video converter from laptop to Raymarine display (2007) -Satellite telephone and fax (2007) -Shipboard telephone system with handheld wireless remote

Hull and Deck

-Complete Awlgrip paint, topsides and deck areas (2007) -Bottom completely stripped and dried for 10 months & barrier coats applied (2007) -Hydraulic lift systems for centerboard & trim boards, fully upgraded (2007) -New Lewmar 12" bow thruster -New Marlon flush mounted sea-cocks and strainers (2007) -All new teak decks (2007) -New flush mounted deck hatches (2007) -High performance window frames & tinted pilothouse windows (2007) -Bowmar overhead pilothouse hatches (2007)

Spars, Rigging and Deck Gear

-Double spreader Hood Stoway spar, removed, fully serviced and painted (2007) -New mainsail furling luff rod and motor (2013) -New running rigging; main & jib sheets, outhaul, job halyard & running backstays (2013) -Harken Mk II furling headsail stay fully serviced (2007) -All Navtec rod rigging fully surveyed & serviced (2007) -Navtec hydraulic boomvang -All Harken deck blocks (2007)

Winches

-(2) Lewmar #88 ST Electric primaries -(2) Lewmar #77 ST Electric secondaries -(2) Lewmar #54 ST Electric main sheet and outhaul -(2) Lewmar #54 ST 2 speed halyard winches -Lewmar #48 ST 2 speed halyard winch -Lewmar #28 2 speed halyard winch

Sails

Hood Vectran stoway mainsail (2007) Hood 115% genoa (2013) Hood Vectran 130% furling genoa (2007) Staysail (storm jib) on removable staysail stay Asymmetrical cruising spinnaker with “snuffer”

Engine and Mechanical Systems

During the 2007 refit, the entire main salon cabin sole was replaced and redesigned, allowing full access to the machinery spaces below, which were completely stripped, detailed and finished in white Awlgrip before installing all new machinery. Floorboards are hinged, with hydraulic risers for easy access to all machinery and equipment. -(2) Volvo 180 hp common rail electronic fuel injected diesel engines and transmissions (2007) In November 2013, the port engine was replaced new. Engine Hours 2/2015: Port; 590 – Starboard; 3,541. -(2) Bruntons 24” / 4 blade Varifold feathering propellers (2007) -Aqua Drive thrust bearing (2007) -Tides Marine shaft seals (2007) -“Spurs” line cutters on 1 3/4” SS shaft -New fuel distribution system with dual Racor filters for main engines (2007) -Single Racor filters for each generator and fuel transfer pump (2007) -Racor vacuum gauges -Reverso 24 volt, 2 part oil transfer systems for engines, transmissions and generators (2007) -(2) Allcraft 20 gallon stainless water heaters; 220 volt/engine heat exchanger (2007) -Marine Air 48,000 BTU chilled water air conditioning system (2007) -Fuel transfer pump (2007) -Algae-X FPS-500 fuel polishing system (2007) -Sump pumps (2007) -Grunert 220 volt refrigeration system with 24 volt DC backup & holdover plates (2007) -Propane alarm system (2007)

Fresh Water System

-Fresh water pressure pumps and accumulator tank (2010) -Sea Recovery Aqua Whisper 1800 GPD Watermaker (2007) -Shipboard water filtration system (2007)

Bilge Pump

-Bilge pumps with counters and alarm panels (2007) (2) electric/automatic (2) electric (2) manual

Electrical System

(2) Westerbeke 33 KWH generators (2007) Generator Hours 2/2015: Port; 3.330 – Starboard; 3,180 -Digital controls at main panel in main salon -Main electric panel and distribution box completely rewired (2012) -Two banks of AGM batteries (4) each, (8) total (2013) -(2) AGM engine starting batteries (2013) -(2) AGM generator starting batteries (2013) -(2) AGM electronics batteries (2013) -(2) Mastervolt Combi 24-2000 chargers - Stat Power 40+ charger - (2) Xantrak Truecharge 40 amp battery chargers

Deck and Anchor Gear

-Lofrans 24V windlass (rebuilt 2007) -Bruce 110 lb Anchor w/200' hi-tensile chain (2007) -CQR 60 lb anchor w/125' hi-tensile chain (2007) -Fortress 125 lb storm anchor w/1/2" chain and 200' nylon rode (2007) -200' spare nylon rode/ -(8) Rondal polished ss 16" cleats (2007)

Safety Equipment

-DBC 8 person Liferaft -Fireboy 36# Halotron engine room fire extinguisher -(6) Type V inflatable lifejackets -(4) 10 # dry chemical fire extinguishers -Horseshoe MOB buoy with strobe -MOB pole -Lifesling

Equipment

- Nouvorania RIB w/60 hp Yamaha outboard (2006) -Die-formed wire lifelines (2007) -Main cockpit bimini (2012) -Aft cockpit dodger (2012) -Wheelhouse enclosure screen (2012) -Full boat awning -Cockpit and pilothouse cushions (2007) -Hot/cold cockpit shower (2007)

Brokers Remarks

33 Years ago, Ted Hood designed the Little Harbor 75 as one of the most innovative and forward looking yachts of her size, ever launched. HALCYON combines all the best attributes of the design. In 2007, the yacht received an absolutely comprehensive rebuild/refit by Hinckley Yachts, which renewed the yacht, from the hull bottom to her teak decks, spars and rigging, all machinery, systems, electronics and cosmetics. Simply stated, they made this innovative, classic design, new again. Since 2007, the yacht has continued to receive the best of care, with all systems maintained in top condition.

Исключения

При продаже яхты исключаются личные вещи владельца.

Отказ от ответственности

Компания предоставляет описание судна или яхты добросовестно, но не может гарантировать точность этой информации, а также не ручается за техническое состояние. Покупатель должен проинструктировать своих агентов или оценщиков исследовать представленную информацию более подробно, по собственному желанию. Продажа судна или яхты, изменение цены или снятие с продажи будет происходить без предварительного уведомления.

ФОТОГРАФИИ

Starboard Profile



Foredeck



Foredeck Aft



Evening on Deck



Owners Cockpit



Pilothouse



Pilothouse Aft



Pilothouse Controls



Main Salon Stbd



Main Salon Aft



Galley



Crew Quarters Forward



Owner Stateroom



Owner Stateroom Aft



Owner Stateroom Office



Starboard Stateroom as Double

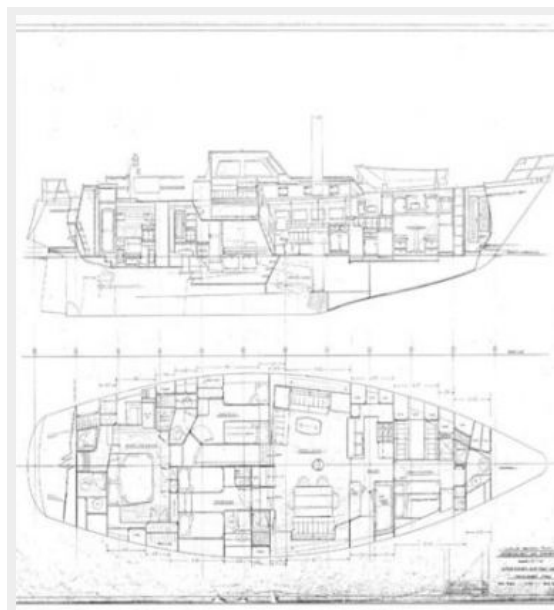

КОНТАКТЫ

Андрей Шестаков (Andrey Shestakov) – ведущий яхтенный брокер отдела продаж яхт и судов компании Shestakov Yacht Sales Inc. Официальный представитель Shestakov Yacht Sales Inc. для русскоговорящих клиентов в центральном офисе компании в Майами/Форт Лодердейл/Флорида/США.

Контактная информация

Email: andrey@shestakovyachtsales.com

Web: shestakovyachtsales.com

Телефоны

Краснодарский край: **+7(918)465-66-44**

США, Майами, Флорида: **+1(954)274-4435**

Время работы

Понедельник – Суббота: **9:00 - 21:00**
EDT

Воскресенье: **Закрето**

Адрес



Harbour Towne Marina, 850 NE 3rd St,
STE 213, Dania, FL 33004