

VELIKO TOČENO — BAVARIA



Builder: BAVARIA

Year Built: 2013

Model: Motor Yacht

Price: PRICE ON APPLICATION

Location: Croatia

LOA: 44' 8" (13.60m)

Beam: 13' 10" (4.21m)

Min Draft: 2' 7" (0.77m)

Max Draft: 3' 8" (1.11m)

Cruise Speed: 20 Kts. (23 MPH)

Our experienced yacht broker, Andrey Shestakov, will help you choose and buy a yacht that best suits your needs **VELIKO TOČENO — BAVARIA** from our catalogue. Presently, at Shestakov Yacht Sales Inc., we have a wide variety of yachts available on our sale's list. We also work in close contact with all the big yacht manufacturers from all over the world.

If you would like to buy a yacht **VELIKO TOČENO — BAVARIA** or would like help answering any questions concerning purchasing, selling or chartering a yacht, please call **+1(954)274-4435**

TABLE OF CONTENTS

TABLE OF CONTENTS	2
SPECIFICATIONS	4
Overview	4
Basic Information	6
Dimensions	6
Speed, Capacities and Weight	6
Accommodations	6
Hull and Deck Information	6
Engine Information	7
PHOTOS	8
tender	8
saloon	8
saloon converted	8
helm	8
IPS	9
cabin	9
underwater lights	9
twins (convert to doubles)	9
showing blue bimini	10
layout	10
sistership swim platform	10
sistership fly bridge	10
sistership aft deck	10
sistership swim platform	10
CONTACTS	11
Contact details	11
Telephones	11
Office hours	11

Address

11

SPECIFICATIONS

Overview

The Bavaria Virtess 420 Fly was named the 2013 European Powerboat of the Year. Text taken from Boating World: On board, the first thing that came to mind was the old car slogan about German engineering. From the swim platform to the bow there are multiple spots at which to marvel at the ingenuity. The platform operates on hydraulic lifts via remote control to lower completely in the water and is used to store and launch the tender. All of the cockpit furniture slides on a stainless-steel track so that it can be rearranged and locked into place for however you want to use it. The faux teak flooring holds up to the sliding so you can practice feng shui without reservation. Glass sliders separate the cockpit from the salon and can be opened to create an easy flow between the spaces. The dinette table raises and lowers with the push of a button. Here we noticed styling, done by Italian designers, that complements the German engineering. The mahogany interior finish and clean lines accent the entire cabin, which is bathed in natural light. The galley sits to port opposite the standard lower helm. Belowdecks, the master stateroom features furniture of the same mahogany and an oversize island berth. The side windows provide ample natural light. The en suite head features a full stand-up shower with a teak bench and a glass door. The two guest staterooms to either side sport twin singles that convert to doubles with filler cushions. The guest head also features a full shower. The real prize of this boat is the fly bridge, which features 360-degree viewing from the helm and a teak table that anchors a six-person dinette. The starboard seat converts into a sun pad. With the twin 435 hp Volvo Penta engines, the 420 cruised comfortably and felt solid carving through chop. The Volvo Penta IPS600s proved very nimble in carving S-curves and other maneuvers, especially turning hard-over at speed, and the joystick afforded great handling in close quarters around marina. Owner Specified Equipment

Navy Blue bimini Cup holders! Flybridge lighting package In harbour covers (grey) Fender baskets on railings Windscreen wipe-washers 2 stools in saloon with flexible backrests Curtain on sliding glass door to cockpit FuSlon Marine Multimedia package 22": TV 22" in Saloon with 2 USB plug and DVD-device, Headunit with 2,7" TFT LCD screen, DVD/CD - receiver(AM/FM/VHF), 2 speakers in salon, 2 speakers in cockpit and 2 speakers on deck, Dock for iPod and USB, Amplifier 200 W, Active subwoofer in saloon, Remote control on deck, TV cabling digital + analog, incl. antenna Shore supply for water Water in Fuel-Kit (additional water sensor in fuel filter with alarm) Additional service battery, AGM Electrical windlass Delta anchor, galvanised Anchor chain, galvanised, Ø 10 mm, 50 meters Control unit with chain counter Bow thruster SE 100, electrical incl. operating battery, AGM Refrigerator on fly deck 2 cup holders, stainless steel on foredeck Sun upholstery on foredeck External sun shades (windscreen and side windows) Chiller-Air-Conditioning, 32.000 BTU, outlet in salon and each cabin, incl. heating and ventilation for windscreen DuraDeck on cockpit floor and bathing platform Bathing platform hydraulically lowerable Electrical grill on Fly deck, 230 V Table foldable incl. cupholder Camper cover, navy blue Floor White Wood Upholstery artificial leather "Leatherette" Washing machine toploader 5 kg (in combination with grey water tank) Grey water tank 240 l BOSE Acoustimass 3

System in Salon (in combination with FUSION Marine Multimedia package 22" in Salon) TV in each cabin, 3 pcs. Venetian blinds for dimming the salon side windows Generator Paguro 12 kW VHF station Garmin 200i 2x Plotter Garmin 5012 2x incl. mapovej cards 2x Autopilot GHP 10, control from deck and flybridge Remote control of Autopilot Radar Garmin 18 HD SAT antennae KWH TrackVision M5, 3 x receiver Electric capstan Quick Totem 800 2x Inflatable RIB boat BRIG F300L with Yamaha F20 DES, & boat holders on platform. Gangway Optima 220 cm, foldable Harbour connecting cable 230 V, 2x Saloon table adapted for sleeping incl. cushion Complete equipment for mooring (ropes, fenders etc.) Complete equipment in galley Complete equipment for beds in cabins Complete equipment for cruise Antifouling painting, International dover white, soft

Standard Equipment Hull windows to open up (with blinds), 8 Steering wheel in sports design, height adjustable Stainless steel bow fitting with anchor roller Deck Hatches to open up, 4 2 Cockpit windows to open up Side deck with anti slip structure Anchor locker, self-drained 6 stainless steel cleats Windscreen wiper stb. and port with synchronous control Stainless steel bow rail Bathing platform hydraulic Cockpit, self-drained Cockpit lights Cockpit upholstery Stern-shower for warm and cold water Fly deck: Radar arch GRP Fly deck with anti slip structure Helm position with double seat Table on fly deck Sunbed on fly deck Handrail on flybridge stairs Stainless steel Wetbar with sink Storage for liferaft Windscreen tinted (laminated glass) Side windows tinted (security glass) Interior wood in solid and veneer, standard in mahogany Covered panel ceiling Settee in saloon Saloon table in solid wood Standard upholstery Stowage space: Lockers and racks Stowage space under sitting area Stowage space under aft sun pad Overhead locker and wardrobe Galley: Ceramic stove top Microwave Refrigerator, 12 V, 80 l Double stainless steel sink, with cover Safety: CE-fire extinguishing system 2 fire extinguishers Fire blanket Navigation: Navigation lights (BDI certification) Sumlog-sonar, Multisensor Acoustic signal system (BSH-Certification) Illuminated compass Water supply: Electrical pressurized water pump with filter Warm water boiler 40 l via engine-cooling circuit and via 230 V Heads: Electrical sea toilet with central holding tank, disposal via seacock and deck suction 2x separate shower cabins in heads Engine compartment: Engine bay fan Engine bay ladder Engine compartment illumination Manual bilge pump in engine bay Electrical bilge pump in engine bay Electrical bilge pump in aft cabin Instrumentation: Analogue instrumentation: engine temperature, voltmeter, power trim, RPM, rudder indicator Digital multi-functional display for speed, current fuel consumption and average fuel consumption plus diverse trip and engine information Drives: Z-drive with hydraulic steering EVC electronical shifter for twin engines Electrical system: AC-outlet package (2 per cabin and 3 in galley) Shore supply, 230 V Battery charger, 40 A (3-channel) Starter battery, AGM (1 x per engine) Service battery, AGM Main switch for board batteries and starter batteries CE-Certification Category B GL CE-Yacht certification Volvo Penta certified installation

Basic Information

Category: Motor Yacht

Sub Category: Flybridge

Model Year: 2013

Year Built: 2013

Country: Croatia

Vessel Top: Radar Arch and Bimini

Fly Bridge: Yes

Cockpit: Yes

Dimensions

LOA: 44' 8" (13.60m)

Beam: 13' 10" (4.21m)

Min Draft: 2' 7" (0.77m)

Max Draft: 3' 8" (1.11m)

Clearance: 16' 4" (4.97m)

Speed, Capacities and Weight

Cruise Speed: 20 Kts. (23 MPH)

Displacement: 25132.697868 Pounds

Water Capacity: 108.31054132 Gallons

Fuel Capacity: 317.0064624 Gallons

Fuel Consumption: 26.4172052 Gallons

Accommodations

Total Cabins: 3

Total Berths: 6

Sleeps: 6

Total Heads: 2

Hull and Deck Information

Hull Material: GRP

Deck Material: Esthec

Hull Color: White

Engine Information

Engines: 2

Manufacturer: Volvo Penta

Model: Volvo Penta IPS 600 (2 x 435hp)

Engine Type: I/O

Fuel Type: Diesel

PHOTOS

tender



saloon



saloon converted

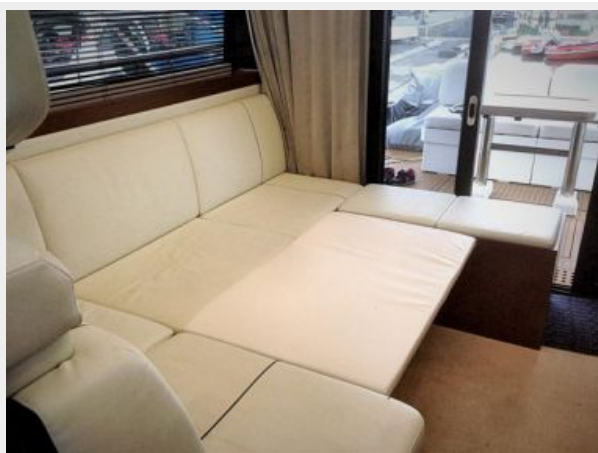

helm



IPS



cabin



underwater lights

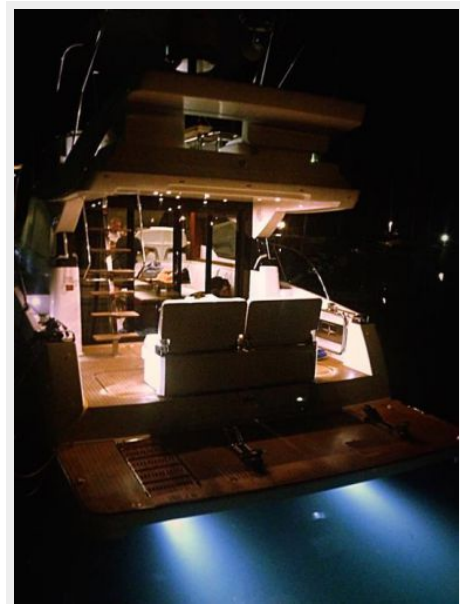

twins (convert to doubles)



showing blue bimini



layout

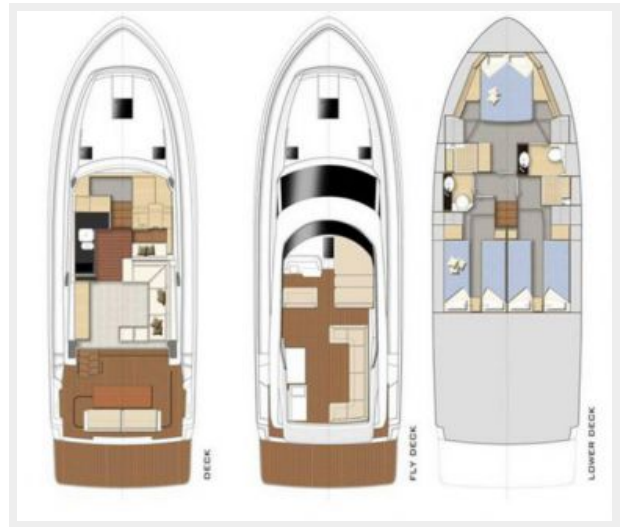

sistership swim platform



sistership fly bridge



sistership aft deck



sistership swim platform



CONTACTS

Andrey Shestakov, leading yacht broker of the sales department of Shestakov Yacht Sales Inc. Shestakov Yacht Sales Inc., the official representative of the Miami/Fort Lauderdale FL headquarters.

Contact details

Email: andrey@shestakovyachtsales.com

Web: shestakovyachtsales.com/en/

Telephones

USA: +1(954)274-4435

Office hours

Monday – Saturday: **9:00 - 21:00** EDT

Sunday: **closed**

Address



Harbour Towne Marina, 850 NE 3rd St,
STE 213, Dania, FL 33004