

SEJAA — JFA



Builder: [JFA](#)

Year Built: 2002

Model: Cruising Sailboat

Price: PRICE ON APPLICATION

Location: United States

LOA: 82' 0" (24.99m)

Beam: 19' 9" (6.02m)

Min Draft: 11' 6" (3.51m)

Our experienced yacht broker, Andrey Shestakov, will help you choose and buy a yacht that best suits your needs **SEJAA — JFA** from our catalogue. Presently, at Shestakov Yacht Sales Inc., we have a wide variety of yachts available on our sale's list. We also work in close contact with all the big yacht manufacturers from all over the world.

If you would like to buy a yacht **SEJAA — JFA** or would like help answering any questions concerning purchasing, selling or chartering a yacht, please call **+1(954)274-4435**

TABLE OF CONTENTS

TABLE OF CONTENTS	2
SPECIFICATIONS	3
Basic Information	3
Dimensions	3
Speed, Capacities and Weight	3
Accommodations	3
Hull and Deck Information	3
Engine Information	3
DETAILED INFORMATION	4
Note	4
Construction	4
Machinery	4
Electrical Systems	5
Plumbing Systems	6
Tankage	7
Navigation Equipment	7
Domestic Equipment	7
Accommodation	8
Deck Equipment	9
Exclusions	12
Disclaimer	12
PHOTOS	13
CONTACTS	16
Contact details	16
Telephones	16
Office hours	16
Address	16

SPECIFICATIONS

Basic Information

Category: Cruising Sailboat

Model Year: 2002

Year Built: 2002

Country: United States

Dimensions

LOA: 82' 0" (24.99m)

Beam: 19' 9" (6.02m)

Min Draft: 11' 6" (3.51m)

Speed, Capacities and Weight

Water Capacity: 369.8408728 Gallons

Fuel Capacity: 396.258078 Gallons

Accommodations

Total Cabins: 3

Total Berths: 6

Hull and Deck Information

Hull Material: Aluminum

Deck Material: Teak

Hull Finish: Aluminum

Hull Designer: Judel/Vrolijk & Co

Engine Information

Engines: 1

Manufacturer: Yanmar

Model: 6LP-DTE

Engine Type: Inboard

Fuel Type: Diesel

DETAILED INFORMATION

Note

Note: All artwork, personal dive gear, personal foul weather gear and safety harnesses excluded from sail.

Construction

Hull, Deck & Superstructure Construction:

- Aluminium alloy for hull, deck and superstructure.
- Hull Colour: Dark navy blue.
- Watertight bulkhead between forepeak and forward accommodations.
- Plumb bow.
- Counter stern with reverse transom.
- New barrier coat and bottom paint (2015).
- Bottom surveyed prior to new bottom paint.
- Teak decks.

Keel & Rudder:

- Lead ballast keel.
- Spade rudder.

Machinery

Engine & Gearboxes:

- Yanmar 6 cylinder diesel, turbocharged, intercooled, model 6LP-DTE.
- Transmission is ZF marine gearbox.

Maintenance & Performance:

- Engine, full gasket service done 2014.

Propulsion & Steering:

- Stainless steel prop shaft.
- 3-bladed folding propeller.
- JP3 rudder bearing, replaced 2013, along with steering cables.
- 2 x Carbon destroyer type wheels.
- Emergency tiller.
- Exhaust system is water injected.
- Bow Thruster, overhauled 2013 by New England Bowthruster, with new prop and door, Lewmar 300 SVT, hydraulically operated vertically retractable, accessible from forepeak.
- Joy stick at helm.

Electrical Systems

There are two primary ship's electrical systems. The first is the 24V from battery banks. The second is 220V AC and is supplied mainly by the shore power connection or from the on board generator, or by a DC to AC inverter.

Voltage Systems:

- 24V/220V electrics.

Battery Banks:

- Two 24VDC battery banks (one house/service, one generator start).
- 12V DC start battery for main engine.

Battery Chargers:

- MasterVolt 1500 W DC to AC inverter.
- Two Mastervolt 110A 220V battery chargers.

Alternators:

- Dedicated engine mounted alternator 175A.

Generator:

- Generator, in sound shield, Westerbeke 20BED, 20.0 kVA, 220V/50 Hz.
- Generator fully overhauled – all gaskets changed, except for head. Compression tests conducted, endoscope inside cylinders, latching still visible. Heater exchanger, exhaust elbow and raw water pump all changed (May 2014).
- New generator exhaust, 2015.

Shore Power:

- 220V.

Plumbing Systems

- Plumbing system overhaul, with new hoses, 2013.

Watermaker:

- Watermaker.

Bilge Pumps:

- Electric bilge in forepeak, 2 in mast bilge area, engine room, lazarette area.
- Manual pump in aft cockpit.

Tankage

Fuel:

- Integral fuel tanks, double bottom, capacity reported at 1500 litres.
- One day tank, non integral.

Fresh water:

- Two integral alum. water tanks, reported capacity 1400 Litres.

Grey/Blackwater holding tanks:

- Two integral holding tanks.
- Sumps for each head and galley sink, connected to holding tanks.

Navigation Equipment

- BG Race Package, June 2014 (most recent available).
- B&G gauges on the mast, 2014.
- Raymarine instruments, 2014 (GPS, screens).
- Raymarine radar dome, 2014.
- 2 x Raymarine chart plotters, 2012.
- Large flat screen TV in main salon and owner's cabin.
- Cockpit speakers and system, 2013.
- EPIRB.
- AIS.
- Sat phone communications.
- MaxSea Nav. system on yachts PC.

Domestic Equipment

Galley:

- Refrigeration, five units, engine & shore power driven, all redone 2012/2013:
 1. In galley, one top load deep freeze and one refrigerator.
 2. Two upright refrigerators port side of galley, and one refrigerator/ice maker in cockpit table.
- washer/dryer, Meile, 2013
- Gimballed Force 10 sst 4 burner stove/oven.
- Dishwasher, 2012
- Microwave.
- Solenoid shut off system for propane.

Heads/Showers:

- Four electrically operated vacuum type fresh water flush toilets, ECO VAC.
- Hoses redone 2012.
- Two integral holding tanks.

Heating & Ventilation:

- Air conditioning, Marine Air Systems, and fitted with reverse cycle valve for heating purposes.
- Seven air handlers throughout the boat, each equipped with independent thermostat controls, except main salon with two on one control.
- Three compressors, total cooling 60,000 BTU's.

Accommodation

Summary of Accommodation:

- Three guest cabins in total: two twin cabins in the midships section of the vessel and one full breadth master stateroom/double in the fwd section.
- The two twin cabins are also fitted with Pullman drop down berths.

- All owner/guest cabins have en suite heads/shower compartments.
- Crew cabin is aft to port of the engine room.
- Interior cushions, redone 2012/2013.
- Custom bed linens.
- Galley dishware/cutlery/pans.
- Main salon is amidships, and extends full width of the vessel.
- The galley and crew mess is found to stbd opposite the crew cabin.
- Nav station is in the aft portion of the main salon.
- The engine compartment is found beneath the center cockpit area and accessible from a door in the galley/crew mess.
- A forepeak is found most forward.

Deck Equipment

Rig:

- Standing rigging, 2014.
- Complete mast service by Southern Spar (2014).
- Roller furler overhaul, 2014.
- New mechanical gear for in-boom furling; fly wheel replaced, 2013.
- New main sheet and halyards, 2015.

Winches:

- Winches, all self-tailing:
 1. Base of mast, L66 x 2.
 2. Aft cockpit, L77's x 4.
 3. Captive winch, LMS 600.

Sails:

- DOYLE SAILS - all 2011, Statis GPC, (laminated carbon/spectra strands).
- Full batten main.
- Code Zero.
- #1 spinn.
- #2 spinn.
- Forestay is Reckmann roller furling, serviced by Rig Pro 2014, hydraulic.
- Self tacking jib.
- Southern Spars carbon mast and boom, fractional rig, keel stepped, four spreaders, painted white with complete rebuild of the in boom furling, new gears in 2013
- In boom furling, hydraulics.
- Navtec hydraulic backstay, vang and outhaul.
- New Gooseneck attaching boom to mast, done by Npt Shipyard
- A1 spinnaker purchased and recut, 2015.

General:

- Port and starboard lazarette lockers.
- Full hydraulic stern platform with carbon swim ladder.
- 4 x Fixed ports to starboard and to port (8 total).
- 8 x Rondal flush hatches on the main deck, forward of the coachroof.
- 4 x Aluminium framed clear hatches on coachroof.
- All teak hatch surrounds replaced, 2014.
- Hydraulics serviced 2015 with new hydraulic lines powered by PTO fitted on generator or by Lewmar Commander hydraulic power unit. All hydraulics on the boat run off this system.
- Hydraulics/PTO overhaul, 2014.
- Dive compressor, 2 bottles.

-
- Dive gear for two people.
 - Inflatable paddle board.
 - Snorkles, fins and masks.
 - Custom cockpit table, with refrigeration and ice maker built into table.
 - Tools and spares.
 - Carbon passarelle.
 - Extra swim ladder for topsides.

Anchoring & Mooring Equipment:

- Hydraulic windlass, Lewmar, vertical type with gypsy and capstan.
- CQR anchor – 140lb.
- Secondary CQR 170lb anchor.
- Pop-up deck cleats.

Covers, Canvas & Cushions:

- Cockpit cushions, redone 2012/2013.
- Bimini.
- Sprayhood.
- Wheel covers
- New cockpit table (with refrigerator and icemaker), 2012.

Safety Equipment:

- Up to date liferaft.
- Jack lines.
- 12 x Lifejackets.
- Flare kit.

Fire-fighting equipment:

- Fire extinguishers.
- Fire extinguishing system in engine room space.

Exclusions

Owner's personal belongings.

Disclaimer

The Company offers the details of this vessel or yacht in good faith but cannot guarantee or warrant the accuracy of this information nor warrant the condition of the vessel. A buyer should instruct his representatives, agents, or his surveyors, to investigate such details as the buyer desires validated. This vessel or yacht is offered subject to prior sale, price change, or withdrawal without notice.

PHOTOS

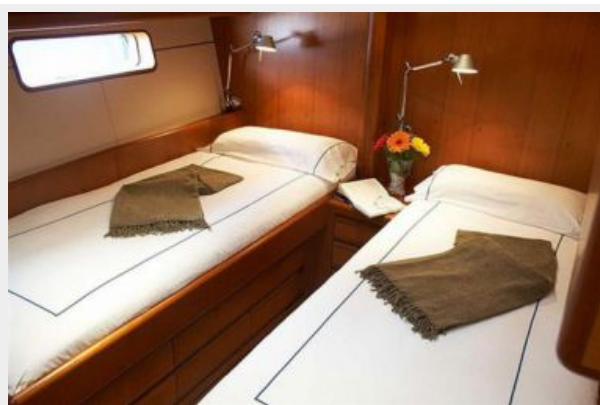



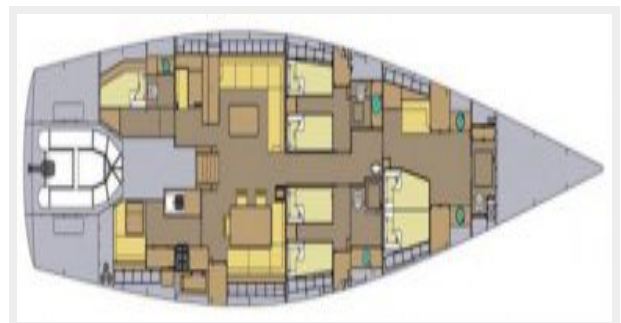

CONTACTS

Andrey Shestakov, leading yacht broker of the sales department of Shestakov Yacht Sales Inc. Shestakov Yacht Sales Inc., the official representative of the Miami/Fort Lauderdale FL headquarters.

Contact details

Email: andrey@shestakovyachtsales.com

Web: shestakovyachtsales.com/en/

Telephones

USA: +1(954)274-4435

Office hours

Monday – Saturday: **9:00 - 21:00** EDT

Sunday: **closed**

Address



Harbour Towne Marina, 850 NE 3rd St,
STE 213, Dania, FL 33004