

## MOTHER GUN — GRAND BANKS



**Судостроитель:** GRAND BANKS

**Год постройки:** 2001

**Модель:** Моторная яхта

**Цена:** **ЦЕНА ЯХТЫ ПО ЗАПРОСУ**

**Местонахождение:** United Kingdom

**Длина общая:** 43' 3" (13.18m)

**Ширина:** 14' 9" (4.50m)

**Мин. осадка:** 4' 2" (1.27m)

**Крейс. скорость:** 10 Kts. (12 MPH)

**Макс. скорость:** 21 Kts. (24 MPH)

Купить **MOTHER GUN — GRAND BANKS** а также выбрать подходящую вам яхту из нашего каталога яхт вам поможет опытный яхтенный брокер Андрей Шестаков. На сегодняшний день компания **Shestakov Yacht Sales Inc.** имеет большое количество яхт в собственном списке продаж, а также тесно сотрудничает со всеми крупными яхтенными производителями по всему миру.

Для того чтобы купить яхту **MOTHER GUN — GRAND BANKS** а также проконсультироваться по любому вопросу связанному с покупкой, продажей, чартером яхт позвоните по телефону **+7(918)465-66-44**.

# ОГЛАВЛЕНИЕ

---

ОГЛАВЛЕНИЕ	2
ХАРАКТЕРИСТИКИ	4
Обзор	4
Основная информация	4
Размеры	4
Скорость, вместимость и масса	4
Размещение	5
Корпус и палуба	5
Информация о двигателе	5
ПОДРОБНОЕ ОПИСАНИЕ	6
Broker's Comments	6
Construction	6
Machinery	6
Electrical Systems	7
Plumbing Systems	8
Tankage	9
Navigation Equipment	10
Domestic Equipment	11
Accommodation	12
Deck Equipment	14
Исключения	15
Отказ от ответственности	15
ФОТОГРАФИИ	16
КОНТАКТЫ	26
Контактная информация	26
Телефоны	26
Время работы	26
Адрес	26



# ХАРАКТЕРИСТИКИ

## Обзор

A striking, very rare and impressively-constructed trawler from the Malaysian masters - Grand Banks. 4 berths in two cabins, a superb saloon with raised galley, long flybridge, sturdy rails and safe decks. Generator, low hours on 375HP Caterpillars and built to last.

## Основная информация

**Тип судна:** Моторная яхта

**Подкатегория:** Semi-Displacement

**Модельный год:** 2002

**Год постройки:** 2001

**Страна:** United Kingdom

## Размеры

**Длина общая:** 43' 3" (13.18m)

**Ширина:** 14' 9" (4.50m)

**Мин. осадка:** 4' 2" (1.27m)

## Скорость, вместимость и масса

**Крейс. скорость:** 10 Kts. (12 MPH)

**Крейсерская скорость поворота:** 1600 Kts.

**Макс. скорость:** 21 Kts. (24 MPH)

**Макс. скорость поворота:** 2800 Kts.

**Водоизмещение:** 33999.69004564 Pounds

**Вместимость воды:** 278.173170756 Gallons

**Вместимость сточного бака:** 32.493162396 Gallons

**Объем топливного бака:** 600.463074196 Gallons

## Размещение

---

Всего кают: 3

Всего коек: 6

Всего ком. состава: 1

## Корпус и палуба

---

Материал корпуса: GRP

Материал палубы: GRP

Дизайнер корпуса: Ken Smith

## Информация о двигателе

---

Двигатели: 2

Производитель: Caterpillar

Модель: 3208TA

Тип двигателя: Inboard

Тип топлива: Diesel

---

# ПОДРОБНОЕ ОПИСАНИЕ

---

## Broker's Comments

---

These legendary trawlers are benchmark for those yachtsmen looking for build weight, quality and comfort. From a hull first launched in 1965, the 42 has been continually improved, and the Europa version with her long flybridge, covered side-decks and clear aft deck is rare to the brokerage market. "Mother Gun" has been routinely serviced, and is the double island forward layout, with the stronger, 375HP Caterpillars putting high teens running on tap. Truly a proper gentleman's nautical motor-carriage.

## Construction

---

*Overall Measured Length: 48'; 14.4' beam inc. 3.6" PP and 1'8" BP.*

*RCD Status: The yacht conforms with the essential safety requirements of Directive 94/25EC (Recreational Craft Directive) and is categorized A - OCEAN.*

*Hull, Deck & Superstructure Construction:*

- White GRP hull, deck and superstructure using isophthalic gelcoats and resins (decks and superstructure are foam-cored for stiffness and insulation.)
- Overhanging "Europa" side-deck and aft deck overhangs.
- Teak-laid side-decks, fly-bridge, stairs to fly-bridge and aft deck.
- Substantial bulwarks, varnished capping rails with scroll ends.
- Semi-displacement hull form with single hard chine and bow vee flattening to run aft, with substantial keel.

## Machinery

---

*Engine & Gearboxes:*

- Located under wheelhouse sole, 2 x Caterpillar 3208TA 375hp 8-cylinder turbo-charged and intercooled diesel engines, developing approx. 375HP @ 2800 RPM.
- Raw water cooled via Groco BVS-1500 strainers and heat exchangers, with freshwater

closed cooling circuit.

- Conventional shaft drive via 2.47:1 TwinDisc MG5601A hydraulic gearboxes.
- Duramax Marine shaft-seals.
- Aqualift 2-stage engine exhaust system.
- Polish chromed throttle and gear selectors at both helms.
- Full engine instrumentation on VDO gauges.

#### *Maintenance & Performance:*

- Engine hours: 459 at April 2015.
- Slow cruising speed: 10 knots @1600 RPM.
- Fast cruising speed: 16 knots @ 2400 RPM.
- Maximum speed: c.21 knots @ 2800 RPM.
- Last serviced: July 2014.

#### *Propulsion & Steering:*

- Teleflex hydraulic wheel steering, with rudder indicators at both helms.
- 2" stainless steel shafts to 4-bladed CJR 27" nickel aluminium bronze propellers with 26" pitch.
- Bronze shaft-support brackets and bronze rudders.
- Bennett electro-hydraulic stainless steel trim tabs with controls at both helms.
- Sleipner Side Power electric bow thruster and stern thruster, with controls at both helms and a handheld remote.

---

## **Electrical Systems**

---

#### *Voltage Systems:*

- 12V DC ships system.
- 220V AC system with ring main supplying 220V sockets throughout yacht, immersion water

heater, microwave oven, etc.

#### *Battery Banks:*

- 12V domestic service batteries.
- 12V engine batteries.
- 12V generator start battery.
- Battery parallel facility.

#### *Battery Chargers:*

- ProMarine 3-stage automatic 50A battery charger.

#### *Alternators:*

- Caterpillar-driven 12V engine alternators.

#### *Generator:*

- Onan 7kW diesel marine generator set.
- Hours run 32 at April 2015, last serviced July 2014.
- Groco BVS-1000 generator raw water strainer.
- Remote control at lower helm station.

#### *Shore Power:*

- Shorepower system & cable, with inlets fore and aft.
- Zinc Saver II 50A galvanic isolator.

---

## **Plumbing Systems**

---

#### *Fresh Water & Water Heating System:*



- There is a pressurised hot and cold water system via a 75 litre Seaward calorifier.
- Groco PST-1 accumulator tank.
- Holding tank to both heads with monitoring system.
- 220V 1500W immersion coil.
- Deckwash to aft deck and deck/anchor wash to foredeck.
- Aft deck shower.

#### *Bilge Pumps:*

- Rule 2000 12V bilge pumps to forward, engine and lazarette bilges (automatic float-switch operation and manual over-ride).
- Whale Gusher 10 Nk.3 manual bilge pump in engine bilge – operation handle at lower helm.
- Float-activated Rule 500 shower drain pump.

#### *Gas system:*

- Storage in vented flybridge locker, with remote Seaward solenoid shut-off at galley.

## **Tankage**

---

#### *Fuel:*

- 2 x mild steel tanks outboard of engines.
- Tank manifold with supply and return valves for fuel switching between tanks, engines and generator.
- Total capacity of 2273 litres / 500 gallons.
- Tank gauge at lower helm.

#### *Fresh water:*

- 2 x aluminium water tanks located forward.

- Total capacity of 1053 litres / 232 gallons.
- Tank gauge at lower helm.

#### *Blackwater holding tank:*

- 123 litre / 27 gallon plastic blackwater holding tank with 12V Sealand macerator discharge.
- Deck discharge facility.
- Tankwatch 4 level monitoring system.

## **Navigation Equipment**

---

#### *Main helm:*

- Raymarine E80 multifunction colour GPS chart plotter.
- Simrad IS15 Speed/Depth/Log multi-display.
- Simrad IS15 digital/analogue Wind display.
- Simrad AP22 autopilot.
- Ritchie Powerdamp steering compass.

#### *Communications:*

- Shipmate RS8400 VHF radio & external speaker.
- Connection for external telephone & TV.

#### *Fly-bridge:*

- Raymarine E80 multifunction colour GPS chart plotter.
- Simrad IS15 Speed/Depth/Log multi-display.
- Simrad IS15 digital/analogue Wind display.
- Simrad AP22 autopilot.
- Ritchie Powerdamp steering compass.

*Communications:*

- Shipmate RS8400 VHF radio & external speaker.

## Domestic Equipment

---

*Galley:*

- Seaward Princess 3-burner stainless steel gas hob.
- Corian sink with Grohe thermostatic mixer tap.
- Waeco Coolmatic MDC-110 12V 110 litre front-opening fridge.
- Vitrifrigo 65 litre chest freezer with Danfoss compressor located in aft lazarette.

*Heads/Shower compartment:*

- Groco electric-flushing WC.
- Basin and separate shower stall.
- Towel radiator.

*Heating & Ventilation:*

- Webasto Thermo 90 diesel fired hydronic/hot-water central heating system with fan outlets in all cabins and thermostatic towel radiator to heads.
- Electronic thermostat control.
- 12V galley fan.
- 12V engine blowers.
- Opening deck hatches with mosquito screens and stainless steel opening port-lights to hull.

*Entertainment:*

- Toshiba LCD TV on mounting bracket at aft end of saloon, with amplified TV AM/FM aerial on flybridge mast.

- Sony CDX-3600 CD/radio.
- Sony X-Plod 120W speakers in saloon deckhead.

#### *Lighting:*

- 12V halogen lighting throughout – both overhead obscured GB lighting panels and down-lights.
- Chrome reading lights to cabins.
- 12V engine bay lighting.

## **Accommodation**

---

#### *Summary of Accommodation:*

- Luxurious accommodation offering 4 berths in 2 cabins with full standing headroom throughout.
- The interior is finished with high quality varnished teak cabinetry, oatmeal cloth upholstery, white Airtex headlinings and parquet floors throughout.
- Curtains and blinds to all cabins with detachable flyscreens.
- Stainless steel catches throughout.
- Cabin lockers lined in cedar wood for freshness.

#### *Description of layout from forwards:*

##### *Forward Cabin:*

Large double centreline berth with drawers beneath berth, and access forward to chain locker. Sideboards to both sides, with port-side hanging locker, and clothes drawers/bureau to starboard. Dressing mirror to aft bulkhead and opening deckhead hatch. Twin reading lights and mini radiator heating outlet with fan switch.

##### *Guest Cabin:*

Located to port opposite heads through teak sliding door, single Pullman-style berth over a double berth, with bedside cabinet, forward hanging locker, opening deckhead hatch, mirror and reading light. Mini radiator heating outlet with fan switch.

#### *Heads:*

Located forward to starboard with an electric Groco marine heads, separated shower area through perspex door and stowage lockers. Corian countertops with Grohe thermostatic mixer tap, wash basin, mirror and towel radiator. Opening deck hatch, Grohe mixer tap shower and teak floor grating.

#### *Galley:*

L-shaped galley area with Corian countertop equipped with a hob, microwave oven and sink. Plentiful stowage in lockers, drawers and cupboards.

#### *Lower helm position:*

Opposite galley to starboard with hinged side deck access door. Upholstered helm seat and fully instrumented console with engine gauges, switches, electric panel and further instruments to deckhead (washers/wipers/etc.).

#### *Saloon:*

Set within the light and comfortable wheelhouse which consists of the helm position to starboard, L-shaped galley to port, bar cabinet and two facing sofas aft, L-shaped to port with storage lockers beneath, and a straight bench to starboard with storage lockers beneath. Teak grabrail to deckhead, solid teak table with folding leaves and bottle stowage. Sliding glazed door leads onto the sheltered aft deck.

#### *Engine Room:*

Accessed through saloon floor traps via ladder, with all systems easily accessed, lighting and ample room to maintain and service the engines and generator. Access door to aft lazarette which houses water heater, freezer, batteries and battery charger, steering gear and has extensive stowage. Further separate storage in after lazarette, with access to rudder stocks, autopilot arm, etc.

---

## Deck Equipment

---

### *General:*

- Wide teak-laid safe decks with high bulwarks.
- Stainless steel and teak rails, with side boarding apertures.
- Stainless steel and teak bathing platform.
- Stainless steel and teak bathing and transom ladders.
- Mast with lifting tackle and boom light.

### *Aft deck:*

- Protective flybridge deckhead overhangs shelter the aft cockpit.
- Twin lazarette access hatches to cockpit sole.
- Moulded stairs with teak treads for flybridge access.
- Hubbel shore-power connection.
- 

### *Anchoring & Mooring Equipment:*

- Twin stainless steel bow anchor rollers.
- 60lbs CQR anchor with 10mm galvanised chain.
- Electric Lofrans Tigress 1000W capstan reversing anchor windlass with controls at both helms and windlass.
- Stainless steel fairleads and mooring cleats.
- Hubbel shore-power connection forward and TV/telephone connection.
- Opacmare electro-hydraulic passarelle.
- Fenders and warps.

### *Covers, Canvas & Cushions:*

- Flybridge console cover, windscreen cover, side-window cover, aft bulkhead cover, deck-hatch covers, flybridge dodgers, aft cockpit dodgers and bimini canvas in beige.
- White fly-bridge seating cushions.

#### *Tender & Outboard:*

- 2011/12 Zodiac 260 Cadet inflatable tender (stored on flybridge aft overhangs – hardly used) – launched from flybridge mast derrick.
- Suzuki 2.2HP outboard engine (stored in after lazarette)

#### *Safety Equipment:*

- Full navigation lights.
- Carbon monoxide alarm to forward cabin.
- Engine temperature, oil, generator operation and bilge alarms.

#### *Fire-fighting equipment:*

- Firefighting system in engine bay (service date unverified).
- Manual fire extinguishers (service date unverified).
- Seaward gas safety cut off solenoid.

---

## **Исключения**

При продаже яхты исключаются личные вещи владельца.

---

## **Отказ от ответственности**

Компания предоставляет описание судна или яхты добросовестно, но не может гарантировать точность этой информации, а также не ручается за техническое состояние. Покупатель должен проинструктировать своих агентов или оценщиков исследовать представленную информацию более подробно, по собственному желанию. Продажа судна или яхты, изменение цены или снятие с продажи будет происходить без предварительного уведомления.

# ФОТОГРАФИИ























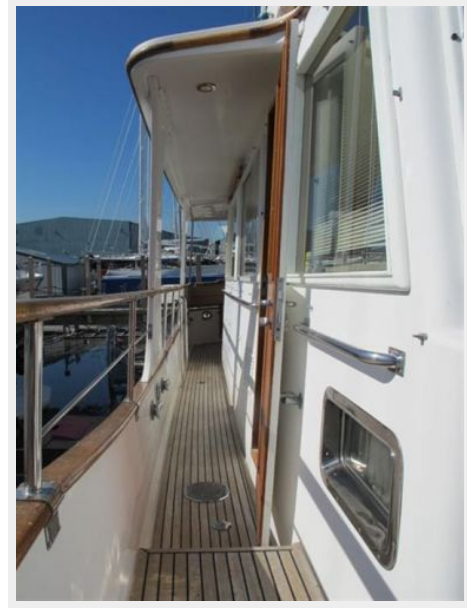





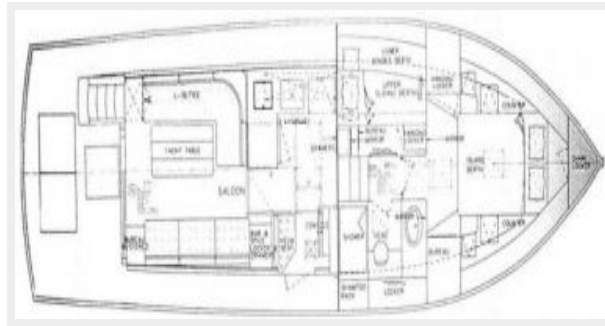

# КОНТАКТЫ

---

Андрей Шестаков (Andrey Shestakov) – ведущий яхтенный брокер отдела продаж яхт и судов компании Shestakov Yacht Sales Inc. Официальный представитель Shestakov Yacht Sales Inc. для русскоговорящих клиентов в центральном офисе компании в Майами/Форт Лодердейл/Флорида/США.

## Контактная информация

---

Email: [andrey@shestakovyachtsales.com](mailto:andrey@shestakovyachtsales.com)

Web: [shestakovyachtsales.com](http://shestakovyachtsales.com)

## Телефоны

---

Краснодарский край: **+7(918)465-66-44**

США, Майами, Флорида: **+1(954)274-4435**

## Время работы

---

Понедельник – Суббота: **9:00 - 21:00**  
EDT

Воскресенье: **Закрыто**

## Адрес

---



Harbour Towne Marina, 850 NE 3rd St,  
STE 213, Dania, FL 33004