

SCOTT FREE V — FLEMING YACHTS



Builder: FLEMING YACHTS

Year Built: 1998

Model: Motor Yacht

Price: PRICE ON APPLICATION

Location: United States

LOA: 55' 0" (16.76m)

Beam: 16' 5" (5.00m)

Max Draft: 5' 0" (1.52m)

Cruise Speed: 10 Kts. (12 MPH)

Max Speed: 17 Kts. (20 MPH)

Our experienced yacht broker, Andrey Shestakov, will help you choose and buy a yacht that best suits your needs **SCOTT FREE V — FLEMING YACHTS** from our catalogue. Presently, at Shestakov Yacht Sales Inc., we have a wide variety of yachts available on our sale's list. We also work in close contact with all the big yacht manufacturers from all over the world.

If you would like to buy a yacht **SCOTT FREE V — FLEMING YACHTS** or would like help answering any questions concerning purchasing, selling or chartering a yacht, please call **+1(954)274-4435**

TABLE OF CONTENTS

TABLE OF CONTENTS	2
SPECIFICATIONS	5
Overview	5
Basic Information	5
Dimensions	5
Speed, Capacities and Weight	5
Accommodations	6
Hull and Deck Information	6
Engine Information	6
DETAILED INFORMATION	7
Accommodations	7
Salon	7
Galley	7
Audio/Video	7
Pilothouse	7
Flybridge	8
Aft Station	8
Electrical systems	8
Deck and Construction Details	8
Canvas	9
Lazarette	9
Bridge Deck	9
Cockpit	9
Mechanical Equipment	9
Remarks	10
Disclaimer	10
Exclusions	10
Disclaimer	10

PHOTOS	11
Salon	11
Salon	11
Salon	11
Galley	11
Galley	11
Full Size Refrigerator	11
Companionway/Steps to Wheelhouse	12
Pilothouse Helm	12
Pilothouse	12
Pilothouse	12
Master Bath	12
Master Stateroom	12
Guest Stateroom	13
Guest Head	13
Aft Deck	13
Guest Stateroom	13
Aft Deck	14
Aft Deck	14
Aft Deck	14
Aft Deck Steering	14
Lazarette	15
Lazarette	15
Lazarette/Watermaker	15
Starboard Generator	15
Port Generator	15
Engine Room	15
Flybridge	16
Flybridge Helm	16

Flybridge	16
Flybridge	16
Covered Tender	16
Tender	16
Outboard	17
Portuguese Bridge	17
Bow	17
Bridge Deck Drawing	17
Main Deck Drawing	17
Accommodations Drawing	17
Pilothouse Drawing	18
Engine Room Drawing	18
Speed/Sound	18
Line Drawings	18
CONTACTS	19
Contact details	19
Telephones	19
Office hours	19
Address	19

SPECIFICATIONS

Overview

VIRTUAL TOUR: <http://yachtprofile.com/ypfl55> **SCOTT FREE V**, 55' Fleming Pilothouse motoryacht, 1997/98 model, and a third owner vessel, is equipped with new twin gens, 3208 CATS, watermaker, dinghy & davit, bow thruster, and Naiad stabilizers. Her layout features 3 staterooms with two heads. **SCOTT FREE V** is located in Fort Lauderdale and easy to show.

Basic Information

Category: Motor Yacht

Sub Category: Raised Pilothouse

Model Year: 1997

Year Built: 1998

Country: United States

Vessel Top: Bimini Top

Fly Bridge: Yes

Cockpit: Yes

Dimensions

LOA: 55' 0" (16.76m)

Beam: 16' 5" (5.00m)

Max Draft: 5' 0" (1.52m)

Speed, Capacities and Weight

Cruise Speed: 10 Kts. (12 MPH)

Cruise Speed RPM: 1500 Kts.

Max Speed: 17 Kts. (20 MPH)

Max Speed RPM: 2800 Kts.

Displacement: 66000 Pounds

Water Capacity: 300 Gallons

Holding Tank: 100 Gallons

Fuel Capacity: 1000 Gallons

Accommodations

Total Cabins: 3

Hull and Deck Information

Hull Material: Fiberglass

Engine Information

Engines: 2

Manufacturer: Caterpillar

Model: 3208 STA

Engine Type: Inboard

Fuel Type: Diesel

DETAILED INFORMATION

Accommodations

The master stateroom is forward featuring a queen Island berth with storage below, two full size hanging lockers, drawer storage, and book shelves with two overhead hatches. The master head includes a sink, vanity, mirror, Headhunter head system, and stall shower with Grohe thermostatic controlled faucet. There is also a Samsung 19" flat-screen TV and KVH SAT TV in the master stateroom. Starboard guest stateroom has upper/lower berth drawers, mirror, and vanity. New bed shams 2009. Port guest stateroom has twin berths, closet, mirror, and drawers. New bed shams 2009. Guest head is forward of the starboard guest stateroom and includes a sink, vanity, mirror, and stall shower with Grohe thermostatic controlled faucet. Asko 220V washer with separate dryer in companionway (new 2007).

Salon

One enters the salon through double opening doors. Looking forward to starboard is an entertainment center for the Vizio 19" flat-screen TV and storage cabinets. To port is a dry bar unit with teak top and icemaker, an L-shaped couch, two salon chairs with new seat cushions in 2011, and a teak hi/lo table. There is an overhead teak rail in the salon which provides a safe handhold. Salon settee sofa cushions and back rest (2014).

Galley

The U-shaped galley is forward of the salon. All appliances are high quality. Equipment includes: Sharp convection microwave oven, 2012 Double sink with disposal Grohe mixer faucets Kenyon deluxe 3-burner cooktop 220V oven under cooktop GE Side-by-side refrigerator/freezer - full size Corian counter tops Dumb waiter to flybridge Ample storage and dish lockers Teak and holly sole Garbage drawer Dishwasher 20-Gallon hot water heater

Audio/Video

Boston Acoustics high fidelity speakers in salon with Kenwood CD player KVH SAT TV in master and salon Vizio 20" flat screen in salon Samsung 19" flat screen TV in master

Pilothouse

From the galley, step up a two-step stairway to the pilothouse, enter and exit from the pilothouse to side decks through sliding doors, or you can go up to the flybridge through a sliding hatch and doors. The pilothouse includes an L-shaped sofa & table, custom Stidd helm chair (redone 04/2015), and ample chart storage in drawers, wet hanging locker, and a full array of flush

mounted electronics. Teak and holly soles throughout, tinted windows, mini blinds, cushions, and linens. Pilothouse settee cushions and back rest (2014) Electronics - Pilothouse: Furuno 7112D radar, 4' antenna, ARP 72-mile radar Furuno depth finder with color sounder 585, 2011 Raymarine chart plotter (A-Series multi) Raymarine E140 multi-function display, 2013 (GPS) ICOM SSB M700 with built-in 30-watt with hailer and remote microphone Standard Horizon GY2100 VHF radio Robertson autopilot AP30 Compass display Heart interface Link 2000 inverter Glendinning synchronizer JVC CD player with two speakers FloScan fuel flow meters B&G digital speed/depth B&G wind speed and direction Wesmar bow thruster control Naiad stabilizer control ACR spotlight Sony black & white monitor with aft flybridge camera and engine room

Flybridge

Raymarine A-Series chart plotter, depth, speed Robertson autopilot remote Wesmar bow thruster control B&G Speed/depth repeaters Garmin GPS Map 700 series ACR searchlight control Synchronizer control Standard VHF Furuno FMD remote display for radar (2011 update) Teak deck in seating area New Bimini canvas (2012) Revere 6-man liferaft Nautica 12' dinghy with Yamaha 40 hp outboard with cover (2010) Quick lift hydraulic 1000 lbs davit (2014) (2) Outrigger poles New flybridge cushions, (2015) Helm cover Console cover Flybridge seating cover Brownies dive compressor in deck box (2011) KVH Trac Vision

Aft Station

Robertson autopilot remote Wesmar bow thruster control Remote fire extinguisher override Engine start/stop (2) Shakespeare 23" VHF antennas. All antennas have stainless mounting hardware

Electrical systems

Northern Lights 12 kW generator, new 2014 (Port 1800 rpm - 5 hours) Northern Lights 9 kW generator, 2013 (Starboard 1800 rpm - 50 hours) AC/DC electrical system AC/DC electrical panel with circuit breakers 24V DC system 220V AC system Gel cell batteries Forward and aft shore connect Paralleling solenoids and switches Battery isolators Cablemaster shore cord reel - aft, 50-amp ProMariner 12-volt charger, 20-amp Victron 24-volt charger, 60 amp Newmar DC converter Heart interface 2500 inverter (2) 30-amp shore plug-in - Bow (1) 50-amp plug-in - Bow

Deck and Construction Details

Vinylester resin below waterline Fiberglass fuel tanks Swim ladder Heavy duty pantograph windshield wipers Halogen deck light on custom mast Stainless steel hardware in pilothouse table Stainless steel transom handrails Stainless steel pulpit handrails Teak deck in cockpit Teak

deck on flybridge Teak bow rail Hinged radar arch 4-Blade props Teak trim, cap rail and cover-board Simulated planking grooves in hull-side Cockpit storage under ladder to flybridge Cockpit controls Stainless steel protective shoe on keel Custom tender chocks with hold downs (4) Rod holders in cockpit Integrally molded guard with stainless rub Bow pulpit, anchor and windlass Pilothouse bulwark doors port and starboard Plow with 250' high test chain Additional anchor with chain/rope Danforth spray rails Foredeck and Portuguese decks non-skid, new 2007 (2) Additional Danforth anchors Lofrans electric windlass Phone & TV plug-in - Bow Bottom sanded, repainted with Seahawk Tropicote (2014) Prop speed shafts, props, struts, rudders, and trim tabs (2014)

Canvas

Bimini top, custom vinyl with stainless steel hardware - new canvas 2012 Flybridge console cover Flybridge helm seat cover Flybridge custom cushions, new 2015 Tender cover, 2012 Bimini extension over seating area on flybridge

Lazarette

Watermakers, Inc., model ISL 300 water maker, 19 gph Fiberglass hatches with teak facing Intake vents for engine room DC lighting Plastic water tanks with sight gauges (4) Cruisair AC compressors in master, guest, salon, and pilothouse Main engine mufflers Vast storage capabilities

Bridge Deck

Plexiglass windshield with stainless handrail Steering console with controls and engine instrumentation Cushioned seating for ten with stowage Molded fiberglass table with stowage space and drink holders Folding hatch doors provides access to the pilothouse Custom mast with KVH antenna Ladder leading down to the cockpit

Cockpit

Teak decks Varnished teak covering boards Deck drains overboard Aft cockpit sunshade cover Cockpit control station Hot and cold shower

Mechanical Equipment

Caterpillar 3208 STA turbo-charges engines, 435 hp (Port engine has fewer hours due to a rebuild that was covered under Caterpillar warranty. Hour meters were not changed). Naiad hydraulic stabilizers Fireboy automatic engine room fire extinguisher Hynautic engine controls at all three helms Hynautic hydraulic steering VD full engine instrumentation Reverse cycle AC with

4-zone SMX controls Wesmar 10 hp, 24V bow thruster Electric oil change system Trim tabs with indicators Manual whale pump Fresh water filter Air Seps installed on main engines

Remarks

SCOTT FREE V, 1997/98 model, and a third owner vessel, is an elegantly styled 55 pilothouse motoryacht, with a semi-displacement hull that has proven to be easily driven as well as extremely comfortable and sea-kindly. The shape of the entry at the bow rolls the water away from the hull and its height and flare keep heavy seas off the deck at all speeds. SCOTT FREE V features twin generators, watermaker, CAT engines, bow thruster, and a 12' dinghy with davit.

Disclaimer

In late November 2013 due to port engine starter motor fire, extensive work was performed and completed (March 2014) throughout the engine room. The CAT engines were serviced and removed in order to complete the necessary work. Most major components were repaired or replaced as necessary. Service records will be available upon request.

Exclusions

Owner's personal belongings.

Disclaimer

The Company offers the details of this vessel or yacht in good faith but cannot guarantee or warrant the accuracy of this information nor warrant the condition of the vessel. A buyer should instruct his representatives, agents, or his surveyors, to investigate such details as the buyer desires validated. This vessel or yacht is offered subject to prior sale, price change, or withdrawal without notice.

PHOTOS

Salon



Salon



Salon



Galley



Galley



Full Size Refrigerator



Companionway/Steps to Wheelhouse



Pilothouse Helm



Pilothouse



Pilothouse



Master Stateroom



Master Bath



Guest Stateroom



Guest Head



Aft Deck



Guest Stateroom



Aft Deck



Aft Deck



Aft Deck

Aft Deck Steering



Lazarette



Lazarette



Lazarette/Watermaker



Starboard Generator



Port Generator



Engine Room



Flybridge



Flybridge Helm



Flybridge



Flybridge



Covered Tender



Tender



Outboard



Portuguese Bridge



Bow



Bridge Deck Drawing

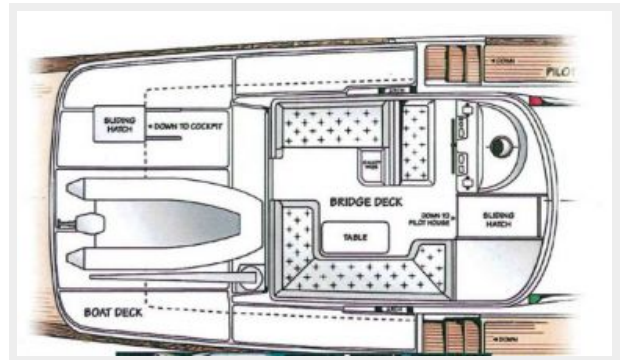

Accommodations Drawing

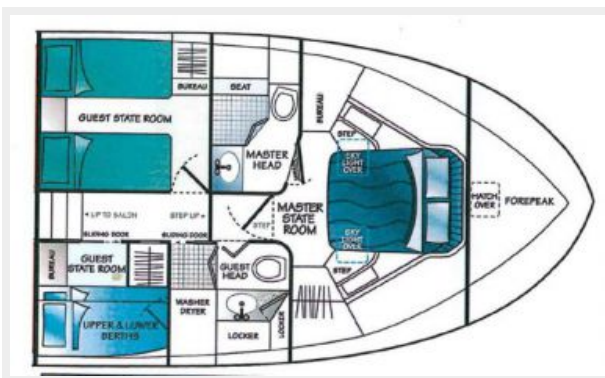

Main Deck Drawing

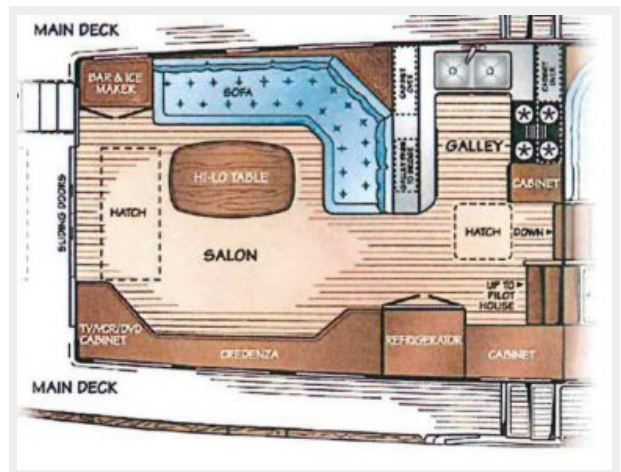

Pilothouse Drawing

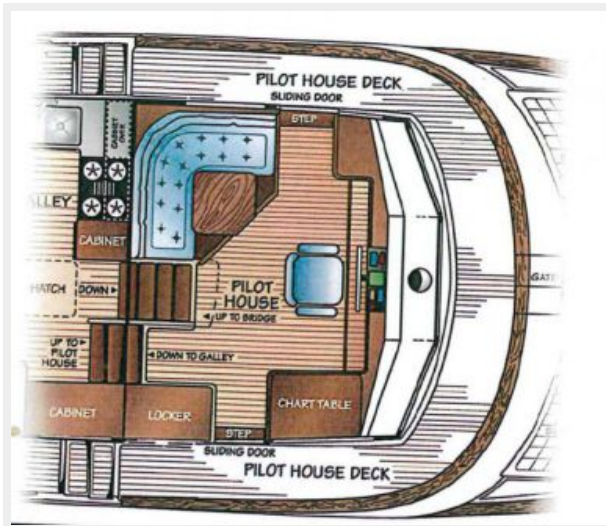

Engine Room Drawing

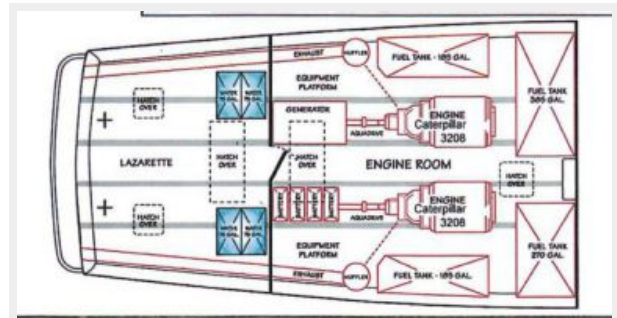

Line Drawings

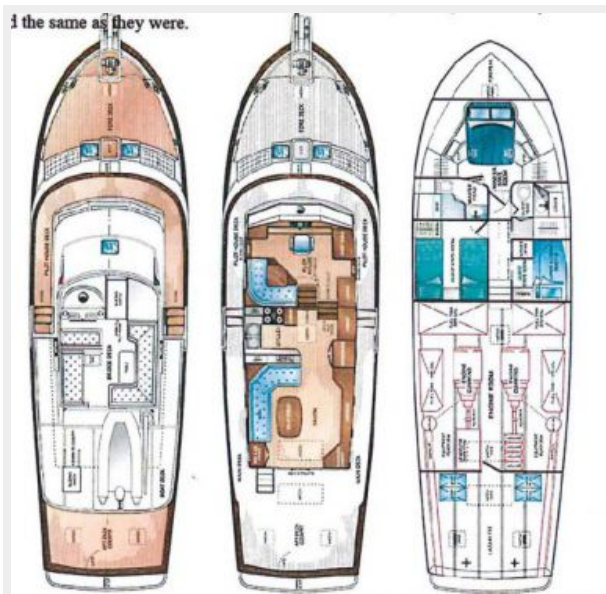

Speed/Sound

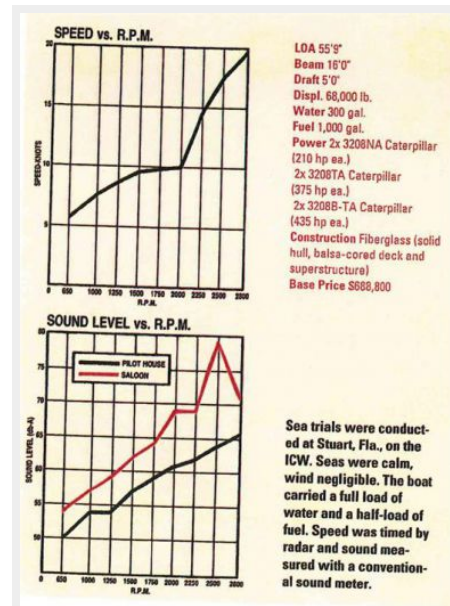

CONTACTS

Andrey Shestakov, leading yacht broker of the sales department of Shestakov Yacht Sales Inc. Shestakov Yacht Sales Inc., the official representative of the Miami/Fort Lauderdale FL headquarters.

Contact details

Email: andrey@shestakovyachtsales.com

Web: shestakovyachtsales.com/en/

Telephones

USA: +1(954)274-4435

Office hours

Monday – Saturday: **9:00 - 21:00** EDT

Sunday: **closed**

Address



Harbour Towne Marina, 850 NE 3rd St,
STE 213, Dania, FL 33004