

MEANWHILE — CAMANO



Builder: CAMANO

Year Built: 2001

Model: Cruiser

Price: PRICE ON APPLICATION

Location: United States

LOA: 31' 0" (9.45m)

Beam: 10' 6" (3.20m)

Max Draft: 3' 3" (0.99m)

Our experienced yacht broker, Andrey Shestakov, will help you choose and buy a yacht that best suits your needs **Meanwhile — CAMANO** from our catalogue. Presently, at Shestakov Yacht Sales Inc., we have a wide variety of yachts available on our sale's list. We also work in close contact with all the big yacht manufacturers from all over the world.

If you would like to buy a yacht **Meanwhile — CAMANO** or would like help answering any questions concerning purchasing, selling or chartering a yacht, please call **+1(954)274-4435**

TABLE OF CONTENTS

TABLE OF CONTENTS	2
SPECIFICATIONS	3
Overview	3
Basic Information	6
Dimensions	6
Speed, Capacities and Weight	6
Accommodations	6
Hull and Deck Information	6
Engine Information	7
PHOTOS	8
CONTACTS	15
Contact details	15
Telephones	15
Office hours	15
Address	15

SPECIFICATIONS

Overview

"Meanwhile"s condition is superb and she is well equipped. She has been kept in a **covered slip** for the past year and features, a pampered, low hour, Volvo diesel, 1500 watt inverter, 16,000 BTU's of A/C, **new electronics package**, custom trim tabs, spotless interior, bilge and engine room, etc., she is cruise ready and turn key. **"Meanwhile"**s original owner was an engineer who had the vessel built, monitored the build and made numerous sensible upgrades to her. This boat is featured in the September 2005 **MOTORBOATING** article "Bahama Bound"!

With her single diesel and large bow thruster, she is easy to maneuver and stingy of fuel. At 7 knots she consumes about 1.5 GPH and at 14 knots about 6 GPH. The unique "keelform" hull will sip fuel and cruise comfortably at a 7 knot displacement speed or reach speeds of 16 knots plus at wide open throttle. Not only does the substantial keel provide full protection for the four bladed prop, it gives the boat the feel of running on rails at all speeds. Docking is a breeze with the large rudder and bow thruster- no more panic leaps to the dock! The Camanos are known for very high quality glass work,(Solid hand laid glass below the waterline and cored with Corecell above the waterline), electro polished stainless steel fittings and no exterior brightwork. The interior joinery is expertly crafted and finished to yacht standards.

"Meanwhile" is truly one of the best designed and best built pocket cruisers you will find. So if you are looking for a well equipped, clean boat, turn key and ready to cruise, this one's for you. She is kept with an "open check book policy" Owners are moving out of boating.

**NOTABLE FEATURES, UPGRADES AND OPTIONS; Canvas and Enclosure new 2015
Optional Trim Tabs A/C Inverter Garmin Color Plotters new 2014 Bow Thruster, 5 HP Twin
Alternators and 5 new AGM batteries Custom Oak Cabin Sole Olsson Dingy Davit**

Boat Name Meanwhile **Dimensions** LOA: 31 ft 0 in Beam: 10 ft 6 in LWL: 28 ft 0 in Maximum Draft: 3 ft 3 in Headroom: 6 ft 3 in Dry Weight: 10000 lbs **Engines** Engine 1: Engine Brand: Volvo Engine Model: TAMD41P Engine Type: Inboard Engine/Fuel Type: Diesel Engine Hours: 989 Engine Power: 200 HP **Tanks** Fresh Water Tanks: (77 Gallons) Fuel Tanks: (100 Gallons) Holding Tanks: (12 Gallons) **Accommodations** Number of heads: 1 **Electrical Equipment** Electrical Circuit: 110V **Outside Equipment/Extras** Electric windlass

Accommodations

Accommodates 8 for cocktails, 6 for dining and sleeps 4 in stateroom and convertible dinette. Clean, traditional and functional. Cockpit deck with lazarette storage below. Very roomy flybridge deck. In the salon you will find a L - shaped settee and table to port, straight ahead to starboard is the lower helm. Large windows all around creates a light and bright feeling. To port step down to the galley, the head to starboard. Master stateroom forward with 5" foam mattress V-berth with fillers, 6'4" headroom. The interior upholstery and curtains are all fresh and in excellent shape, The mahogany trim in the

cabin is well kept.

Hanging Locker Custom A/C vent in head CruiseAir 16,000 BTU Reverse Cycle A/C with SMX digital control (New 2009) Custom V-berth electric fan

Cubby hole and drawer storage in stateroom Convertible dinette, seats 6 for dining Vacuflush head with holding tank and macerator (New pump and sensor 7/2015) Curtains with tie backs Optional Oak Wood cabin sole Casual Rugs Cable TV connection Digital TV Antenna (New 2014) Pilot Chair Flat screen TV

Galley

Nova Cool Refrigerator, 12V/110V Force Ten 3 burner Propane Stove with oven and cutting board cover Microwave Coffee Maker S/S Sink Drawer and cabinet storage Custom storage Pressure water system Hot water heater

Electronics / Helm

LOWER HELM Garmin 441S Color Plotter (New 2014) Raymarine ST6000+ Autopilot with wireless remote Saturn 3" Compass Garmin VHF 200 VHF (New 2012) with wireless remote AM/FM/CD Maxwell remote windlass control Bow thruster control 12 Volt plug

UPPER HELM Garmin 441S Color Plotter Raymarine S100 Wireless Remote for Autopilot (New 2012) Raymarine ST-60 Digital Depth Saturn 5" Compass West Marine VHF 480 (New 2014) AM/FM Radio with USB and IPod input (New 2014)

Garmin GHS 20 Wireless remote VHF (New 2012) Bow thruster control 12 Volt plug Flo Scan Maxwell remote windlass control 3 helm chairs 2 Folding chairs

Electrical

3.5KW Generator (New 2014) Xantrex Freedom Jazz 1500 Inverter Batteries: (5) Group #27 AGM, (New 2015) Charles Auto Battery Charger 20A 3 Stage (New 2013) 30 AMP Shore Power with 2 50' cords AC/DC Electrical panel with upgraded breakers

Mechanical

Volvo TAMD41P-A 200 hp diesel- 989 hours. Fully serviced every 100 hours, and is up to date, (Filters, fluids, impellers and coolant 2/2015). Heat exchanger and coolers pulled (oil cooler replaced) and cleaned 2/2015) All work completed by Blue Water Marine of St. Petersburg. Extensive Receipts and invoices available. The engine and engine room is very clean and reflects it's well maintained condition

Custom twin alternators Belts and some hoses replaced 2014 Fresh water pump (new 2012) Kobelt engine controls, upper and lower Hydraulic steering Dripless shaft seal and cutlass bearing (Replaced 2014) Algae X system

4 Bladed prop Hot water heater (also engine heated) Pressure water system Dual Racor fuel filters with remote vac gauge and warning light at helm

Key Power 5 HP bow thruster 3 Auto-electric bilge pumps (1 new 2015) Quick change raw water pump cover Factory Trim Tabs (New upper and lower toggle controls 2014) Spares

Hull / Deck

New bottom paint 2014 Maxwell Windlass with 2 foot switches and helm remotes Olsson Davit System (New 2014) Bow Pulpit 22 lb Bruce anchor with 120' chain rode (Rode New 2014) Sunbrella Bimini with 3 side enclosure (New 6/2015)

Textalene Windshield Cover Sunbrella Helm Cover Cockpit Shower (Replaced 2013) Transom Door Swim Platform and ladder Large Lazerette storage Ample Hand rails Opening ports and hatch with screens Cockpit Lights Fenders and Lines CG Safety Package

Factory Description

Comfort underway is derived by many factors, one of which is hull shape. The KEELFORM® hull does not “roll” like a full displacement hull form and does not “pound” like a planing hull form. The Camano KEELFORM® is unique. Forward, her stem is deep, as it would be in a displacement hull. Aft, the bottom flattens out into hard chines, just like a planing boat, but has a huge keel and barn-door style rudder that would never be found on a planing yacht. The keel, which provides about 28 percent of the hull’s displacement, is one of the elements of design that makes the Camano an adept performer at any speed.

The 200 hp Volvo® turbo-charged engine is placed deep in the engine compartment, along with the fluid storage. This places the center of gravity lower than in most boats, thus allowing a steady and level ride. Comfort is also derived from the low noise level, when underway, because of a combination of a quiet diesel and a well-insulated engine room.

Brokers Comments

"Meanwhile"s condition is superb and is loaded. With her pampered, low hour, diesel, 1500 watt inverter, 16,000 BTU's of A/C, nice, new electronics package, custom trim tabs, spotless interior, bilge and engine room, etc., she is cruise ready and turn key.

She is featured in the September 2005 MOTORBOATING article "Bahama Bound"! Kept undercover and with an "open check book policy" Owners are moving ashore and

seeking offers.

Basic Information

Category: Cruiser

Model Year: 2001

Year Built: 2001

Country: United States

Cockpit: Yes

Dimensions

LOA: 31' 0" (9.45m)

LWL: 28' 0" (8.53m)

Beam: 10' 6" (3.20m)

Max Draft: 3' 3" (0.99m)

Speed, Capacities and Weight

Displacement: 10000 Pounds

Water Capacity: 77 Gallons

Holding Tank: 12 Gallons

Fuel Capacity: 100 Gallons

Accommodations

Total Cabins: 1

Total Heads: 1

Hull and Deck Information

Hull Material: Fiberglass

Engine Information

Engines: 1

Manufacturer: Volvo

Model: TAMD41P

Engine Type: Inboard

Fuel Type: Diesel

PHOTOS



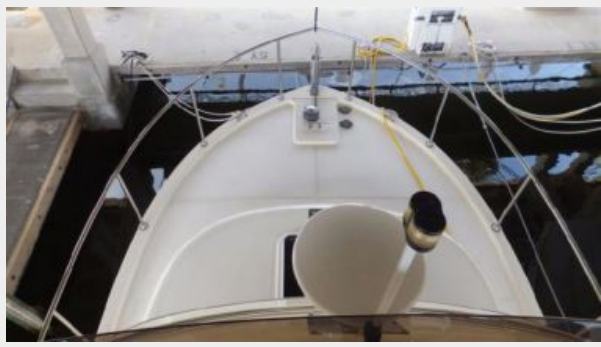









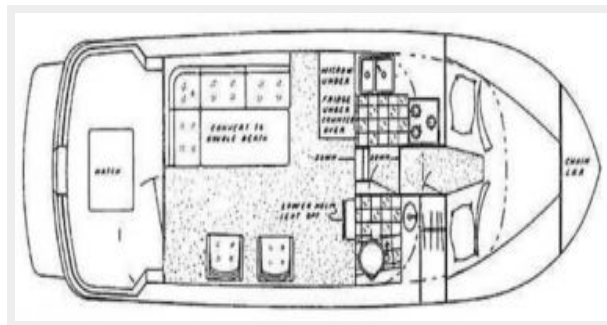

CONTACTS

Andrey Shestakov, leading yacht broker of the sales department of Shestakov Yacht Sales Inc. Shestakov Yacht Sales Inc., the official representative of the Miami/Fort Lauderdale FL headquarters.

Contact details

Email: andrey@shestakovyachtsales.com

Web: shestakovyachtsales.com/en/

Telephones

USA: +1(954)274-4435

Office hours

Monday – Saturday: **9:00 - 21:00** EDT

Sunday: **closed**

Address



Harbour Towne Marina, 850 NE 3rd St,
STE 213, Dania, FL 33004