

## PLAN SEA — SUNSEEKER



**Builder:** SUNSEEKER

**Year Built:** 2006

**Model:** Motor Yacht

**Price:** PRICE ON APPLICATION

**Location:** United Kingdom

**LOA:** 49' 0" (14.94m)

**Beam:** 14' 1" (4.29m)

**Min Draft:** 3' 11" (1.19m)

**Max Draft:** 3' 11" (1.19m)

**Max Speed:** 32 Kts. (37 MPH)

Our experienced yacht broker, Andrey Shestakov, will help you choose and buy a yacht that best suits your needs **PLAN SEA — SUNSEEKER** from our catalogue. Presently, at Shestakov Yacht Sales Inc., we have a wide variety of yachts available on our sale's list. We also work in close contact with all the big yacht manufacturers from all over the world.

If you would like to buy a yacht **PLAN SEA — SUNSEEKER** or would like help answering any questions concerning purchasing, selling or chartering a yacht, please call **+1(954)274-4435**

---

# TABLE OF CONTENTS

---

TABLE OF CONTENTS	2
SPECIFICATIONS	3
Overview	3
Basic Information	3
Dimensions	3
Speed, Capacities and Weight	3
Accommodations	3
Hull and Deck Information	4
Engine Information	4
DETAILED INFORMATION	5
Accommodation	5
Additional	5
Vessel Description	5
Exclusions	5
Disclaimer	5
PHOTOS	7
CONTACTS	11
Contact details	11
Telephones	11
Office hours	11
Address	11

---

# SPECIFICATIONS

---

## Overview

---

The Portofino 47 offers 2 good sized cabins both with en suite facilities and is therefore the perfect boat for long distance cruising. Although a UK boat from new she is also fitted with air conditioning so is more than capable of taking on warmer climes. This boat has been known by us from new and she is a very good example of what is proving to be an extremely popular model.

## Basic Information

---

**Category:** Motor Yacht

**Model Year:** 2006

**Year Built:** 2006

**Country:** United Kingdom

**Vessel Top:** Hardtop

## Dimensions

---

**LOA:** 49' 0" (14.94m)

**Beam:** 14' 1" (4.29m)

**Min Draft:** 3' 11" (1.19m)

**Max Draft:** 3' 11" (1.19m)

## Speed, Capacities and Weight

---

**Max Speed:** 32 Kts. (37 MPH)

**Displacement:** 35999.28276198 Pounds

**Water Capacity:** 89.81849768 Gallons

**Fuel Capacity:** 346.06538812 Gallons

## Accommodations

---

**Total Berths:** 2

---

## Hull and Deck Information

---

**Hull Material:** GRP

**Hull Color:** White with dark blue hull band

---

## Engine Information

---

**Engines:** 2

**Manufacturer:** Volvo

**Model:** D9 EVC

**Fuel Type:** Diesel

# DETAILED INFORMATION

---

## Accommodation

---

2 large cabins both of which feature en suite access. The forward cabin is presented in stunning satin Cherry satin with contrasting bed cover and scatter cushions. The master cabin ensuite is accessed by a door to the foot of the bed, the stunning porcelain wash basins are mounted on top of granite work-tops. Moving aft to the guest cabin you will find two single berths again fitted with contrasting bed covers to the Satin Cherry wood. You will find a large wardrobe located adjacent to the en suite access that offers ample hanging and storage space. The en suite boasts a full sized pull round shower cubicle and as per the forward cabin and free standing sink shown in the pictures below. Both cabins feature LCD televisions with the ability to play DVD's.

## Additional

---

16kg Delta anchor 6 place crockery set Royal Doulton Additional 30m anchor chain Air Conditioning - 1 x 7000 BTU - 1 x 16000 BTU Bose 321 in Saloon Bow Sunbathing Cushions Bow Thruster - Volvo Penta BP 900 -7hp Cockpit ceramic electric Griddle - AEG Competence Colour Radar Chartplotter with Raystar 125 GPS Diff receiver and 4kw 24" Radome in lieu of std Electric Anchor winch Lewmar V2 GD-12v Electric refrigerator 12v Coolmatic RD110F 110ltr Galley top in Avonite in lieu of Cherry Generator Upgraded to Kohler 6.5kw 50Hz (6.5EFOZD) in lieu of standard 4kw Hardtop LCD television to Guest cabin with DVD player 15" Aquos LCD television to Master cabin with DVD player Sharp 15" Aquos LCD television to Saloon Sharp 20" Aquos Microwave/Grill Panasonic NNGD5666MRaymarine E120 -12.1" Seafire FM200 system Teak Cabin Stair Treads Teak Cockpit Decking Volvo Service history

## Vessel Description

---

The Portofino 47 offers 2 good sized cabins both with en suite facilities and is therefore the perfect boat for long distance cruising. Although a UK boat from new she is also fitted with air conditioning so is more than capable of taking on warmer climes. This boat has been known by us from new and she is a very good example of what is proving to be an extremely popular model.

## Exclusions

---

Owner's personal belongings.

## Disclaimer

---

The Company offers the details of this vessel or yacht in good faith but cannot guarantee or

warrant the accuracy of this information nor warrant the condition of the vessel. A buyer should instruct his representatives, agents, or his surveyors, to investigate such details as the buyer desires validated. This vessel or yacht is offered subject to prior sale, price change, or withdrawal without notice.

# PHOTOS

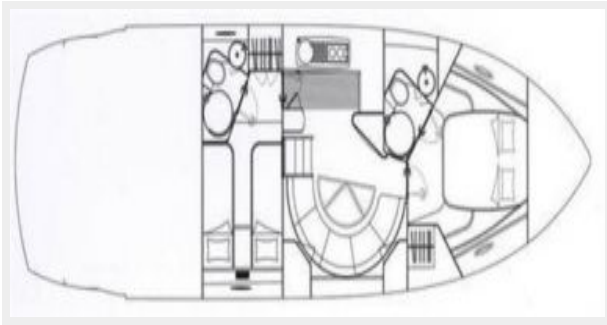











# CONTACTS

---

Andrey Shestakov, leading yacht broker of the sales department of Shestakov Yacht Sales Inc. Shestakov Yacht Sales Inc., the official representative of the Miami/Fort Lauderdale FL headquarters.

## Contact details

---

Email: [andrey@shestakovyachtsales.com](mailto:andrey@shestakovyachtsales.com)

Web: [shestakovyachtsales.com/en/](http://shestakovyachtsales.com/en/)

## Telephones

---

USA: +1(954)274-4435

## Office hours

---

Monday – Saturday: **9:00 - 21:00** EDT

Sunday: **closed**

## Address

---



Harbour Towne Marina, 850 NE 3rd St,  
STE 213, Dania, FL 33004