

RAPTOR — SUNSEEKER



Builder: SUNSEEKER

Year Built: 2007

Model: Motor Yacht

Price: PRICE ON APPLICATION

Location: Malta

LOA: 49' 1" (14.96m)

Beam: 14' 1" (4.29m)

Min Draft: 3' 11" (1.19m)

Max Draft: 3' 11" (1.19m)

Max Speed: 35 Kts. (40 MPH)

Our experienced yacht broker, Andrey Shestakov, will help you choose and buy a yacht that best suits your needs **RAPTOR — SUNSEEKER** from our catalogue. Presently, at Shestakov Yacht Sales Inc., we have a wide variety of yachts available on our sale's list. We also work in close contact with all the big yacht manufacturers from all over the world.

If you would like to buy a yacht **RAPTOR — SUNSEEKER** or would like help answering any questions concerning purchasing, selling or chartering a yacht, please call **+1(954)274-4435**

TABLE OF CONTENTS

TABLE OF CONTENTS	2
SPECIFICATIONS	4
Overview	4
Basic Information	4
Dimensions	4
Speed, Capacities and Weight	4
Accommodations	4
Hull and Deck Information	5
Engine Information	5
DETAILED INFORMATION	6
Accommodation	6
Additional	6
Vessel Description	6
Exclusions	6
Disclaimer	6
PHOTOS	8
IMG_6712 (Copy).jpeg	8
IMG_6710 (Copy).jpeg	8
IMG_6521 (Copy).jpeg	8
IMG_6515 (Copy).jpeg	8
IMG_6491 (Copy).jpeg	8
IMG_6512 (Copy).jpeg	9
IMG_6501 (Copy).jpeg	9
IMG_6488 (Copy).jpeg	9
IMG_6439 (Copy).jpeg	9
IMG_6452 (Copy).jpeg	9
IMG_6696 (Copy).jpeg	10
IMG_6469 (Copy).jpeg	10

CONTACTS	11
Contact details	11
Telephones	11
Office hours	11
Address	11

SPECIFICATIONS

Overview

"RAPTOR" is a fantastic example of the stunning Sunseeker Portofino 47. Look no further - "RAPTOR" offers everything in your perfect boat. She benefits from a huge specification with the very popular Cherry Satin Wood interior. Moving up towards the Cockpit she has everything covered from her sliding hard top roof, hydraulic bathing platform, passerelle, air conditioning & generator! She also offers the more powerful Volvo Penta D9 575hp diesel engines which give a fantastic maximum speed of up to 35 knots. Viewing is highly recommended, please do not hesitate to contact us for further information.

Basic Information

Category: Motor Yacht

Model Year: 2007

Year Built: 2007

Country: Malta

Vessel Top: Hardtop

Dimensions

LOA: 49' 1" (14.96m)

Beam: 14' 1" (4.29m)

Min Draft: 3' 11" (1.19m)

Max Draft: 3' 11" (1.19m)

Speed, Capacities and Weight

Max Speed: 35 Kts. (40 MPH)

Displacement: 36155.810968 Pounds

Water Capacity: 89.81849768 Gallons

Fuel Capacity: 346.06538812 Gallons

Accommodations

Total Berths: 4

Hull and Deck Information

Hull Material: GRP

Hull Color: White hull with black hull band
and black boot top line

Engine Information

Engines: 2

Manufacturer: Volvo

Model: D9

Fuel Type: Diesel

DETAILED INFORMATION

Accommodation

This vessel has 2 spacious Cabins fitted. These Cabins comprise of a forward double VIP Cabin with full ensuite and amidship Twin Guest Cabin with ensuite facilities. With a spacious Saloon and Galley area to dine, and another option to use the vast space and seating in the Cockpit, there is plenty of space to entertain guests aboard.

Additional

4x Underwater Lights Aft Cockpit cover (navy blue) Air conditioning Alpine CD player with remote to Helm position Automatic bilge pumps Automatic fire extinguishers Bose 321 surround sound Bow cushion cover in white vinyl Cockpit drinks cooler Cockpit griddle Electric anchor winch Electric hard top Electric side window Full wet bar Helm dash panel with wood effect Holding tank Horn Hot & cold transom shower Hot & cold water system Hydraulic 2.5 metre telescopic gangway passerelle with teak walkway Hydraulic bathing platform Kohler generator KVH M3 trac vision Lewmar bow thruster New batteries Raritan Cockpit ice maker Raymarine E120 Raymarine ST 6002 smart pilot Raymarine ST60+ auto Helm Raymarine VHF Sharp LCD HD Aquos TV to aft Cabin Sharp LCD HD Aquos TV to forward Cabin Sharp LCD HD TV to Saloon Stern thruster Swimming ladder Teak Cockpit Teak Cockpit folding table Teak Galley flooring Teak Saloon stair treads Teak swim platform Tender chocks Vacuum toilets

Vessel Description

"RAPTOR" is a fantastic example of the stunning Sunseeker Portofino 47. Look no further - "RAPTOR" offers everything in your perfect boat. She benefits from a huge specification with the very popular Cherry Satin Wood interior. Moving up towards the Cockpit she has everything covered from her sliding hard top roof, hydraulic bathing platform, passerelle, air conditioning & generator! She also offers the more powerful Volvo Penta D9 575hp diesel engines which give a fantastic maximum speed of up to 35 knots. Viewing is highly recommended, please do not hesitate to contact us for further information.

Exclusions

Owner's personal belongings.

Disclaimer

The Company offers the details of this vessel or yacht in good faith but cannot guarantee or warrant the accuracy of this information nor warrant the condition of the vessel. A buyer should

instruct his representatives, agents, or his surveyors, to investigate such details as the buyer desires validated. This vessel or yacht is offered subject to prior sale, price change, or withdrawal without notice.

PHOTOS

IMG_6712 (Copy).jpeg

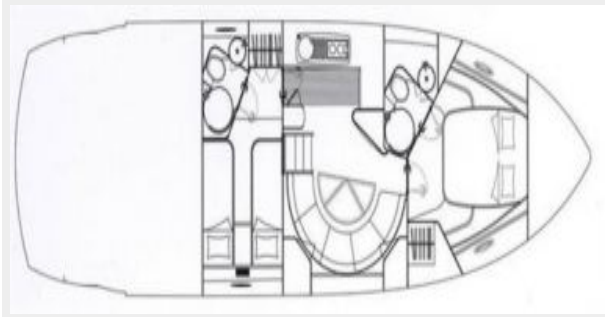

IMG_6710 (Copy).jpeg



IMG_6521 (Copy).jpeg



IMG_6515 (Copy).jpeg



IMG_6491 (Copy).jpeg



IMG_6512 (Copy).jpeg



IMG_6501 (Copy).jpeg



IMG_6488 (Copy).jpeg



IMG_6439 (Copy).jpeg



IMG_6452 (Copy).jpeg



IMG_6696 (Copy).jpeg



IMG_6469 (Copy).jpeg



CONTACTS

Andrey Shestakov, leading yacht broker of the sales department of Shestakov Yacht Sales Inc. Shestakov Yacht Sales Inc., the official representative of the Miami/Fort Lauderdale FL headquarters.

Contact details

Email: andrey@shestakovyachtsales.com

Web: shestakovyachtsales.com/en/

Telephones

USA: +1(954)274-4435

Office hours

Monday – Saturday: **9:00 - 21:00** EDT

Sunday: **closed**

Address



Harbour Towne Marina, 850 NE 3rd St,
STE 213, Dania, FL 33004