

BOY TOY — SUNSEEKER



Builder: SUNSEEKER

Year Built: 2008

Model: Motor Yacht

Price: PRICE ON APPLICATION

Location: Portugal

LOA: 65' 0" (19.81m)

Beam: 17' 7" (5.35m)

Min Draft: 10' 6" (3.18m)

Max Draft: 10' 6" (3.18m)

Max Speed: 34 Kts. (39 MPH)

Our experienced yacht broker, Andrey Shestakov, will help you choose and buy a yacht that best suits your needs **BOY TOY — SUNSEEKER** from our catalogue. Presently, at Shestakov Yacht Sales Inc., we have a wide variety of yachts available on our sale's list. We also work in close contact with all the big yacht manufacturers from all over the world.

If you would like to buy a yacht **BOY TOY — SUNSEEKER** or would like help answering any questions concerning purchasing, selling or chartering a yacht, please call **+1(954)274-4435**

TABLE OF CONTENTS

TABLE OF CONTENTS	2
SPECIFICATIONS	3
Overview	3
Basic Information	3
Dimensions	3
Speed, Capacities and Weight	3
Accommodations	3
Hull and Deck Information	4
Engine Information	4
DETAILED INFORMATION	5
Accommodation	5
Additional	5
Vessel Description	5
Exclusions	5
Disclaimer	6
PHOTOS	7
CONTACTS	10
Contact details	10
Telephones	10
Office hours	10
Address	10

SPECIFICATIONS

Overview

The low profile look of the Sunseeker Predator 72, one of the most popular Predator models "BOY TOY" is a well maintained edition with no expense spared on options and maintenance since her hand over in 2008. The distinctive black hull has been meticulously looked after. The more popular 4 cabin layout below decks with additional Pullman cabin in lieu of the lower Saloon and large sunbathing pad with lager garage option also. "BOY TOY" will not disappoint any perspective purchaser, viewing is highly recommended. Call our Mallorca office today to arrange a viewing.

Basic Information

Category: Motor Yacht

Model Year: 2008

Year Built: 2008

Country: Portugal

Vessel Top: Hardtop

Dimensions

LOA: 65' 0" (19.81m)

Beam: 17' 7" (5.35m)

Min Draft: 10' 6" (3.18m)

Max Draft: 10' 6" (3.18m)

Speed, Capacities and Weight

Max Speed: 34 Kts. (39 MPH)

Displacement: 118829.159218 Pounds

Water Capacity: 208.69592108 Gallons

Fuel Capacity: 1030.2710028 Gallons

Accommodations

Total Berths: 8

Crew Berths: 2

Hull and Deck Information

Hull Material: Other

Engine Information

Engines: 2

Manufacturer: MAN

Model: 1550

Fuel Type: Diesel

DETAILED INFORMATION

Accommodation

Large aft Cockpit with fixed sunpad above the tender garage. Entrance to the upper Saloon through a 3 pane Cockpit doors. Large Saloon seating around a convertible dining table the starboard side with rise and fall television on the port side. Moving down stairs into the well positioned Galley. Going forward we have a Pullman cabin to the port side while on the starboard side we have day head and en suite for the well sized starboard twin cabin. Going further forward we have the double VIP cabin with en suite. Back at the Galley we pass aft to the full beam owners cabin with en suite.

Additional

2 x G6 dummy domes Anchor Chain - Additional 30mtrs. Of 10 mm Big sunbathing area in Cockpit in stern zone Bow sunbathing cushions Electric Canopy for aft Cockpit Compass swinging and adjustment with correcting card Crew cabin fit out installation with air conditioning 1 x 7000btu Extended Galley bar Extra Pair 12"stern Mooring cleats fitted to the AFT lower edge of the Hull Band Fire and bilge flood monitoring alarm system 7 zone Fridge Miele KFN 9753 id integrated refrigerator/Freezer upgrade Glendinning cable master- 220v Low level side deck lights Helm dash Panels in carbon fibre Port Pullman cabin option Raymarine Autopilot system ST8002+ Raymarine E120-12.1 additional colour display Raymarine E120-12.1 colour radar chartplotter on lower console with E120-12,1 Raymarine Ray 240E class D-DSC VHF Roman Blinds in guest cabin Safe 2 brick with digital lock Shipping cover Sleipner stern thruster Tender recovery roller system Washer/Dryer in locker under companionway steps Wine cooler in Saloon Yacht controller system with remote control

Vessel Description

The low profile look of the Sunseeker Predator 72, one of the most popular Predator models "BOY TOY" is a well maintained edition with no expense spared on options and maintenance since her hand over in 2008. The distinctive black hull has been meticulously looked after. The more popular 4 cabin layout below decks with additional Pullman cabin in lieu of the lower Saloon and large sunbathing pad with lager garage option also. "BOY TOY" will not disappoint any perspective purchaser, viewing is highly recommended. Call our Mallorca office today to arrange a viewing.

Exclusions

Owner's personal belongings.

Disclaimer

The Company offers the details of this vessel or yacht in good faith but cannot guarantee or warrant the accuracy of this information nor warrant the condition of the vessel. A buyer should instruct his representatives, agents, or his surveyors, to investigate such details as the buyer desires validated. This vessel or yacht is offered subject to prior sale, price change, or withdrawal without notice.

PHOTOS

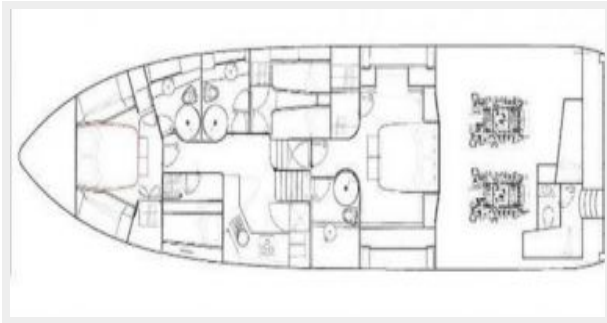





CONTACTS

Andrey Shestakov, leading yacht broker of the sales department of Shestakov Yacht Sales Inc. Shestakov Yacht Sales Inc., the official representative of the Miami/Fort Lauderdale FL headquarters.

Contact details

Email: andrey@shestakovyachtsales.com

Web: shestakovyachtsales.com/en/

Telephones

USA: +1(954)274-4435

Office hours

Monday – Saturday: **9:00 - 21:00** EDT

Sunday: **closed**

Address



Harbour Towne Marina, 850 NE 3rd St,
STE 213, Dania, FL 33004