

THINK BIG — CAMANO



Builder: CAMANO

Year Built: 2003

Model: Trawler

Price: PRICE ON APPLICATION

Location: United States

LOA: 31' 0" (9.45m)

Beam: 10' 6" (3.20m)

Max Draft: 3' 6" (1.07m)

Cruise Speed: 12 Kts. (14 MPH)

Max Speed: 17 Kts. (20 MPH)

Our experienced yacht broker, Andrey Shestakov, will help you choose and buy a yacht that best suits your needs **Think Big — CAMANO** from our catalogue. Presently, at Shestakov Yacht Sales Inc., we have a wide variety of yachts available on our sale's list. We also work in close contact with all the big yacht manufacturers from all over the world.

If you would like to buy a yacht **Think Big — CAMANO** or would like help answering any questions concerning purchasing, selling or chartering a yacht, please call +1(954)274-4435

TABLE OF CONTENTS

TABLE OF CONTENTS	2
SPECIFICATIONS	5
Overview	5
Basic Information	5
Dimensions	5
Speed, Capacities and Weight	5
Accommodations	6
Hull and Deck Information	6
Engine Information	6
DETAILED INFORMATION	7
31' Camano Overview	7
31' Camano Vessel Walkthrough	7
31' Camano Accommodations	7
31' Camano Salon	7
31' Camano Galley	7
31' Camano Dining	8
31' Camano Stateroom	8
31' Camano Flybridge	8
31' Camano Aftdeck	8
31' Camano Audio/Visual Equipment	8
31' Camano Electronics	8
31' Camano Electrical System	9
31' Camano Engine/Mechanical Equipment	9
31' Camano Deck Equipment	10
31' Camano Fire & Safety Protection	10
31' Camano Disclaimer	11
Exclusions	11
Disclaimer	11

PHOTOS	12
31' Camano anchor windlass	12
31' Camano foredeck	12
31' Camano port side deck	12
31' Camano foredeck aft	12
31' Camano starboard side deck	13
31' Camano flybridge forward	13
31' Camano flybridge aft	13
31' Camano flybridge helm	13
31' Camano salon forward photo1	13
31' Camano salon forward photo2	13
31' Camano salon table	14
31' Camano salon aft	14
31' Camano lower helm	14
31' Camano galley photo1	14
31' Camano galley photo2	14
31' Camano galley photo3	14
31' Camano stateroom photo1	15
31' Camano stateroom photo2	15
31' Camano head	15
31' Camano engine compartment access	15
31' Camano main engine	15
31' Camano gearbox	15
31' Camano Algae-X fuel conditioning system	16
31' Camano Racor fuel filters	16
31' Camano water heater	16
31' Camano electrical panel	16
31' Camano inverter/charger	16
31' Camano layout	16

CONTACTS	17
-----	-----
Contact details	17
-----	-----
Telephones	17
-----	-----
Office hours	17
-----	-----
Address	17
-----	-----

SPECIFICATIONS

Overview

2003 31' Camano Troll Trawler

Think Big is a 2003 31' Camano Troll fast trawler model in very nice condition. She offers a single, fuel efficient 200 hp Volvo Penta main engine, Sea Power Technologies engine driven 5 kW generator, Magnum inverter, bow thruster, upper and lower helms, custom bamboo salon sole and low maintenance exterior. Think Big would be a perfect Great Loop cruiser. Seller is a two boat owner, so Think Big needs a new owner.

Basic Information

Category: Trawler

Sub Category: Sedan

Model Year: 2003

Year Built: 2003

Country: United States

Vessel Top: Open W/Bimini

Fly Bridge: Yes

Dimensions

LOA: 31' 0" (9.45m)

Beam: 10' 6" (3.20m)

Max Draft: 3' 6" (1.07m)

Clearance: 12' 7" (3.84m)

Speed, Capacities and Weight

Cruise Speed: 12 Kts. (14 MPH)

Max Speed: 17 Kts. (20 MPH)

Displacement: 10000 Pounds

Water Capacity: 77 Gallons

Holding Tank: 11 Gallons

Fuel Capacity: 133 Gallons

Accommodations

Total Cabins: 1

Total Berths: 3

Sleeps: 4

Total Heads: 1

Hull and Deck Information

Hull Material: Fiberglass

Deck Material: Composite Fiberglass

Hull Configuration: Modified Deep Vee

Hull Color: White

Hull Finish: Plastic

Engine Information

Engines: 1

Manufacturer: Volvo Penta

Model: TAMD 41P-A

Engine Type: Inboard

Fuel Type: Diesel

DETAILED INFORMATION

31' Camano Overview

2003 31' Camano Troll Trawler

Think Big is a 2003 31' Camano Troll fast trawler model in very nice condition. She offers a single, fuel efficient 200 hp Volvo Penta main engine, Sea Power Technologies engine driven 5 kW generator, Magnum inverter, bow thruster, upper and lower helms, custom bamboo salon sole (2014) and low maintenance exterior. Think Big would be a perfect Great Loop cruiser. Seller is a two boat owner, so Think Big needs a new owner.

31' Camano Vessel Walkthrough

From the fiberglass swimplatform, enter the aftdeck through the transom door and either use the ladder to the flybridge or enter the salon, where you will find a settee and table to port, cabinetry to starboard, lower helm starboard forward and entertainment center/cabinetry port forward. Step down and you will find the galley to port, head to starboard and the stateroom forward. Engine room access is via a hatch in the salon sole.

31' Camano Accommodations

Think Big offers a stateroom forward with a v-berth and insert. The salon settee also converts to a double size berth.

31' Camano Salon

The open and airy salon offers an entertainment center and cabinetry port forward, settee with hi/lo folding table to port, cabinetry to starboard, custom bamboo sole (2014), opening side and aft windows with screens, fans and reading lights.

31' Camano Galley

The galley is down and to port.

- Nova-Kool refrigerator/freezer
- Oster toaster oven (2013)
- Force 10 2-burner gas cooktop

- Stainless steel sink with new faucet (2014)
- Storage cabinets and drawers
- Vinyl sole

31' Camano Dining

Dining space is available at the salon settee/table.

31' Camano Stateroom

The stateroom is located forward and offers a v-berth with insert, fan, reading lights, overhead hatch with Oceanair shade/screen, shelves, storage drawers, hanging locker, 2 portlights with curtains and carpet.

31' Camano Flybridge

The large flybridge offers a helm forward, three helmseats, bimini, deck chairs, deck storage box, non-skid deck and 2 rod holders.

31' Camano Aftdeck

31' Camano Aftdeck

The aftdeck offers a non-skid deck, transom door to the fiberglass swimplatform, lazarette access, steps to each side deck, propane locker and stainless steel ladder to the flybridge.

31' Camano Audio/Visual Equipment

- Shakespeare Seawatch HD TV antenna
- Samsung flat screen TV in the salon
- Kenwood KDC-116S stereo/CD player in the salon
- Aquatronics speakers

31' Camano Electronics

- Garmin HD18 Radar (2013)
- Garmin 4210 GPSMap multi-function display on the flybridge (2014)
- Garmin 541s GPSMap chart plotter at the lower helm
- Garmin GHC10 autopilot at both helms (2013)
- Garmin GSD-22 networked depth sounder/fish finder at each helm (2015)
- Garmin aft view camera
- Standard Horizon Matrix AIS/GPS VHF at the lower helm (2015)
- Standard Horizon Ram 3 remote VHF mic on the flybridge (2015)
- Aqua Meter magnetic compass at both helms

31' Camano Electrical System

- SeaPower Power Technologies 5 kW engine driven generator
- 12vdc outlets in the salon, at the lower helm and on the flybridge
- Magnum MS2812 inverter/charger
- 30 amp shore cord
- 2 X 6vdc 400AH AGM batteries (2013)
- 12vdc Group 27 AGM start battery (2013)

31' Camano Engine/Mechanical Equipment

- Single Volvo Penta TAMD 41P-A 200 hp main engine
- ZF Hurth HS45A gearbox
- Kobelt engine controls
- Tides Marine driplless shaft seal
- Dual Racor fuel filters
- Algae-X fuel conditioning system
- Seastar hydraulic steering system

- Keypower bowthruster
- Marine Air Systems reverse cycle air conditioning/heating system
- West Marine 50 psi fresh water system pump
- Kuuma 6 gallon stainless steel water heater (2015)
- Buyer's choice of composting or electric head
- Line cutter
- Bottom painted in 2015
- Hull compounded and waxed in 2015 -All blackwater system hoses are new

31' Camano Deck Equipment

- Maxwell anchor windlass with foot controls and remote controls at each helm (2013)
- GTS stainless steel 14 kg anchor with 200' anchor chain
- Spare Danforth anchor
- Non-skid decks
- Stainless steel rails
- Stainless steel deck hardware
- Bomar deck hatch
- Windshield and window covers
- Raw water washdown (2013)
- Hot/cold fresh water shower
- Stainless steel swim ladder
- Aftdeck flood light
- Weaver swimplatform davit system (2013)

31' Camano Fire & Safety Protection

- Fireboy FE241 engine room fire suppression system

- Fireboy emergency engine shutdown system
- Fire extinguishers
- Lifering
- Galley propane control panel
- Rule bilge pumps
- GoLight searchlight
- Garmin aftdeck camera

31' Camano Disclaimer

The Company offers the details of this vessel in good faith but cannot guarantee or warrant the accuracy of this information nor warrant the condition of the vessel. A buyer should instruct his agents, or his surveyors, to investigate such details as the buyer desires validated. This vessel is offered subject to prior sale, price change, or withdrawal without notice.

Exclusions

Owner's personal belongings.

Disclaimer

The Company offers the details of this vessel or yacht in good faith but cannot guarantee or warrant the accuracy of this information nor warrant the condition of the vessel. A buyer should instruct his representatives, agents, or his surveyors, to investigate such details as the buyer desires validated. This vessel or yacht is offered subject to prior sale, price change, or withdrawal without notice.

PHOTOS

31' Camano anchor windlass



31' Camano foredeck



31' Camano foredeck aft



31' Camano port side deck



31' Camano starboard side deck



31' Camano flybridge forward



31' Camano flybridge aft



31' Camano flybridge helm



31' Camano salon forward photo1



31' Camano salon forward photo2



31' Camano salon aft



31' Camano salon table



31' Camano lower helm



31' Camano galley photo1



31' Camano galley photo2



31' Camano galley photo3



31' Camano stateroom photo1



31' Camano stateroom photo2



31' Camano head



31' Camano engine compartment access



31' Camano main engine



31' Camano gearbox



31' Camano Racor fuel filters



31' Camano Algae-X fuel conditioning system



31' Camano water heater



31' Camano electrical panel



31' Camano inverter/charger



31' Camano layout

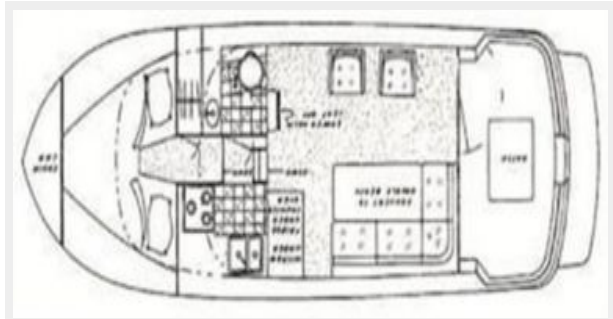

CONTACTS

Andrey Shestakov, leading yacht broker of the sales department of Shestakov Yacht Sales Inc. Shestakov Yacht Sales Inc., the official representative of the Miami/Fort Lauderdale FL headquarters.

Contact details

Email: andrey@shestakovyachtsales.com

Web: shestakovyachtsales.com/en/

Telephones

USA: +1(954)274-4435

Office hours

Monday – Saturday: **9:00 - 21:00** EDT

Sunday: **closed**

Address



Harbour Towne Marina, 850 NE 3rd St,
STE 213, Dania, FL 33004