

MAGRATHEA — OYSTER YACHTS



Судостроитель: [Oyster Yachts](#)

Год постройки: 2009

Модель: Cruising/Racing Sailboat

Цена: ЦЕНА ЯХТЫ ПО ЗАПРОСУ

Местонахождение: United States

Длина общая: 72' 0" (21.95m)

Ширина: 19' 4" (5.89m)

Макс. осадка: 9' 4" (2.84m)

Купить **MAGRATHEA — Oyster Yachts** а также выбрать подходящую вам яхту из нашего каталога яхт вам поможет опытный яхтенный брокер Андрей Шестаков. На сегодняшний день компания **Shestakov Yacht Sales Inc.** имеет большое количество яхт в собственном списке продаж, а также тесно сотрудничает со всеми крупными яхтенными производителями по всему миру.

Для того чтобы купить яхту **MAGRATHEA — Oyster Yachts** а также проконсультироваться по любому вопросу связанному с покупкой, продажей, чартером яхт позвоните по телефону **+7(918)465-66-44**.

ОГЛАВЛЕНИЕ

ОГЛАВЛЕНИЕ	2
ХАРАКТЕРИСТИКИ	4
Обзор	4
Основная информация	4
Размеры	4
Скорость, вместимость и масса	4
Размещение	4
Корпус и палуба	4
Информация о двигателе	5
ПОДРОБНОЕ ОПИСАНИЕ	6
COMMENTS	6
CONSTRUCTION	6
DECK LAYOUT AND EQUIPMENT	7
DECK PLUMBING	7
COCKPIT	7
RIG AND SAIL HANDLING	9
INTERIOR	10
ENTERTAINMENT	12
TANKAGE AND PLUMBING	13
MECHANICAL AND ENGINEERING	13
ELECTRICAL	14
NAVIGATION AND COMMUNICATION	15
SAFETY	15
GENERAL	16
Исключения	16
Отказ от ответственности	16
ФОТОГРАФИИ	17
КОНТАКТЫ	20

Контактная информация	20
Телефоны	20
Время работы	20
Адрес	20

ХАРАКТЕРИСТИКИ

Обзор

Основная информация

Тип судна: Cruising/Racing Sailboat

Подкатегория: Представительская парусная яхта

Модельный год: 2009

Год постройки: 2009

Страна: United States

Размеры

Длина общая: 72' 0" (21.95m)

Длина по ватерлинии: 64' 9" (19.74m)

Ширина: 19' 4" (5.89m)

Макс. осадка: 9' 4" (2.84m)

Скорость, вместимость и масса

Водоизмещение: 105820 Pounds

Вместимость воды: 264 Gallons

Объем топливного бака: 528 Gallons

Размещение

Всего кают: 4

Спальные места: 9

Всего ком. состава: 3

Корпус и палуба

Материал корпуса: Composite

Информация о двигателе

Двигатели: 1

Производитель: Perkins

Модель: M225Ti

Тип двигателя: Inboard

Тип топлива: Diesel

ПОДРОБНОЕ ОПИСАНИЕ

COMMENTS

Presented in excellent condition with a thorough MCA Cat II Survey/Recertification having been completed October 2015. Crown Cut Teak joinery with many thoughtful details throughout, the result of knowledgeable owners working their Captain and the Oyster Design Team to get it just right. Additions made in 2016/2017: New washing machine New lithium ION batteries (6) New Raymarine electronics New Dolphin canvas New cushions New soft goods throughout Updated linens and accessories Multiple sets of bed linens New Lewmar anchor and chain New icemaker below New hot water heaters Two paddle boards

CONSTRUCTION

HULL CONTRUCTION

The hull is built to comply with the requirements stipulated in the European Union's Craft Directive (EURCD) to meet Design Category A - 'Ocean'. The yacht has also been built for MCA (The UK Maritime and Coastguard Agency) compliance. The GRP hull incorporates a composite High Modulous Carbon Kevlar (HMCK) system. This is a 'balanced laminate' that has been designed to give excellent structural properties between the laminate layers. Advantages over standard GRP include: weight savings, extra strength and stiffness. The hull is reinforced with a matrix of structural stringers and floors and specially engineered by High Modulus, world leaders in composite design.

HULL FINISH

Hull color white with cove line and four boot top lines in black

DECK CONSTRUCTION

Deck constructed with balsa cored vinylester resin system.

DECK FINISH

Teak laid decks, low profile 'rolled edge' bulwark.

KEEL

High performance bulb (HPB) external lead keel.

RUDDER

Fully protected skeg-hung rudder.

EURCD

Built to comply with the requirements for Category A - Ocean.

MCA

Built to MCA Category II

DECK LAYOUT AND EQUIPMENT

ANCHOR CQR anchor 105lb (48kg) + 325' (100m) of 7/16" (14mm) calibrated, galvanized chain. 66lb (30kg) Spade anchor with 10mx10mm chain and 100m of 18mm warp, attached by eye and shackle. Stowage for anchor in forward sail locker.

WINDLASS Lewmar 3500 vertical gypsy / drum type, hydraulic anchor windlass installed on deck with foot switch controls. Additional windlass control at port pedestal.

DECK ACCESS Midship gateway stanchions with stainless steel tread plates on cap rail. Stern boarding ladder - removable drop in type, drops into sockets on stern platform. Transom bathing ladder. Top rails demount to allow easy stowage, lower section of ladder demounts to act as side gate bathing ladder. Gate to pushpit. Carbon fiber folding passerelle with stanchions, spreader bar and teaked surface on walkway. Weight with teak 19kg. Black painted finish. Padded stowage bag.

HATCHES Oyster custom drop-down washboard system for main companionway.

Flush Rodal hatches x 3

Lewmar opening hatches x 8

Opening hull ports x 13

Rondal deck prisms x 2 in cockpit

Deck saloon forward opening windows w/gas struts x 2

DECK PLUMBING

High capacity, 50 psi, fresh water anchor wash pump with 25m hose on a coil with bayonet connector in anchor locker. Hot and cold fresh water deck shower at transom with 2m hose, Hans Grohe head with no trigger, bracket for shower head at rail. Fresh water outlet at transom.

COCKPIT

Walk-through teak-laid cockpit. Mug holders at steering pedestals customized to hold a beer

bottle.

COCKPIT TABLE Gloss varnished cockpit table in teak with folding leaves and stainless steel footbars. Additional leaves at end to make into a full size table. Stainless steel wine bottle holders which pin into cockpit table grabrails. One holder each end, each holder stows two bottles, 1x standard red size and other for white with an insulated jacket. Each reversible, so it can be pinned into either side of the table. Frigomatic DC refrigeration, keel cooled unit to cockpit table forward bin and aft section refrigerated with open partition between two boxes, allowing cold air to pass into second box. .

STEERING Exit Engineering Carbon 1200mm wheels with Whitlock shaft brake spinners. Twin remote pedestals, friction brake, and three bearing pedestal steering unit. Canvas covers to wheels.

GENERAL Stainless steel pulpit and pushpin with laminated boards on top rail with upholstered cushions.

Custom cup holders in inboard corners of quarter seats.

2 x Liferrafts mounted below each pushpin seat in canisters

Stainless steel loop to attach lanyards for passerelle fitted to pushpit rail leg at each quarter.

Schaffer fairleads at transom and Clooney Oval tube cleats on aft deck below pushpit seat.

Simpson Cooney 400kg hydraulically powered davits with wireless remote.

Stainless steel mooring and cockpit cleats.

Stainless steel folding type cleats on bulwark x 8

Drop-down acrylic washboard, shock cord assisted

Stainless steel grab rails to aft of sprayhood with leather cover

Twin stainless steel gas struts on lazarette locker lid

Stainless steel warp bar to one side of bow sail locker

Webbing jackstays

4 x Alpine speakers in cockpit

Oval stainless steel grabrails at each side of the companionway and extending down vertical sides of companionway.

Lazarette locker with shelf to stow passerelle, CW pad eyes and lashings. Extra shelves starboard side with plastic crate boxes. Top shelf for waterski stowage with lashing pad eyes.

Stern post for antennas including small Sat dome/GPS and deck flood light

BBQ

Deck accessed gas locker for 2 bottles

RIG AND SAIL HANDLING

MAST and RIGGING Cutter rig

Hall Spars Carbon Fiber mast (black, refinished April 2018 with clear coat) w/stainless plates at point of contact with aft lowers (slab reefing)

Hall Carbon Vee boom

Mainsheet luff track and cars

Navtec hydraulic vang

Navtec A260 hydraulic backstay with remote panel in cockpit

Stainless steel rod standing rigging

HEADSAIL FURLING Reckman RF90-3 Hydraulic Headsail, RF90-2 Hydraulic Staysail.

WINCHES All Lewmar winches in black finish

2 x 88-3 EST electric - primaries

2 x 68 CST electric - secondaries

1 x 65 CEST electric - mainsheet winch

1 x 46 CST electric - traveler control line

1 x 54 CST manual - reefing control line

1 x 68-3 CEST electric - mainsail halyard

1 x 65 CST manual - yankee and staysail halyard

2 x 68 E - mast

SPINNAKER GEAR Deck gear for spinnaker, 2 x Harken 648 pad eyes for sheets on rail, 2 x Harken 648 pad eyes for guys, 6 x Lewmar 105 screw in foreguy blocks and pad eyes and pair single Spinlock XCS clutches for foreguy at side deck. Carbon spinnaker pole, vertically mounted on mast. Clear coated carbon with Kevlar bumper sleeve.

SAILS Upgraded North Sails: Spectra/Gatorback Radial Cut; Main and Yankee replaced in new March 2013. Staysail original. Carbon C-tech battens. North G2 Gennaker (Norlon 50), Asymetic cruising chute with inflatable snuffer. Storm Jib. New Northsails Endurance 3DI (white) mainsail on order (4/18)

INTERIOR

GENERAL Eight berths in four cabins (plus recessed pipe/sea berth), excluding the saloon

Saloon upholstery in leather - color: Aquamarine Ivory

Saloon table cover - color: white

Interior joinery finished in quarter-sawn teak, designed to be modern and coordinated, whilst remaining practical and durable at sea. Essential features include sculpted fiddles and grab rails, 'shadow-gap' joints between panels and Oyster custom knobs for locekr and drawers

Foam cored joinery, headliners and bunk baseboards - balsa cored ply

Lightweight foam cored sole boards

Teak V groove strip plank style sole boards

Surfaces in galley and heads in Avonite satin finish - color "Argent"

Electric towel rails to all heads

Headlining in white vinyl

All heads with fresh / or seawater flush

Mattresses in owner's berth, port aft, and forward cabin upgraded

Saloon hull ports lined with teak

Lee cloths for all berths

Oceanair Skysol pleated blinds to all hull ports

Oceanair combined bugscreens and blinds on all Lewmar and Rondal deck hatches (except galley centerline hatch and sail locker hatch)

FORWARD SAIL LOCKER Deck accessed. Stowage for anchor. Double socket in waterproof box

VIP SUITE FORWARD VIP double berth to port, with settee to starboard with Lee cloth and with recessed roll away seaberth above. Mirror on face of hanging locker door. Sony Bravia TV recessed into forward bulkhead. Flip up desk on bulkhead below TV. Raymarine Graphic

Display.

ENSUITE HEAD / SHOWER Avonite satin finish - color "Argent" surfaces and backsplash. Hans Grohe mixer tap, hand held shower head. Shower seat over plinth made of teak slats with a drop in GRP panel with lid for stowage bin. Heated towel rail. Mirrored locker over sink. Par Quietflush toilet.

GALLEY A spacious and safe area to work in whilst at sea. There is generous worktop space and plentiful lockers for stowage. Stainless steel ladder to crew hatch. Own A/C and stereo system. Hella fan x 1. Main saloon bulkhead extended with door separating galley from saloon. Stainless halfrounds on top of galley fiddles in work areas to protect wood. In counter knife rack stowage.

SINKS Franke KBX 160 double sink with smaller sink outboard

HOT WATER TAP Quooka instant hot water tap

COOKER Neff gas hob, four burner with electric oven / convection combo below, plus a second Neff 4263 two burner induction hob forward of cooker built into countertop. Stainless steel brushed AEG cooker hood with extractor fan and built in light.

MICROWAVE Stainless steel Panasonic microwave NN-E2735

REFRIGERATOR Firtomatic stainless steel front opening refrigerator with 50W, keel cooled. Stainless steel Vitrifigo refrigerator - acts as vegetable drawer - fitted to forward bulkhead.

FREEZER To starboard: Top loading freezer box with two Frigomatic 50W compressors - water cooled.

DISHWASHER Double drawer Fisher and Paykel dish drawer dishwasher.

WASHER/DRYER Bosch washer / dryer, new July 2017

FRESH WATER Seagul water purifying filter with own faucet at galley sink

SALOON Features a large u-shaped settee to port, with dining table in quarter cut teak grain, with black line surround bank, with two leaves that slide apart and pull out bench seating. Washer / dryer located in forward locker. Starboard side of saloon has desk area with two armchair leather seats. There are lockers outboard and behind the settee backs, as well as lockers above seats, and wine storage in the base of the table accessible from both sides. U-Line CO29 combined icemaker / drinks fridge with Seagul water purifying filter to icemaker. Passageway leading aft oil skins locker with heater. AC vented to each head. Electric lift-up TV and Apple TV.

NAVIGATION AREA A comfortable, forward facing navigation station is located aft and starboard of the saloon. The chart table area is strategically sited. Wide chart seat in ivory leather with folding armrest. There is a provision for the stowage within the chart table for half folded

Admiralty charts and a bookshelf over file stowage area. Instruments mounted with teak fascia.

STARBOARD TWIN GUEST CABIN Upper and lower berths with hanging lockers, drawers and full length mirror. Stowage bin in headlining for bedding. Opening port and opening hatch.

PORT AFT DOUBLE GUEST CABIN Double berth with hanging locker and stowage bin in headlining to stow lightweight items. TV recessed into side of hanging locker. Private door access to head with mirror to face of door.

SHARED HEAD / SHOWER Avonite satin finish - color "Argent" surfaces and backsplash. Hans Grohe mixer tap, hand held shower and overhead shower. Heated towel rail. Full length mirror on face of door, and mirrored cabinet above sink. Par Quietflush toilet.

OWNER'S STATEROOM Double berth offset to port, under berth drawers and lockers. Hanging locker to port, drop down locker beneath. Full length mirror on starboard forward bulkhead. Headboard in matching Ivory leather. Lockers to starboard and port side of berth. Desk/vanity with mirror to underside and custom chrome and leather chair, curved settee just aft of desk/vanity. Own companionway hatch entrance to the aft deck, via a deck hatch and a ladder offset to starboard. Hatch has slide out bug screen and black out blind. Shoe locker below aft companionway. A door leads to starboard to the roomy head with separate stall shower. Sony Bravia 26" flat screen TV. Four brick safe with push button keypad in hanging locker. Hella fans x 2

ENSUITE HEAD Avonite satin finish - color "Argent" surfaces and backsplash. Hans Grohe mixer tap, hand held shower and overhead shower. Heated towel rail. Mirror on aft bulkhead over countertop, and mirror on opposite bulkhead. Par Quietflush toilet.

ENTERTAINMENT

AUDIO VISUAL AND SOUND SYSTEMS

SALOON Sony Bravia 32" flat screen TV with Timage type lift system with integrated lid. Connections for video, computer games, etc. Video feed from main salon to all cabins. Alpine Touchscreen control at chart table.

GALLEY Pair of speakers in headlining.

COCKPIT Four Alpine speakers with waterproof control at pedestal

VIP SUITE FORWARD Sony Bravia 20" TV on bulkhead

DOUBLE CREW CABIN DVD / CD / TUNER. Two focal headliner speakers / Magic eye / iPod interface / Panel with MP3 - iPod sockets

STARBOARD TWIN CABIN CD / TUNER inside locker on aft bulkhead with shelf to stow iPod. Two headliner speakers. Magic eye / iPod interface / panel with MP3 - iPod socket.

PORT AFT CABIN Sony Bravia 20" flat screen TV mounted in bulkhead. DVD / CD / TUNER stored inside locker outboard of berth head with shelf to stow iPod / Magic eye / iPod interface / panel with MP3 - iPod socket. Two focal headliner speakers.

OWNER'S STATEROOM Sony Bravia 26" flat screen TV mounted in bulkhead. CD / DVD / TUNER, two Alpine speakers in the headlining, either side of berth head. Magic eye / iPod interface / panel with MP3 - iPod socket

TANKAGE AND PLUMBING

FUEL 2,000 liters approximately (439 imp/528 US gallons) in four carbon tanks. Fit with 1/4 turn breathers valves.

WATER Two GRP tanks totaling 1,000 liters (264 US gallons). Freshwater tanks partitioned for 1/2 capacity bay on both sides. Fit with 1/4 turn breather valves.

TANK TENDER GAUGES Tanks tender gauge system for two water tanks and two diesel tanks.

HOT WATER Two insulated 73 liter (19 US gallons) tanks, both heated by the engine's heat exchanger, or by their integral, thermostatically controlled 220V immersion heater elements.

PRESSURIZED HOT AND COLD FRESHWATER SYSTEM

HOLDING TANKS 3 x gravity discharge holding tanks with Wema electric gauges, and Bailey Marine Holding tank pump out fittings set flush with teak.

MECHANICAL AND ENGINEERING

ENGINE Perkins/Sabre M225Ti (225hp) diesel engine

PROPELLER 24" Maxprop, 3 bladed, feathering propeller (with one spare)

ALTERNATORS 40A 24V alternator to charge the engine start batteries. Mastervolt 150 amp 24V alternator for charging the ship's domestic batteries. Mastervolt Alpha Pro regulator

GENERATOR Upgraded from 13.5kW to 22.5kW. 6700 hours

BOW THRUSTER Sleipner 285 electric 20hp bow thruster with joystick control.

AIR CONDITIONING Aircon system throughout. Each cabin has its own zone.

Sleeping cabins have AC compressors in the engine room (3 off) with remote air handlers in each cabin.

Saloon and galley have stowaway units

Controllers in cabins mounted in Vimar switch surrounds.

Aft stbd cabin - 4,000 BTU REU4C handler sharing RX12C 12,000 BTU condenser in engine room.

Saloon - 2 x 16,000 BTU Stoway STQ16C (230v 60/50 hz TURBO) self contained units.

Galley - 12,000 BTU Stoway STQ12C (230v / 60/50hz TURBO) self contained unit.

Cold air bleed take offs to fwd WC, aft WC, and port aft WC with closable duct outlet.

WATERMAKER Seafresh 206A upgraded to 2012 model (170 litres/hour) watermaker system with remote panel in cupboard aft passageway with flow meter and auto flush assembly.

ELECTRICAL

SHIP'S SUPPLY 24V

RINGMAIN 220V AC ring main with 12 sockets, UK 3-pin type. Sockets located as appropriate within the layout. Vimar surround sockets with chrome type surrounds.

OTHER ELECTRICAL SOCKETS at chart table

BATTERY MANAGEMENT Mastervolt 220V MASS 24/100A battery charger Mastervolt monitor Cross-link from domestic batteries to generator for emergency starting, needs to take a 12V feed.

INVERTER 220V MASS Sine wave inverter 24V / 1500W, to provide power to AV system and icemaker. Mastervolt 24V/5000W sine inverter for domestic sockets.

SHOREPOWER Two 50A dockside power cables

INTERIOR LIGHTING Cantalupi - chrome finish Down lights

Reading light - Cantalupi Time - in aft cabin, and Pacific in other cabins - one for each berth

Mood lighting control to saloon

Red LED night lights, one at each saloon step

Cantalupi Spillo white LED accent lights at kick recess around saloon sole, and at each side of companionway steps

Uplighters - Cantalupi halogen - in saloon on shelves behind port side seating and forward aft. Also outboard of starboard side worktop and bulkhead.

Red overhead lights - one at: charter table / galley / heads with neon light switches which activate when 'night light' breaker circuit is powered on.

Hull ports - Labcraft LED warm white strip LED strips.

Lights in forward sail locker

EXTERIOR LIGHTING Lights mounted in lazarette

Bow and stern navigation - Lopolight LED lights

Tri-white anchor / navigation light at masthead

Remote control lighting for aft deck, boom and spreader lights.

NAVIGATION AND COMMUNICATION

COMPASSES Two S.I.R.S. marine major 150mm diameter compass with internal lighting

SAILING Raymarine Instrument system, ST290 series

INSTRUMENTS 1 x graphic, ST60 radar display, flatscreen 15" Raymarine monitor, Ray 300 GPS plus speed and depth transducers at chart table

1 x ST60 graphic in owner's stateroom - flush mounted

5 x graphics on carbon mounting at mast

RADAR / CHART PLOTTER 4kW radar scanner for E80 display and E120 repeaters

AUTOPILOT Raymarine autopilot with SPX SOL AP system with Phoenix Hydraulic motor and clutch

WINDEX Windex at masthead. Additional windlass control at pedestal.

VHF RADIO Raymarine 240E VHF, with USA channels at chart table with its own speaker. second handset and speaker in the cockpit at port pedestal.

SATELLITE PHONE Thrane & Thrane satellite phone and antenna on pushpit, including second handset in owner's stateroom.

PC AG Neovo flatscreen

SAFETY

LIFERAFT 2 x lifeguard 8-man life rafts in canister Ocean Safety "ISO" unit with Solas B grab

bag. Float free release and straps for MCA

BILGE PUMPS Electric bilge pump Par 34600 with Par hydro air switch

DECK SAFETY Two Horseshoe lifebuoys with lights

FIRE EXTINGUISHERS Various fire extinguishers

ALARMS Gas detector at galley for MCA smoke detector in engine room with loud audible alarm in saloon for MCA Carbon monoxide alarm in saloon. **OTHER SAFETY**

FEATURES Macro foghorn for MCA Watertight bulkhead and door at aft companionway; Ocean First Aide kit and oxygen

GENERAL

RIB 4.5 metre TIB with 60hp outboard

SAFE 4-brick safe

ASSORTED TOOLS, SPARES AND MANUALS

Исключения

При продаже яхты исключаются личные вещи владельца.

Отказ от ответственности

Компания предоставляет описание судна или яхты добросовестно, но не может гарантировать точность этой информации, а также не ручается за техническое состояние. Покупатель должен проинструктировать своих агентов или оценщиков исследовать представленную информацию более подробно, по собственному желанию. Продажа судна или яхты, изменение цены или снятие с продажи будет происходить без предварительного уведомления.

ФОТОГРАФИИ



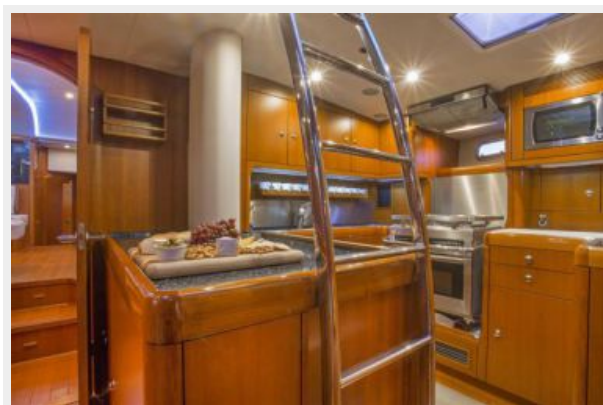

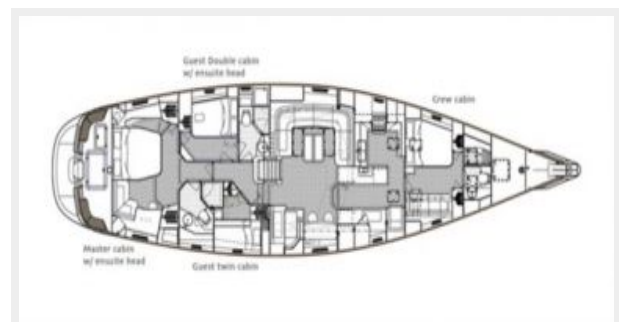

КОНТАКТЫ

Андрей Шестаков (Andrey Shestakov) – ведущий яхтенный брокер отдела продаж яхт и судов компании Shestakov Yacht Sales Inc. Официальный представитель Shestakov Yacht Sales Inc. для русскоговорящих клиентов в центральном офисе компании в Майами/Форт Лодердейл/Флорида/США.

Контактная информация

Email: andrey@shestakovyachtsales.com

Web: shestakovyachtsales.com

Телефоны

Краснодарский край: **+7(918)465-66-44**

США, Майами, Флорида: **+1(954)274-4435**

Время работы

Понедельник – Суббота: **9:00 - 21:00**
EDT

Воскресенье: **Закрето**

Адрес



Harbour Towne Marina, 850 NE 3rd St,
STE 213, Dania, FL 33004