

RITA — NAUTOR'S SWAN



Судостроитель: NAUTOR'S SWAN

Год постройки: 1991

Модель: Крейсерская яхта

Цена: ЦЕНА ЯХТЫ ПО ЗАПРОСУ

Местонахождение: Spain

Длина общая: 57' 5" (17.49m)

Ширина: 15' 11" (4.85m)

Мин. осадка: 8' 7" (2.60m)

Купить RITA — NAUTOR'S SWAN а также выбрать подходящую вам яхту из нашего каталога яхт вам поможет опытный яхтенный брокер Андрей Шестаков. На сегодняшний день компания Shestakov Yacht Sales Inc. имеет большое количество яхт в собственном списке продаж, а также тесно сотрудничает со всеми крупными яхтенными производителями по всему миру.

Для того чтобы купить яхту RITA — NAUTOR'S SWAN а также проконсультироваться по любому вопросу связанному с покупкой, продажей, чартером яхт позвоните по телефону **+7(918)465-66-44**.

ОГЛАВЛЕНИЕ

ОГЛАВЛЕНИЕ	2
ХАРАКТЕРИСТИКИ	3
Обзор	3
Основная информация	3
Размеры	3
Скорость, вместимость и масса	4
Размещение	4
Корпус и палуба	4
Информация о двигателе	4
ПОДРОБНОЕ ОПИСАНИЕ	5
GENERAL	5
Исключения	6
Отказ от ответственности	6
ФОТОГРАФИИ	7
КОНТАКТЫ	11
Контактная информация	11
Телефоны	11
Время работы	11
Адрес	11

ХАРАКТЕРИСТИКИ

Обзор

The Swan 55 is a break-away design for Nautor. She is a yacht dedicated to cruising. The vast centre cockpit is both safe and comfortable. The rig and deck plan are designed to facilitate short handed use. The engine is the most powerful ever installed as standard in a Swan of this size and is situated in a walk in engine room together with a generator and water maker.

RITA was completed and commissioned late in 1991. This yacht was specified by an experienced owner. The original name was "Arab Light" and then "Gracia". Sold to the current owner in 1994. He has utilised her for family sailing – mostly in the west Med area but also with four crossings to the Caribbean in the past. He has also competed in a few races such as the Rolex Swan Cup in Sardinia; Bermuda-Azores; ARC transatlantic. Most winters the yacht has been stored ashore and covered.

RITA is well equipped and in good condition. Under this ownership she has been maintained by the same skipper. Many upgrades have been made including new teak deck (approx 2000) and new rod rigging (approx 2007). Also instruments and water-maker have been updated and the refrigeration system was all new in 2016. This is a rare opportunity to acquire an example of this popular cruising Swan design at a most realistic price.

Основная информация

Тип судна: Крейсерская яхта

Модельный год: 1991

Год постройки: 1991

Год обновления: 2009

Вид обновления: Teak, rigging etc

Страна: Spain

Размеры

Длина общая: 57' 5" (17.49m)

Длина по ватерлинии: 42' 11" (13.07m)

Ширина: 15' 11" (4.85m)

Мин. осадка: 8' 7" (2.60m)

Скорость, вместимость и масса

Водоизмещение: 52029.093832 Pounds **Вместимость воды:** 880 Gallons

Объем топливного бака: 620 Gallons

Размещение

Всего кают: 4

Спальные места: 8

Корпус и палуба

Материал корпуса: GRP

Информация о двигателе

Двигатели: 1

Производитель: Perkins

Модель: 4M135

Тип двигателя: Inboard

Тип топлива: Diesel

ПОДРОБНОЕ ОПИСАНИЕ

GENERAL

Hull and Deck Hull of glass-fibre reinforced polyester by hand-laid method, alternative layers of mat and roving. Ballast keel is a lead casting with antimony. Cast in keel bolts of high tensile stainless steel. Further standard build information available. White hull with blue cove and coaming stripes. Extended reverse transom, LOA 17.49m (57.39'). Teak laid side decks, cabin trunk and sun deck – teak replaced in 2009/10 13mm at time. Recessed Lofrans Falkon 1500 anchor windlass including fold up rope drum rollers, chain pipe and box with manual drain pump, 2 foot switches and stainless through deck hawse pipe and cover plate. CQR and Danforth anchors with chain and warp plus a spare. Gate in pushpit on starboard side. Gangway fitting at stern Gates in lifelines port and starboard. Outboard bracket on pushpit Fold up stainless transom ladder Side mounting swim ladder Lewmar Winches: Genoa sheet winches (upgraded at build) to 2 x Lewmar 66 CEST electric 2 x 55 self tailing aft on coaming (runners) 1 x 43 self tailing for mainsail track 2 x 46 self tailing on deck forward On mast – 1 x 52; 1 x 43; 2 x 46 Mainsail sheet upgraded (under current ownership) to a Lewmar 50 self tailing electric winch Interior Four cabin interior with following amendments from standard: Fore-cabin: crew toilet, shower and wash basin in forecabin, with curtain to separate from cabin which has two berths, seat and stowage. Guest cabins: upper/lower berths with two drawers under each lower berth, hanging lockers.. Saloon: full length settee on starboard side, usable as a sea berth; (there is no centre-line seat & bar unit anymore). Three folding stools. Wine locker under the saloon table. Aft cabin: with two large single/small double berths, one to port and one to starboard; small seat on port side; vanity unit in centre, facing aft with stool Galley equipment 4 burner Alpes Inox cooker and oven Main Systems ENGINE Perkins 4 M135 86.5 kw (116 shp) at 2800 rpm, with Hurth hydraulic rev./red. gear 2.52:1 Engine hours at July 2017: approx 7000 (hour meter changed twice). 3 blade Max-Prop feathering propeller - as standard. GENERATOR Westerbeke BTD 9.4 kva diesel generator, overhauled 2000. Approx 5000 hours at July 2017 PLUMBING SYSTEMS Electric bilge pump, manual and auto control Deck shower, hot and cold fresh water One holding tank for forward and aft guest heads, with electrical discharge pump Vacuflush toilets, fresh and salt water flushing Water-maker, HRO system REFRIGERATION Isotherm refrigerator and freezer system, 24v (installed new in ?) - (two compressors, one for the fridge and one for the freezer – can be swapped over in case of one failing). AIR CONDITIONING Marine Air 21000 BTU total with reverse heating mode, incl separate shore power inlet. Has had new compressor etc. Electrical Equipment Shorepower 220v 25A including land connection cable, polarity alarm, and outlets 12 service batteries – 2v each by Tudor, approx 4 years. Engine start batteries x 2; 1 x genset, all recent approx 1 / 2 years. Victron Skylla battery charger 24v / 75A, 220v Inverter – Atlas 24v/300A LED lighting in interior. Spreader deck lights. Boom light above cockpit Hella Turbo fans, one in galley and one in crew cabin Navigation Equipment Autohelm ST 60 instrumentation (upgraded from ST50), including: Repeaters over companionway - speed/log, depth, wind, close hauled/VMG - in cockpit; ST60 Multi at chart table Autohelm ST 50 Navcentre chart plotter at chart table, with 5 cartridges (old) Raymarine ST7002 hydraulic autopilot – (motor in engine room) Sailor RT 2048 VHF, antenna at mast-head Sailor T2130 SSB, with insulated

backstay and grounding cage Raymarine hand held VHF, RAY 100E Furuno 1623 Radar, scanner on mast, interfaced to speed/log and GPS Fastnet radio CMD56 decoder (only used to receive Navtex) Garmin GPS 152H Furuno GPS/WAAS GP32 Acer Travel Mate C100 PC system plus mouse & keyboard including MaxSea chart system Suunto pedestal compass Sailor VHF DSC RM2042 (not working but still installed) Entertainment Equipment Samsung TV LG DVD/CD player JVC MP3 radio/CD player Pioneer speakers in saloon, Sony speakers in cockpit

Rig and Sails RIG Mast-head sloop rig, Nautor anodised aluminium spars. L = 21.15m (69.39') Navtec hydraulic system, panel at pedestal – vang and backstay. Navtec discontinuous rod rigging, changed in March 2009 (by Yachttech, Oliver Blume) Reckmann R4 manual furling headstay Removable inner stay External Harken mast track for fully battened mainsail, with Harken Series B special roller bearing cars, and Lazy Jack system on mast and boom Full running rigging incl sheets, guys, downhaul, preventer etc. Spinnaker pole and jockey pole.

SAILS By Polish sailmaker Narwal Mainsail N° 1 genoa (new) only one week use. Main, Spectra N° 1, Spectra N° 2 – good, used for race N° 2 - ok N° 3 Solent jib N° 3 jib Spinnaker x 3 (light, medium and heavy) all ok. Accessories “Venezuelan” tender, rollaway system, stows in aft locker. Yamaha 15hp outboard Deck gear: Large cockpit table. Cockpit upholstery and cushions for aft deck, with blue towelling loose covers Cover for wheel and compass. Mainsail cover. Sun awning Sprayhood Big winter cover (currently in south Spain near Almeria) Carbon fibre aft gangway Safety: Eight person life-raft with canvas cover, (in service). Horseshoe lifebuoys and brackets. Jonbuoy Danbuoy Life jackets and harnesses EPIRB emergency beacon. First aid kit. Fire extinguishers and fire blanket Lots of spares on board.

Исключения

При продаже яхты исключаются личные вещи владельца.

Отказ от ответственности

Компания предоставляет описание судна или яхты добросовестно, но не может гарантировать точность этой информации, а также не ручается за техническое состояние. Покупатель должен проинструктировать своих агентов или оценщиков исследовать представленную информацию более подробно, по собственному желанию. Продажа судна или яхты, изменение цены или снятие с продажи будет происходить без предварительного уведомления.

ФОТОГРАФИИ







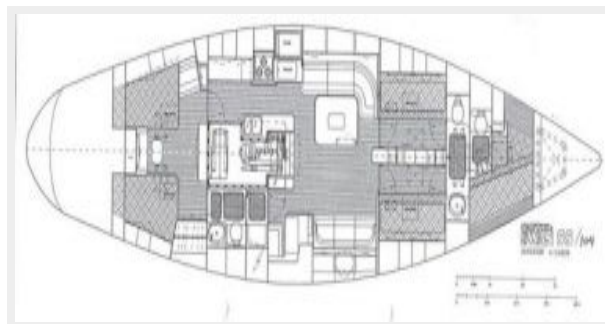

КОНТАКТЫ

Андрей Шестаков (Andrey Shestakov) – ведущий яхтенный брокер отдела продаж яхт и судов компании Shestakov Yacht Sales Inc. Официальный представитель Shestakov Yacht Sales Inc. для русскоговорящих клиентов в центральном офисе компании в Майами/Форт Лодердейл/Флорида/США.

Контактная информация

Email: andrey@shestakovyachtsales.com

Web: shestakovyachtsales.com

Телефоны

Краснодарский край: **+7(918)465-66-44**

США, Майами, Флорида: **+1(954)274-4435**

Время работы

Понедельник – Суббота: **9:00 - 21:00**
EDT

Воскресенье: **Закрито**

Адрес



Harbour Towne Marina, 850 NE 3rd St,
STE 213, Dania, FL 33004