

# ALTERNATE LATITUDE — VOYAGE YACHTS



**Судостроитель:** VOYAGE YACHTS

**Год постройки:** 2001

**Модель:** Катамаран

**Цена:** ЦЕНА ЯХТЫ ПО ЗАПРОСУ

**Местонахождение:** United States

**Длина общая:** 44' 0" (13.41m)

**Ширина:** 25' 0" (7.62m)

**Мин. осадка:** 3' 6" (1.07m)

Купить **Alternate Latitude — VOYAGE YACHTS** а также выбрать подходящую вам яхту из нашего каталога яхт вам поможет опытный яхтенный брокер Андрей Шестаков. На сегодняшний день компания **Shestakov Yacht Sales Inc.** имеет большое количество яхт в собственном списке продаж, а также тесно сотрудничает со всеми крупными яхтенными производителями по всему миру.

Для того чтобы купить яхту **Alternate Latitude — VOYAGE YACHTS** а также проконсультироваться по любому вопросу связанному с покупкой, продажей, чартером яхт позвоните по телефону **+7(918)465-66-44**.

# ОГЛАВЛЕНИЕ

---

ОГЛАВЛЕНИЕ	2
ХАРАКТЕРИСТИКИ	3
Обзор	3
Основная информация	10
Размеры	10
Скорость, вместимость и масса	10
Размещение	10
Корпус и палуба	10
Информация о двигателе	10
ФОТОГРАФИИ	11
КОНТАКТЫ	18
Контактная информация	18
Телефоны	18
Время работы	18
Адрес	18

---

# ХАРАКТЕРИСТИКИ

---

## Обзор

---

Alternate Latitude is a shining example of the award-winning Voyage 440 bluewater luxury catamaran. With head turning good looks, excellent performance, and a build quality second to none in her class, Voyage catamarans are in high demand both as long distance cruisers and income producing charter yachts. This Voyage 440 has been expertly maintained since new and has been a successful crewed charter yacht in the BVI for many years.

**She is ready to take her new owners anywhere as a private yacht, or her charter books and amenities will convey. This includes a beautiful robust website, 6 years of charter contacts, social media marketing and complete business package.**

She is currently in the Bahamas and will arrive in Florida early summer. **Dimensions**

LOA: 44 ft 0 in Beam: 25 ft 0 in Maximum Draft: 3 ft 6 in

## Engines

Engine 1: Engine Brand: Yanmar Engine Type: Inboard Engine/Fuel Type: Diesel Location: Starboard Engine Hours: 6527 Engine Power: 40 HP Engine 2: Engine Brand: Yanmar Engine Type: Inboard Engine/Fuel Type: Diesel Location: Port Engine Hours: 4501 Engine Power: 40 HP

## Accommodations

Number of cabins: 4 + 2 single bow cabins Number of heads: 4

## Forward and Aft Cabins

- Access to bow storage
- Cabin and reading lights
- Cabin lights & reading lights
- Cave lockers
- Hanging and storage cupboards
- Laundry locker with upholstered cover
- Modules in moulded GRP
- Queen size bunk with split mattresses
- Stainless steel towel rail

- Cabin Appointments

### **Bow Cabins**

- Cabin Appointments
- Cabin Light
- Fan
- Hatch
- Single V-Berth

### **Main Saloon**

- ALCANTARA upholstered settee
- Coffee table
- CORIAN type work surfaces
- Modules in moulded GRP
- Standing height throughout 1.9m
- Storage in seating modules

### **Galley**

#### **The Voyage 440 galley is second to none in its class**

- 4 x Burner propane hob and propane oven
- CORIAN type work surfaces with stainless steel rails and fiddles
- Facility for microwave oven
- Front opening refrigerator - 12V air cooled ADLER/BARBOUR
- Large recessed drip tray
- Modules in moulded GRP
- Pressurized hot and cold water
- Stainless steel sink
- Stainless steel waste chute with cover
- Top opening freezer, 12V air cooled ADLER/BARBOUR

- Galley Appointments

## Head Compartments

- Integrated shower grate and sump
- Manual marine toilet
- Mirror
- Modules in moulded GRP
- Stainless steel towel rail
- Vanity cabinet
- Wash basin and shower with hot and cold water
- 4 x Heads, 2 x Port, 2 x Stbd

## Navigation Centre

- Access panels to electrical installation and systems
- Instrument console
- Navigation seat
- Chart table with recessed chart stowage

## Instrumentation

- Compass
- ICOM M-45 VHF Radio with RAM mike
- RAYMARINE ST60 Tridata & Wind
- RAYMARINE ST6001+ Autopilot with WHITLOCK rotary drive
- LOWRANCE 113 HD chartplotter/GPS/Depth sounder with updated chip/triducer

## Electrical

- 2 x 120A AMPLE alternators with SMART multi stage regulators
- 2 x Engine start batteries (12V) @ 65 AH (new 2005)
- AC shore cable socket
- Battery isolator switches

- Ceiling lights
- Circuit breaker panel
- Cockpit lights
- Deck light
- Interior AC outlets: 3 in saloon, 1 in each cabin
- Lazarette and engine compartment lights
- LINK 2000 battery management system
- Mast top and lower navigation lights
- House batteries (12V) gel - 400AH x 2 (800AH) (new 2005)
- HEART 25 Inverter/Charger 12V to 110V
- Shore power cable 30A

### **Engine Equipment**

- 2 x Instrument panels with engine hour meters
- 2 x 55A alternators
- High pressure fuel lines
- Sound insulation
- 40Hp fresh water cooled YANMAR diesel engines with saildrives and fixed propellers. The port engine new in 2005 with SD 50 sail drive

### **Plumbing**

- 2 x Black water systems and holding tanks
- 2 x Manual bilge pumps
- 2 x Water heater 22 litre
- 4 x Automatic electric bilge pumps
- Pressurized hot and cold deck shower (starboard)
- Self draining cockpit

### **Comfort and Lifestyle**

- Air Conditioning – 22 000 BTU **NEW 2018**
- Dimmers, Courtesy Lights, Boom light, 12V outlet
- Flat Panel 22 inch TV
- Generator, NORTHERN LIGHTS 6KW - 5156 hours
- Sound system, 12V Radio/CD and 4 Marine speakers in saloon/cockpit

### **Cockpit/Aft Deck**

- 7 x Storage lockers
- Cockpit deck level walk through to dive platform
- Dingy stowage supports and BBQ mounting point
- Double helmsman's seat
- GRP Cockpit table
- Sheet pouches x 2, Utility pouch x 1
- Steering console including
- Instrument console
- Stainless steel steering wheel
- Teak dive platform/aft deck
- Traveller arch
- Cockpit Cushions
- Cockpit table - White GRP – Removable
- Hard top Bimini with spray dodger

### **Sails**

- Fully battened main with large roach, 2 reef points, 10.3 oz high modulus, cross cut Dacron
- Furling genoa with foam luff and UV cover, 7.3 oz high modulus cross cut Dacron
- HARKEN battcar system for mainsail
- Mainsail stowage pack with lazy jacks
- PROFURL genoa roller furler

## Rigging

- 7/8th fractional rig
- Anchor chain lead internally through compression post
- Anodised Aluminium mast, boom, cross beam and double compression post
- Attachment point for bow sprit
- Color coded sheets and control lines
- Double purchase main halyard
- Flag halyards, Port and Starboard
- Mast supported by triple spreaders, intermediate and cap shrouds, forestay and inner forestay
- Reefing lines x 2 and luff pendants x 2
- Telescopic boom derrick for hauling dinghy on to dive platform

## Hull, Deck and Bulkheads

- Antifouling over epoxy based osmosis barrier
- Closed cell PVC foam core, vacuum bonded for stiffness, strength and minimal weight
- Forward water tight compartments with horizontal bulkheads
- Hand laid-up GRP construction using multi layers of Quadraxial glass roving, isophthalic and orthophthalic polyester resin and other highest grade material
- Low aspect reinforced keels
- Marine ply and balsa core on critical structure bulkheads for added strength and stiffness
- Reinforced fitting areas for cleats and chain plates
- Skeg supported rudders

## Deck Equipment

- 1 x Electric windlass: LOFRANS
- 2 x Primary winches on coach roof: ANDERSEN 46ST
- 2 x Secondary winches in cockpit: ANDERSEN 46ST



- 8 x Aluminium mooring cleats
- Teak walkway between trampolines
- Tracks, cars, jammers and blocks
- Webbing trampolines
- Propane BBQ (PARKER Grill) on Dive Platform
- Snorkeling Equipment
- Bow pulpits with teak seats
- Double guard wires
- Grab rails on coach roof
- Pushpits on stern with brackets for life ring buoys and overboard lights
- Stanchions and stanchion bases
- Swim ladder Starboard
- Water stays attachment points for bow sprit
- Gates in guard wires
- Swim ladder Port

### **Hatches and Windows**

- 11 x LEWMAR hatches
- 2 x GRP locker lids: foredeck
- 7 x GRP locker lids: cockpit
- 8 x LEWMAR port lights
- 8 x Reflective laminated safety glass windows
- Anodised aluminium framed sliding door with safety glass and fixed opening positions
- Ventilation/Escape hatch with teak grid in galley
- Dive equipment hatch and locker in aft coaming

### **Safety Equipment**

- Basic safety equipment including: flares, life jackets, first aid kit and life rings

## Основная информация

Тип судна: Катамаран

Модельный год: 2001

Год постройки: 2001

Страна: United States

## Размеры

Длина общая: 44' 0" (13.41m)

Ширина: 25' 0" (7.62m)

Мин. осадка: 3' 6" (1.07m)

Трапы: 63' 0" (19.20m)

## Скорость, вместимость и масса

Водоизмещение: 20240 Pounds

Вместимость воды: 220 Gallons

Объем топливного бака: 170 Gallons

## Размещение

Всего кают: 4

Всего ком. состава: 4

## Корпус и палуба

Материал корпуса: Fiberglass

## Информация о двигателе

Двигатели: 2

Производитель: Yanmar

Тип двигателя: Inboard

Тип топлива: Diesel

# ФОТОГРАФИИ



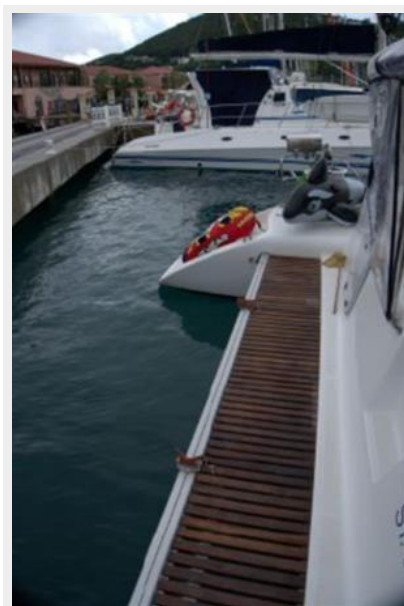















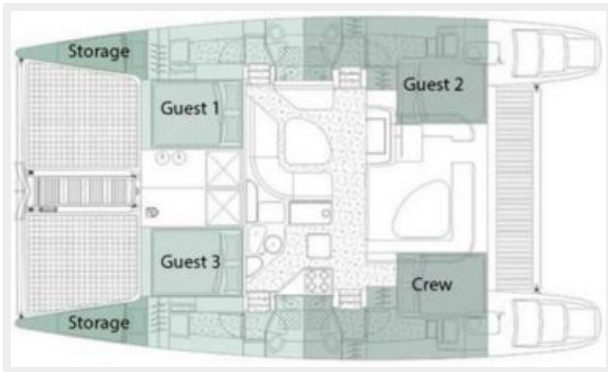

# КОНТАКТЫ

---

Андрей Шестаков (Andrey Shestakov) – ведущий яхтенный брокер отдела продаж яхт и судов компании Shestakov Yacht Sales Inc. Официальный представитель Shestakov Yacht Sales Inc. для русскоговорящих клиентов в центральном офисе компании в Майами/Форт Лодердейл/Флорида/США.

## Контактная информация

---

Email: [andrey@shestakovyachtsales.com](mailto:andrey@shestakovyachtsales.com)

Web: [shestakovyachtsales.com](http://shestakovyachtsales.com)

## Телефоны

---

Краснодарский край: **+7(918)465-66-44**

США, Майами, Флорида: **+1(954)274-4435**

## Время работы

---

Понедельник – Суббота: **9:00 - 21:00**  
EDT

Воскресенье: **Закрито**

## Адрес

---



Harbour Towne Marina, 850 NE 3rd St,  
STE 213, Dania, FL 33004