

PIMM'S O' CLOCK — AZIMUT



Builder: AZIMUT

Year Built: 2008

Model: Motor Yacht

Price: PRICE ON APPLICATION

Location: United States

LOA: 43' 10" (13.36m)

Beam: 45' 5" (13.83m)

Max Draft: 12' 4" (3.75m)

Cruise Speed: 28.6762 Kts. (33 MPH)

Max Speed: 33.021 Kts. (38 MPH)

Our experienced yacht broker, Andrey Shestakov, will help you choose and buy a yacht that best suits your needs **PIMM'S O' CLOCK — AZIMUT** from our catalogue. Presently, at Shestakov Yacht Sales Inc., we have a wide variety of yachts available on our sale's list. We also work in close contact with all the big yacht manufacturers from all over the world.

If you would like to buy a yacht **PIMM'S O' CLOCK — AZIMUT** or would like help answering any questions concerning purchasing, selling or chartering a yacht, please call **+1(954)274-4435**

TABLE OF CONTENTS

TABLE OF CONTENTS	2
SPECIFICATIONS	3
Overview	3
Basic Information	3
Dimensions	3
Speed, Capacities and Weight	3
Accommodations	4
Hull and Deck Information	4
Engine Information	4
DETAILED INFORMATION	5
Manufacturer Provided Description	5
Exclusions	5
Disclaimer	5
PHOTOS	6
Manufacturer Provided Image: 43S Profile	7
Manufacturer Provided Image: Cockpit	7
Manufacturer Provided Image: Owners Cabin	7
Manufacturer Provided Image: Guest Cabin	7
Manufacturer Provided Image: Owners Head	7
Manufacturer Provided Image: Saloon	7
CONTACTS	8
Contact details	8
Telephones	8
Office hours	8
Address	8

SPECIFICATIONS

Overview

The sleek Azimut 43S is notable not just for her leading-edge styling or acclaimed interior, but also because she was the first Azimut model to incorporate pod drives as standard equipment. That alone gave her a performance and economy edge on most competitive sportyachts of her day—an advantage that proved short-lived, however, as pod drives are rapidly taking over the market these days. Azimuts have always been noted for their designer interiors so it's no surprise that the accommodations aboard the 43S are both lavish and tasteful. Tiered windows and a huge power sunroof bathe the salon in copious natural lighting.

Both staterooms are roomy and comfortable (note the hull side windows in the guest cabin), and both heads are fitted with separate stall showers. Note the big opening port over the galley counter. Additional features include a U-shaped cockpit lounge, hydraulic swim platform, and a big foredeck sun pad. Triple hatches provide good engine access. Volvo 435hp IPS pod drives cruise at 30 knots.

Basic Information

Category: Motor Yacht	Sub Category: Cruiser
Model Year: 2008	Year Built: 2008
Country: United States	

Dimensions

LOA: 43' 10" (13.36m)	Beam: 45' 5" (13.83m)
Max Draft: 12' 4" (3.75m)	

Speed, Capacities and Weight

Cruise Speed: 28.6762 Kts. (33 MPH)	Max Speed: 33.021 Kts. (38 MPH)
Displacement: 34172 Pounds	Water Capacity: 132 Gallons
Holding Tank: 35 Gallons	Fuel Capacity: 294 Gallons

Accommodations

Total Cabins: 2

Total Berths: 2

Total Heads: 2

Hull and Deck Information

Hull Material: Fiberglass

Hull Configuration: Modified Deep Vee

Engine Information

Engines: 2

Manufacturer: Volvo

Model: D60 IPS

Engine Type: Inboard

Fuel Type: Diesel

DETAILED INFORMATION

Manufacturer Provided Description

The smallest craft in the S line, Azimut's Open range, together with the 62S, will be presented at this year's Genoa International Boat Show. The Turin based boat yard has achieved an exceptional goal: a new range, with an impressive 4 models from 43 feet to 88 feet, in exactly three years. Another one-of-a-kind Open design by Stefano Righini. A 43' Open with distinctly separated living and sleeping areas that with a perfect balance of openings and windows perfectly combines the commodity and elegance of a Fly with the sporty freshness of an Open.

Exclusions

Owner's personal belongings.

Disclaimer

The Company offers the details of this vessel or yacht in good faith but cannot guarantee or warrant the accuracy of this information nor warrant the condition of the vessel. A buyer should instruct his representatives, agents, or his surveyors, to investigate such details as the buyer desires validated. This vessel or yacht is offered subject to prior sale, price change, or withdrawal without notice.

PHOTOS



Manufacturer Provided Image: 43S Profile



Manufacturer Provided Image: Cockpit

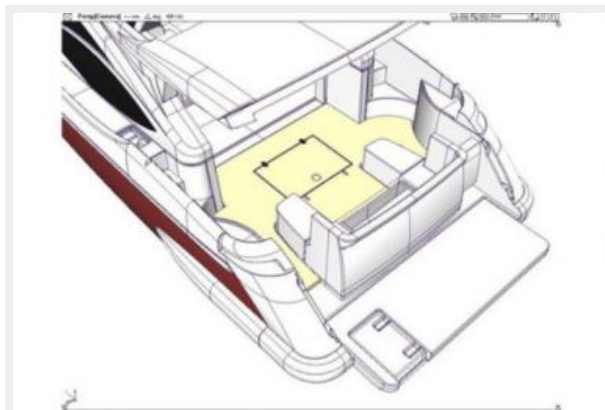

Manufacturer Provided Image: Guest Cabin



Manufacturer Provided Image: Owners Cabin



Manufacturer Provided Image: Owners Head



Manufacturer Provided Image: Saloon



CONTACTS

Andrey Shestakov, leading yacht broker of the sales department of Shestakov Yacht Sales Inc. Shestakov Yacht Sales Inc., the official representative of the Miami/Fort Lauderdale FL headquarters.

Contact details

Email:
andrey@shestakovyachtsales.com

Web: shestakovyachtsales.com/en/

Telephones

USA: **+1(954)274-4435**

Office hours

Monday – Saturday: **9:00 - 21:00 EDT**

Sunday: **closed**

Address



Harbour Towne Marina, 850 NE 3rd St,
STE 213, Dania, FL 33004