

ZEGO — PERSHING



Builder: PERSHING

Year Built: 2015

Model: Motor Yacht

Price: PRICE ON APPLICATION

Location: Malta

LOA: 70' 5" (21.44m)

Beam: 16.33

Max Draft: 4' 6" (1.35m)

Cruise Speed: 40 Knots Kts. (46 MPH)

Max Speed: 46 Knots Kts. (53 MPH)

Our experienced yacht broker, Andrey Shestakov, will help you choose and buy a yacht that best suits your needs **ZEGO — PERSHING** from our catalogue. Presently, at Shestakov Yacht Sales Inc., we have a wide variety of yachts available on our sale's list. We also work in close contact with all the big yacht manufacturers from all over the world.

If you would like to buy a yacht **ZEGO — PERSHING** or would like help answering any questions concerning purchasing, selling or chartering a yacht, please call **+1(954)274-4435**

TABLE OF CONTENTS

TABLE OF CONTENTS	2
SPECIFICATIONS	3
Overview	3
Basic Information	3
Dimensions	3
Speed, Capacities and Weight	4
Accommodations	4
Hull and Deck Information	4
Engine Information	4
PHOTOS	5
CONTACTS	8
Contact details	8
Telephones	8
Office hours	8
Address	8

SPECIFICATIONS

Overview

THE AVANT-GARDE LOOKS OF THE ALL NEW PERSHING 70 HAS CONQUERED BOTH LOYAL AND NEW FANS OF THE BRAND. A DYNAMIC PROFILE AND INNOVATIVE DESIGN ARE ENHANCED BY TWO LARGE STRUCTURAL WINGS THAT GIVE THE YACHT A TRULY BREATHTAKING APPEARANCE ON THE WATER, AND A TRULY UNIQUE PERSONALITY LIKE NO OTHER. THIS YACHT REPRESENTS A NEW GENERATION OF PERSHING'S AND CAPTIVATES OWNERS WHO SEEK A YACHT WITH UNIQUE STYLE THAT IS RECOGNISABLE AT A GLANCE AND IS THE ESSENCE OF ELEGANCE AND SPEED, POWER AND BEAUTY, TECHNOLOGY AND COMBINED WITH THE TOP SYSTEM 85P SURFACE-PIERCING PROPELLERS THE VESSEL CAN REACH AN ASTONISHING MAXIMUM SPEED OF 46 KNOTS AND CRUISING SPEED OF 40 KNOTS.

The boat is fully equipped (incl.a Williams 325), with a lot of things added custom to the owner's requirements. The third cabin has been removed, to create a spacious toilet and bidet and extra storage space for towels and laundry. Wine cooler has been added in the kitchen and replaced the original kitchen top with Nero Assoluto granite, which isn't prone to damage. The original chain has been replaced by an inox one and the anchor has been replaced as well with an UltraMarine anchor

Also in option: - custom designed tenda mounted on carbon sticks. - seakeeper (116 000,- EUR)
- water maker with remote control. - energy storage pack (Olife, 30 000,- EUR)

Basic Information

Category: Motor Yacht

Sub Category: Motor Yacht

Model Year: 2015

Year Built: 2015

Country: Malta

Dimensions

LOA: 70' 5" (21.44mm)

Beam: 16.33

Max Draft: 4' 6" (1.35mm)

Speed, Capacities and Weight

Cruise Speed: 40 Knots Kts. (46 MPH)

Cruise Speed Range: 280

Max Speed: 46 Knots Kts. (53 MPH)

Water Capacity: 237.7548 Gallons

Fuel Capacity: 3500.02 Gal Gallons

Accommodations

Total Cabins: 2

Hull and Deck Information

Hull Material: Composite

Hull Configuration: Planing

Hull Color: White Brilliant

Engine Information

Engines: 2

Manufacturer: MTU

Engine Type: Inboard

Fuel Type: Diesel

PHOTOS





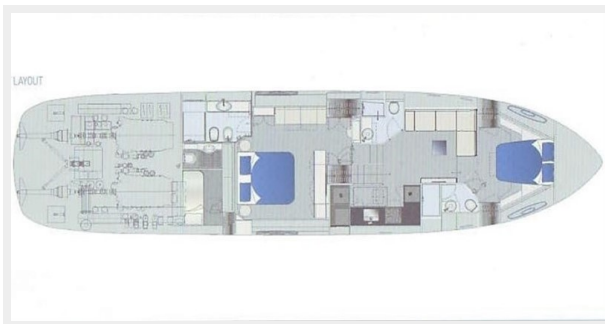

CONTACTS

Andrey Shestakov, leading yacht broker of the sales department of Shestakov Yacht Sales Inc. Shestakov Yacht Sales Inc., the official representative of the Miami/Fort Lauderdale FL headquarters.

Contact details

Email: andrey@shestakovyachtsales.com

Web: shestakovyachtsales.com/en/

Telephones

USA: +1(954)274-4435

Office hours

Monday – Saturday: 9:00 - 21:00 EDT

Sunday: **closed**

Address



Harbour Towne Marina, 850 NE 3rd St,
STE 213, Dania, FL 33004