

ANNABEL — SUNSEEKER



Builder: SUNSEEKER

Year Built: 2009

Model: Motor Yacht

Price: PRICE ON APPLICATION

Location: Spain

LOA: 88' (26.82mm)

Beam: 20.91

Max Draft: 6' 8" (2.03mm)

Max Speed: 27 Knots Kts. (31 MPH)

Our experienced yacht broker, Andrey Shestakov, will help you choose and buy a yacht that best suits your needs **ANNABEL — SUNSEEKER** from our catalogue. Presently, at Shestakov Yacht Sales Inc., we have a wide variety of yachts available on our sale's list. We also work in close contact with all the big yacht manufacturers from all over the world.

If you would like to buy a yacht **ANNABEL — SUNSEEKER** or would like help answering any questions concerning purchasing, selling or chartering a yacht, please call **+1(954)274-4435**

TABLE OF CONTENTS

TABLE OF CONTENTS	2
SPECIFICATIONS	4
Overview	4
Basic Information	4
Dimensions	4
Speed, Capacities and Weight	4
Accommodations	5
Hull and Deck Information	5
Engine Information	5
PHOTOS	6
Aft Deck	6
Aft Deck	6
Main Salon	6
Main Salon	6
Dining Area	6
Galley	6
Helm	7
Master Stateroom	7
Master Bath	7
VIP Stateroom	7
Port Guest Stateroom	7
Port Guest Stateroom	7
Guest Bath	8
Starboard Guest Stateroom	8
Flybride	8
Flybridge Seating	8
Side Deck	8
Sun Pad	8

Starboard Profile	9
Swim Platform	9
Starboard Running	9
Profile Layout	9
Flybridge Layout	9
Main Deck Layout	9
Lower Deck Layout	9
CONTACTS	10
Contact details	10
Telephones	10
Office hours	10
Address	10

SPECIFICATIONS

Overview

'Annabel' is stunning 2010 Sunseeker 88 Yacht, offered seriously for sale. Used only for private use since new, this 88 Yacht is in pristine condition. Fitted with twin 1947HP MTU 12V 2000 M94 engines, 'Annabel' reaches a top speed of 27 knots. She is fitted with Tropical specification air conditioning, TRAC Star digital fin stabilizer system, generators upgraded to two Kohler 27Kw 50Hz with silent sound shields, flybridge GRP hard top and Bang & Olufsen upgrade throughout. This striking Sunseeker 88 Yacht has a Bourneville brown hull and RAL white superstructure, both of which have been recently fully repainted by the manufacturers, Sunseeker International Limited. The interior of 'Annabel' has been completed using black American walnut in a satin finish, which is complemented by the cream and oyster leather soft furnishings. The luxurious accommodation on 'Annabel' consists of four en-suite staterooms with berths for eight guests. The extensive exterior areas of the flybridge, aft deck and foredeck provide guests onboard with al fresco entertaining and dining spaces.

Basic Information

Category: Motor Yacht

Model Year: 2010

Year Built: 2009

Country: Spain

Dimensions

LOA: 88' (26.82mm)

Beam: 20.91

Max Draft: 6' 8" (2.03mm)

Speed, Capacities and Weight

Max Speed: 27 Knots Kts. (31 MPH)

Gross Tonnage: 51 Pounds

Water Capacity: 1500 Gallons

Fuel Capacity: 7500 Gal Gallons

Accommodations

Total Cabins: 4

Sleeps: 8

Crew Cabin: 4

Crew Berths: 4

Hull and Deck Information

Hull Material: GRP

Deck Material: Teak

Engine Information

Engines: 2

Manufacturer: MTU

Fuel Type: Diesel

PHOTOS

Aft Deck



Aft Deck



Main Salon



Main Salon



Dining Area



Galley



Helm



Master Stateroom



Master Bath



VIP Stateroom



Port Guest Stateroom



Port Guest Stateroom



Guest Bath



Starboard Guest Stateroom



Flybridge



Flybridge Seating



Side Deck

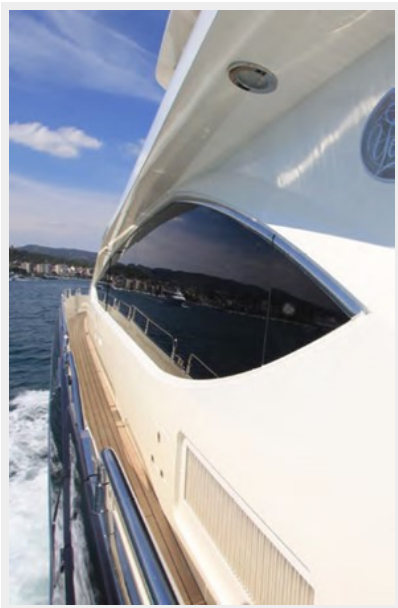

Sun Pad



Swim Platform



Starboard Profile



Starboard Running



Profile Layout



Flybridge Layout

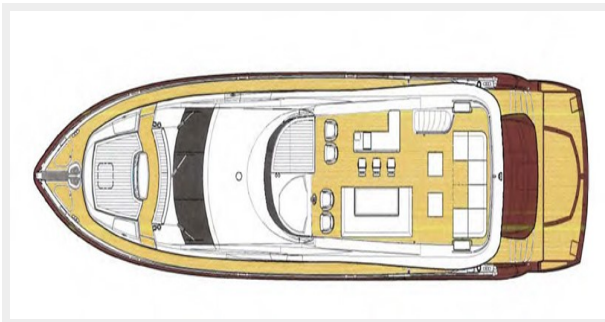

Main Deck Layout

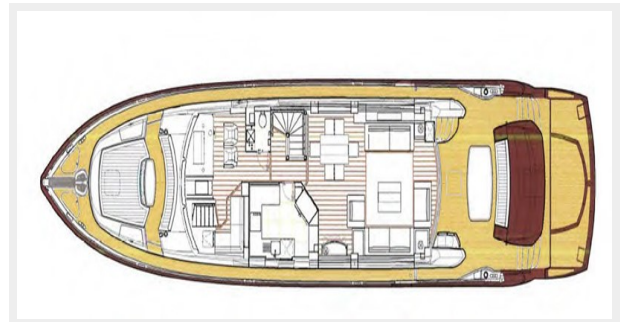

Lower Deck Layout

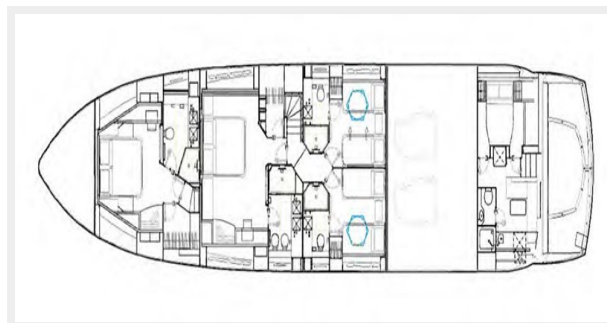

CONTACTS

Andrey Shestakov, leading yacht broker of the sales department of Shestakov Yacht Sales Inc. Shestakov Yacht Sales Inc., the official representative of the Miami/Fort Lauderdale FL headquarters.

Contact details

Email: andrey@shestakovyachtsales.com

Web: shestakovyachtsales.com/en/

Telephones

USA: +1(954)274-4435

Office hours

Monday – Saturday: **9:00 - 21:00** EDT

Sunday: **closed**

Address



Harbour Towne Marina, 850 NE 3rd St,
STE 213, Dania, FL 33004