

BURGER 122 TRI-DECK — BURGER



Builder: BURGER

Year Built: 2025

Model: Motor Yacht

Price: PRICE ON APPLICATION

Location: United States

LOA: 122' (37.19m)

Beam: 25.41

Max Draft: 6' 3" (1.9m)

Cruise Speed: 20 Knots Kts. (23 MPH)

Max Speed: 22 Knots Kts. (25 MPH)

Our experienced yacht broker, Andrey Shestakov, will help you choose and buy a yacht that best suits your needs **Burger 122 Tri-Deck — BURGER** from our catalogue. Presently, at Shestakov Yacht Sales Inc., we have a wide variety of yachts available on our sale's list. We also work in close contact with all the big yacht manufacturers from all over the world.

If you would like to buy a yacht **Burger 122 Tri-Deck — BURGER** or would like help answering any questions concerning purchasing, selling or chartering a yacht, please call **+1(954)274-4435**

TABLE OF CONTENTS

TABLE OF CONTENTS	2
SPECIFICATIONS	3
Overview	3
Basic Information	3
Dimensions	4
Speed, Capacities and Weight	4
Accommodations	4
Hull and Deck Information	4
PHOTOS	5
CONTACTS	7
Contact details	7
Telephones	7
Office hours	7
Address	7

SPECIFICATIONS

Overview

The Burger 122 Tri-Deck Motor Yacht is a gorgeous yacht. This is a Burger for the adventure of exploring the open waters. Whatever your plans, or dreams, she's ready to take you there. Modern. Strong. She has the quality you'd expect from Burger with the style demanded of today's adventurers. Work with Burger to customize her for your requirements — a collaboration that combines your mission with our heritage. The Burger 122 Tri Deck's large main salon and dining area is an exceptional space for entertaining or simply relaxing with friends and family. The luxurious full beam main deck owner's stateroom includes his and hers en suite baths and generous closet space. The main entry foyer makes one feel welcome while the guest accommodations consist of four fully appointed staterooms with en suite baths. The skylounge opens to a large aft deck area for enjoying the view and private dining. This area also offers direct access to the sun deck with a hot tub, bar area and open spaces for entertaining. The galley is designed for efficient use of space and provides ample room for conversing and relaxation. The crew area includes accommodations for six crew members forward and includes a spacious crew lounge and galley area. Aft of the engine room is the yacht's tender garage which converts to a Beach Club when the tender is launched. Imagine what you can build — dreams, getaways, the freedom of being at sea with no land in sight, an heirloom and a lifetime of memories crafted as a member of the Burger family. The Burger 122 provides you the opportunity to craft experiences to share with the loved ones in your life. Add your flair to the final design and complete your very own Burger yacht that is set up to give you a first-hand view of the world as you embark on new destinations and adventures. From salon spaces to entertain, guest decks for privacy and options for multiple staterooms, this is a Burger over which you can have as much control as you want. It's a journey and we'll join you, every step of the way. The Burger 122 is designed and built for distance and exploration. All available in comfort and a style you complete with Burger's design team. This yacht will be crafted to your specifications by Burger's experienced and meticulous team. Start here and finish with the adventure of a lifetime.

Basic Information

Category: Motor Yacht

Model Year: 2025

Year Built: 2025

Country: United States

Dimensions

LOA: 122' (37.19mm)

Beam: 25.41

Max Draft: 6' 3" (1.9mm)

Speed, Capacities and Weight

Cruise Speed: 20 Knots Kts. (23 MPH)

Max Speed: 22 Knots Kts. (25 MPH)

Gross Tonnage: 333 Pounds

Water Capacity: 1135 Gallons

Holding Tank: 1130 Gal Gallons

Fuel Capacity: 6500 Gal Gallons

Accommodations

Total Cabins: 5

Total Berths: 7

Sleeps: 10

Total Heads: 5

Crew Cabin: 6

Crew Berths: 5

Crew Heads: 3

Hull and Deck Information

Hull Material: Aluminum

Deck Material: Aluminum

Hull Configuration: Semi-Displacement

Hull Color: TBD

Hull Designer: Gregory C Marshall Naval Architects

Exterior Designer: Gregory C Marshall Naval Architects

Interior Designer: TBD

PHOTOS

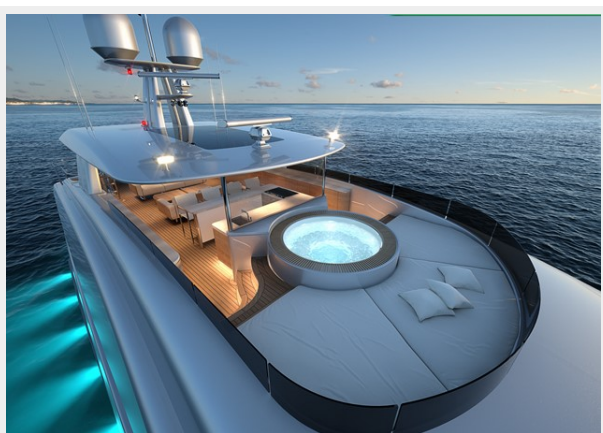

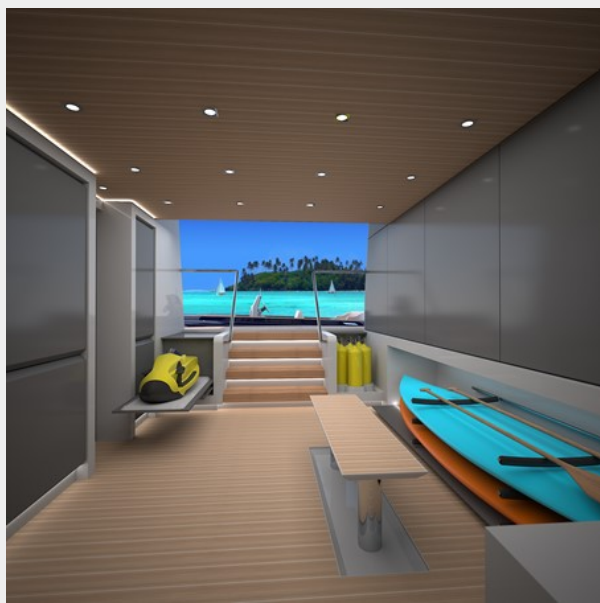
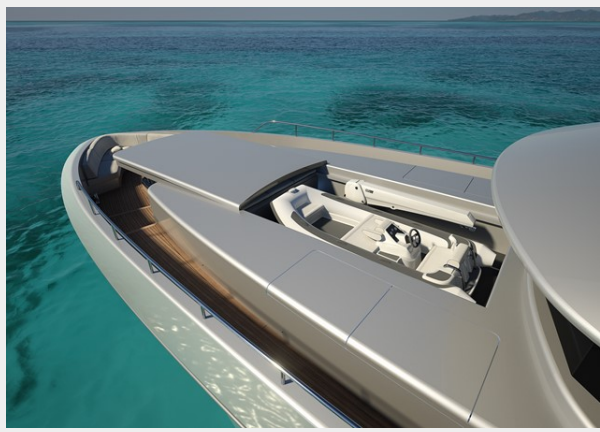

CONTACTS

Andrey Shestakov, leading yacht broker of the sales department of Shestakov Yacht Sales Inc. Shestakov Yacht Sales Inc., the official representative of the Miami/Fort Lauderdale FL headquarters.

Contact details

Email: andrey@shestakovyachtsales.com

Web: shestakovyachtsales.com/en/

Telephones

USA: +1(954)274-4435

Office hours

Monday – Saturday: **9:00 - 21:00** EDT

Sunday: **closed**

Address



Harbour Towne Marina, 850 NE 3rd St,
STE 213, Dania, FL 33004